

LAYOUT PLAN OF THE DEVELOPMENT 發展項目的布局圖

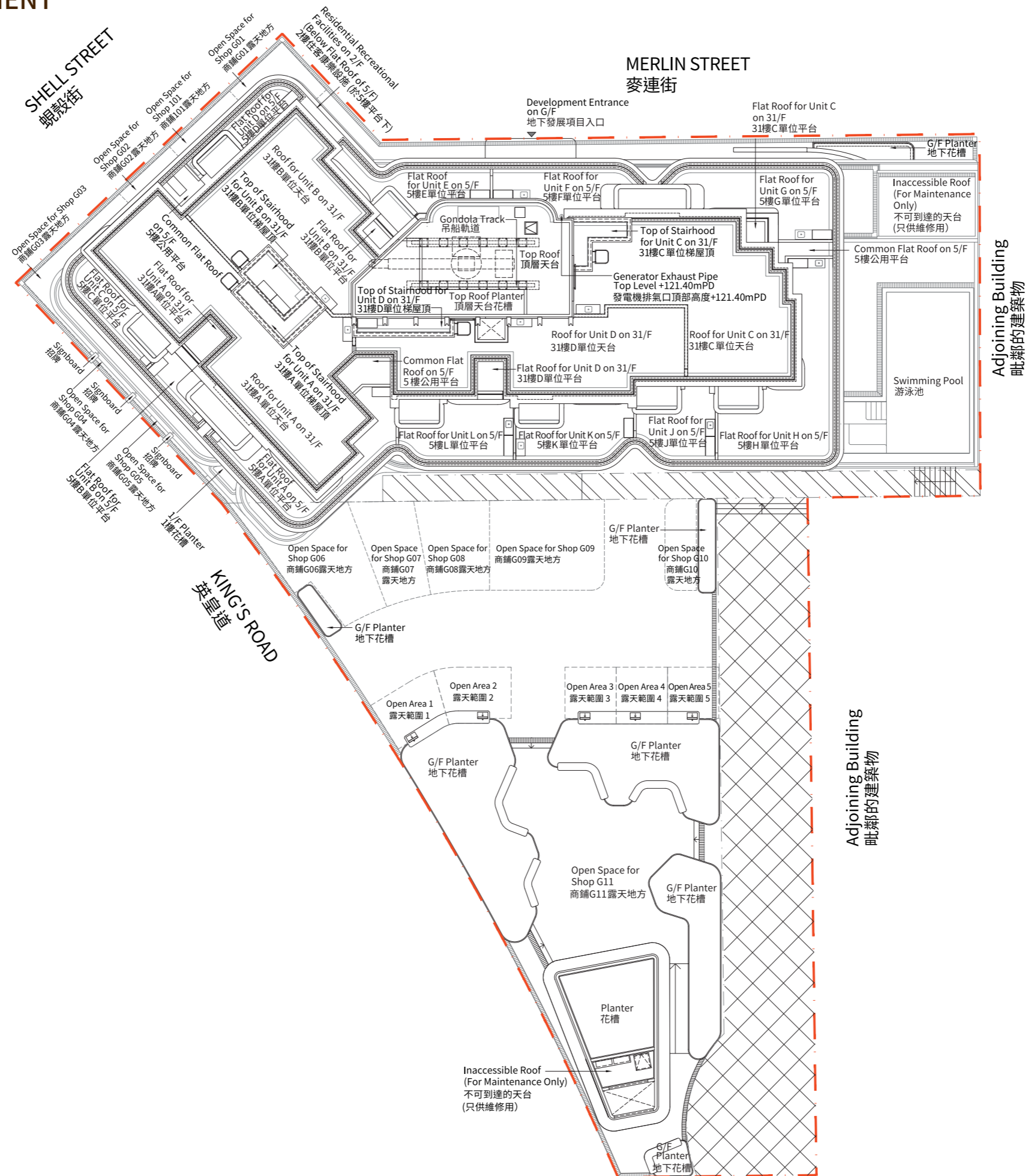

LEGEND
圖例

- Boundary of the Development
發展項目的界線
- Right of Way
通行權
- Right of Way
通行權

Scale
比例
0M(米) 5M(米) 10M(米)

The estimated date of completion of the uncompleted building and facilities, as provided by the Authorized Person for the Development is 31 January 2026.
由發展項目的認可人士提供的未落成建築物及設施的預計落成日期為2026年1月31日。