

LAYOUT PLAN OF THE DEVELOPMENT

發展項目的布局圖

LEGEND OF THE TERMS AND ABBREVIATIONS USED ON LAYOUT PLAN 布局圖中所使用之名詞及簡稱之圖例

24HRS PEDESTRIAN WALKWAY AT 1/F	=	24 HOURS PEDESTRIAN WALKWAY AT 1/F	位於1樓之24小時行人通道
A/C OUTDOOR UNIT FOR RESIDENTIAL RECREATION FACILITIES AT 3/F FLAT ROOF	=	AIR-CONDITIONER OUTDOOR UNIT FOR RESIDENTIAL RECREATIONAL FACILITIES AT 3/F FLAT ROOF	位於3樓平台之供住客休憩設施使用之冷氣室外機
A/C OUTDOOR UNIT FOR RESIDENTIAL RECREATION FACILITIES AT 2/F	=	AIR-CONDITIONER OUTDOOR UNIT FOR RESIDENTIAL RECREATIONAL FACILITIES AT 2/F	位於2樓之供住客休憩設施使用之冷氣室外機
A/C OUTDOOR UNIT FOR SHOP AT 3/F FLAT ROOF	=	AIR-CONDITIONER OUTDOOR UNIT FOR SHOP AT 3/F FLAT ROOF	位於3樓平台之供商舖使用之冷氣室外機
BASEMENT CARPARK ENTRANCE AT G/F	=	BASEMENT CARPARK ENTRANCE AT G/F	位於地下之地庫停車場入口
BBQ AREA	=	BBQ AREA	燒烤區
CANOPY	=	CANOPY	簷篷
CHILDREN'S PLAY AREA	=	CHILDREN'S PLAY AREA	兒童遊樂場
CHIMNEY FOR EMERGENCY GENERATOR ROOM AT 1/F	=	CHIMNEY FOR EMERGENCY GENERATOR ROOM AT 1/F	位於1樓之緊急發電機機房煙囪
COMMON AREA (FOR REMOVABLE POTS)	=	COMMON AREA (FOR REMOVABLE POTS)	公共範圍(供可移除花盆)
COMMON FLAT ROOF (COMMON AREA)	=	COMMON FLAT ROOF (COMMON AREA)	公共平台(公共範圍)
DRIVEWAY (E.V.A.)	=	DRIVEWAY (EMERGENCY VEHICULAR ACCESS)	車道(緊急車輛通道)
EMERGENCY GENERATOR ROOM AT G/F	=	EMERGENCY GENERATOR ROOM AT G/F	位於地下之緊急發電機房
EMERGENCY GENERATOR ROOM AT 1/F	=	EMERGENCY GENERATOR ROOM AT 1/F	位於1樓之緊急發電機房
EXHAUST LOUVRE FOR RESIDENTIAL RECREATION FACILITIES AT 2/F	=	EXHAUST LOUVRE FOR RESIDENTIAL RECREATION FACILITIES AT 2/F	位於2樓之住客休憩設施使用之排氣百葉
FLAT ROOF (COMMON AREA)	=	FLAT ROOF (COMMON AREA)	平台(公共範圍)
FLOOD LIGHTS MOUNTED AT EXTERNAL WALL FOR KIDS POOL	=	FLOOD LIGHTS MOUNTED AT EXTERNAL WALL FOR KIDS POOL	懸掛於外牆之供兒童游泳池使用之泛光燈
FLOOD LIGHTS MOUNTED AT EXTERNAL WALL FOR OUTDOOR SWIMMING POOL	=	FLOOD LIGHTS MOUNTED AT EXTERNAL WALL FOR OUTDOOR SWIMMING POOL	懸掛於外牆之供室外游泳池使用之泛光燈
GONDOLA AT TOP ROOF	=	GONDOLA AT TOP ROOF	位於頂層天台之吊船
GONDOLA AT UPPER ROOF	=	GONDOLA AT UPPER ROOF	位於上層天台之吊船
HORIZONTAL SCREEN (COVERED WALKWAY) AT 2/F	=	HORIZONTAL SCREEN (COVERED WALKWAY) AT 2/F	位於2樓之橫向屏障(有蓋行人通道)
KIDS POOL	=	KIDS POOL	兒童游泳池
LAMP POLES WITH FLOOD LIGHTS AT OUTDOOR SWIMMING POOL	=	LAMP POLES WITH FLOOD LIGHTS AT OUTDOOR SWIMMING POOL	位於室外游泳池之燈柱連泛光燈
LIGHT RAIL TRANSIT TRACK AND PLATFORMS AT G/F	=	LIGHT RAIL TRANSIT TRACK AND PLATFORMS AT G/F	位於地下之輕鐵路軌及月台
L/UL	=	LOADING AND UNLOADING SPACE	上落貨停車位
METAL CANOPY (NOISE BARRIER)	=	METAL CANOPY (NOISE BARRIER)	金屬簷篷(隔音屏障)
OUTDOOR SWIMMING POOL	=	OUTDOOR SWIMMING POOL	室外游泳池
P.	=	PLANTER	花槽
PROPOSED COVERED FOOTBRIDGE AT 1/F	=	PROPOSED COVERED FOOTBRIDGE AT 1/F	擬興建位於1樓之有蓋行人天橋
REFUGE ROOF	=	REFUGE ROOF	庇護層天台
RESIDENTIAL RECREATIONAL FACILITIES AT 2/F	=	RESIDENTIAL RECREATIONAL FACILITIES AT 2/F	位於2樓之住客休憩設施
SHOP AT 2/F	=	SHOP AT 2/F	位於2樓之商舖
TRANSFORMER STATION AT G/F	=	TRANSFORMER STATION AT G/F	位於地下之變壓器站
TRANSFORMER ROOM AT 1/F	=	TRANSFORMER ROOM AT 1/F	位於1樓之變壓器房
TRANSFORMER ROOM AT 2/F	=	TRANSFORMER ROOM AT 2/F	位於2樓之變壓器房
TIN WING STOP PLATFORM NO.6	=	TIN WING STOP PLATFORM NO.6	天榮站6號月台
TIN WING STOP TEMPORARY PLATFORM NO.7	=	TIN WING STOP TEMPORARY PLATFORM NO.7	天榮站7號臨時月台

Note:

- Flood lights will be provided for lighting of the outdoor swimming pool of the Development in the evening, prospective purchasers should note the impact (if any) of the illumination of the flood lights on individual units.
- Communal aerial system, mobile phone antenna, lightning rod, chimney for emergency generator room, transformer room and A/C outdoor unit forming part of the Development may affect the enjoyment of the residential properties.

附註:

- 泛光燈將提供以供發展項目室外游泳池的晚間照明, 準買家請注意上述泛光燈之燈光對個別單位造成之影響(如有)。
- 組成發展項目一部分的公共天線系統、流動電話天線、避雷針、緊急發電機機房煙囪、變壓器房及分體式冷氣室外機可能對享用住宅物業造成影響。





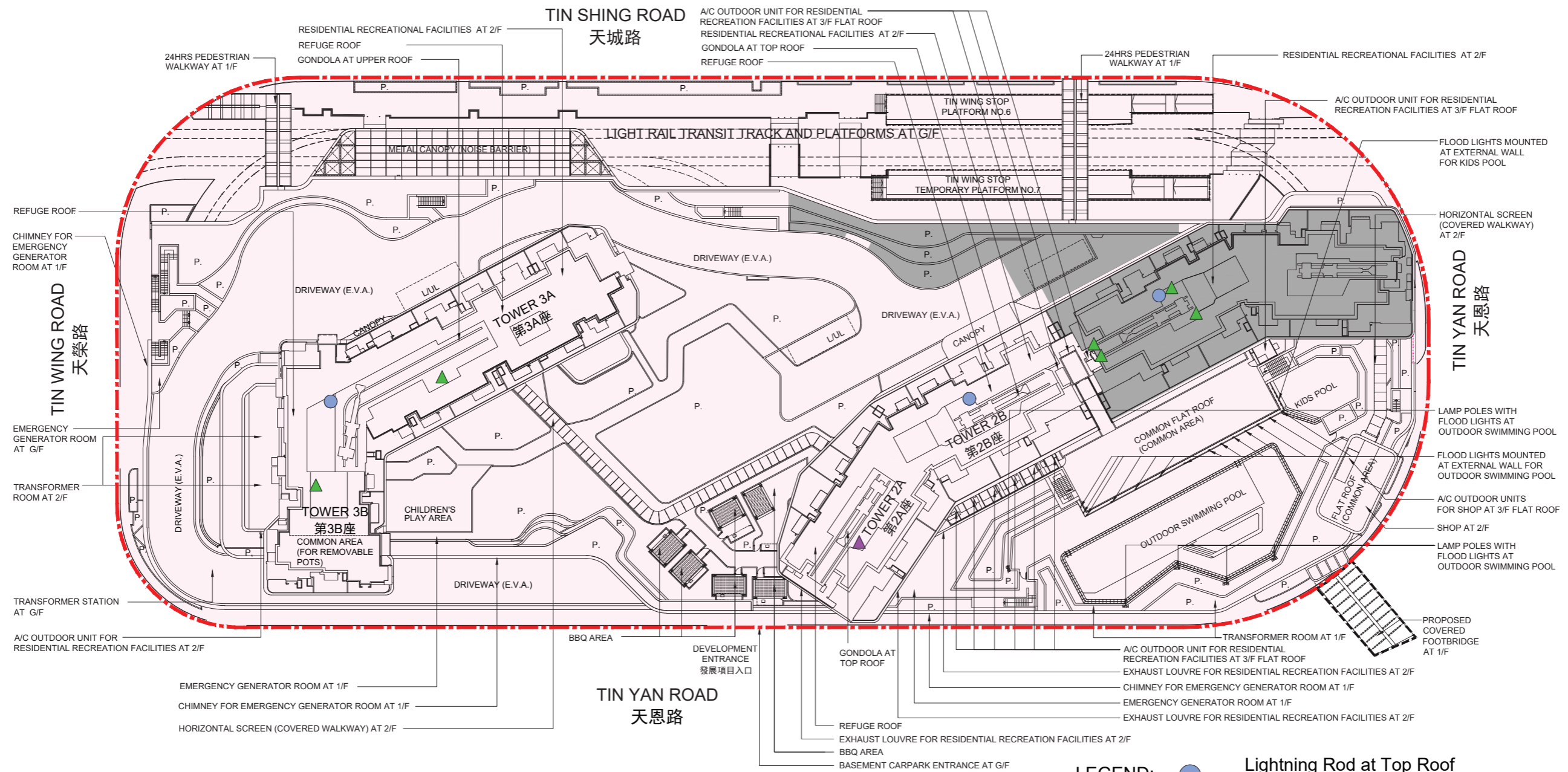

LAYOUT PLAN OF THE DEVELOPMENT

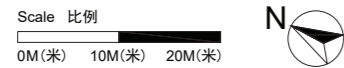
發展項目的布局圖



The estimated date of the completion of the buildings and facilities within Phase 2 of the development as provided by the Authorized Person for Phase 2 of the Development is 31 December 2025.
 由發展項目第2期的認可人士提供的位於發展項目第2期內的建築物及設施的預計落成日期為2025年12月31日。



- LEGEND:**
圖例
-  Lightning Rod at Top Roof
避雷針於頂層天台
 -  Communal Aerial System at Top Roof
公共天線系統於頂層天台
 -  Mobile Phone Antenna at Lift Machine Level and Upper Roof
流動電話天線於升降機機房層及上層天台
 -  Phase 1 of the Development
發展項目第1期
 -  Phase 2 of the Development
發展項目第2期
 -  Boundary of the Development
發展項目的界線