

FLOOR PLANS OF RESIDENTIAL PROPERTIES IN THE DEVELOPMENT

發展項目的住宅物業的樓面平面圖

Legend of Terms And Abbreviations Used On Floor Plans:

平面圖中所使用名稱及簡稱之圖例：

AIR CONDITIONER PLATFORM (FLAT A & B)	Air Conditioner Platform (Flat A & B)	空調機平台 (單位A和B)
AIR CONDITIONER PLATFORM (FLAT B)	Air Conditioner Platform (Flat B)	空調機平台 (單位B)
AIR CONDITIONER PLATFORM (FLAT C)	Air Conditioner Platform (Flat C)	空調機平台 (單位C)
AIR CONDITIONER METAL FRAME (FLAT C)	Air Conditioner Metal Frame (Flat C)	空調機金屬架 (單位C)
ALUMINIUM CLADDING	Aluminium Cladding	鋁質覆蓋層板
ARCHITECTURAL FEATURE ABOVE	Architectural Feature Above	上層建築裝飾
ARCHITECTURAL FEATURE BELOW	Architectural Feature Below	下層建築裝飾
ARCHITECTURAL FEATURE	Architectural Feature	建築裝飾
ARCHITECTURAL FIN	Architectural Fin	建築裝飾鰭
BALCONY	Balcony	露台
BALCONY ABOVE	Balcony Above	露台置上
BALCONY TOP	Balcony Top	露台上蓋
BATH	Bathroom	浴室
BEDROOM	Bedroom	睡房
BEDROOM 1	Bedroom 1	睡房1
BEDROOM 2	Bedroom 2	睡房2
CABINET FOR H.R. NOZZLE	Cabinet for Hose Reel Nozzle	消防喉轆噴嘴櫃
COMMON AREA FOR GONDOLA USE	Common Area for Gondola Use	吊船用的公用地方
COMMON FLAT ROOF	Common Flat Roof (Common Area designated in DMC)	公用平台 (公契指定為公用地方)
CURTAIN WALL TOP	Curtain Wall Top	玻璃幕牆蓋
D	Down	落

Notes :

1. There may be architectural features on external walls of some floors.
2. Common pipes exposed and/or enclosed in cladding are located at/adjacent to balcony and/or flat roof and/or roof of some residential units and/or air-conditioner platform and/or external walls.
3. There are sunken slabs and/or ceiling bulkheads and/or false ceiling at living rooms & dining rooms, bedrooms, corridors, bathrooms, store rooms, kitchens and open kitchens of some residential units for the air-conditioning system and/or mechanical and electrical services.
4. The internal ceiling height within some units may vary due to structural, architectural and/or decoration design variations.
5. Balconies are non-enclosed areas.
6. Symbols of fittings and fitments shown on the floor plans, such as sink, water closets, shower, sink counter, cabinet, fittings etc, are architectural symbols extracted from the latest approved general building plans and are for general indication only and are not for showing their actual size, design and shape.
7. There are curtain walls forming part of the enclosing walls of the residential units. The Saleable Area as defined in the Formal Agreement for Sale and Purchase of a residential unit has included the curtain walls, and is measured from the exterior of such curtain walls.

備註：

1. 部分樓層外牆或設有建築裝飾。
2. 部分住宅單位的露台及/或平台及/或天台及/或空調機平台及/或外牆或其鄰近地方設有外露及/或內藏於覆蓋層板的公用喉管。
3. 部分住宅單位客廳及飯廳、睡房、走廊、浴室、儲物室、廚房及開放式廚房設有跌級樓板及/或天花假陣及/或假天花，用以裝置空調系統及/或機電設備。
4. 部分單位之室內天花高度將會因應結構、建築及/或裝修設計上的需要而有差異。
5. 露台為不可封閉的地方。
6. 樓面平面圖上所顯示的形象裝置符號，例如洗滌盆、坐廁、淋浴間、洗滌盆櫃、櫃、裝置等乃摘自最新的經批准的建築圖則的建築圖示，只作一般性標誌，並非展示其實際大小、設計及形狀。
7. 住宅單位有構成其圍封牆的一部分的幕牆。住宅單位之正式買賣合約內所定義之實用面積已包括幕牆，並由該幕牆之外圍起計。

FLOOR PLANS OF RESIDENTIAL PROPERTIES IN THE DEVELOPMENT

發展項目的住宅物業的樓面平面圖

E.L.	Electricity Duct	電線槽
E.M.C.	Electricity Meter Cabinet	電錶櫃
FLAT ROOF	Flat Roof	平台
F.H.	Fire Hydrant	消防栓
H.R.	Hose Reel	消防喉轆
H.R. AT H/L	Hose Reel at High Level	消防喉轆在高位
KITCHEN	Kitchen	廚房
LIFT	Lift	升降機
LIFT LOBBY	Lift Lobby	升降機大堂
LIFT SHAFT	Lift Shaft	升降機槽
LIVING / DINING	Living Room & Dining Room	客廳及飯廳
M. BEDROOM	Master Bedroom	主人睡房
MAIN ROOF	Main Roof	主天台
MAX.	Maximum	最大值
OPEN KITCHEN	Open Kitchen	開放式廚房
P.D.	Pipe Duct	管道槽
POTABLE AND FLUSHING PUMP ROOM	Potable and Flushing Pump Room	食用及沖廁水泵房
SPK. PIPES	Sprinkler Pipes	花灑管
STORE	Store Room	儲物室
TOP OF E.L.	Top of Electricity Duct	電線槽上蓋
U	Up	上
W.M.C.	Water Meter Cabinet	水錶櫃

Notes :

1. There may be architectural features on external walls of some floors.
2. Common pipes exposed and/or enclosed in cladding are located at/adjacent to balcony and/or flat roof and/or roof of some residential units and/or air-conditioner platform and/or external walls.
3. There are sunken slabs and/or ceiling bulkheads and/or false ceiling at living rooms & dining rooms, bedrooms, corridors, bathrooms, store rooms, kitchens and open kitchens of some residential units for the air-conditioning system and/or mechanical and electrical services.
4. The internal ceiling height within some units may vary due to structural, architectural and/or decoration design variations.
5. Balconies are non-enclosed areas.
6. Symbols of fittings and fitments shown on the floor plans, such as sink, water closets, shower, sink counter, cabinet, fittings etc, are architectural symbols extracted from the latest approved general building plans and are for general indication only and are not for showing their actual size, design and shape.
7. There are curtain walls forming part of the enclosing walls of the residential units. The Saleable Area as defined in the Formal Agreement for Sale and Purchase of a residential unit has included the curtain walls, and is measured from the exterior of such curtain walls.

備註：

1. 部分樓層外牆或設有建築裝飾。
2. 部分住宅單位的露台及/或平台及/或天台及/或空調機平台及/或外牆或其鄰近地方設有外露及/或內藏於覆蓋層板的公用喉管。
3. 部分住宅單位客廳及飯廳、睡房、走廊、浴室、儲物室、廚房及開放式廚房設有跌級樓板及/或天花假陣及/或假天花，用以裝置空調系統及/或機電設備。
4. 部分單位之室內天花高度將會因應結構、建築及/或裝修設計上的需要而有差異。
5. 露台為不可封閉的地方。
6. 樓面平面圖上所顯示的形象裝置符號，例如洗滌盆、坐廁、淋浴間、洗滌盆櫃、櫃、裝置等乃摘自最新的經批准的建築圖則的建築圖示，只作一般性標誌，並非展示其實際大小、設計及形狀。
7. 住宅單位有構成其圍封牆的一部分的幕牆。住宅單位之正式買賣合約內所定義之實用面積已包括幕牆，並由該幕牆之外圍起計。

FLOOR PLANS OF RESIDENTIAL PROPERTIES IN THE DEVELOPMENT

發展項目的住宅物業的樓面平面圖

5/F
FLOOR PLAN
5樓
樓面平面圖

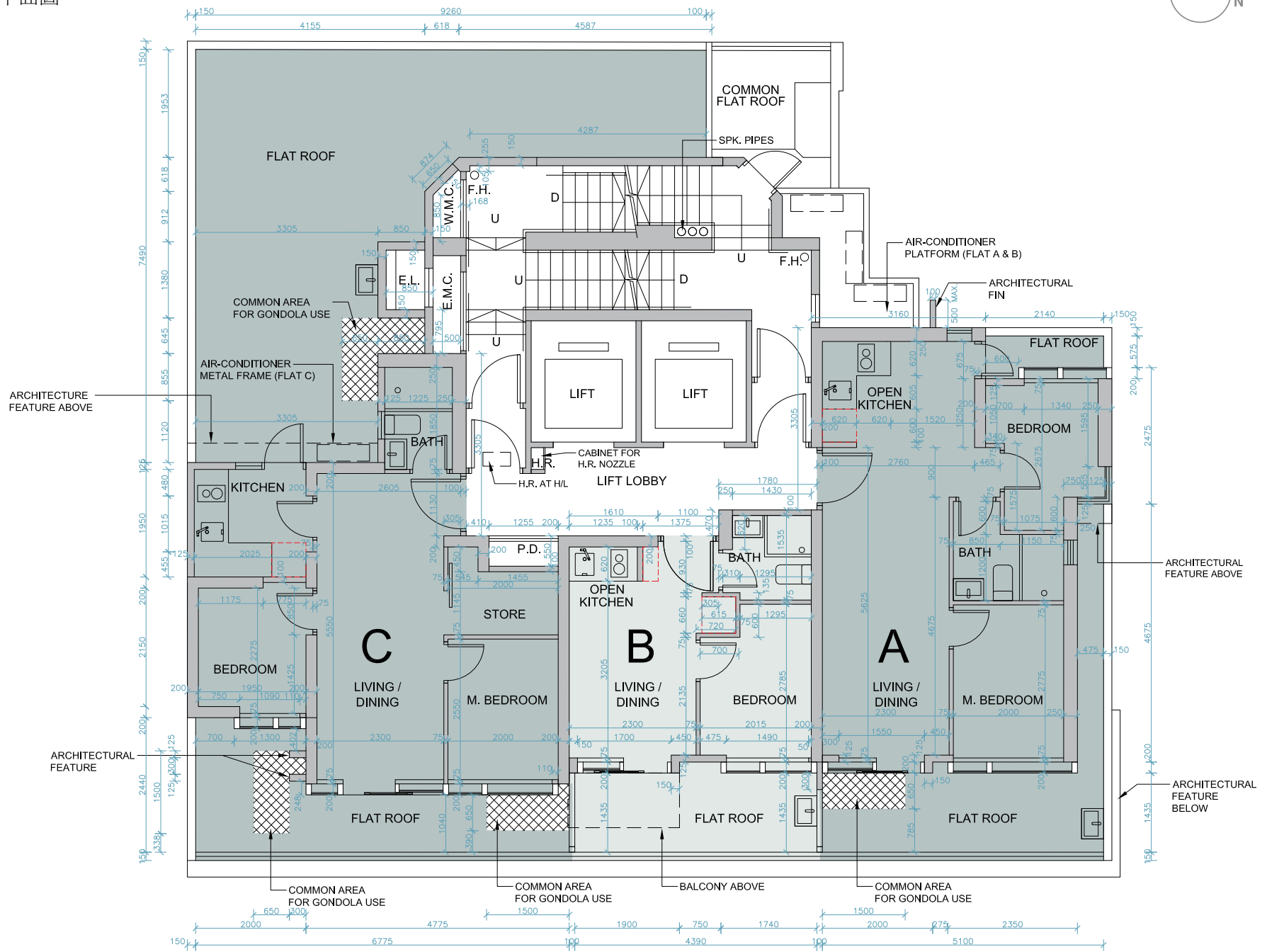

 Built-in fittings provided in the flats
隨樓附送之嵌人式裝置

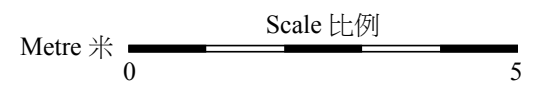

FLOOR PLANS OF RESIDENTIAL PROPERTIES IN THE DEVELOPMENT

發展項目的住宅物業的樓面平面圖

Floor 樓層	Flat 單位	Thickness of the Floor Slabs (excluding plaster) of each residential property (mm) 每個住宅物業的樓板 (不包括灰泥) 的厚度 (毫米)	The floor-to-floor height of each residential property (mm) 每個住宅物業的層與層之間的高度 (毫米)
5/F 5樓	A	150	2950, 3100, 3300, 3350, 3650
	B	175	3250, 3300
	C	150	3100, 3300

The internal areas of the residential properties on the upper floors will generally be slightly larger than those on the lower floors because of the reducing thickness of the structural walls on the upper floors. This situation and section 10(2)(e) of Part 1 of Schedule 1 to the Residential Properties (First-hand Sales) Ordinance is not applicable for this Development.
因住宅物業的較高樓層的結構牆的厚度遞減，較高樓層的內部面積，一般比較低樓層的內部面積稍大。此情況及《一手住宅物業銷售條例》附表1第1部第10(2)(e)條不適用於此發展項目。

Notes:

- The dimensions of the floor plan are all structural dimensions in millimetres.
- Please refer to Pages 34 - 35 of this sales brochure for the legend of the terms and abbreviations shown on the floor plans and remarks that are applicable thereto.
- There may be architectural features on external walls of some residential properties. For details, please refer to the latest approved building plans.
- "Floor-to-floor height" refers to the height between the top surface of the structural slab of floor and the top surface of the structural slab of its immediate upper floor.

附註：

- 樓面平面圖所列之尺寸為以毫米標示之建築結構尺寸。
- 樓面平面圖中顯示之名詞及簡稱之圖例及其適用的附註，請參閱本售樓說明書第34至35頁。
- 部分住宅物業外牆可能設有建築裝飾。詳情請參考最新批准之建築圖則。
- "層與層之間的高度" 指該樓層之石屎地台面與上一層石屎地台面之高度距離。

FLOOR PLANS OF RESIDENTIAL PROPERTIES IN THE DEVELOPMENT

發展項目的住宅物業的樓面平面圖

6/F
FLOOR PLAN
6樓
樓面平面圖

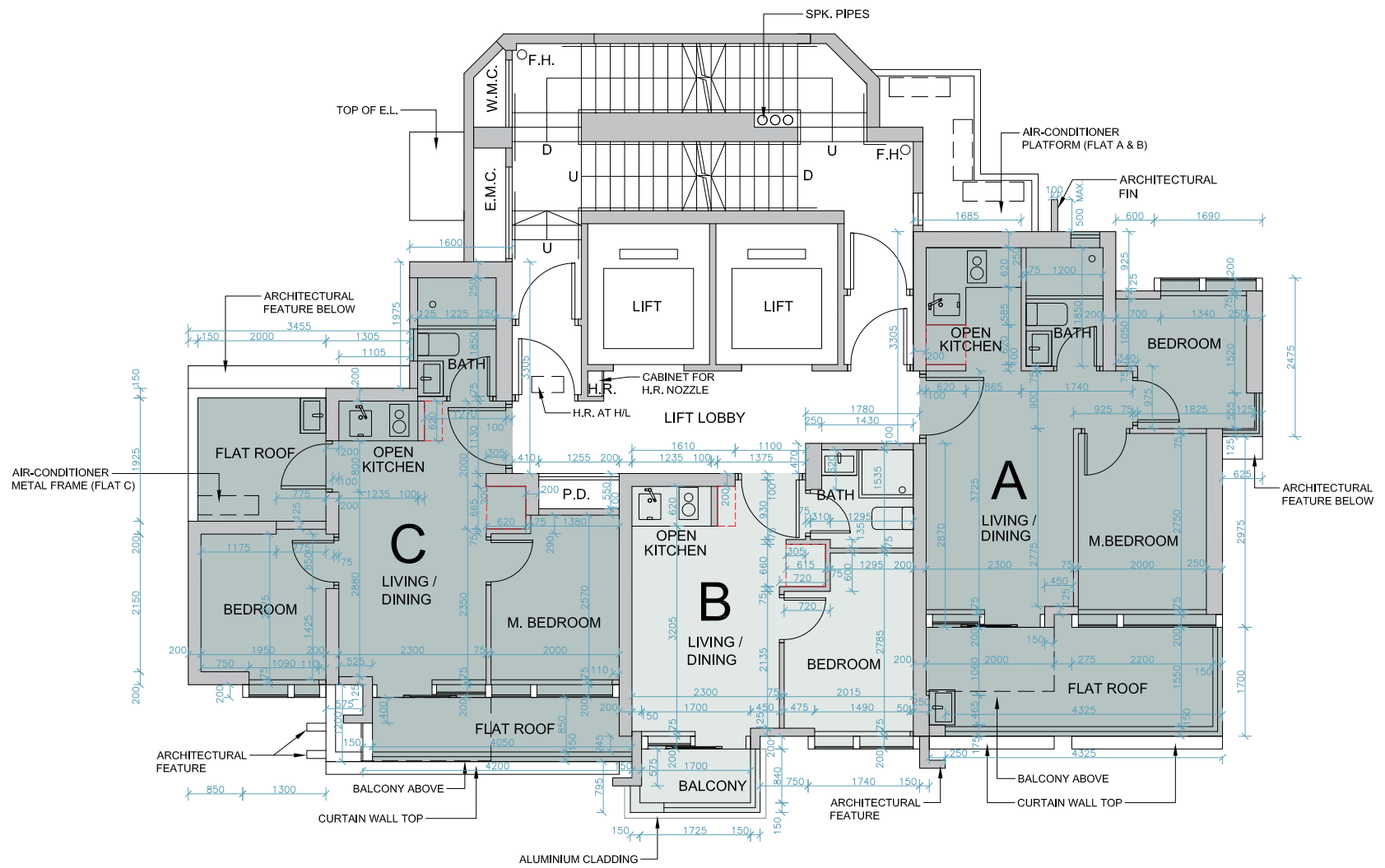

 Built-in fittings provided in the flats
隨樓附送之嵌人式裝置

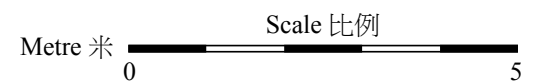

FLOOR PLANS OF RESIDENTIAL PROPERTIES IN THE DEVELOPMENT

發展項目的住宅物業的樓面平面圖

Floor 樓層	Flat 單位	Thickness of the Floor Slabs (excluding plaster) of each residential property (mm) 每個住宅物業的樓板 (不包括灰泥) 的厚度 (毫米)	The floor-to-floor height of each residential property (mm) 每個住宅物業的層與層之間的高度 (毫米)
6/F 6樓	A	150	3300
	B	175	
	C	150	

The internal areas of the residential properties on the upper floors will generally be slightly larger than those on the lower floors because of the reducing thickness of the structural walls on the upper floors. This situation and section 10(2)(e) of Part 1 of Schedule 1 to the Residential Properties (First-hand Sales) Ordinance is not applicable for this Development.
因住宅物業的較高樓層的結構牆的厚度遞減，較高樓層的內部面積，一般比較低樓層的內部面積稍大。此情況及《一手住宅物業銷售條例》附表1第1部第10(2)(e)條不適用於此發展項目。

Notes:

- The dimensions of the floor plan are all structural dimensions in millimetres.
- Please refer to Pages 34 - 35 of this sales brochure for the legend of the terms and abbreviations shown on the floor plans and remarks that are applicable thereto.
- There may be architectural features on external walls of some residential properties. For details, please refer to the latest approved building plans.
- "Floor-to-floor height" refers to the height between the top surface of the structural slab of floor and the top surface of the structural slab of its immediate upper floor.

附註：

- 樓面平面圖所列之尺寸為以毫米標示之建築結構尺寸。
- 樓面平面圖中顯示之名詞及簡稱之圖例及其適用的附註，請參閱本售樓說明書第34至35頁。
- 部分住宅物業外牆可能設有建築裝飾。詳情請參考最新批准之建築圖則。
- "層與層之間的高度" 指該樓層之石屎地台面與上一層石屎地台面之高度距離。

FLOOR PLANS OF RESIDENTIAL PROPERTIES IN THE DEVELOPMENT

發展項目的住宅物業的樓面平面圖

7/F - 12/F, 15/F - 17/F & 19/F - 22/F
 FLOOR PLAN
 7樓至12樓，15樓至17樓及19樓至22樓
 樓面平面圖

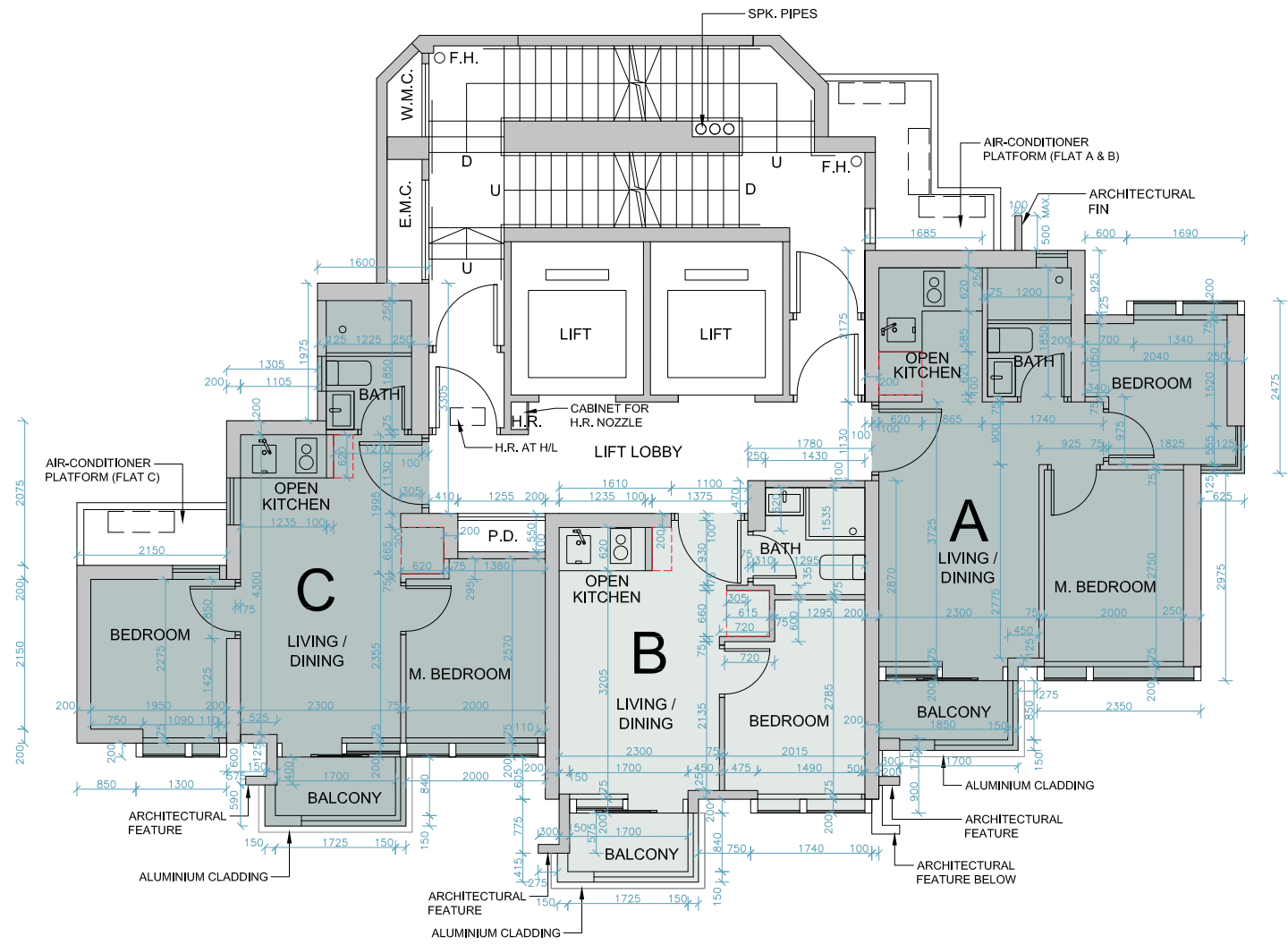

 Built-in fittings provided in the flats
 隨樓附送之嵌人式裝置

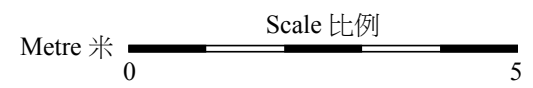

FLOOR PLANS OF RESIDENTIAL PROPERTIES IN THE DEVELOPMENT

發展項目的住宅物業的樓面平面圖

Floor 樓層	Flat 單位	Thickness of the Floor Slabs (excluding plaster) of each residential property (mm) 每個住宅物業的樓板 (不包括灰泥) 的厚度 (毫米)	The floor-to-floor height of each residential property (mm) 每個住宅物業的層與層之間的高度 (毫米)
7/F - 12/F, 15/F - 17/F & 19/F - 21/F 7樓至12樓， 15樓至17樓及 19樓至21樓	A	150	3300
	B	175	
	C	150	
22/F 22樓	A	150	3300
	B	175	3300, 3350, 3550, 3650, 3700
	C	150	3300

The internal areas of the residential properties on the upper floors will generally be slightly larger than those on the lower floors because of the reducing thickness of the structural walls on the upper floors. This situation and section 10(2)(e) of Part 1 of Schedule 1 to the Residential Properties (First-hand Sales) Ordinance is not applicable for this Development.

因住宅物業的較高樓層的結構牆的厚度遞減，較高樓層的內部面積，一般比較低樓層的內部面積稍大。此情況及《一手住宅物業銷售條例》附表1第1部第10(2)(e)條不適用於此發展項目。

Notes:

- The dimensions of the floor plan are all structural dimensions in millimetres.
- Please refer to Pages 34 - 35 of this sales brochure for the legend of the terms and abbreviations shown on the floor plans and remarks that are applicable thereto.
- There may be architectural features on external walls of some residential properties. For details, please refer to the latest approved building plans.
- "Floor-to-floor height" refers to the height between the top surface of the structural slab of floor and the top surface of the structural slab of its immediate upper floor.

附註：

- 樓面平面圖所列之尺寸為以毫米標示之建築結構尺寸。
- 樓面平面圖中顯示之名詞及簡稱之圖例及其適用的附註，請參閱本售樓說明書第34至35頁。
- 部分住宅物業外牆可能設有建築裝飾。詳情請參考最新批准之建築圖則。
- "層與層之間的高度" 指該樓層之石屎地台面與上一層石屎地台面之高度距離。

FLOOR PLANS OF RESIDENTIAL PROPERTIES IN THE DEVELOPMENT

發展項目的住宅物業的樓面平面圖

18/F
FLOOR PLAN
18樓
樓面平面圖

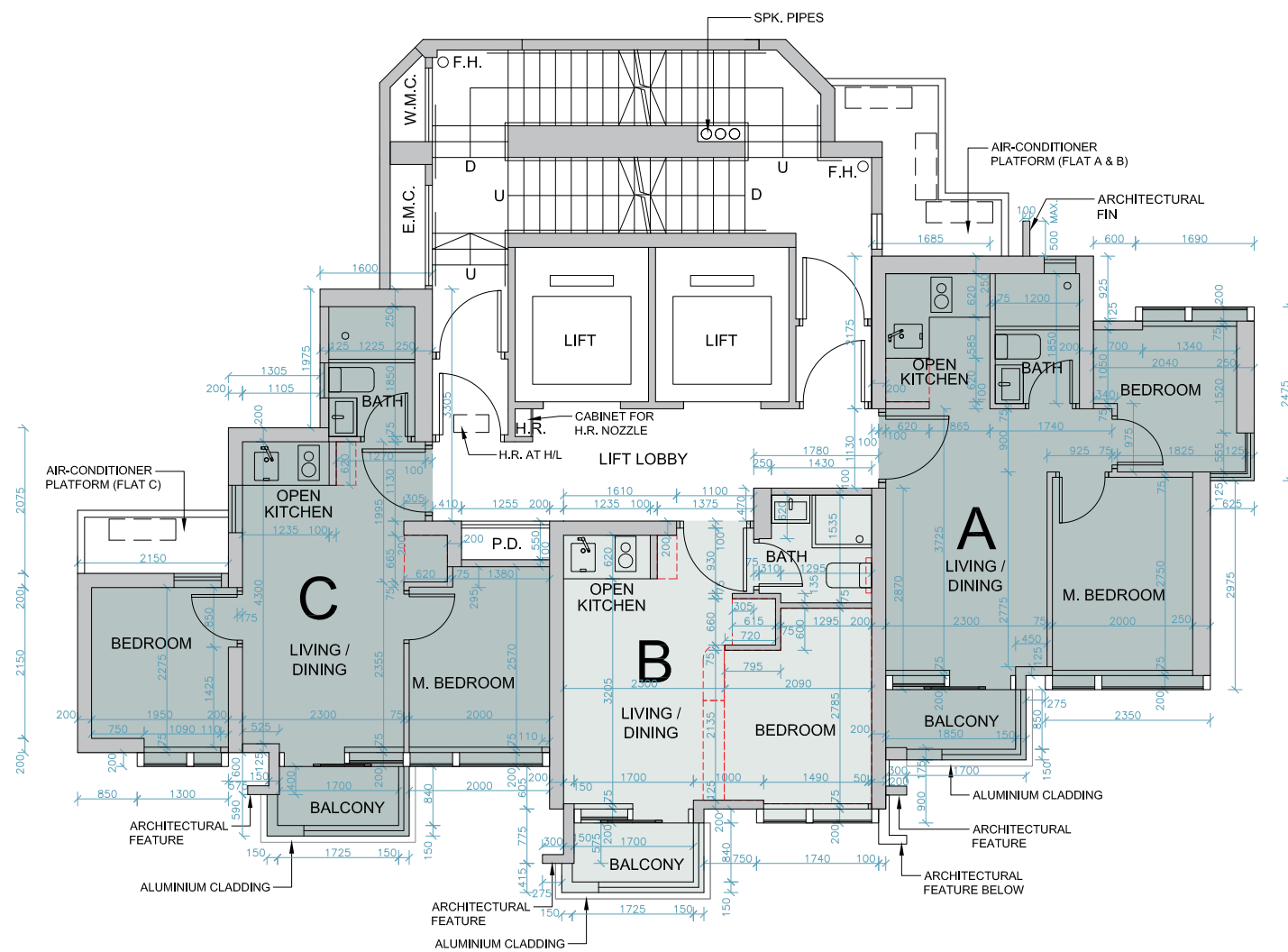

 Built-in fittings provided in the flats
隨樓附送之嵌人式裝置

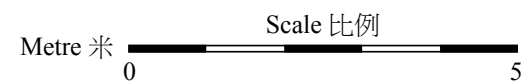

FLOOR PLANS OF RESIDENTIAL PROPERTIES IN THE DEVELOPMENT

發展項目的住宅物業的樓面平面圖

Floor 樓層	Flat 單位	Thickness of the Floor Slabs (excluding plaster) of each residential property (mm) 每個住宅物業的樓板 (不包括灰泥) 的厚度 (毫米)	The floor-to-floor height of each residential property (mm) 每個住宅物業的層與層之間的高度 (毫米)
18/F 18樓	A	150	3300
	B	175	
	C	150	

The internal areas of the residential properties on the upper floors will generally be slightly larger than those on the lower floors because of the reducing thickness of the structural walls on the upper floors. This situation and section 10(2)(e) of Part 1 of Schedule 1 to the Residential Properties (First-hand Sales) Ordinance is not applicable for this Development.
因住宅物業的較高樓層的結構牆的厚度遞減，較高樓層的內部面積，一般比較低樓層的內部面積稍大。此情況及《一手住宅物業銷售條例》附表1第1部第10(2)(e)條不適用於此發展項目。

Notes:

- The dimensions of the floor plan are all structural dimensions in millimetres.
- Please refer to Pages 34 - 35 of this sales brochure for the legend of the terms and abbreviations shown on the floor plans and remarks that are applicable thereto.
- There may be architectural features on external walls of some residential properties. For details, please refer to the latest approved building plans.
- "Floor-to-floor height" refers to the height between the top surface of the structural slab of floor and the top surface of the structural slab of its immediate upper floor.

附註：

- 樓面平面圖所列之尺寸為以毫米標示之建築結構尺寸。
- 樓面平面圖中顯示之名詞及簡稱之圖例及其適用的附註，請參閱本售樓說明書第34至35頁。
- 部分住宅物業外牆可能設有建築裝飾。詳情請參考最新批准之建築圖則。
- "層與層之間的高度" 指該樓層之石屎地台面與上一層石屎地台面之高度距離。

FLOOR PLANS OF RESIDENTIAL PROPERTIES IN THE DEVELOPMENT

發展項目的住宅物業的樓面平面圖

23/F
FLOOR PLAN
23樓
樓面平面圖

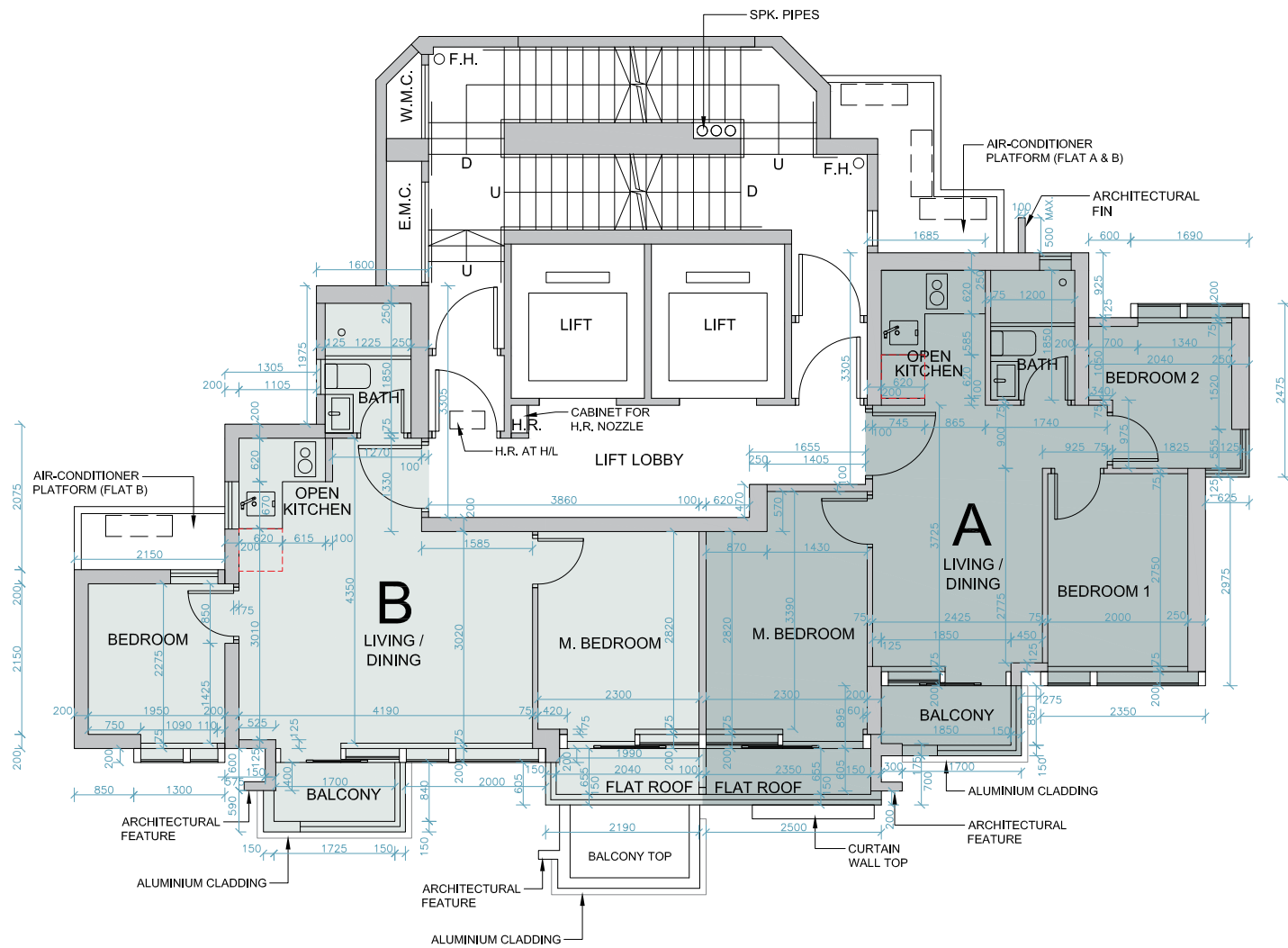

 Built-in fittings provided in the flats
隨樓附送之嵌入式裝置

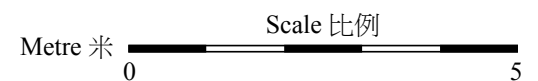

FLOOR PLANS OF RESIDENTIAL PROPERTIES IN THE DEVELOPMENT

發展項目的住宅物業的樓面平面圖

Floor 樓層	Flat 單位	Thickness of the Floor Slabs (excluding plaster) of each residential property (mm) 每個住宅物業的樓板 (不包括灰泥) 的厚度 (毫米)	The floor-to-floor height of each residential property (mm) 每個住宅物業的層與層之間的高度 (毫米)
23/F 23樓	A	150, 175	3300
	B	150, 175	

The internal areas of the residential properties on the upper floors will generally be slightly larger than those on the lower floors because of the reducing thickness of the structural walls on the upper floors. This situation and section 10(2)(e) of Part 1 of Schedule 1 to the Residential Properties (First-hand Sales) Ordinance is not applicable for this Development.

因住宅物業的較高樓層的結構牆的厚度遞減，較高樓層的內部面積，一般比較低樓層的內部面積稍大。此情況及《一手住宅物業銷售條例》附表1第1部第10(2)(e)條不適用於此發展項目。

Notes:

- The dimensions of the floor plan are all structural dimensions in millimetres.
- Please refer to Pages 34 - 35 of this sales brochure for the legend of the terms and abbreviations shown on the floor plans and remarks that are applicable thereto.
- There may be architectural features on external walls of some residential properties. For details, please refer to the latest approved building plans.
- "Floor-to-floor height" refers to the height between the top surface of the structural slab of floor and the top surface of the structural slab of its immediate upper floor.

附註：

- 樓面平面圖所列之尺寸為以毫米標示之建築結構尺寸。
- 樓面平面圖中顯示之名詞及簡稱之圖例及其適用的附註，請參閱本售樓說明書第34至35頁。
- 部分住宅物業外牆可能設有建築裝飾。詳情請參考最新批准之建築圖則。
- "層與層之間的高度" 指該樓層之石屎地台面與上一層石屎地台面之高度距離。

FLOOR PLANS OF RESIDENTIAL PROPERTIES IN THE DEVELOPMENT

發展項目的住宅物業的樓面平面圖

25/F
FLOOR PLAN
25樓
樓面平面圖

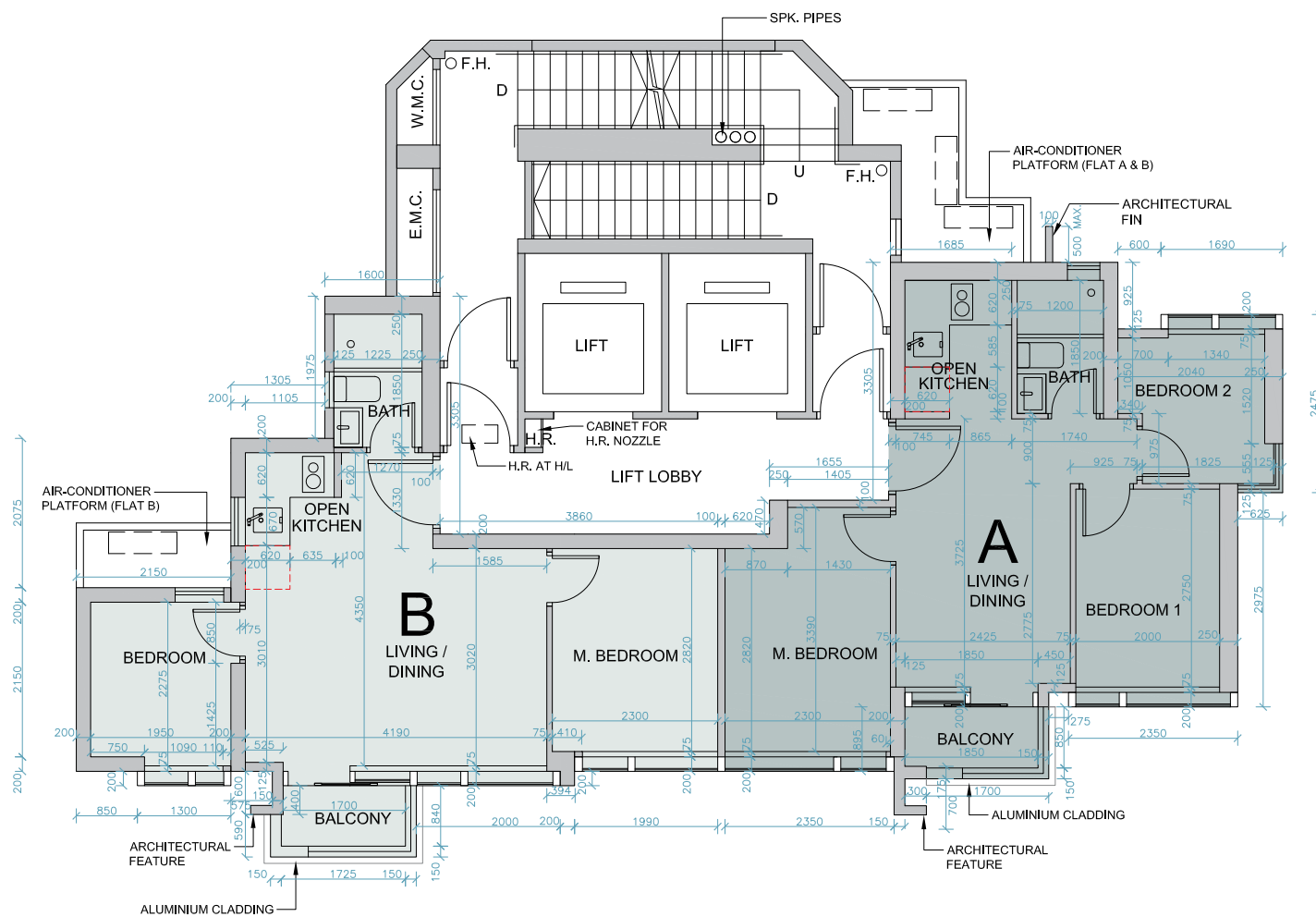

 Built-in fittings provided in the flats
隨樓附送之嵌人式裝置

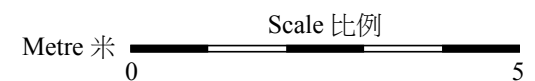

FLOOR PLANS OF RESIDENTIAL PROPERTIES IN THE DEVELOPMENT

發展項目的住宅物業的樓面平面圖

Floor 樓層	Flat 單位	Thickness of the Floor Slabs (excluding plaster) of each residential property (mm) 每個住宅物業的樓板 (不包括灰泥) 的厚度 (毫米)	The floor-to-floor height of each residential property (mm) 每個住宅物業的層與層之間的高度 (毫米)
25/F 25樓	A	150, 175	3300, 3650, 3700, 4000
	B	150, 175	3150, 3200, 3300, 3450, 3650

The internal areas of the residential properties on the upper floors will generally be slightly larger than those on the lower floors because of the reducing thickness of the structural walls on the upper floors. This situation and section 10(2)(e) of Part 1 of Schedule 1 to the Residential Properties (First-hand Sales) Ordinance is not applicable for this Development.
因住宅物業的較高樓層的結構牆的厚度遞減，較高樓層的內部面積，一般比較低樓層的內部面積稍大。此情況及《一手住宅物業銷售條例》附表1第1部第10(2)(e)條不適用於此發展項目。

Notes:

- The dimensions of the floor plan are all structural dimensions in millimetres.
- Please refer to Pages 34 - 35 of this sales brochure for the legend of the terms and abbreviations shown on the floor plans and remarks that are applicable thereto.
- There may be architectural features on external walls of some residential properties. For details, please refer to the latest approved building plans.
- "Floor-to-floor height" refers to the height between the top surface of the structural slab of floor and the top surface of the structural slab of its immediate upper floor.

附註：

- 樓面平面圖所列之尺寸為以毫米標示之建築結構尺寸。
- 樓面平面圖中顯示之名詞及簡稱之圖例及其適用的附註，請參閱本售樓說明書第34至35頁。
- 部分住宅物業外牆可能設有建築裝飾。詳情請參考最新批准之建築圖則。
- "層與層之間的高度" 指該樓層之石屎地台面與上一層石屎地台面之高度距離。

FLOOR PLANS OF RESIDENTIAL PROPERTIES IN THE DEVELOPMENT

發展項目的住宅物業的樓面平面圖

Roof
FLOOR PLAN
天台
樓面平面圖

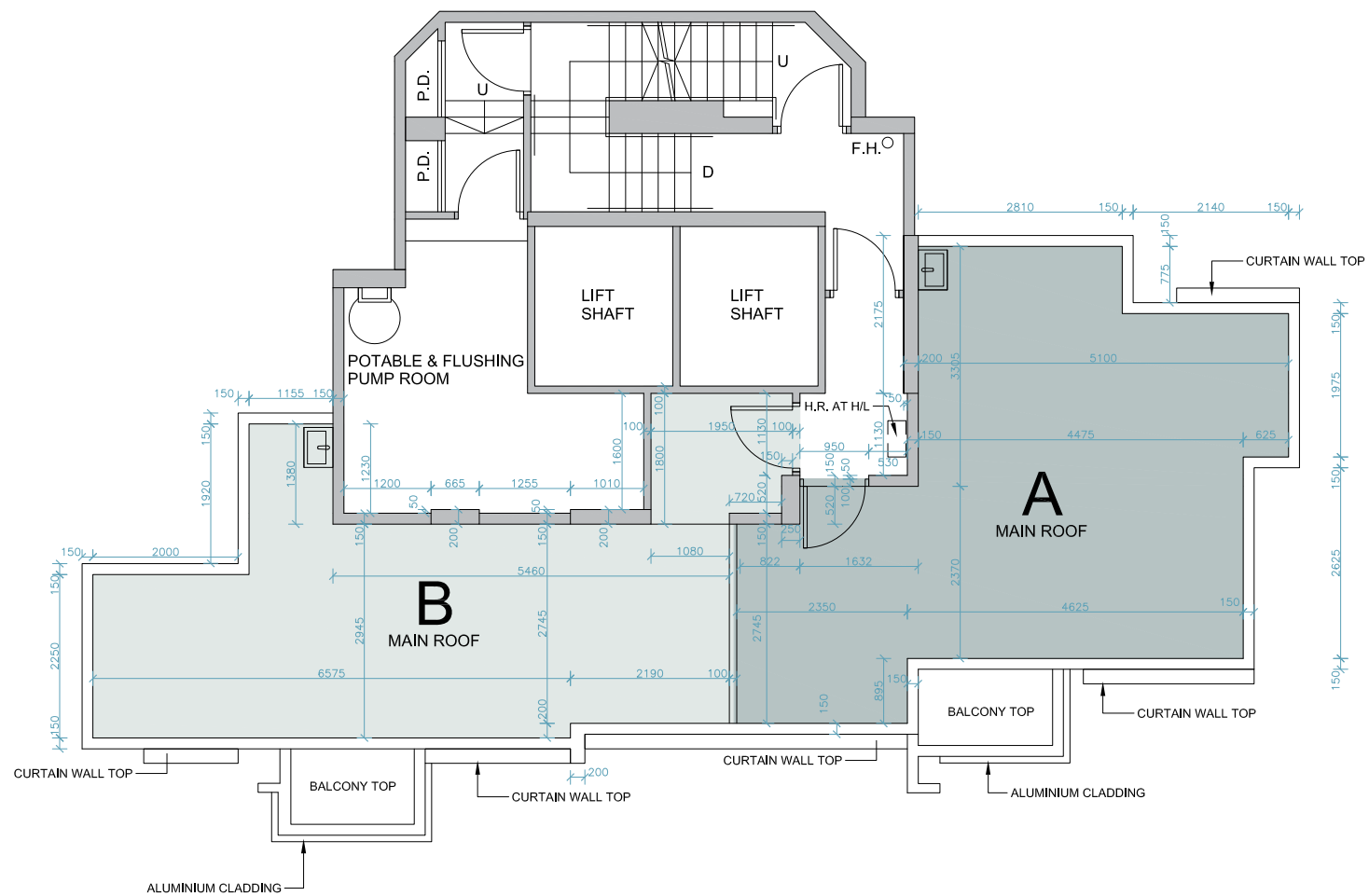

Metre 米
0
5
 Scale 比例

FLOOR PLANS OF RESIDENTIAL PROPERTIES IN THE DEVELOPMENT

發展項目的住宅物業的樓面平面圖

Floor 樓層	Flat 單位	Thickness of the Floor Slabs (excluding plaster) of each residential property (mm) 每個住宅物業的樓板 (不包括灰泥) 的厚度 (毫米)	The floor-to-floor height of each residential property (mm) 每個住宅物業的層與層之間的高度 (毫米)
Roof 天台	A	Not applicable 不適用	Not applicable 不適用
	B	Not applicable 不適用	

The internal areas of the residential properties on the upper floors will generally be slightly larger than those on the lower floors because of the reducing thickness of the structural walls on the upper floors. This situation and section 10(2)(e) of Part 1 of Schedule 1 to the Residential Properties (First-hand Sales) Ordinance is not applicable for this Development.

因住宅物業的較高樓層的結構牆的厚度遞減，較高樓層的內部面積，一般比較低樓層的內部面積稍大。此情況及《一手住宅物業銷售條例》附表1第1部第10(2)(e)條不適用於此發展項目。

Notes:

- The dimensions of the floor plan are all structural dimensions in millimetres.
- Please refer to Pages 34 - 35 of this sales brochure for the legend of the terms and abbreviations shown on the floor plans and remarks that are applicable thereto.
- There may be architectural features on external walls of some residential properties. For details, please refer to the latest approved building plans.
- "Floor-to-floor height" refers to the height between the top surface of the structural slab of floor and the top surface of the structural slab of its immediate upper floor.

附註：

- 樓面平面圖所列之尺寸為以毫米標示之建築結構尺寸。
- 樓面平面圖中顯示之名詞及簡稱之圖例及其適用的附註，請參閱本售樓說明書第34至35頁。
- 部分住宅物業外牆可能設有建築裝飾。詳情請參考最新批准之建築圖則。
- "層與層之間的高度" 指該樓層之石屎地台面與上一層石屎地台面之高度距離。