

19 CROSS-SECTION PLAN OF BUILDING IN THE DEVELOPMENT

發展項目中的建築物的橫截面圖

Cross-section A-A

橫截面圖A-A

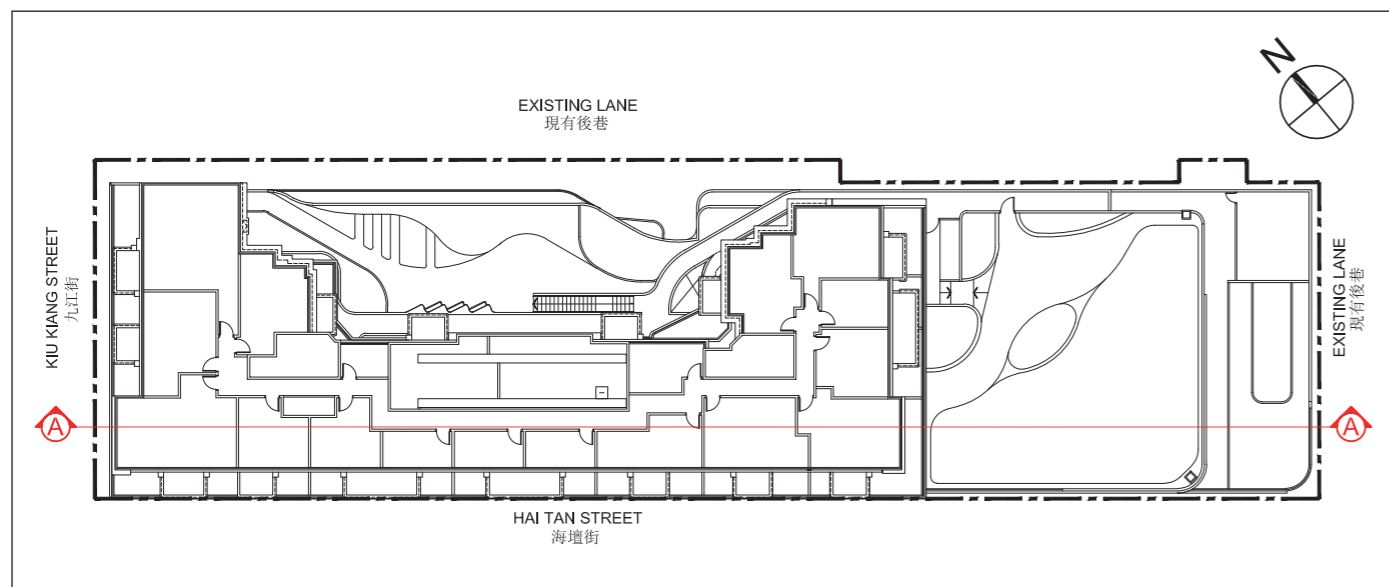

LEGEND 圖例

- Development Boundary
發展項目邊界線
- - - Dotted line denotes the level of the lowest residential floor
虛線為最低住宅樓層水平
- ▽ Height (in metres) above the Hong Kong Principal Datum
香港主水平基準以上高度(米)

KEY PLAN 指示圖

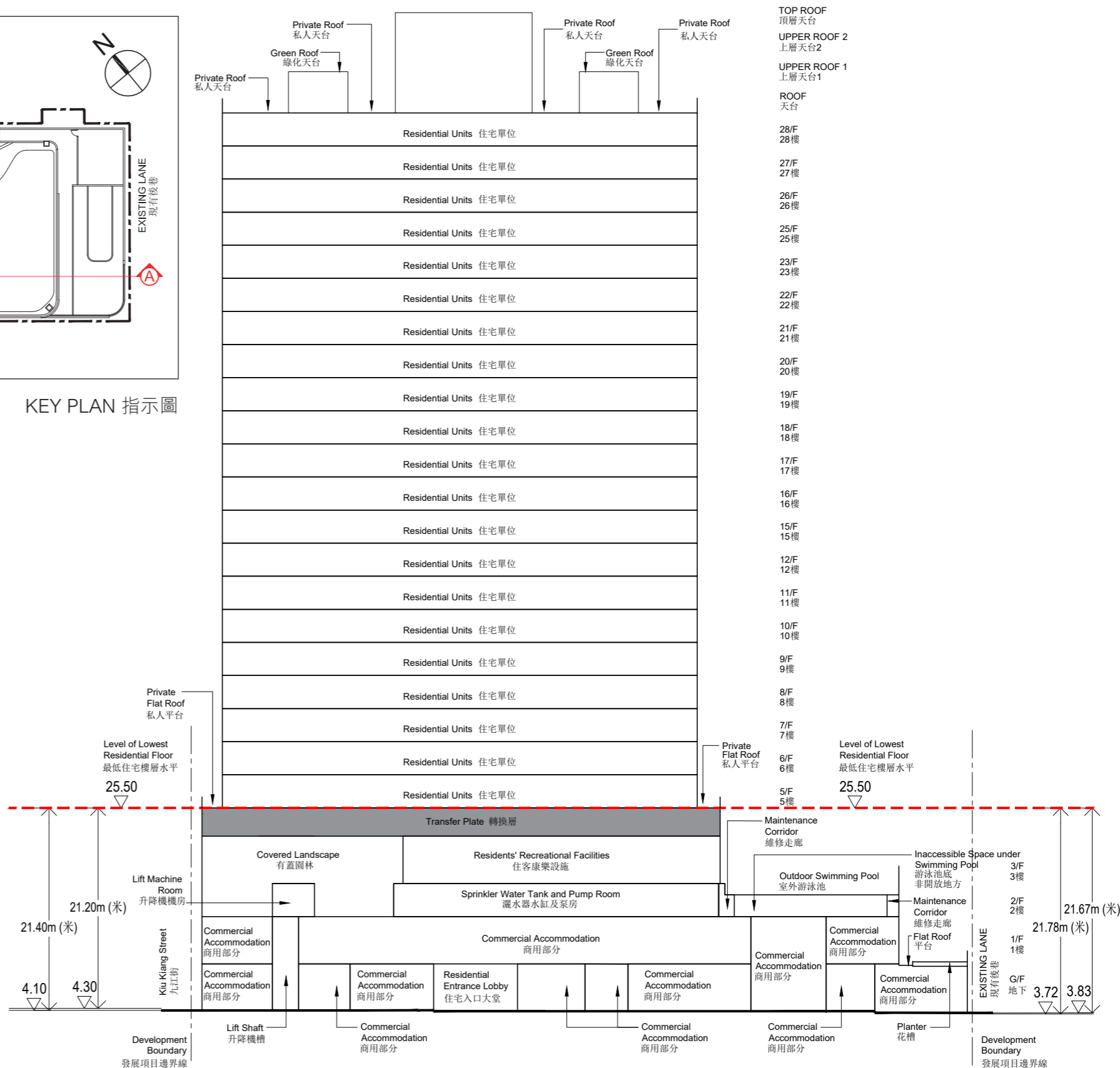

Notes:

1. This cross-section plan is not drawn to scale.
2. The part of Kiu Kiang Street adjacent to north-west side of the Development is 4.10 metres to 4.30 metres above the Hong Kong Principal Datum.
3. The part of existing lane adjacent to south-east side of the Development is 3.72 metres to 3.83 metres above the Hong Kong Principal Datum.

備註:

1. 此橫截面圖並非按照比例繪圖。
2. 毗連發展項目西北面的一段九江街為香港主水平基準以上4.10米至4.30米。
3. 毗連發展項目東南面的一段現有後巷為香港主水平基準以上3.72米至3.83米。

CROSS-SECTION PLAN OF BUILDING IN THE DEVELOPMENT 19

發展項目中的建築物的橫截面圖

Cross-section B-B

橫截面圖 B-B

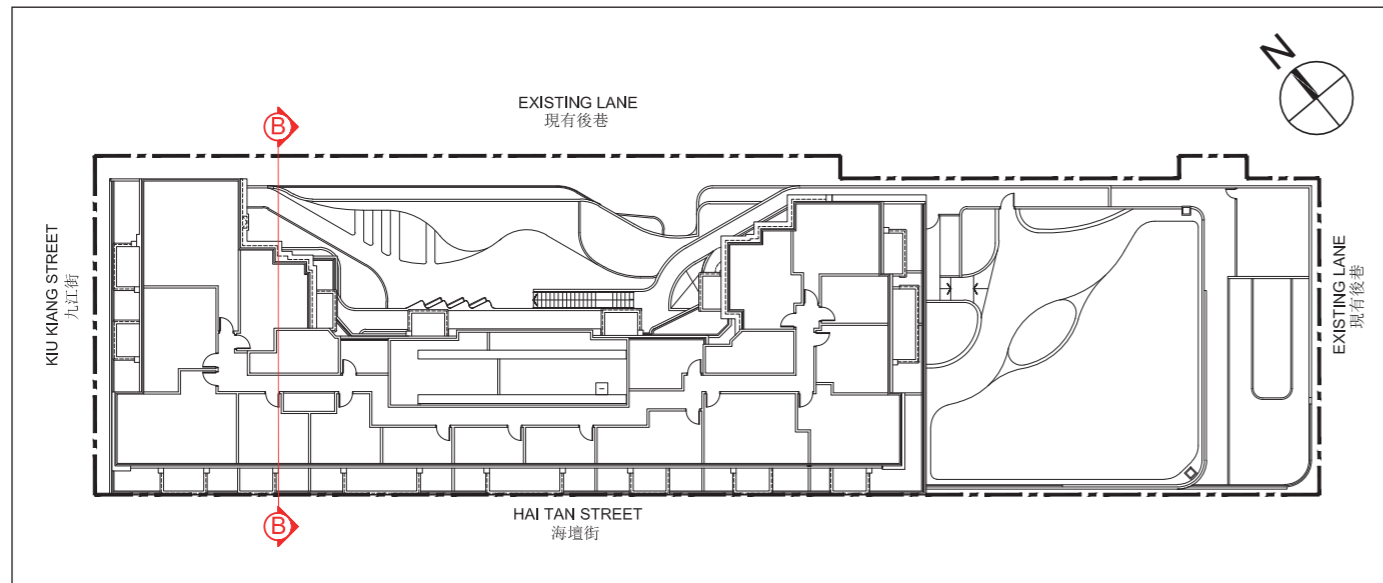

LEGEND 圖例

- Development Boundary 發展項目邊界線
- Dotted line denotes the level of the lowest residential floor 虛線為最低住宅樓層水平
- Height (in metres) above the Hong Kong Principal Datum 香港主水平基準以上高度(米)

KEY PLAN 指示圖

Notes:

1. This cross-section plan is not drawn to scale.
2. The part of existing lane adjacent to north-east side of the Development is 3.72 metres to 4.30 metres above the Hong Kong Principal Datum.
3. The part of Hai Tan Street adjacent to south-west side of the Development is 3.83 metres to 4.10 metres above the Hong Kong Principal Datum.

備註:

1. 此橫截面圖並非按照比例繪圖。
2. 毗連發展項目東北面的一段現有後巷為香港主水平基準以上3.72米至4.30米。
3. 毗連發展項目西南面的一段海壇街為香港主水平基準以上3.83米至4.10米。

