

10 LAYOUT PLAN OF THE DEVELOPMENT 發展項目的布局圖

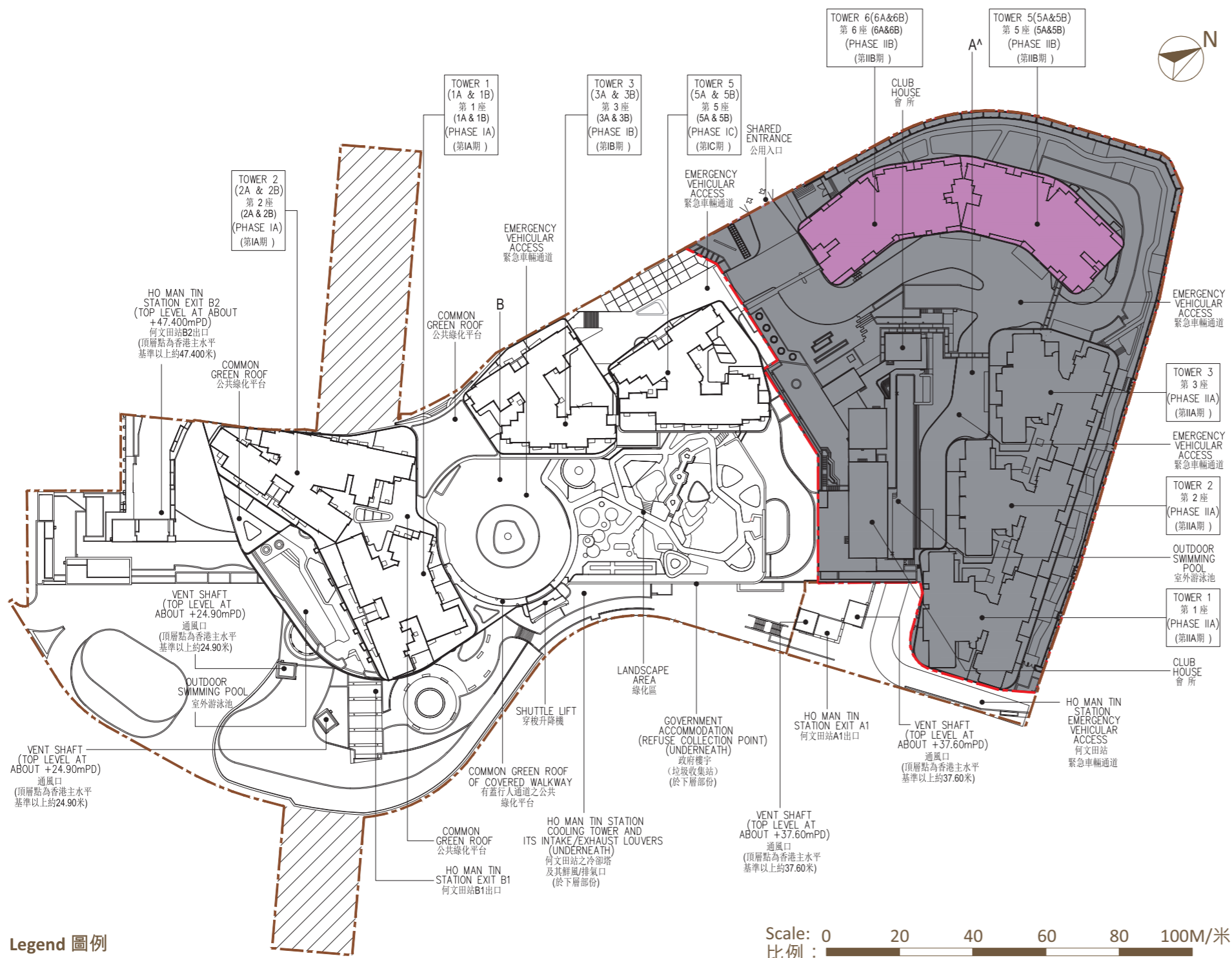

Legend 圖例

Boundary of Site A[^] of Kowloon Inland Lot No. 11264 (excluding station and government accommodation)
九龍內地段第11264號地盤A[^]的界線 (不包括港鐵站及政府樓宇)

The Phase (Coloured Pink)
期數 (塗粉紅色)

Phase IIA of the Development (Coloured Grey)
發展項目的第IIA期 (塗灰色)

Part of Ho Man Tin Station (Between -31.0 mPD and -9.5mPD)
何文田站之部分 (香港主水平基準以上-31.0米與-9.5米之間)

Scale: 0 20 40 60 80 100M/米
比例:

mPD Metres above Hong Kong Principal Datum
香港主水平基準以上高度(米)

- A. The estimated date of completion of The Phase & Phase IIA:
- The estimated date of completion of The Phase (coloured pink on the plan) of Phase II of the Development located in Site A[^] is 31 August 2024 as provided by the authorized person for the said Phase.
 - The estimated date of completion of Phase IIA (coloured grey on the plan) of Phase II of the Development located in Site A[^] is 31 August 2024 as provided by the authorized person for the said Phase.
- B. The estimated date of completion of Phase IA of the Development located in Site B is 10 August 2024 as provided by the authorized person for the said phase. The estimated date of completion of Phase IB of the Development located in Site B is 10 August 2024 as provided by the authorized person for the said phase. The estimated date of completion of Phase IC of the Development located in Site B is 30 October 2024 as provided by the authorized person for the said phase.

- A. 期數及第IIA期的預計落成日期:
- 位於地盤A[^]的發展項目的第II期的期數 (塗粉紅色部分) 的認可人士提供該期數的預計落成日期為2024年8月31日。
 - 位於地盤A[^]的發展項目的第II期的第IIA期 (塗灰色部分) 的認可人士提供該期數的預計落成日期為2024年8月31日。
- B. 位於B地盤的發展項目第IA期的認可人士提供該期數的預計落成日期為2024年8月10日。位於B地盤的發展項目第IB期的認可人士提供該期數的預計落成日期為2024年8月10日。位於B地盤的發展項目第IC期的認可人士提供該期數的預計落成日期為2024年10月30日。

Note:

- There may be future changes to the buildings and facilities in the Development subject to the final approval by the relevant Government authorities.
 - Floodlights will be provided for lighting of the outdoor swimming pools of the Phase and other phases of the Development in the evening. Prospective purchasers please note the impact (if any) of the illumination of such lighting system on individual residential units.
 - Existing cooling tower and its intake/exhaust louvers of Ho Man Tin Station are located below Phase I of the Development. Prospective purchasers please note the impact (if any) of such facilities on individual residential units.
 - Shuttle lift lobby connecting Ho Man Tin Station and residential podium is expected to be available for use estimated material date of Phase IIA (tentatively 31 March 2025).
 - Part of the recreational areas and facilities including, but not limited to, the outdoor and indoor swimming pools will not be available estimated material date of Phase IIA.
 - There are vent shafts of Ho Man Tin Station located within the Development. Prospective purchasers please note the impact (if any) of such vent shafts on individual residential unit.
 - The shared entrance and Emergency Vehicular Access located at Site A[^] shall be completed prior to the estimated date of completion of the Phase.
- [^]Phase II of Ho Man Tin Station Property Development is situated at "Site A[^]" of Kowloon Inland Lot No.11264. Its Chinese name is "朗賢峯" and its English name is "ONMANTIN". Phase IIB forms part of Phase II "ONMANTIN". Phase IIB comprises Tower 5(5A&5B) and Tower 6(6A&6B).

備註:

- 發展項目內的建築物及設施將來可能會有所變化，並以有關政府部門的最終批核為準。
- 期數及發展項目其他期數之室外泳池會裝設泛光燈，以供室外泳池的晚間照明。準買家請注意該等照明系統的照明對個別住宅單位造成的影響 (如有)。
- 何文田站的現有冷卻塔及其鮮風/排氣口位於發展項目的第I期之下。準買家請注意該等設施對個別住宅單位造成的影響 (如有)。
- 連接何文田站與住宅平台的穿梭升降機大堂預計將於第IIA期的預計關鍵日期(暫定為2025年3月31日)或之前開放使用。
- 部分康樂地方與設施 (包括但不限於室外泳池與室內泳池) 將不會於第IIA期的預計關鍵日期前開放使用。
- 發展項目內設有何文田站的通風口。準買家請注意該等通風口對個別住宅單位造成的影響 (如有)。
- 位於地盤A[^]的公用入口及緊急車輛通道須於期數的預計落成日期前落成。
[^]何文田站物業發展項目的第II期，位於九龍內地段第11264號之「地盤A[^]」，中文名稱為「朗賢峯」，英文名稱為「ONMANTIN」。第II期為第II期「朗賢峯」其中一個期數。第II期包括第5座(5A及5B)和第6座(6A及6B)。