

CROSS-SECTION PLAN OF BUILDING IN THE DEVELOPMENT

發展項目中的建築物的橫截面圖

Section A-A 橫截面圖 A-A

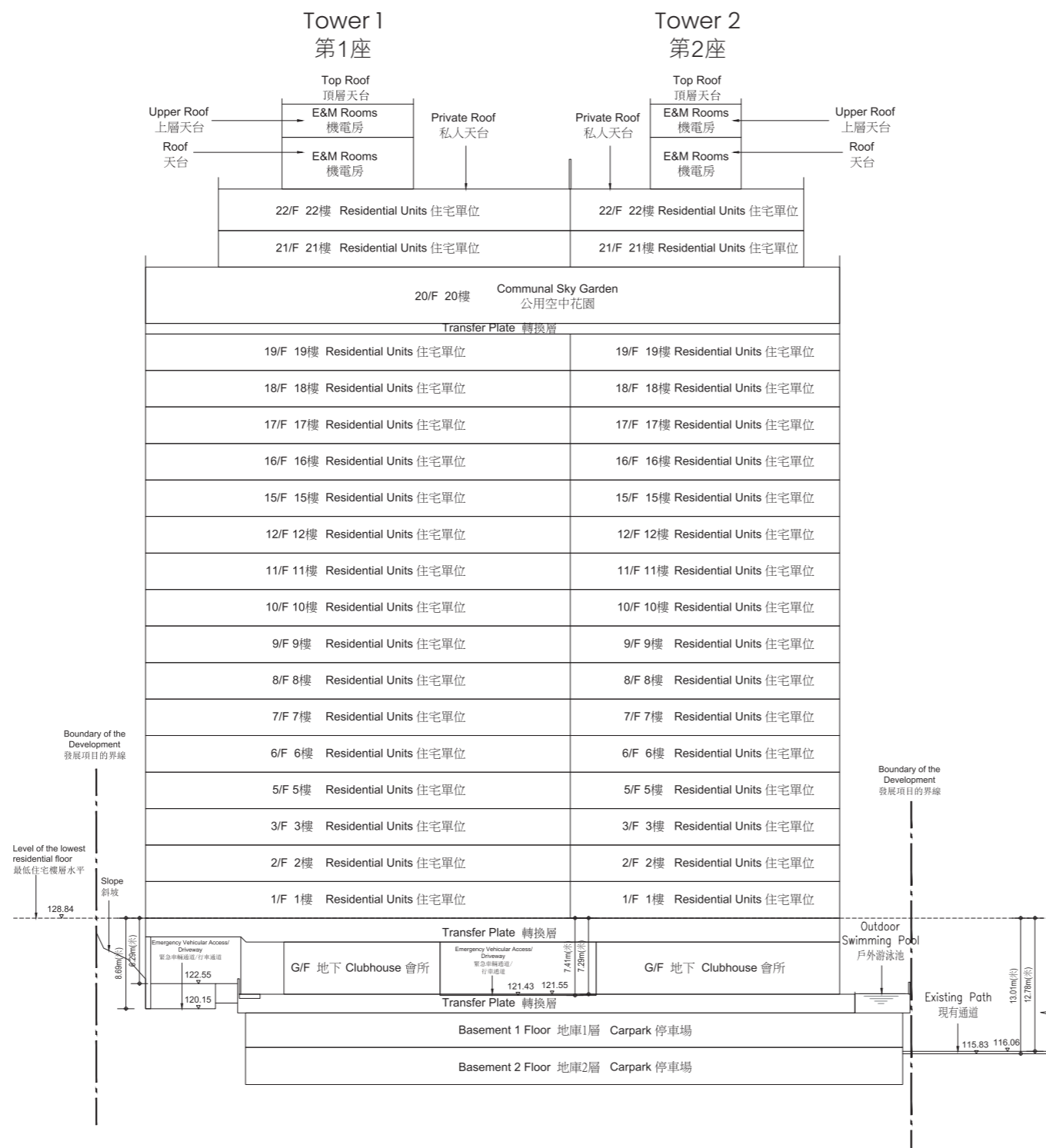

Key Plan 索引圖

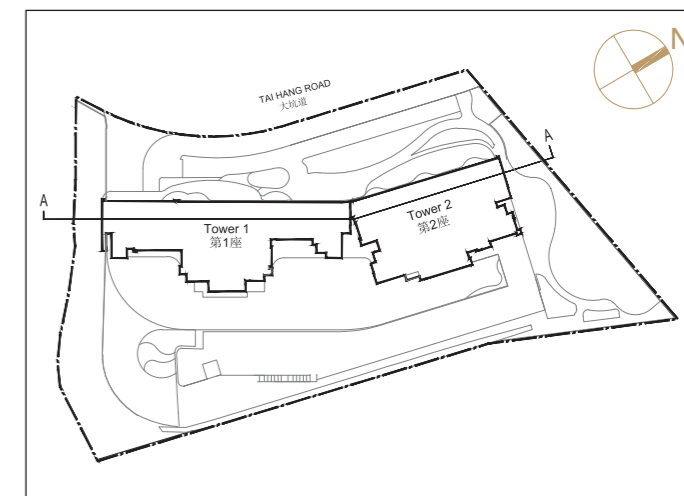

1. The part of Existing Path adjacent to the Tower 2 is 115.83 meters to 116.06 meters above the Hong Kong Principal Datum.
2. The part of Emergency Vehicular Access/Driveway adjacent to the Tower 1 and Tower 2 is 121.43 meters to 121.55 meters above the Hong Kong Principal Datum.
3. The part of Emergency Vehicular Access/Driveway adjacent to the Tower 1 is 120.15 meters to 122.55 meters above the Hong Kong Principal Datum.
4. Dotted line (---) denotes the level of the lowest residential floor.
5. (▽) denotes height (in metres) above the Hong Kong Principal Datum.

1. 毗連第2座一段現有通道為香港主水平基準以上115.83米至116.06米。
2. 毗連第1座及第2座一段緊急車輛通道/行車通道為香港主水平基準以上121.43米至121.55米。
3. 毗連第1座一段緊急車輛通道/行車通道為香港主水平基準以上120.15米至122.55米。
4. 虛線 (---) 為最低住宅樓層水平。
5. (▽)代表香港主水平基準以上的高度 (米)。

CROSS-SECTION PLAN OF BUILDING IN THE DEVELOPMENT

發展項目中的建築物的橫截面圖

Section B-B
橫截面圖 B-B

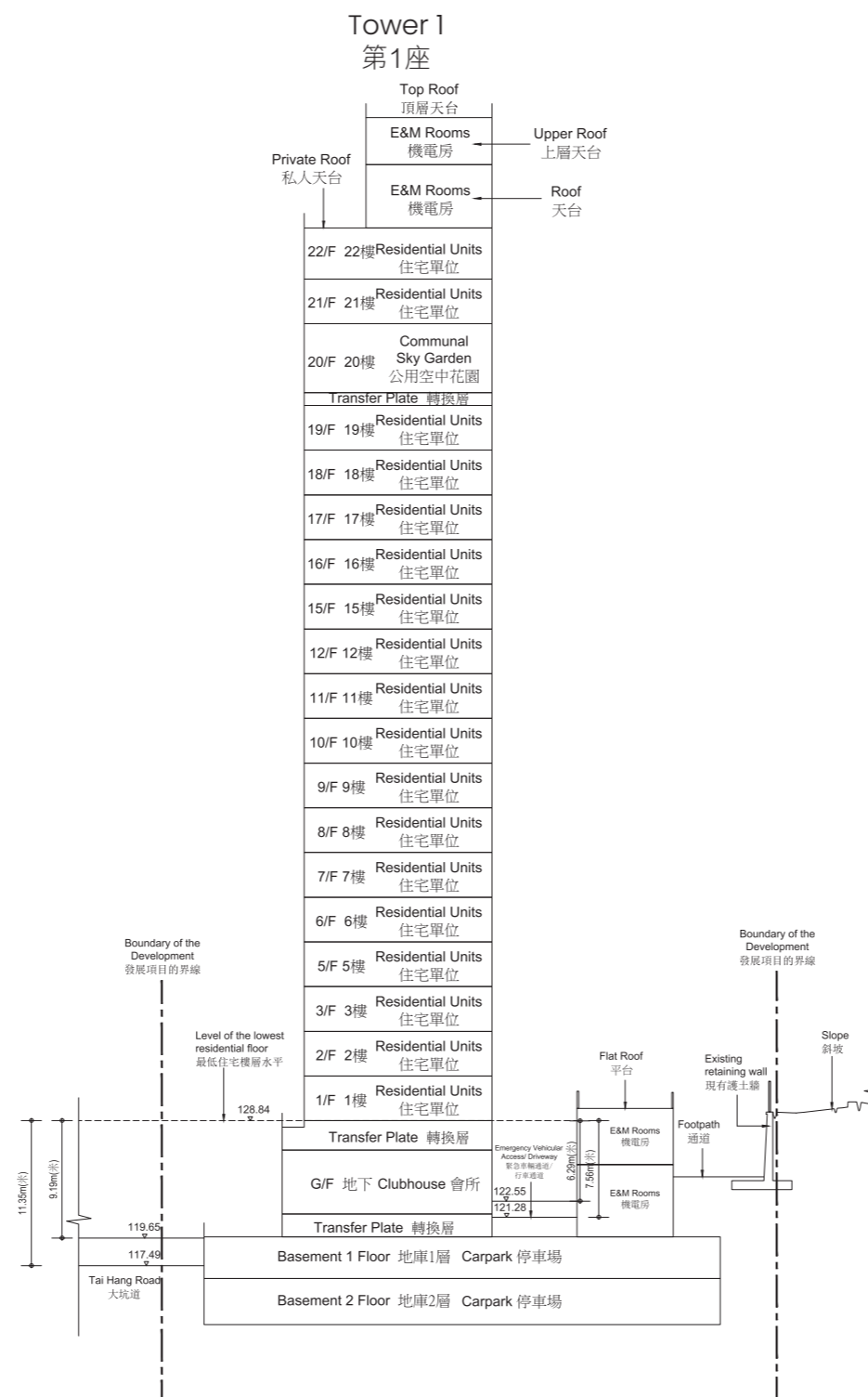

Key Plan
索引圖

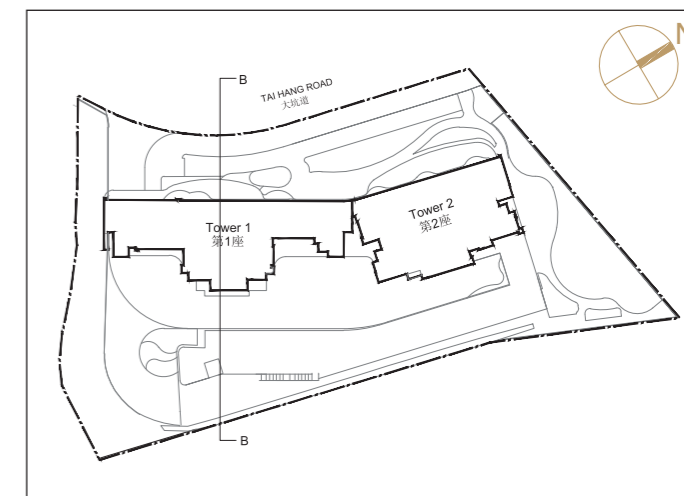

1. The part of Tai Hang Road adjacent to the Tower 1 is 117.49 meters to 119.65 meters above the Hong Kong Principal Datum.
2. The part of Emergency Vehicular Access/Driveway adjacent to the building is 121.28 meters to 122.55 meters above the Hong Kong Principal Datum.
3. Dotted line (---) denotes the level of the lowest residential floor.
4. (▽) denotes height (in metres) above the Hong Kong Principal Datum.

1. 毗連第1座一段大坑道為香港主水平基準以上117.49米至119.65米。
2. 毗連建築物一段緊急車輛通道/行車通道為香港主水平基準以上121.28米至122.55米。
3. 虛線 (---) 為最低住宅樓層水平。
4. (▽) 代表香港主水平基準以上的高度 (米)。

CROSS-SECTION PLAN OF BUILDING IN THE DEVELOPMENT

發展項目中的建築物的橫截面圖

Section C-C
橫截面圖 C-C

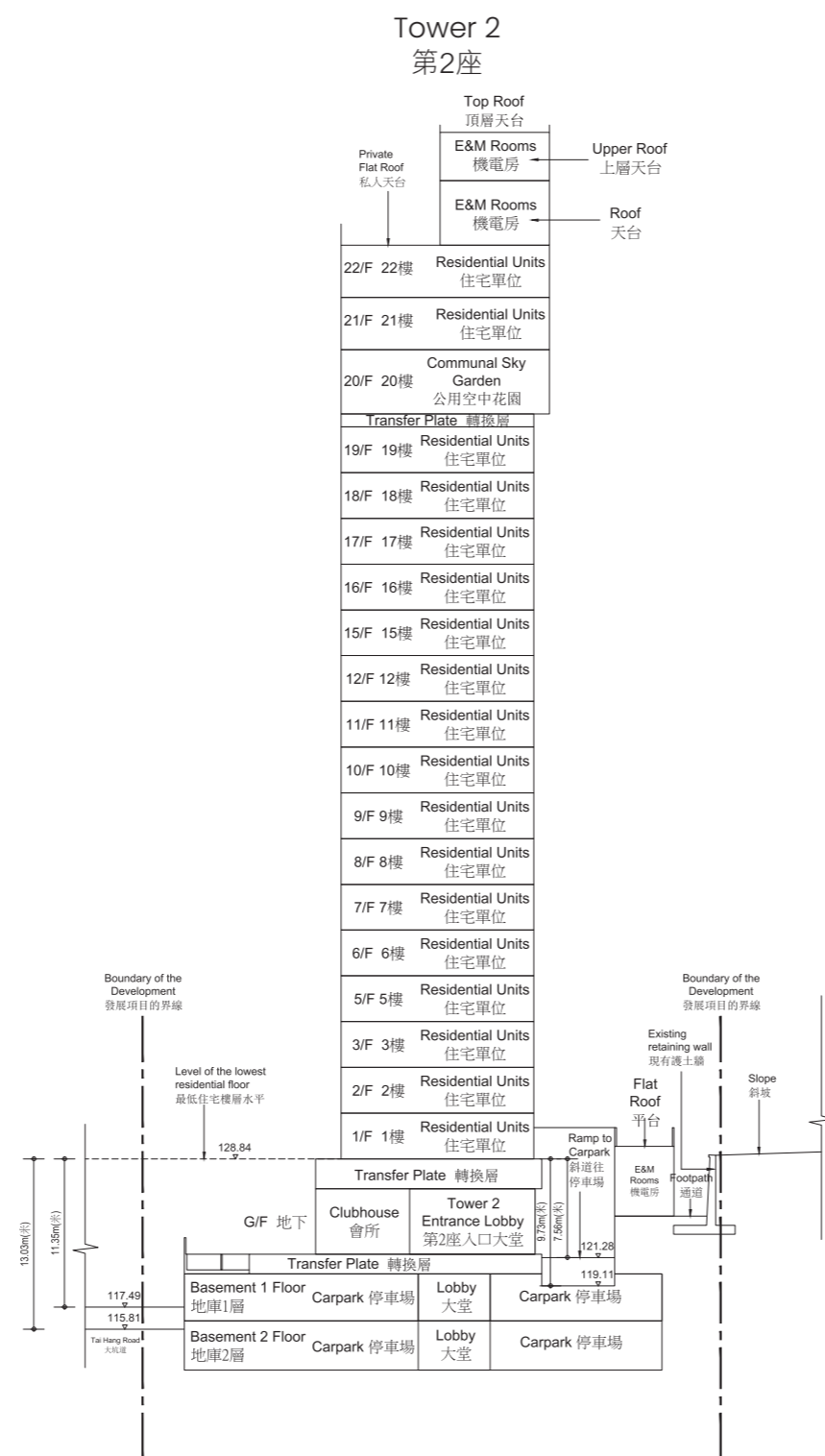

Key Plan
索引圖

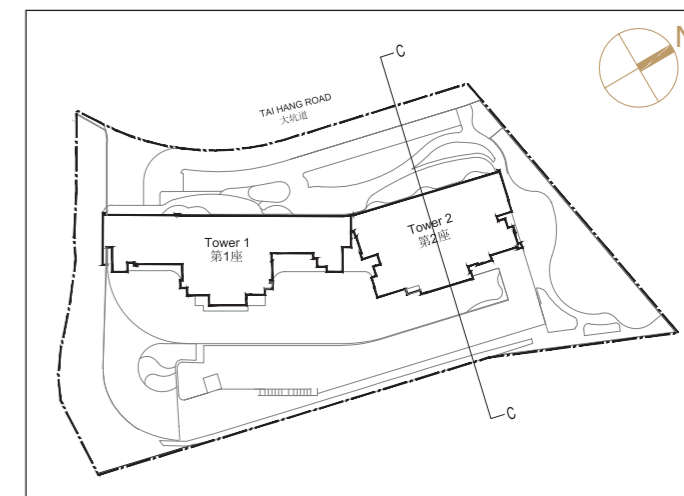

1. The part of Tai Hang Road adjacent to the Tower 2 is 115.81 to 117.49 meters above the Hong Kong Principal Datum.
2. The part of Ramp to Carpark adjacent to the Tower 2 is 119.11 meters 121.28 meters above the Hong Kong Principal Datum.
3. Dotted line (---) denotes the level of the lowest residential floor.
4. (▽) denotes height (in metres) above the Hong Kong Principal Datum.

1. 毗連第2座一段大坑道為香港主水平基準以上115.81米至117.49米。
2. 毗連第2座一段斜道往停車場為香港主水平基準以上119.11米至121.28米。
3. 虛線 (---) 為最低住宅樓層水平。
4. (▽) 代表香港主水平基準以上的高度 (米)。