

11 FLOOR PLANS OF RESIDENTIAL PROPERTIES IN THE DEVELOPMENT

發展項目的住宅物業的樓面平面圖

Legend of terms and abbreviations used on floor plans

樓面平面圖中所使用名詞之簡稱之圖例

BALCONY ABOVE = 上層露台覆蓋之部份

COVER OF U.P. = Cover of Utility Platform = 下層工作平台頂

DN = Down 落

E.M.C. = Electrical Meter Cabinet 電錶櫃

HR = Hose Reel = 消防喉轆

P.D. = Pipe Duct = 管道槽

RS&MRC = Refuse Storage and Material Recovery Cabinet 垃圾及物料回收房

UP = 上

U.P. = Utility Platform = 工作平台

Note:

1. There may be architectural features on external walls of some floors.
2. Common pipes exposed and/or enclosed in cladding are located at/ adjacent to balcony and/or flat roof and/or roof and/or utility platform and/or air-conditioner flatroof and/or external wall of some residential units.
3. There are sunken slabs and/or ceiling bulkheads and/or false ceiling at living rooms, dining rooms, bedrooms, corridors, bathrooms and open kitchens of some residential units for the air-conditioning system and/or mechanical and electrical services.
4. The internal ceiling height within some units may vary due to structural, architectural and/or decoration design variations.
5. Balconies and utility platforms are non-enclosed areas.
6. Symbols of fittings and fitments shown on the floor plans, such as bath tub, sink, water closets, shower, sink counter, cooking bench etc, are architectural symbols extracted from the latest approved general building plans and are for
7. [□] Dotted line in a residential unit with Open Kitchen delineates the extent of the Open Kitchen area.

備註：

1. 部份樓層外牆或設有建築裝飾。
2. 部分住宅單位的露台及 / 或平台及 / 或天台及 / 或工作平台及 / 或空調機平台及 / 或外牆或其鄰近地方 設有外露及 / 或藏於覆蓋層板的公用喉管。
3. 部份住宅單位客廳、飯廳、睡房、走廊、浴室及開放式廚房設有跌級樓板及 / 或天花假陣及 / 或假天花，用以裝置空調系統及 / 或機電設備。
4. 部份單位之室內天花高度將會因應結構、建築及 / 或裝修設計上的需要而有差異。
5. 露台及工作平台為不可封閉的地方。
6. 樓面平面圖上所顯示的形象裝置符號，例如浴缸、洗滌盆、坐廁、花灑、洗滌盆櫃、灶台等乃摘自最新的經批准的建築圖則的建築圖示，只作一般性標誌。
7. [□] 有開放式廚房的住宅單位 所顯示的虛線代表開放式廚房的範圍。

11 FLOOR PLANS OF RESIDENTIAL PROPERTIES IN THE DEVELOPMENT

發展項目的住宅物業的樓面平面圖

5th Floor Plan 5樓平面圖

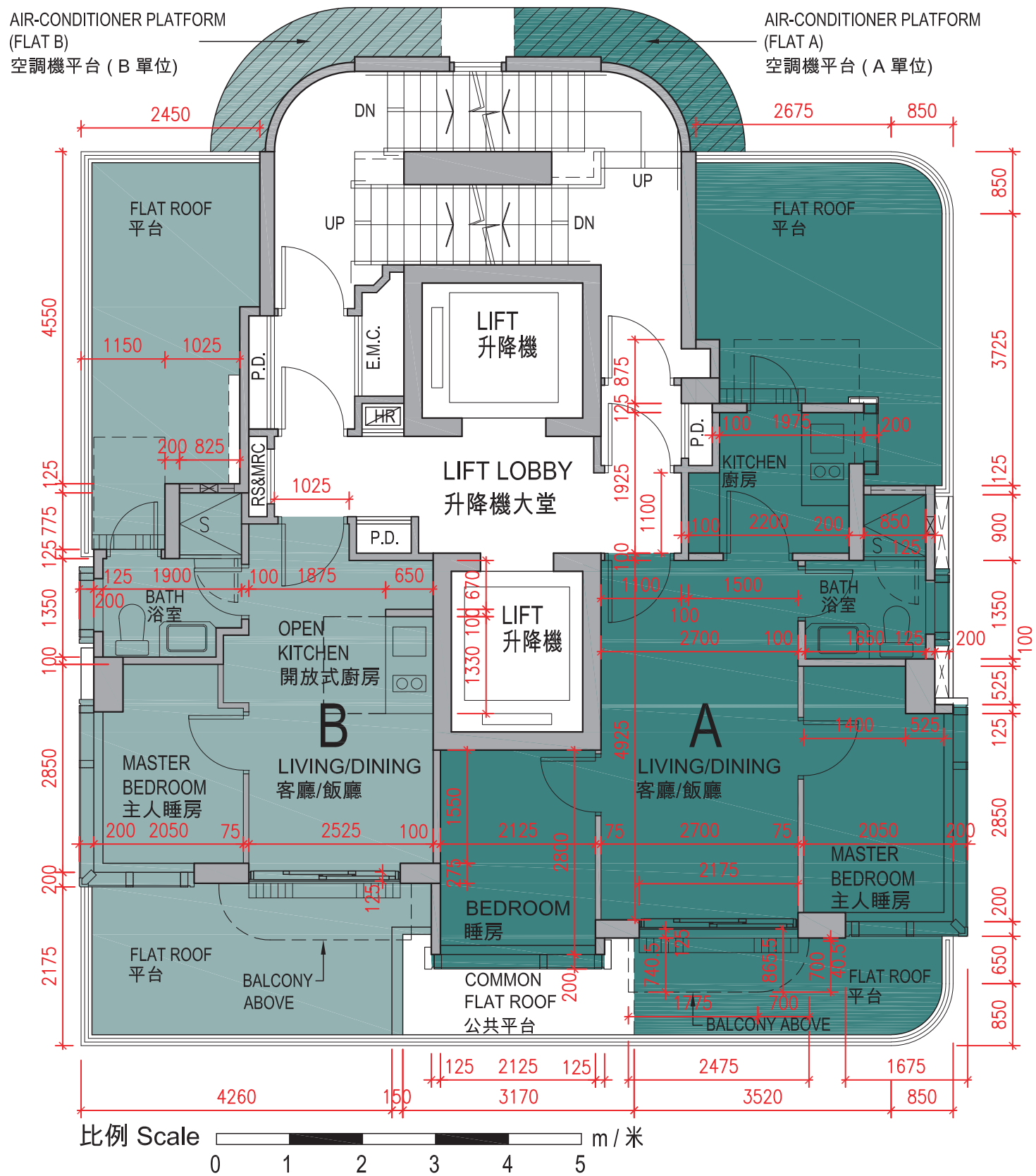

Remark:

* Alterations have been made by exempted works under buildings Ordinance.

備註：

* 因施行《建築物條例》豁免條例的工程條例而有所改動。

Description 描述	Flat 單位	
	A	B
Floor-to-floor height (refers to the height between the top surface of the structural slab of a floor and the top surface of the structural slab of its immediate upper floor) of each residential property (mm). 每個住宅物業的層與層之間的高度 (指該樓層之石屎地台面與上一層石屎地台面之高度距離) (毫米)。	3325	
Thickness of the floor slabs (excluding plaster) of each residential property (mm). 每個住宅物業的樓板 (不包括灰泥) 厚度 (毫米)。	300, 150	

Note:

- (a) The dimensions of floor plans are all structural dimensions in millimetres.
- (b) Please refer to page 20 of this sales brochure for remarks, legend of the terms and abbreviations shown on the floor plan.

備註：

- (a) 樓面平面圖尺寸所列的數字為以毫米標示的建築結構尺寸。
- (b) 有關樓面平面圖中顯示的附註名詞及簡稱之註釋，請參閱本售樓說明書第 20 頁。

11 FLOOR PLANS OF RESIDENTIAL PROPERTIES IN THE DEVELOPMENT

發展項目的住宅物業的樓面平面圖

6th-12th & 15th-21st Floor Plan (13th & 14th floor skipped)
6樓至12樓及15樓至21樓平面圖（不設13樓及14樓）

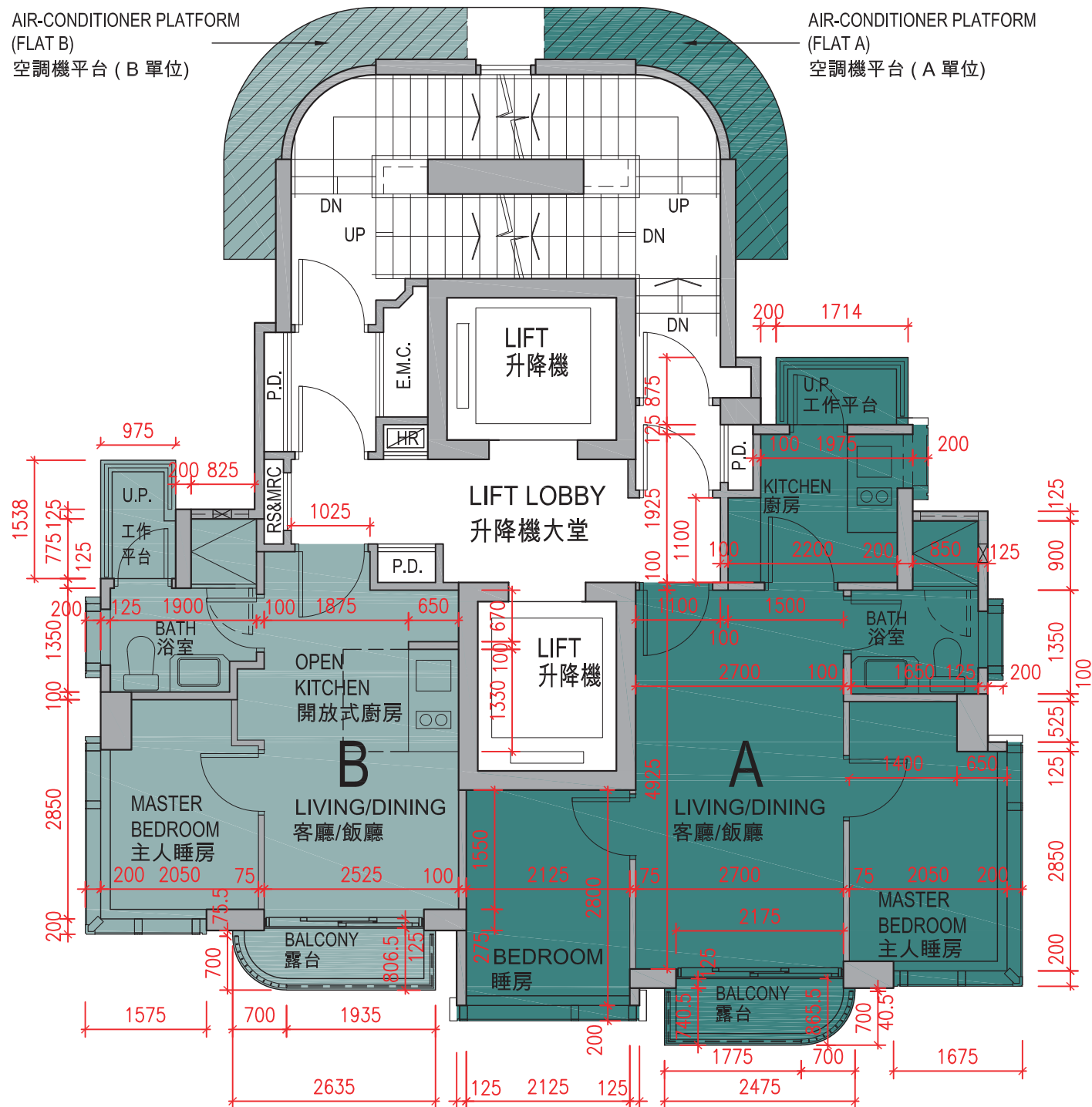
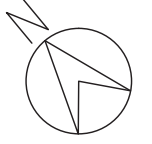

比例 Scale 0 1 2 3 4 5 m / 米

Remark:

* Alterations have been made by exempted works under buildings Ordinance.

備註：

* 因施行《建築物條例》豁免條例的工程條例而有所改動。

Description 描述	Flat 單位	
	A	B
Floor-to-floor height (refers to the height between the top surface of the structural slab of a floor and the top surface of the structural slab of its immediate upper floor) of each residential property (mm). 每個住宅物業的層與層之間的高度（指該樓層之石屎地台面與上一層石屎地台面之高度距離）（毫米）。	3325	
Thickness of the floor slabs (excluding plaster) of each residential property (mm). 每個住宅物業的樓板（不包括灰泥）厚度（毫米）。	300, 150	

Note:

- (a) The dimensions of floor plans are all structural dimensions in millimetres.
- (b) Please refer to page 20 of this sales brochure for remarks, legend of the terms and abbreviations shown on the floor plan.

備註：

- (a) 樓面平面圖尺寸所列的數字為以毫米標示的建築結構尺寸。
- (b) 有關樓面平面圖中顯示的附註名詞及簡稱之註釋，請參閱本售樓說明書第20頁。

11 FLOOR PLANS OF RESIDENTIAL PROPERTIES IN THE DEVELOPMENT

發展項目的住宅物業的樓面平面圖

22nd Floor Plan 22 樓平面圖

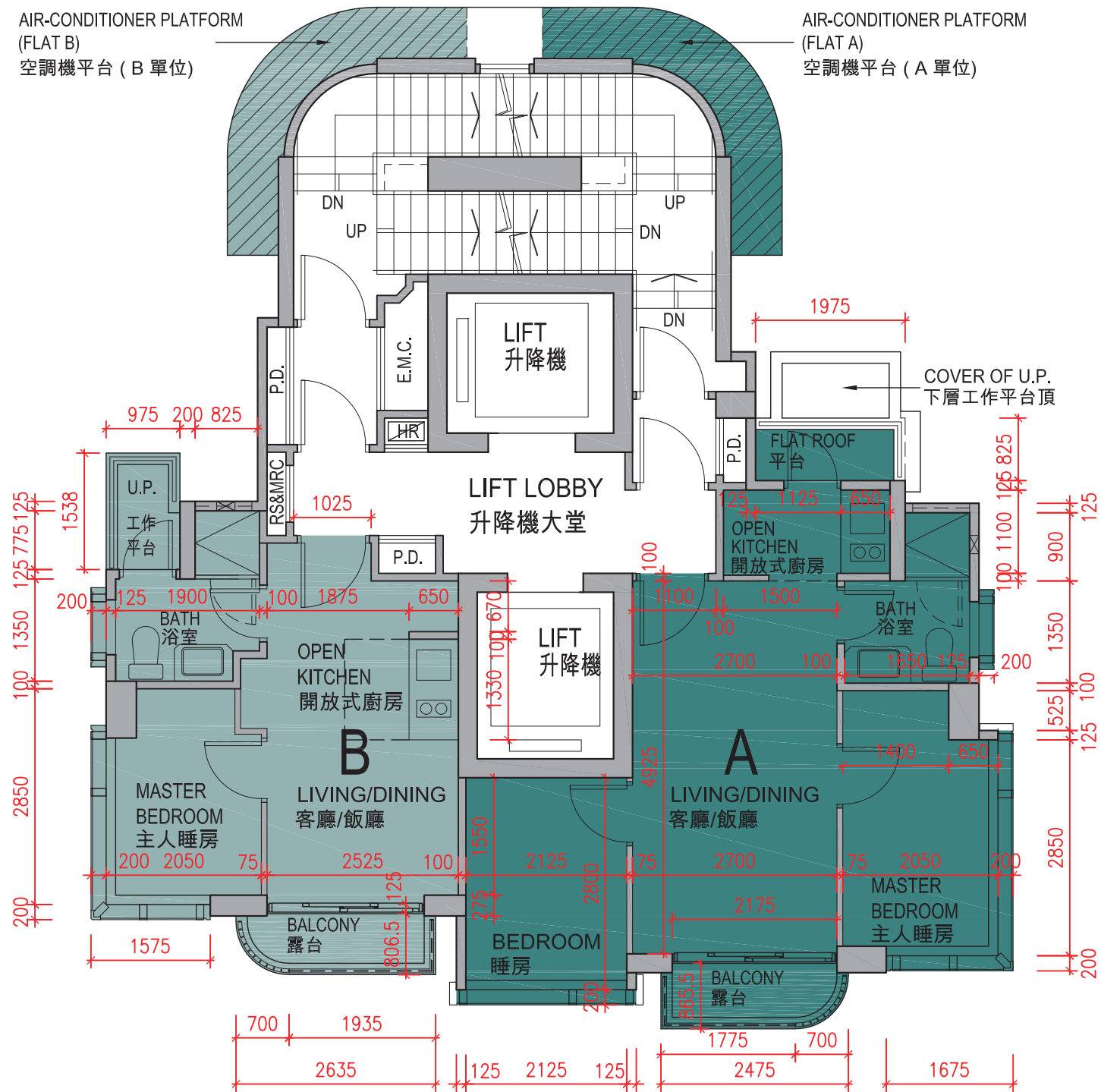

比例 Scale 0 1 2 3 4 5 m / 米

Remark:

* Alterations have been made by exempted works under buildings Ordinance.

備註:

* 因施行《建築物條例》豁免條例的工程條例而有所改動。

Description 描述	Flat 單位	
	A	B
Floor-to-floor height (refers to the height between the top surface of the structural slab of a floor and the top surface of the structural slab of its immediate upper floor) of each residential property (mm). 每個住宅物業的層與層之間的高度 (指該樓層之石屎地台面與上一層石屎地台面之高度距離) (毫米)。	3325	
Thickness of the floor slabs (excluding plaster) of each residential property (mm). 每個住宅物業的樓板 (不包括灰泥) 厚度 (毫米)。	300, 150	

Note:

- (a) The dimensions of floor plans are all structural dimensions in millimetres.
- (b) Please refer to page 20 of this sales brochure for remarks, legend of the terms and abbreviations shown on the floor plan.

備註:

- (a) 樓面平面圖尺寸所列的數字為以毫米標示的建築結構尺寸。
- (b) 有關樓面平面圖中顯示的附註名詞及簡稱之註釋，請參閱本售樓說明書第 20 頁。

11 FLOOR PLANS OF RESIDENTIAL PROPERTIES IN THE DEVELOPMENT

發展項目的住宅物業的樓面平面圖

23rd Floor & 25th-28th Floor Plan (24th floor skipped)

23樓及25樓至28樓平面圖（不設24樓）

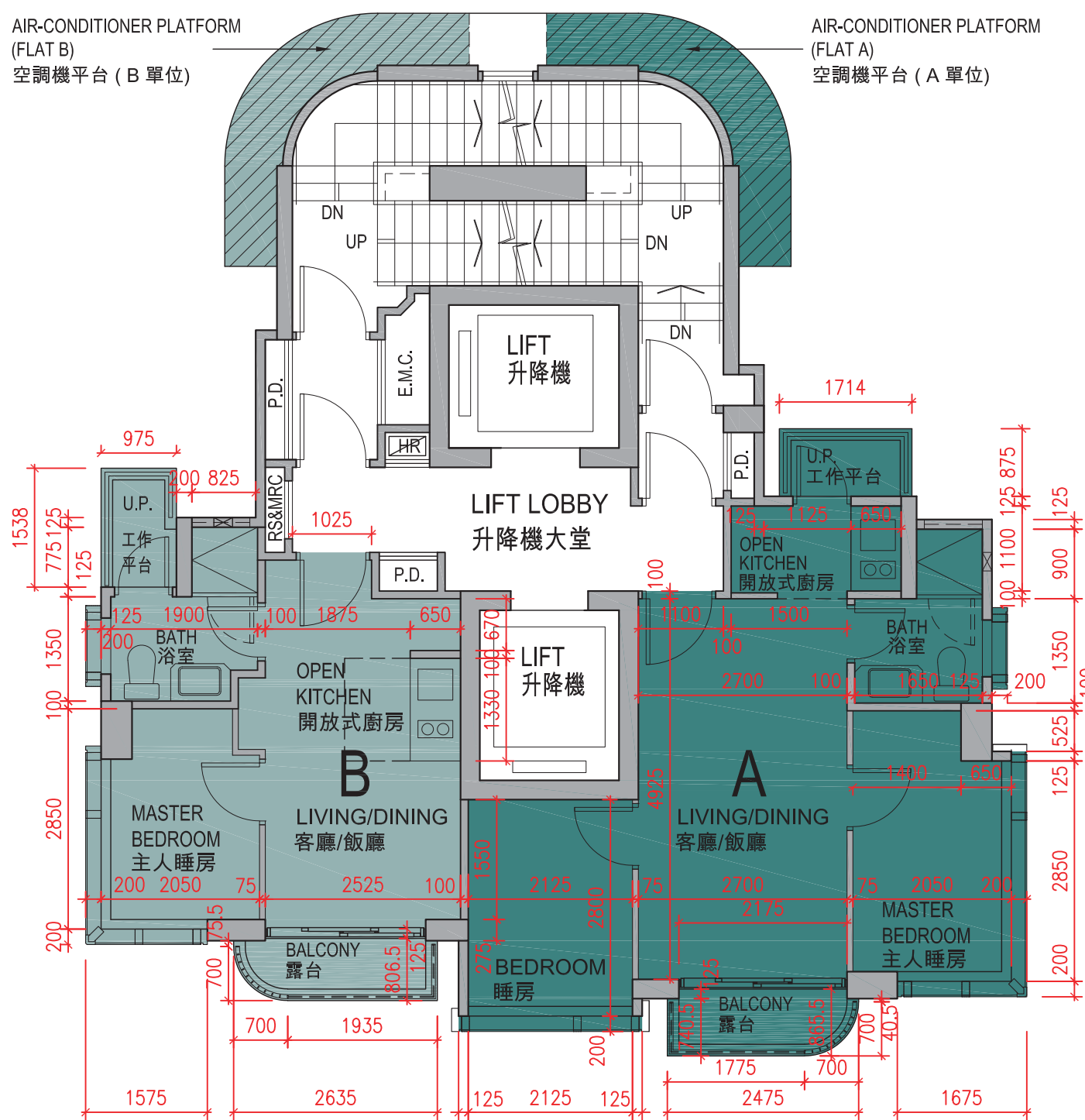

比例 Scale m / 米

Remark:

* Alterations have been made by exempted works under buildings Ordinance.

備註：

* 因施行《建築物條例》豁免條例的工程條例而有所改動。

Description 描述	Flat 單位	
	A	B
Floor-to-floor height (refers to the height between the top surface of the structural slab of a floor and the top surface of the structural slab of its immediate upper floor) of each residential property (mm). 每個住宅物業的層與層之間的高度（指該樓層之石屎地台面與上一層石屎地台面之高度距離）（毫米）。	3325	
Thickness of the floor slabs (excluding plaster) of each residential property (mm). 每個住宅物業的樓板（不包括灰泥）厚度（毫米）。	300, 150	

Note:

- (a) The dimensions of floor plans are all structural dimensions in millimetres.
- (b) Please refer to page 20 of this sales brochure for remarks, legend of the terms and abbreviations shown on the floor plan.

備註：

- (a) 樓面平面圖尺寸所列的數字為以毫米標示的建築結構尺寸。
- (b) 有關樓面平面圖中顯示的附註名詞及簡稱之註釋，請參閱本售樓說明書第20頁。