

19 CROSS-SECTION PLAN OF BUILDING IN THE DEVELOPMENT 發展項目中的建築物的橫截面圖

CROSS-SECTION PLAN A-A 橫截面圖 A-A

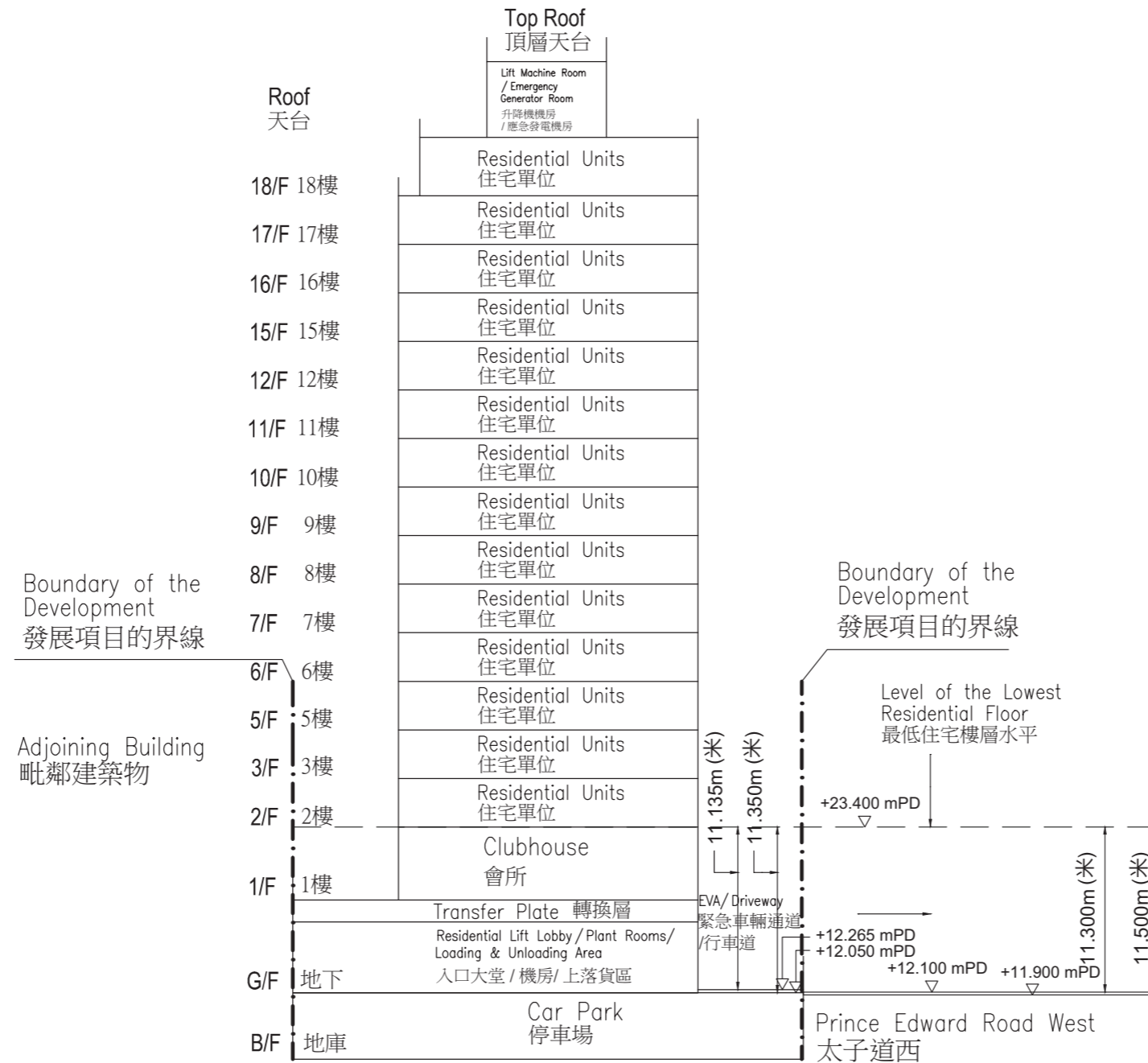

CROSS-SECTION PLAN A-A 橫截面圖 A-A

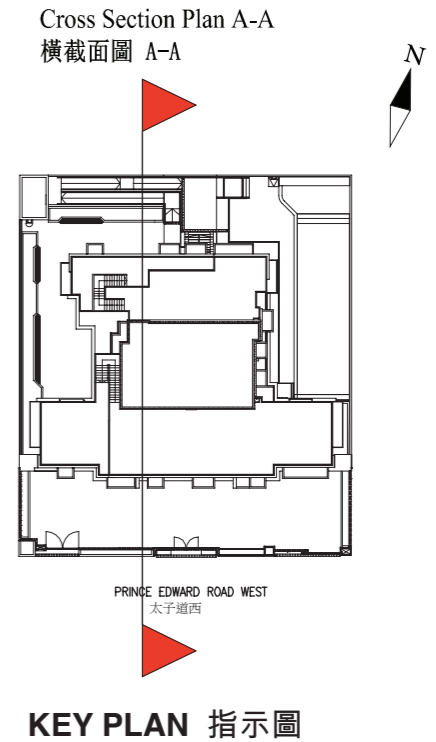

Notes:

1. The part of Prince Edward Road West adjacent to the building is 11.900 metres to 12.100 metres above the Hong Kong Principal Datum.
2. The part of emergency vehicular access / driveway adjacent to the building is 12.050 metres to 12.265 metres above the Hong Kong Principal Datum.
3. —▽— Height in metres above Hong Kong Principal Datum (HKPD).
4. - - - Dotted line denotes the lowest residential floor.
5. EVA=Emergency Vehicular Access

備註：

1. 毗連建築物的一段太子道西為香港主水平基準以上11.900米至12.100米。
2. 毗連建築物的一段緊急車輛通道/行車道為香港主水平基準以上12.050米至12.265米。
3. —▽— 香港主水平基準以上的高度(米)。
4. - - - 虛線為最低住宅樓層水平。
5. EVA=緊急車輛通道