

CROSS-SECTION PLAN OF BUILDING IN THE DEVELOPMENT

發展項目中的建築物的橫截面圖

House A - Cross Section Plan
洋房 A - 橫截面圖

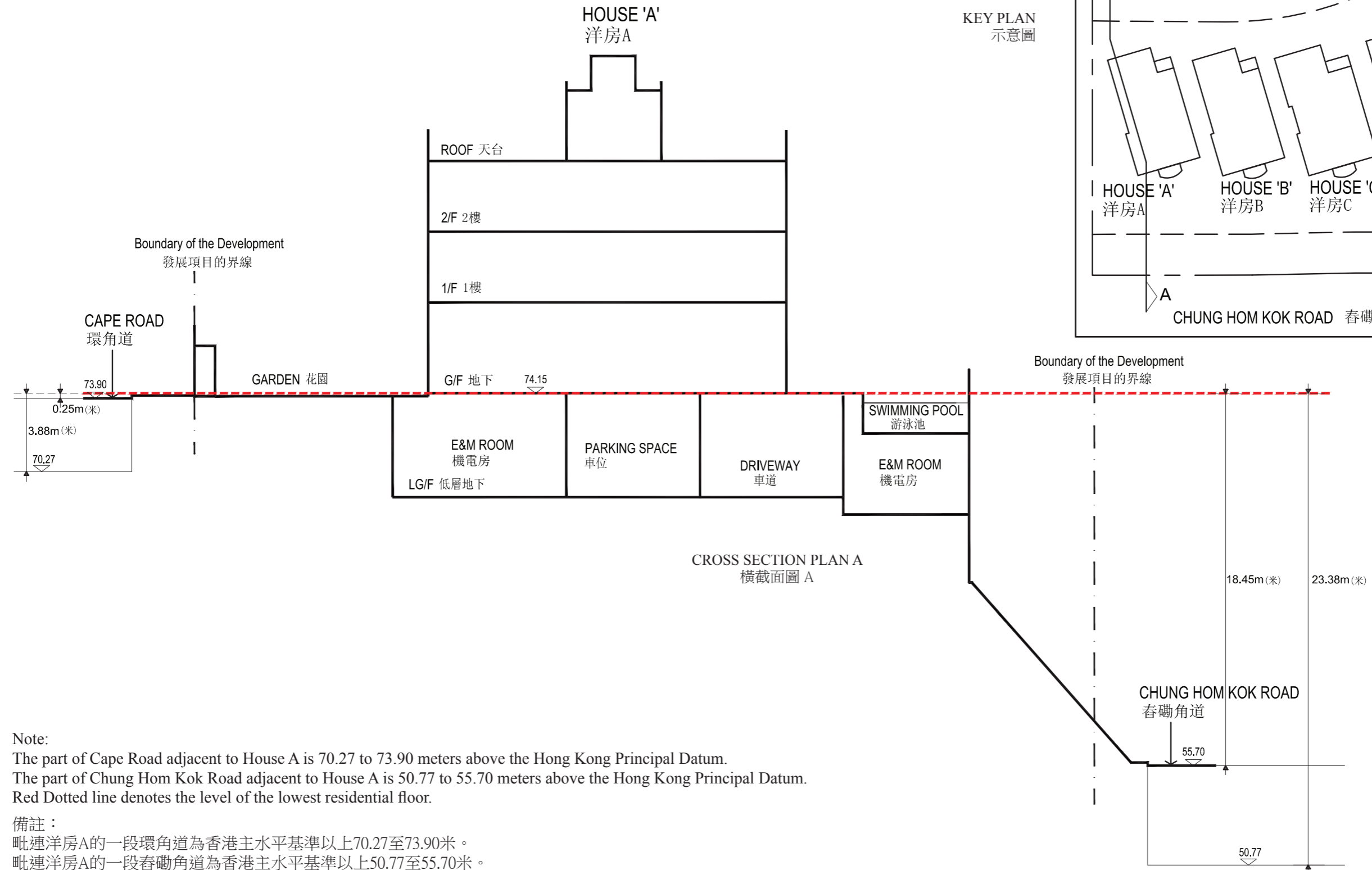

KEY PLAN
示意圖

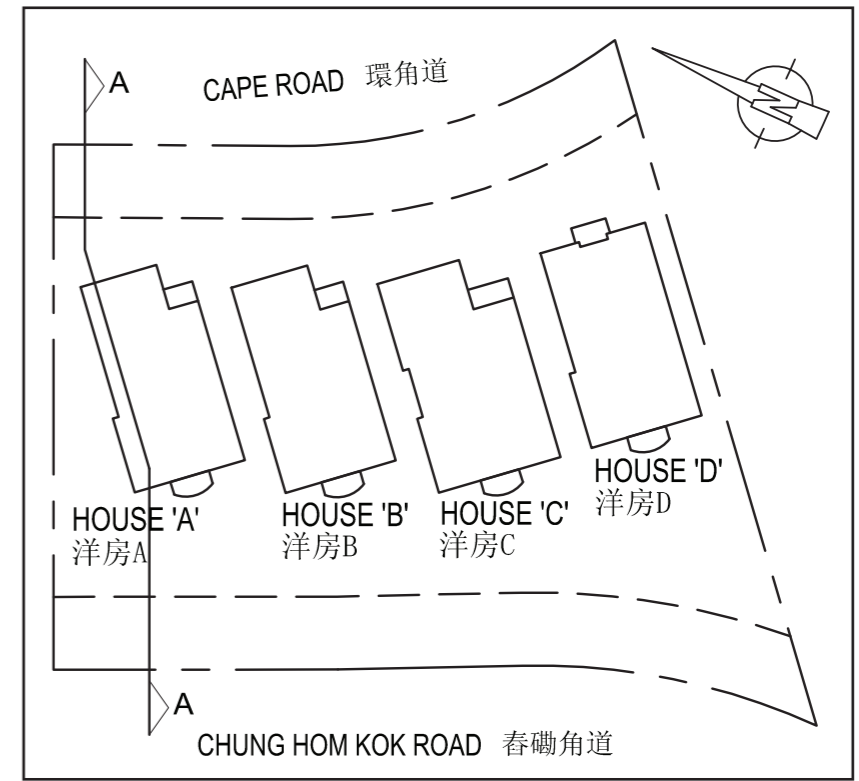

Note:
The part of Cape Road adjacent to House A is 70.27 to 73.90 meters above the Hong Kong Principal Datum.
The part of Chung Hom Kok Road adjacent to House A is 50.77 to 55.70 meters above the Hong Kong Principal Datum.
Red Dotted line denotes the level of the lowest residential floor.

備註：
毗連洋房A的一段環角道為香港主水平基準以上70.27至73.90米。
毗連洋房A的一段春磡角道為香港主水平基準以上50.77至55.70米。
紅色虛線為最低住宅樓層水平。

CROSS-SECTION PLAN OF BUILDING IN THE DEVELOPMENT

發展項目中的建築物的橫截面圖

House B - Cross Section Plan
洋房 B - 橫截面圖

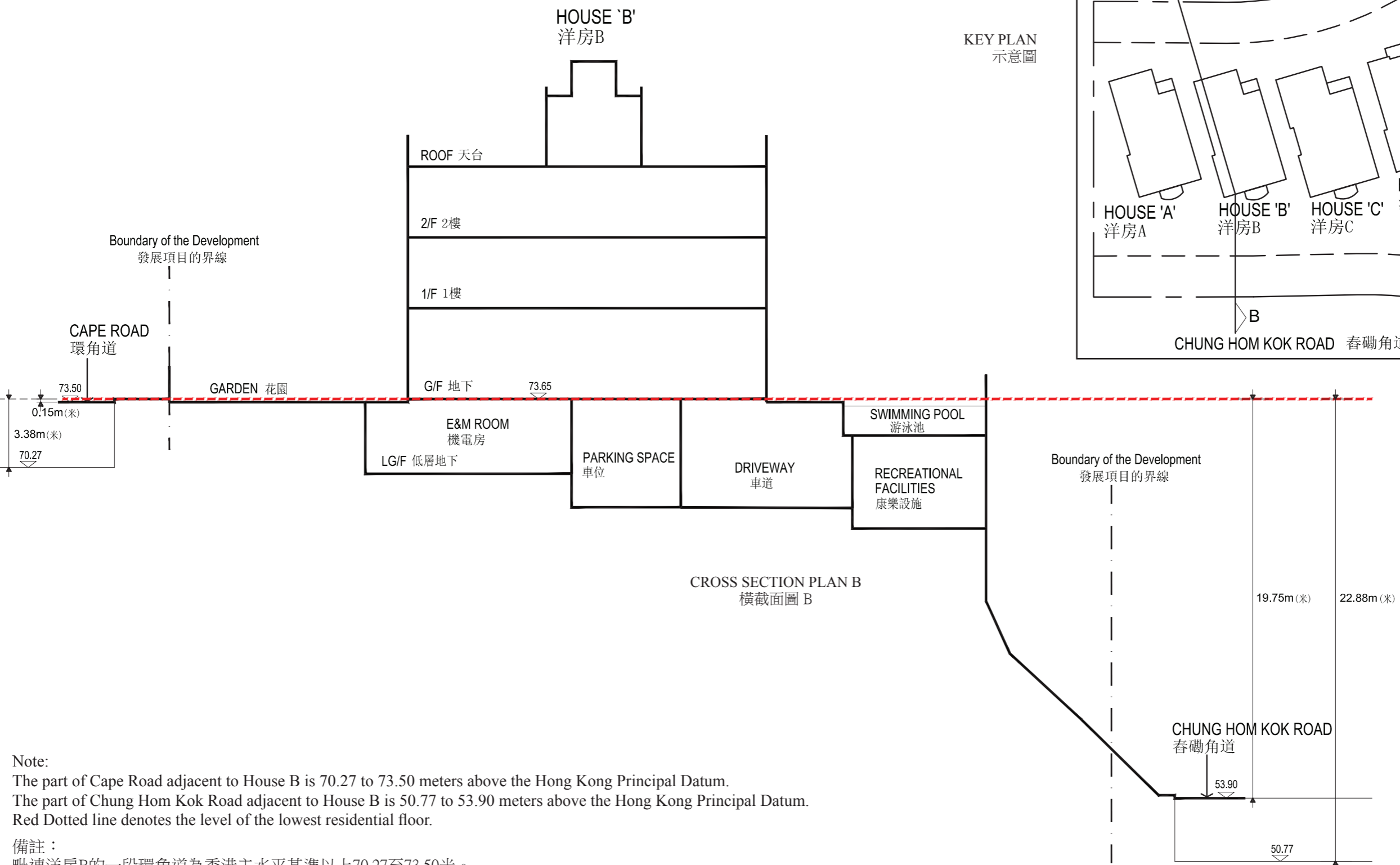

Note:
The part of Cape Road adjacent to House B is 70.27 to 73.50 meters above the Hong Kong Principal Datum.
The part of Chung Hom Kok Road adjacent to House B is 50.77 to 53.90 meters above the Hong Kong Principal Datum.
Red Dotted line denotes the level of the lowest residential floor.

備註：
毗連洋房B的一段環角道為香港主水平基準以上70.27至73.50米。
毗連洋房B的一段春磡角道為香港主水平基準以上50.77至53.90米。
紅色虛線為最低住宅樓層水平。

KEY PLAN
示意圖

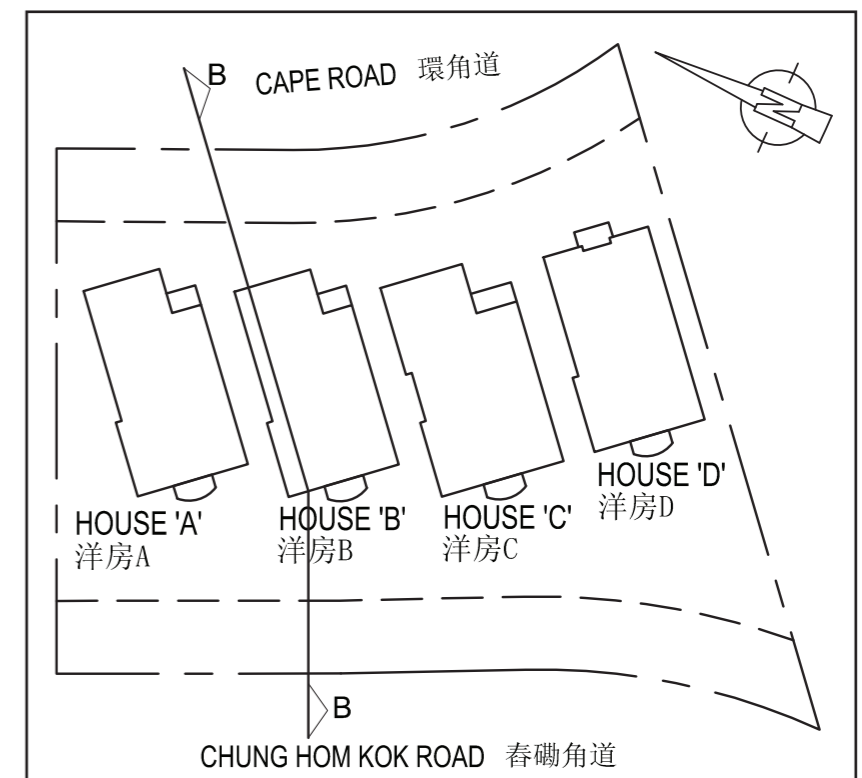

CROSS-SECTION PLAN OF BUILDING IN THE DEVELOPMENT

發展項目中的建築物的橫截面圖

House C - Cross Section Plan
洋房 C - 橫截面圖

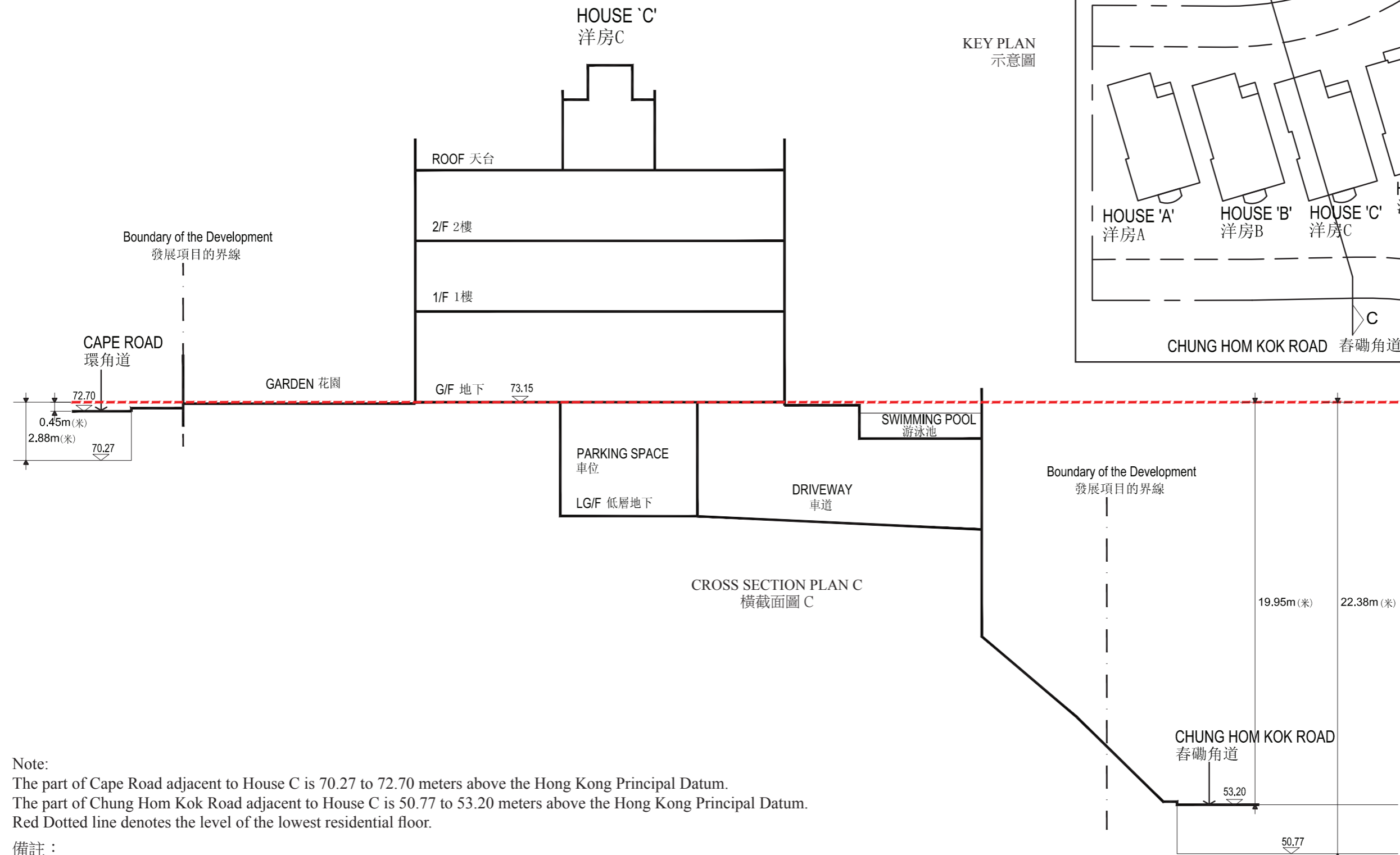

Note:
The part of Cape Road adjacent to House C is 70.27 to 72.70 meters above the Hong Kong Principal Datum.
The part of Chung Hom Kok Road adjacent to House C is 50.77 to 53.20 meters above the Hong Kong Principal Datum.
Red Dotted line denotes the level of the lowest residential floor.

備註：
毗連洋房C的一段環角道為香港主水平基準以上70.27至72.70米。
毗連洋房C的一段春磡角道為香港主水平基準以上50.77至53.20米。
紅色虛線為最低住宅樓層水平。

KEY PLAN
示意圖

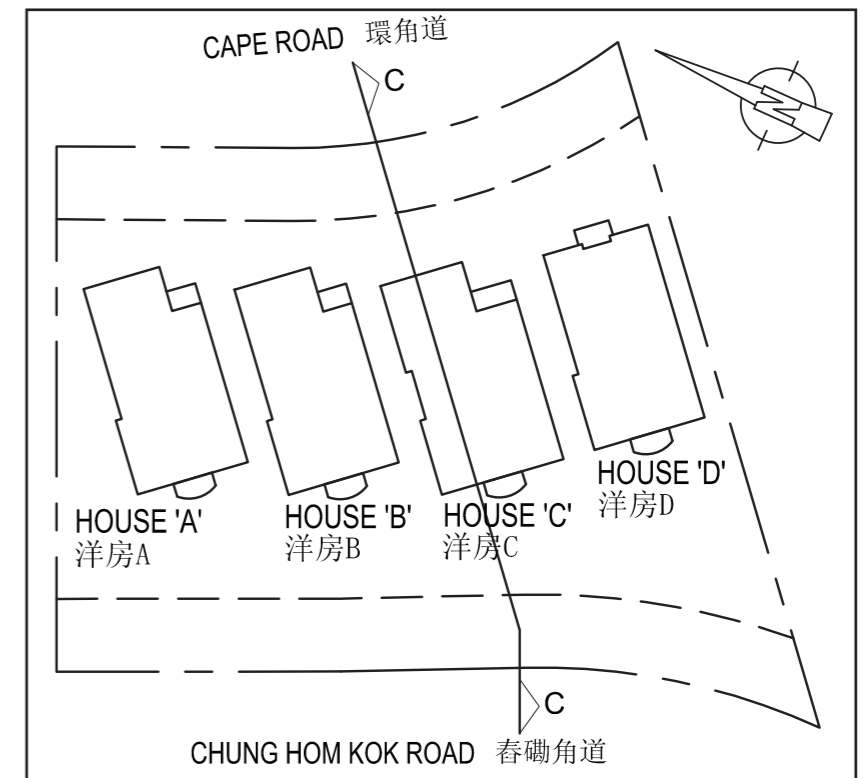

CROSS-SECTION PLAN OF BUILDING IN THE DEVELOPMENT

發展項目中的建築物的橫截面圖

House D - Cross Section Plan
洋房D - 橫截面圖

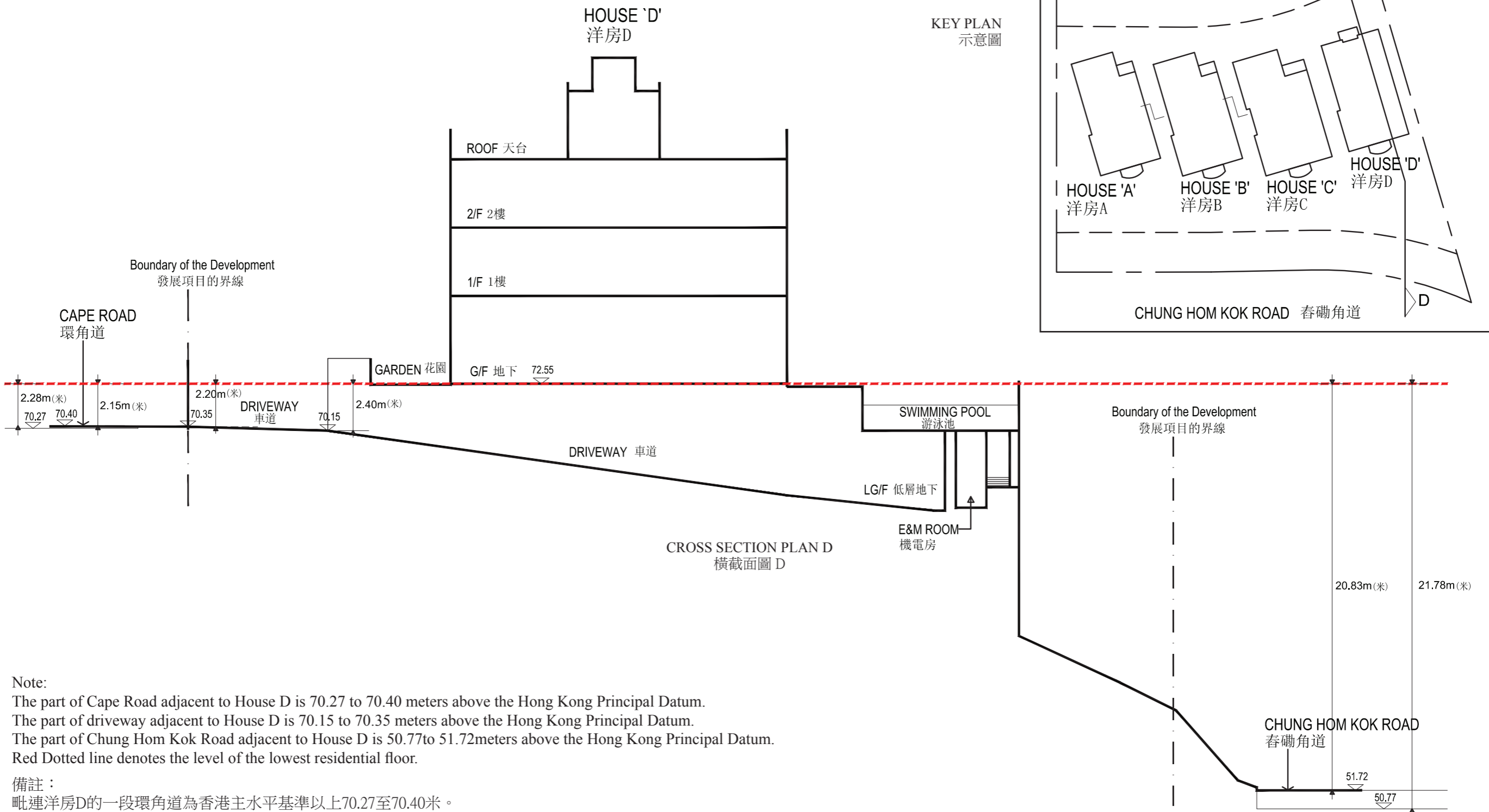

Note:
The part of Cape Road adjacent to House D is 70.27 to 70.40 meters above the Hong Kong Principal Datum.
The part of driveway adjacent to House D is 70.15 to 70.35 meters above the Hong Kong Principal Datum.
The part of Chung Hom Kok Road adjacent to House D is 50.77 to 51.72 meters above the Hong Kong Principal Datum.
Red Dotted line denotes the level of the lowest residential floor.

備註：
毗連洋房D的一段環角道為香港主水平基準以上70.27至70.40米。
毗連洋房D的一段車道為香港主水平基準以上70.15至70.35米。
毗連洋房D的一段春磡角道為香港主水平基準以上50.77至51.72米。
紅色虛線為最低住宅樓層水平。

CROSS-SECTION PLAN OF BUILDING IN THE DEVELOPMENT

發展項目中的建築物的橫截面圖

House A, B, C & D - Cross Section Plan
洋房 A、B、C及D - 橫截面圖

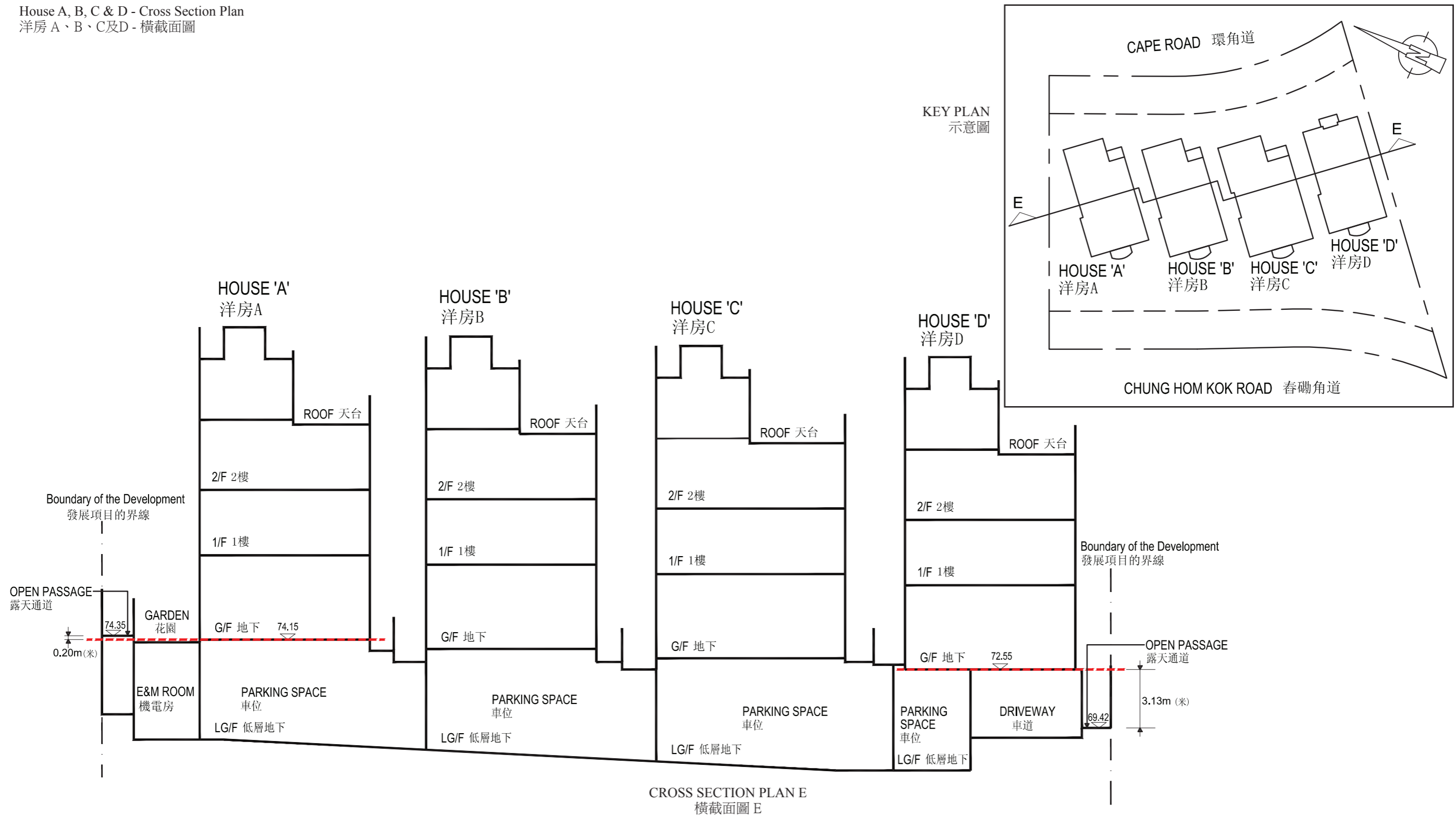

Note:
The part of Open Passage adjacent to House A is 74.35 meters above the Hong Kong Principal Datum.
The part of Open Passage adjacent to House D is 69.42 meters above the Hong Kong Principal Datum.
Red Dotted line denotes the level of the lowest residential floor.

備註：
毗連洋房A的一段露天通道為香港主水平基準以上74.35米。
毗連洋房D的一段露天通道為香港主水平基準以上69.42米。
紅色虛線為最低住宅樓層水平。