

橫截面圖 A  
Cross-section plan A

第2座(2A、2B及2C)  
Tower 2 (2A, 2B & 2C)

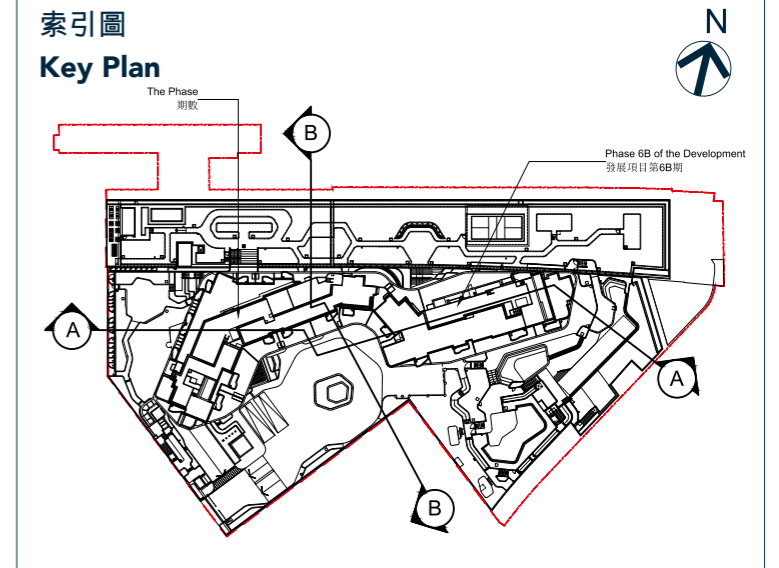
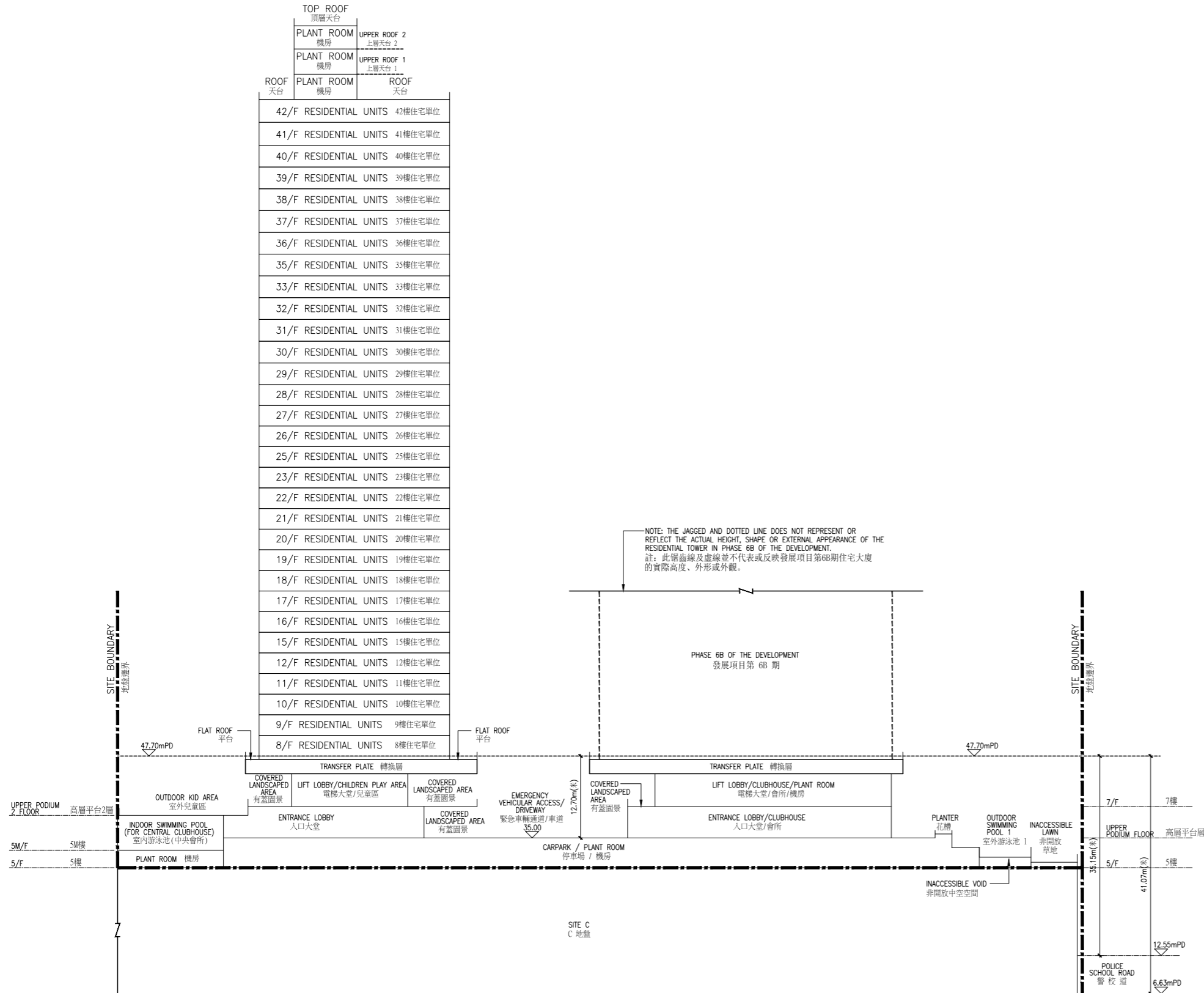

備註：

1. (-----) 虛線為該建築物最低住宅樓層水平。
2. (▽) 指香港主水平基準以上高度(米)。
3. 毗連建築物的一段警校道為香港主水平基準以上6.63米至12.55米。
4. 毗連建築物的一段緊急車輛通道/車道為香港主水平基準以上35.00米。
5. 不設4樓、6樓、13樓、14樓、24樓及34樓。

Notes:

1. (-----) Dotted line denotes the level of the lowest residential floor of the building.
2. (▽) denote height (in meters) above the Hong Kong Principal Datum (HKPD).
3. The part of Police School Road adjacent to the building is 6.63 metres to 12.55 metres above the Hong Kong Principal Datum.
4. The part of Emergency Vehicular Access/Driveway adjacent to the building is 35.00 metres above the Hong Kong Principal Datum.
5. 4/F, 6/F, 13/F, 14/F, 24/F and 34/F are omitted.

橫截面圖 B  
Cross-section plan B

第2座(2C)  
Tower 2 (2C)

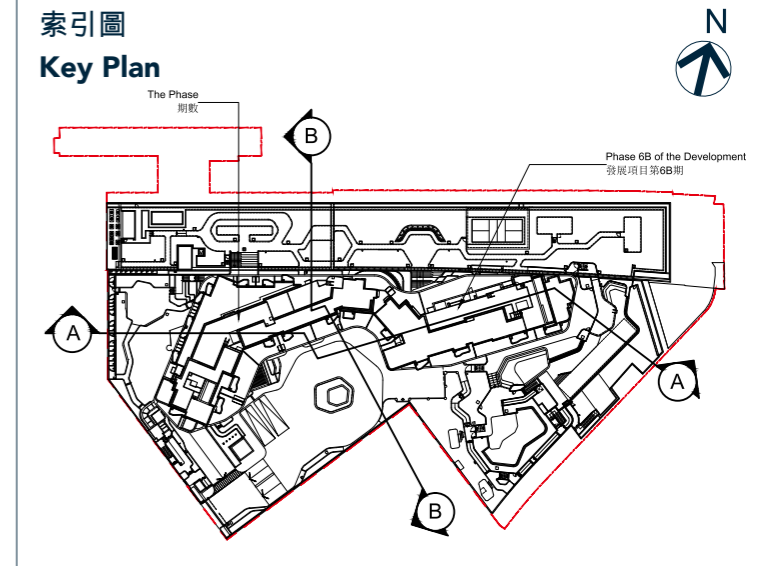
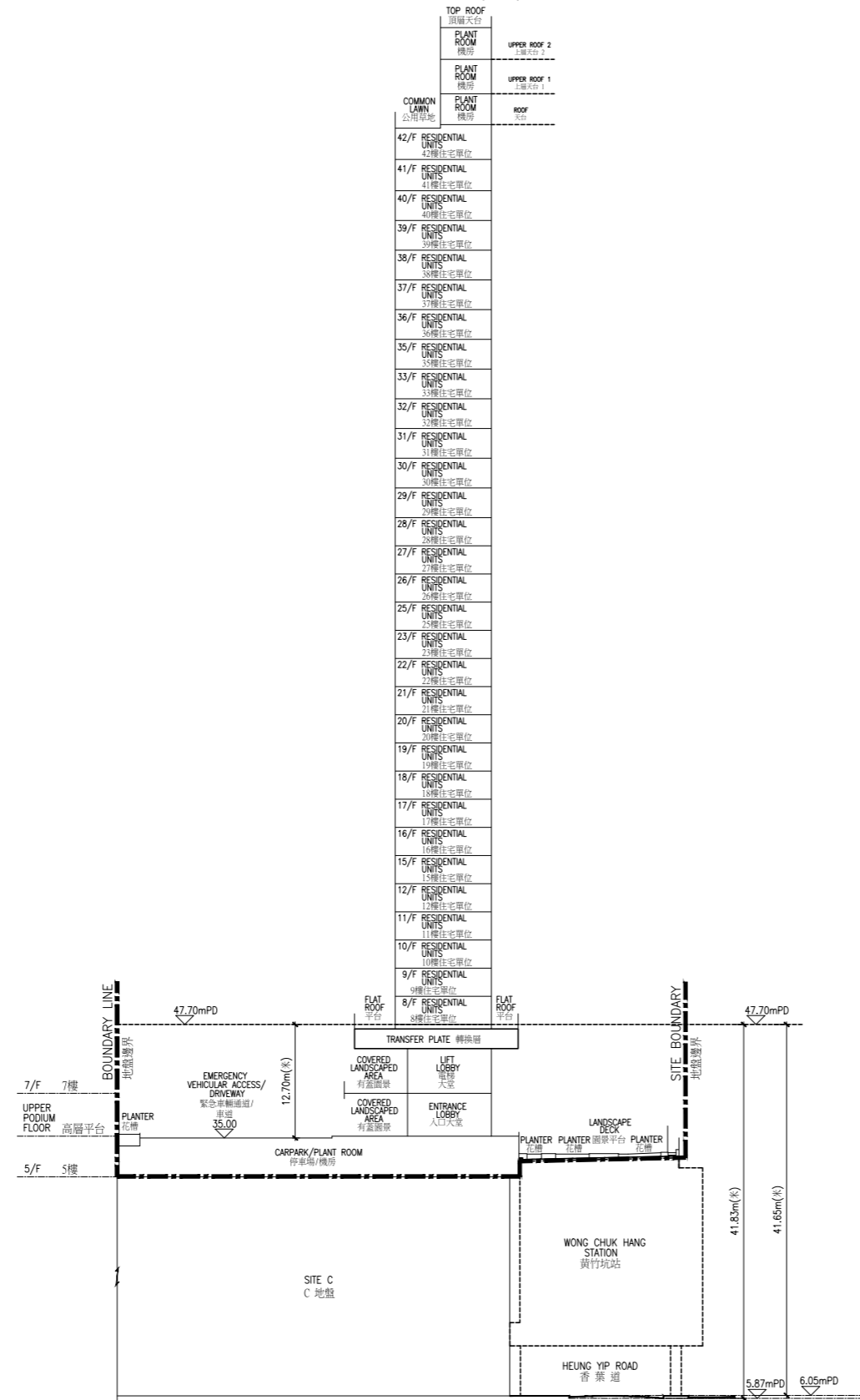

備註：

- (-----)虛線為該建築物最低住宅樓層水平。
- (▽)指香港主水平基準以上高度(米)。
- 毗連建築物的一段緊急車輛通道/車道為香港主水平基準以上35.00米。
- 毗連建築物的一段香葉道為香港主水平基準以上5.87米至6.05米。
- 不設4樓、6樓、13樓、14樓、24樓及34樓。

Notes:

- (-----) Dotted line denotes the level of the lowest residential floor of the building.
- (▽) denote height (in meters) above the Hong Kong Principal Datum (HKPD).
- The part of Emergency Vehicular Access/Driveway adjacent to the building is 35.00 metres above the Hong Kong Principal Datum.
- The part of Heung Yip Road adjacent to the building is 5.87 metres to 6.05 metres above the Hong Kong Principal Datum.
- 4/F, 6/F, 13/F, 14/F, 24/F and 34/F are omitted.