

# 09 OUTLINE ZONING PLAN RELATING TO THE DEVELOPMENT

## 09 關乎發展項目的分區計劃大綱圖

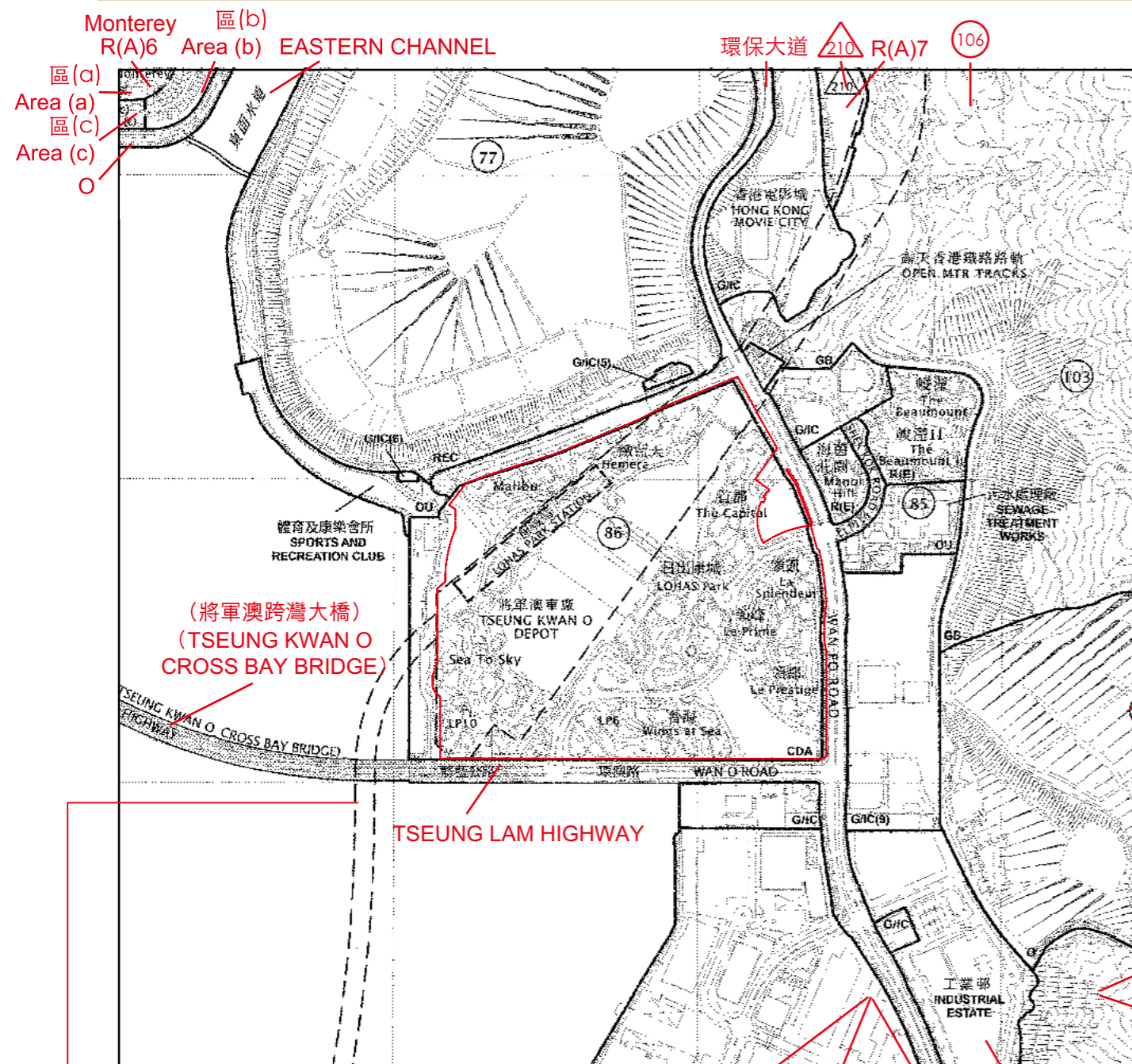

可能的將軍澳線南延線(須待進一步研究)  
 POSSIBLE TSEUNG KWAN O LINE SOUTHERN  
 EXTENSION (SUBJECT TO FURTHER INVESTIGATION)

Boundary of the Development  
 發展項目的邊界

Scale : 0M/米 500M/米  
 比例 :

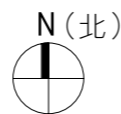

Extracted from approved Tseung Kwan O Outline Zoning Plan No. S/TKO/32, gazetted on 17 October 2025, with adjustments where necessary as shown in red. Survey and Mapping Office, Lands Department, The Government of HKSAR © Copyright reserved - reproduction by permission only.

摘錄自2025年10月17日刊憲之將軍澳分區計劃大綱核准圖，圖則編號為S/TKO/32，有需要處經修正處理，以紅色顯示。香港特別行政區政府地政總署測繪處 © 版權所有，未經許可，不得複製。

### Notation 圖例

#### Zones 地帶

- CDA Comprehensive Development Area 綜合發展區
- R(A) Residential (Group A) 住宅(甲類)
- R(E) Residential (Group E) 住宅(戊類)
- G/IC Government, Institution or Community 政府、機構或社區
- O Open Space 休憩用地
- REC Recreation 康樂
- OU Other Specified Uses 其他指定用途
- GB Green Belt 綠化地帶

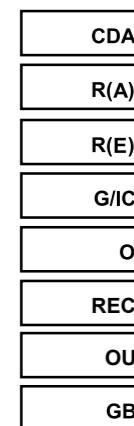

#### Communications 交通

- 105 Railway and Station 鐵路及車站
- Railway and Station (Underground) 鐵路及車站(地下)
- Major Road and Junction 主要道路及路口
- Elevated Road 高架道路

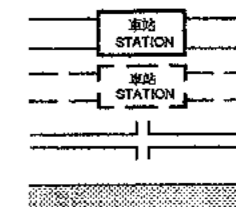

#### Miscellaneous 其他

- 104 Planning Area Number 規劃區編號
- Maximum Building Height (In Metres Above Principal Datum) 最高建築物高度 (在主水平基準上若干米)



#### Notes :

1. The last updated Outline Zoning Plan and the attached schedule as at the date of printing of the sales brochure is available for free inspection at the sales office of the Phase during opening hours.
2. Due to technical reasons (such as the shape of the Development), the plan may show more area than that required under the Residential Properties (First-hand Sales) Ordinance.
3. The vendor also advises prospective purchasers to conduct an on-site visit for a better understanding of the development, its surrounding environment and the public facilities nearby.

#### 附註 :

1. 在印刷售樓說明書當日所適用的最近期分區計劃大綱圖及其附表，可於期數的售樓處開放時間內免費查閱。
2. 因技術原因(例如發展項目之形狀)，分區計劃大綱圖所顯示的範圍可能多於《一手住宅物業銷售條例》所要求。
3. 賣方亦建議準買家到有關發展項目作實地考察，以對該發展項目、其周邊地區環境及附近的公共設施有較佳了解。