

CROSS-SECTION PLAN OF BUILDING IN THE DEVELOPMENT

發展項目中的建築物的橫截面圖

Cross-section Plan A-A

橫截面圖 A-A

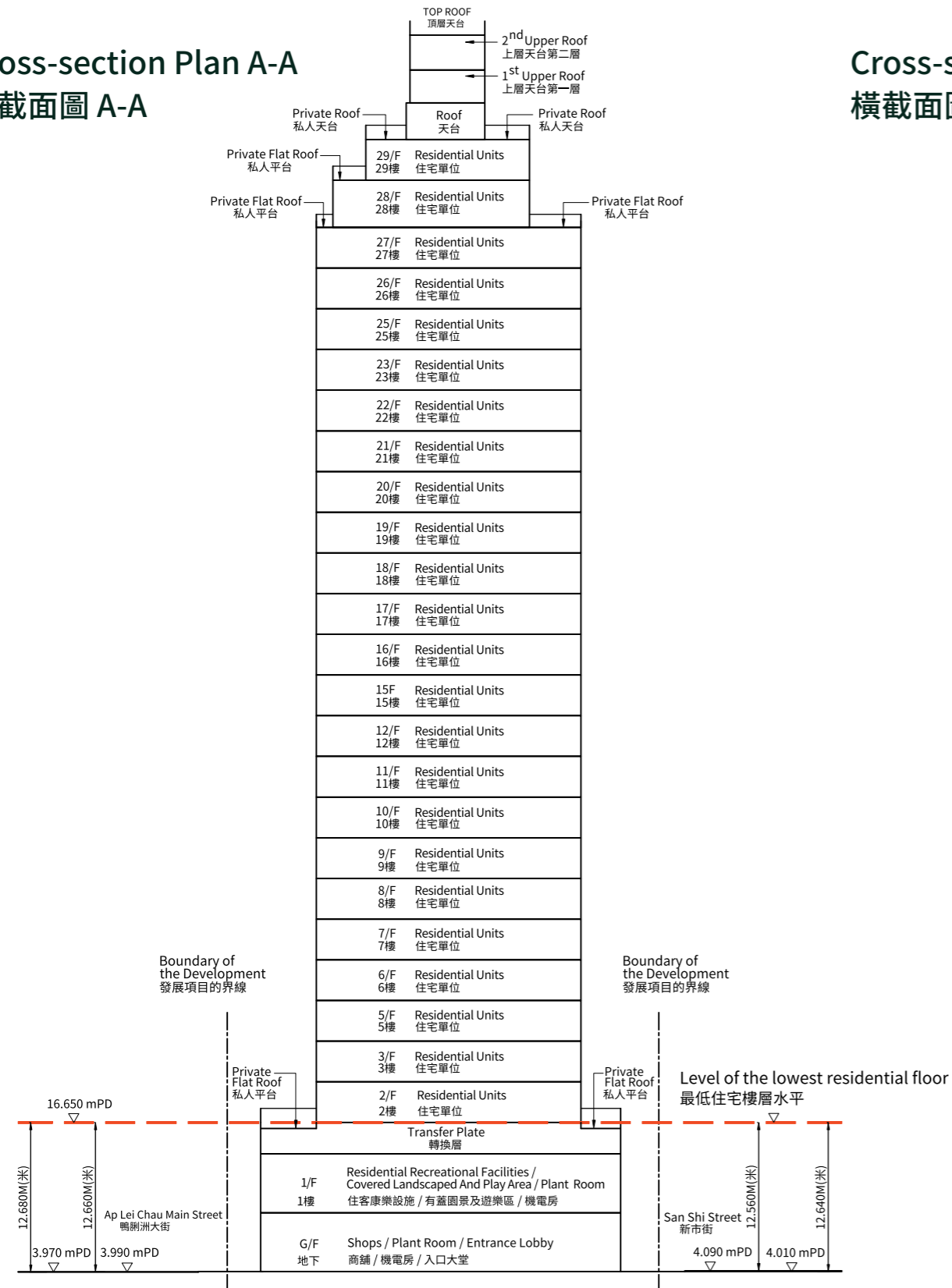

Cross-section Plan B-B

橫截面圖 B-B

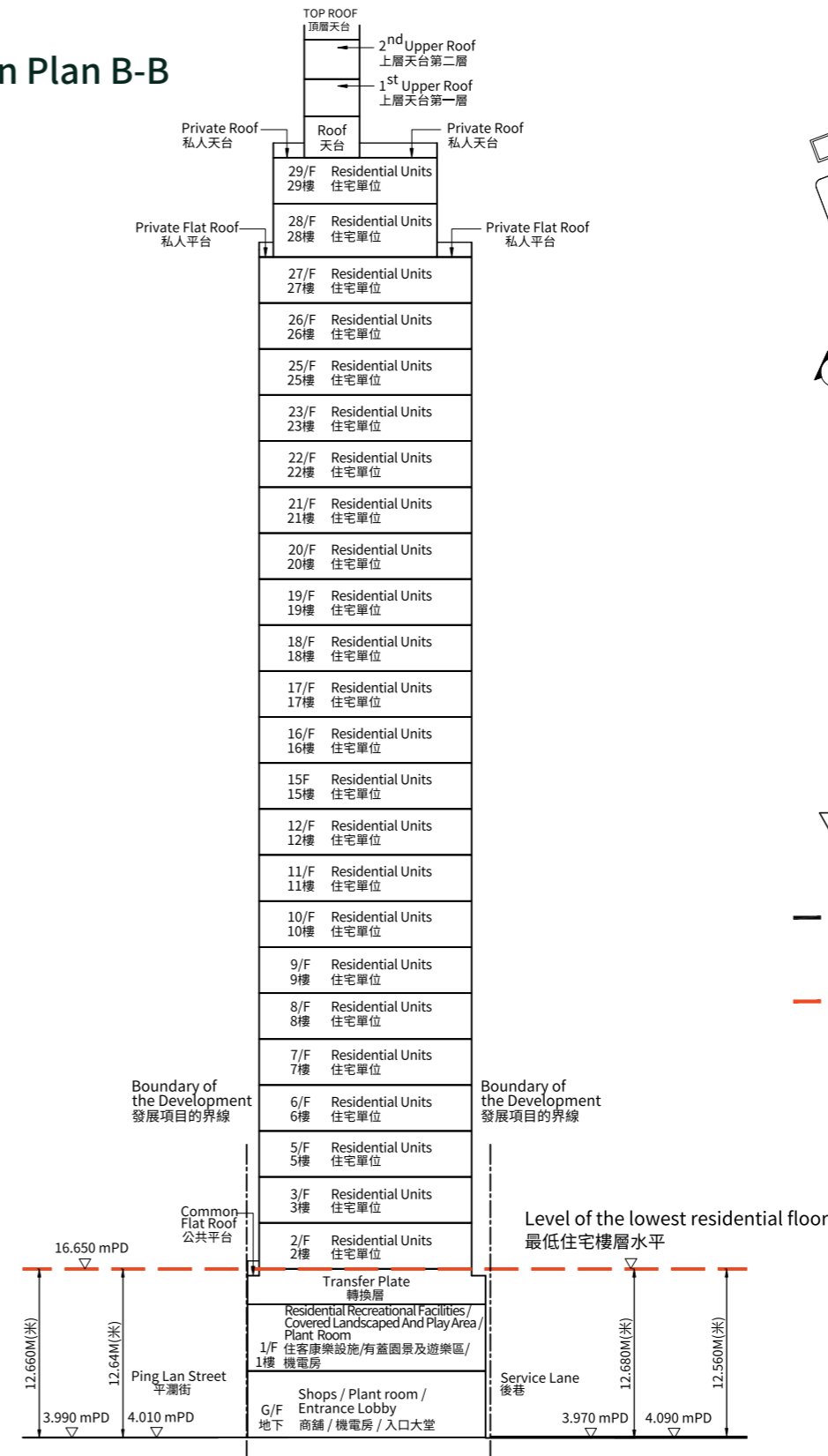

Key Plan 指示圖

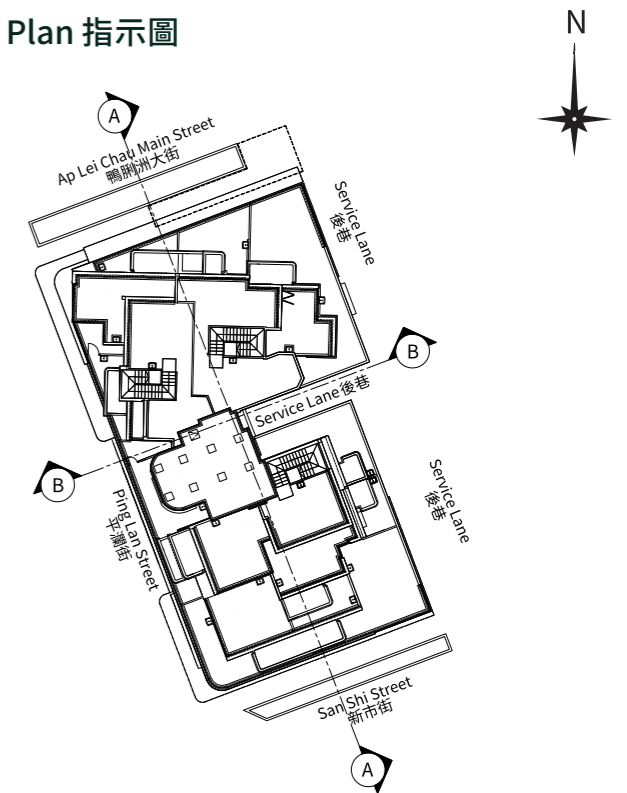

- ▽ Height (in metre) above the Hong Kong Principal Datum (PD)
香港主水平基準面以上高度(米)
- Boundary of the development
發展項目的界線
- The level of the lowest residential floor
最低住宅樓層水平

1. The part of Ap Lei Chau, Main Street adjacent to the building is 3.970 metres to 3.990 metres above the Hong Kong Principal Datum.
2. The part of San Shi Street adjacent to the building is 4.010 metres to 4.090 metres above the Hong Kong Principal Datum.
3. The part of Ping Lan Street adjacent to the building is 3.990 metres to 4.010 metres above the Hong Kong Principal Datum.
4. The part of Service Lane adjacent to the building is 3.970 metres to 4.090 metres above the Hong Kong Principal Datum.

1. 毗鄰建築物的一段鴨洲大街為香港主水平基準以上3.970米至3.990米。
2. 毗鄰建築物的一段新市街為香港主水平基準以上4.010米至4.090米。
3. 毗鄰建築物的一段平瀾街為香港主水平基準以上3.990米至4.010米。
4. 毗鄰建築物的一段後巷為香港主水平基準以上3.970米至4.090米。