

19 | CROSS-SECTION PLAN OF BUILDING IN THE PHASE

期數中的建築物的橫截面圖

CROSS-SECTION PLAN A-A

橫截面圖 A-A

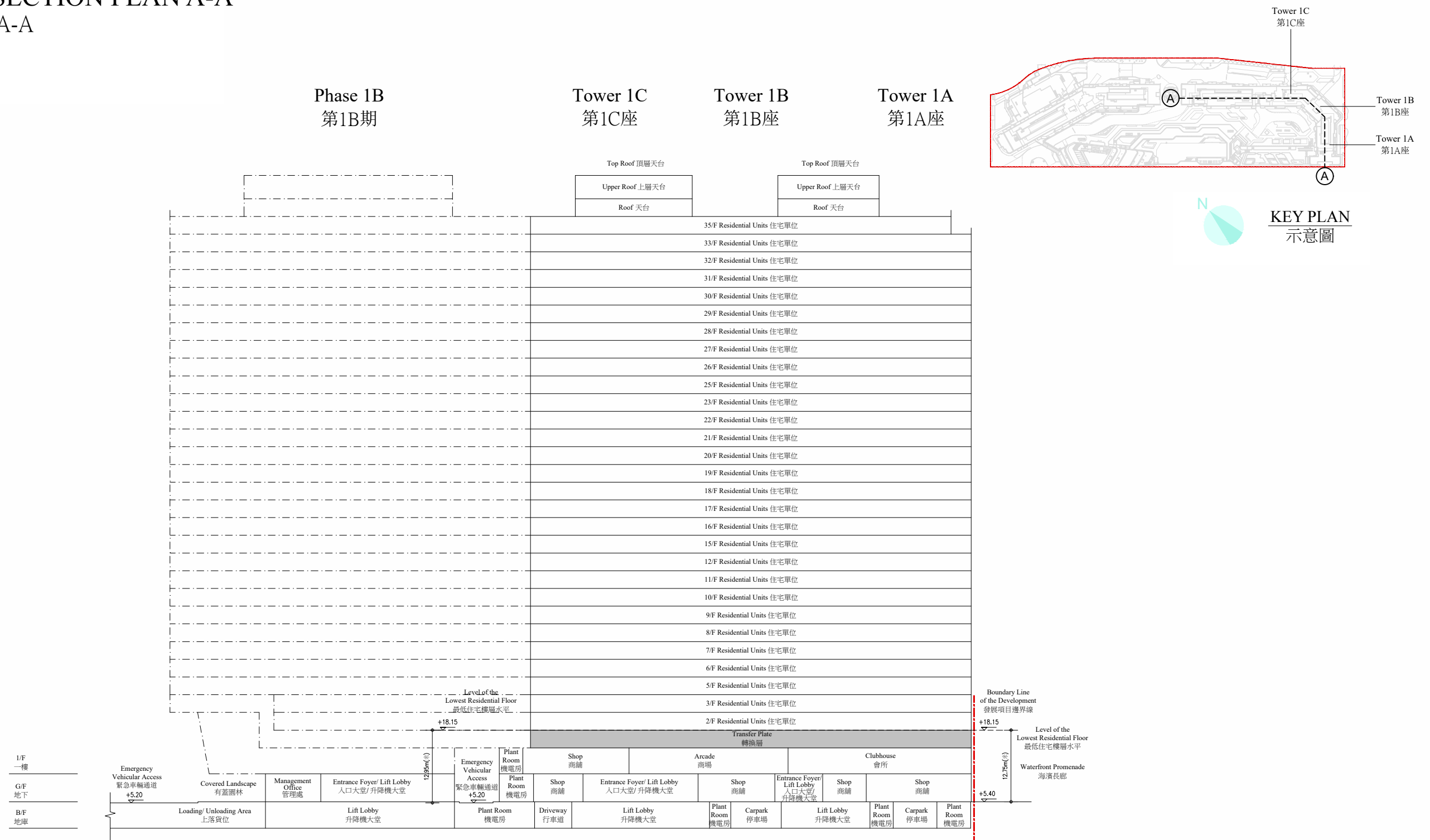

Notes:

1. Height in metres above the Hong Kong Principal Datum (HKPD).
2. The part of Waterfront Promenade adjacent to the building is 5.40 metres above the Hong Kong Principal Datum (HKPD).
3. The part of Emergency Vehicular Access adjacent to the building is 5.20 metres above the Hong Kong Principal Datum (HKPD).
4. ----- Dotted line denotes the lowest residential floor of the building.

附註：

1. 香港主水平基準以上的高度(米)。
2. 毗連建築物的一段海濱長廊為香港主水平基準以上5.40米。
3. 毗連建築物的一段緊急車輛通道為香港主水平基準以上5.20米。
4. ----- 虛線為該建築物最低住宅樓層水平。

CROSS-SECTION PLAN B-B
橫截面圖 B-B

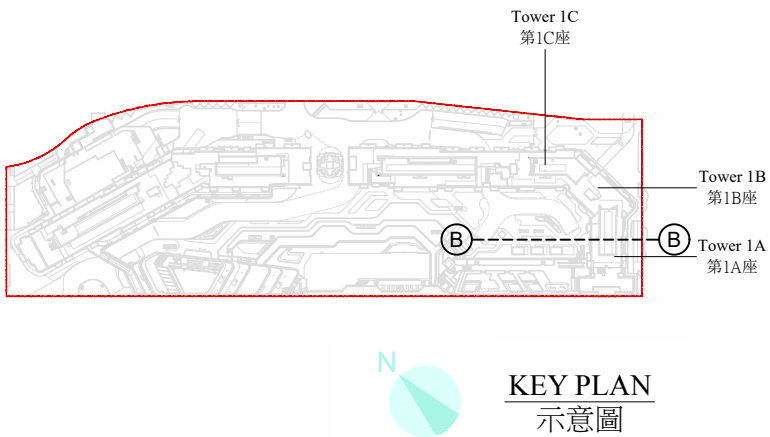
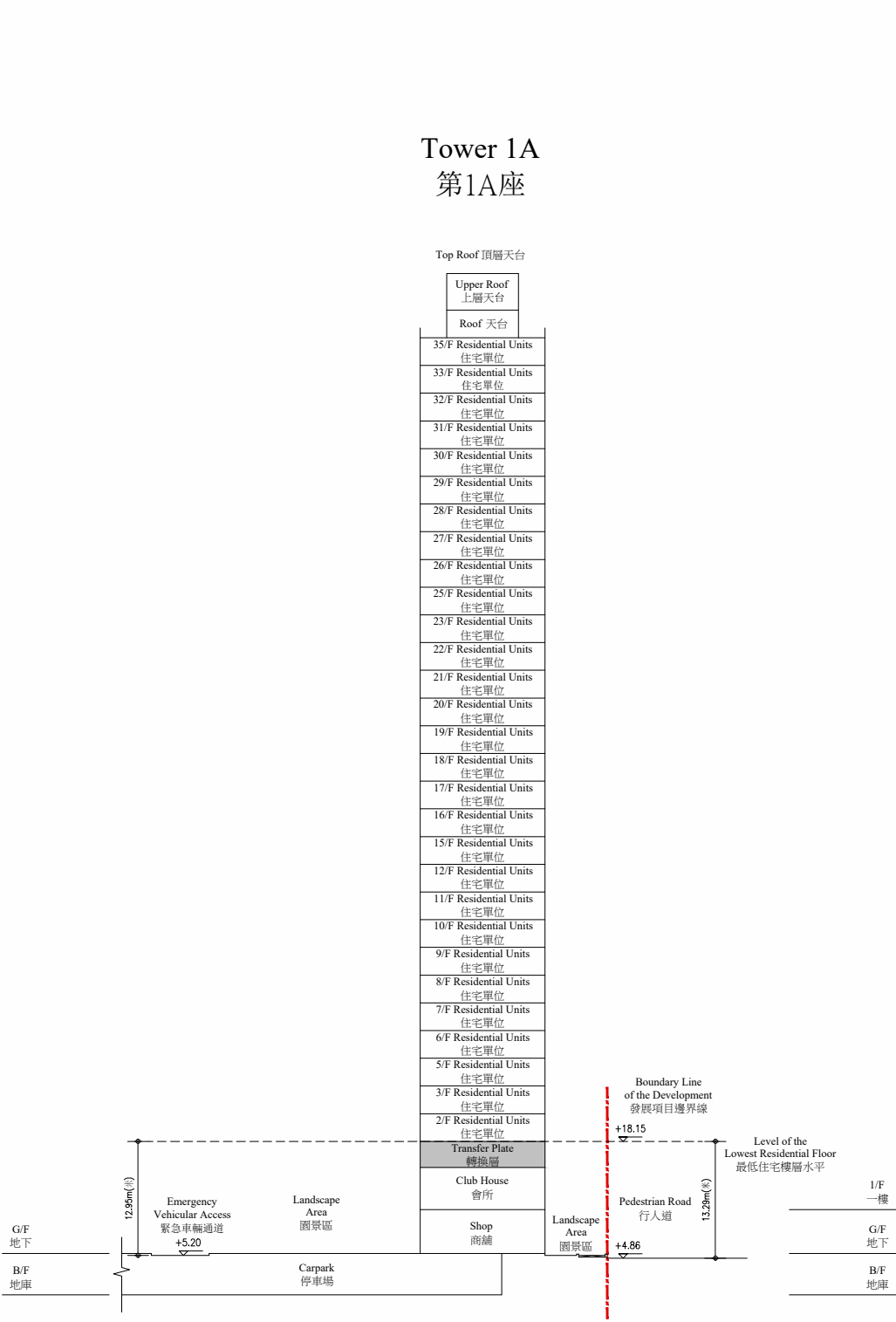

Notes:

- Height in metres above the Hong Kong Principal Datum (HKPD).
- The part of Pedestrian Road adjacent to the building is 4.86 metres above the Hong Kong Principal Datum (HKPD).
- The part of Emergency Vehicular Access adjacent to the building is 5.20 metres above the Hong Kong Principal Datum (HKPD).
- Dotted line denotes the lowest residential floor of the building.

附註：

- 香港主水平基準以上的高度(米)。
- 毗連建築物的一段行人道為香港主水平基準以上4.86米。
- 毗連建築物的一段緊急車輛通道為香港主水平基準以上5.20米。
- 虛線為該建築物最低住宅樓層水平。

19 | CROSS-SECTION PLAN OF BUILDING IN THE PHASE

期數中的建築物的橫截面圖

CROSS-SECTION PLAN C-C

橫截面圖 C-C

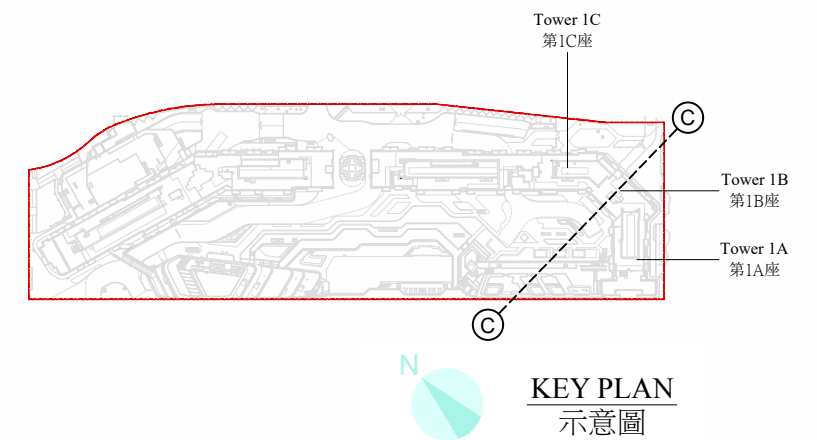
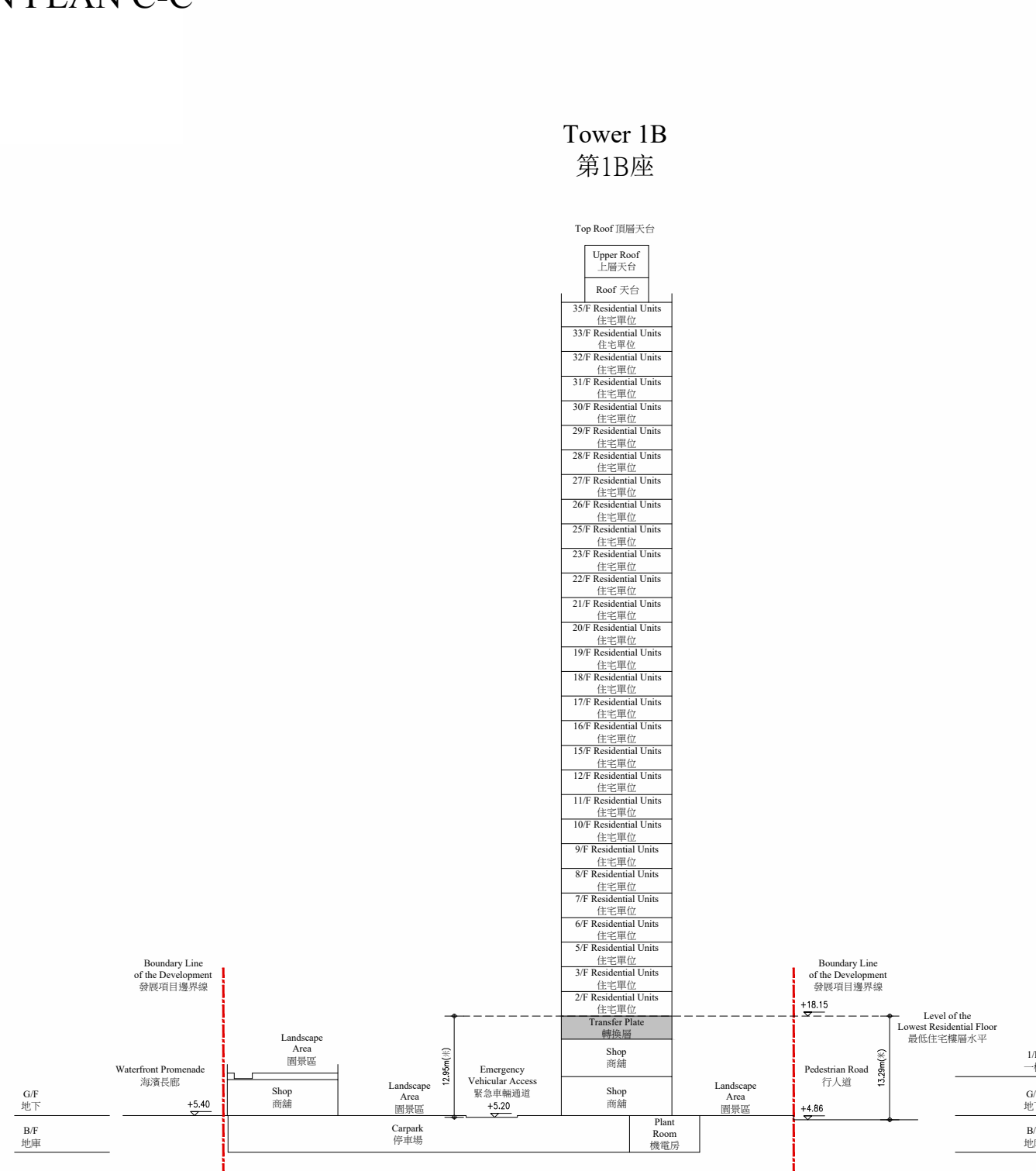

Notes:

- ▽ Height in metres above the Hong Kong Principal Datum (HKPD).
- The part of Pedestrian Road adjacent to the building is 4.86 metres above the Hong Kong Principal Datum (HKPD).
- The part of Emergency Vehicular Access adjacent to the building is 5.20 metres above the Hong Kong Principal Datum (HKPD).
- Dotted line denotes the lowest residential floor of the building.

附註：

- ▽ 香港主水平基準以上的高度(米)。
- 毗連建築物的一段行人道為香港主水平基準以上4.86米。
- 毗連建築物的一段緊急車輛通道為香港主水平基準以上5.20米。
- 虛線為該建築物最低住宅樓層水平。

19 | CROSS-SECTION PLAN OF BUILDING IN THE PHASE 期數中的建築物的橫截面圖

CROSS-SECTION PLAN D-D 橫截面圖 D-D

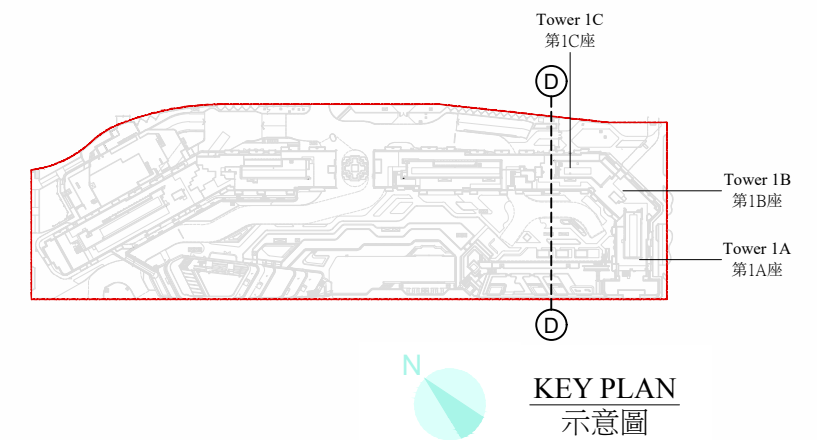
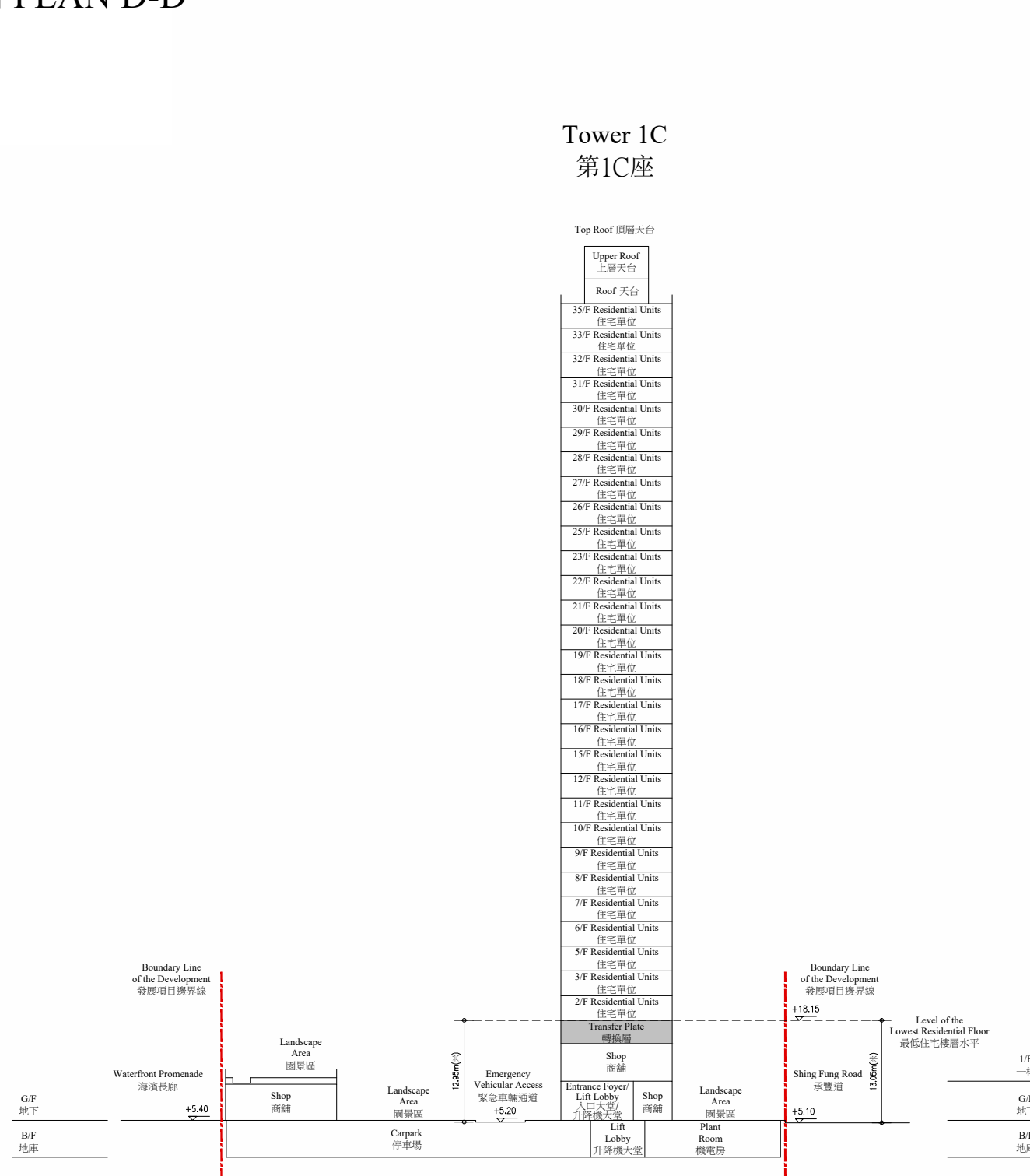

Notes:

1. — Height in metres above the Hong Kong Principal Datum (HKPD).
2. The part of Shing Fung Road adjacent to the building is 5.10 metres above the Hong Kong Principal Datum (HKPD).
3. The part of Emergency Vehicular Access adjacent to the building is 5.20 metres above the Hong Kong Principal Datum (HKPD).
4. ----- Dotted line denotes the lowest residential floor of the building.

附註：

1. — 香港主水平基準以上的高度(米)。
2. 毗連建築物的一段承豐道為香港主水平基準以上5.10米。
3. 毗連建築物的一段緊急車輛通道為香港主水平基準以上5.20米。
4. ----- 虛線為該建築物最低住宅樓層水平。