

# CROSS - SECTION PLAN OF BUILDING IN THE DEVELOPMENT

## 發展項目中的建築物的橫截面圖

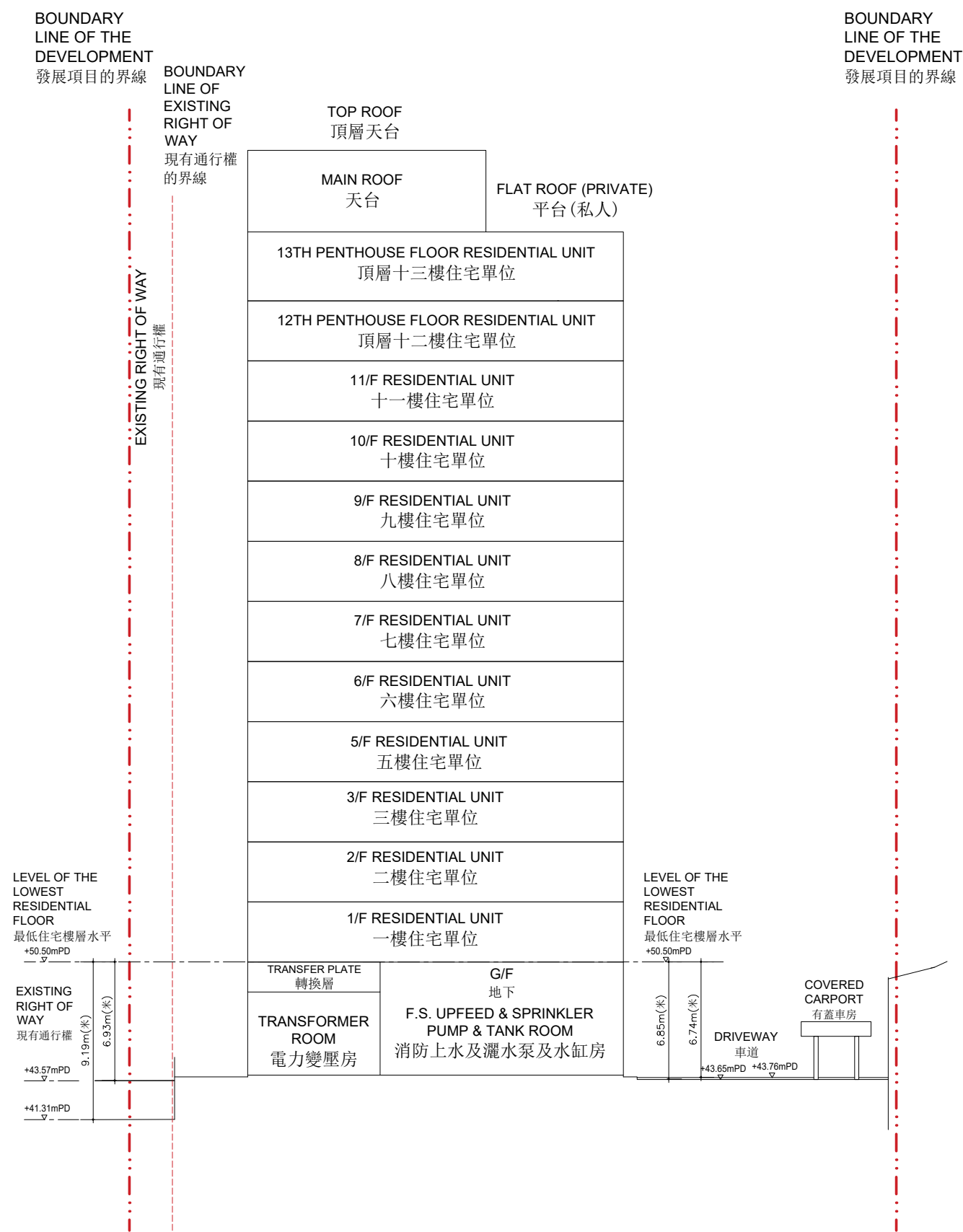

CROSS-SECTION PLAN A-A  
橫截面圖 A-A

BLOCK PLAN  
座向圖

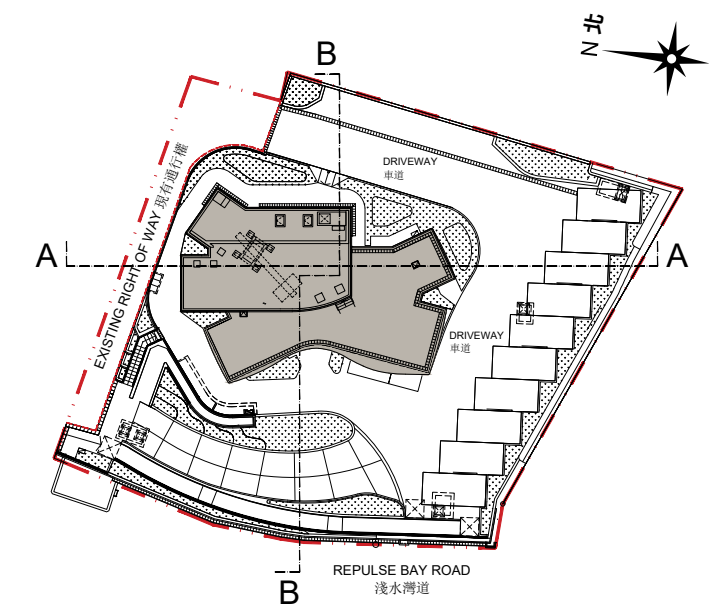

- Boundary of the Development  
發展項目之界線
- Boundary of Existing Right of Way  
現有通行權之界線

CROSS-SECTION PLAN A-A

- ▽ mPD denotes height (in metres) above the Hong Kong Principal Datum (HKPD).
- - - Dotted line denotes the level of the lowest residential floor of the Development.
- The part of Existing Right of Way adjacent to the building is from 41.31 to 43.57 metres above the Hong Kong Principal Datum (HKPD).
- The part of Driveway adjacent to the building is from 43.65 to 43.76 metres above the Hong Kong Principal Datum (HKPD).

橫截面圖 A-A

- ▽ mPD代表香港主水平基準以上的高度(米)。
- - - 虛線代表發展項目之最低住宅樓層水平。
- 毗連建築物的一段現有通行權為香港主水平基準以上41.31至43.57米。
- 毗連建築物的一段車道為香港主水平基準以上43.65至43.76米。

# CROSS - SECTION PLAN OF BUILDING IN THE DEVELOPMENT

## 發展項目中的建築物的橫截面圖

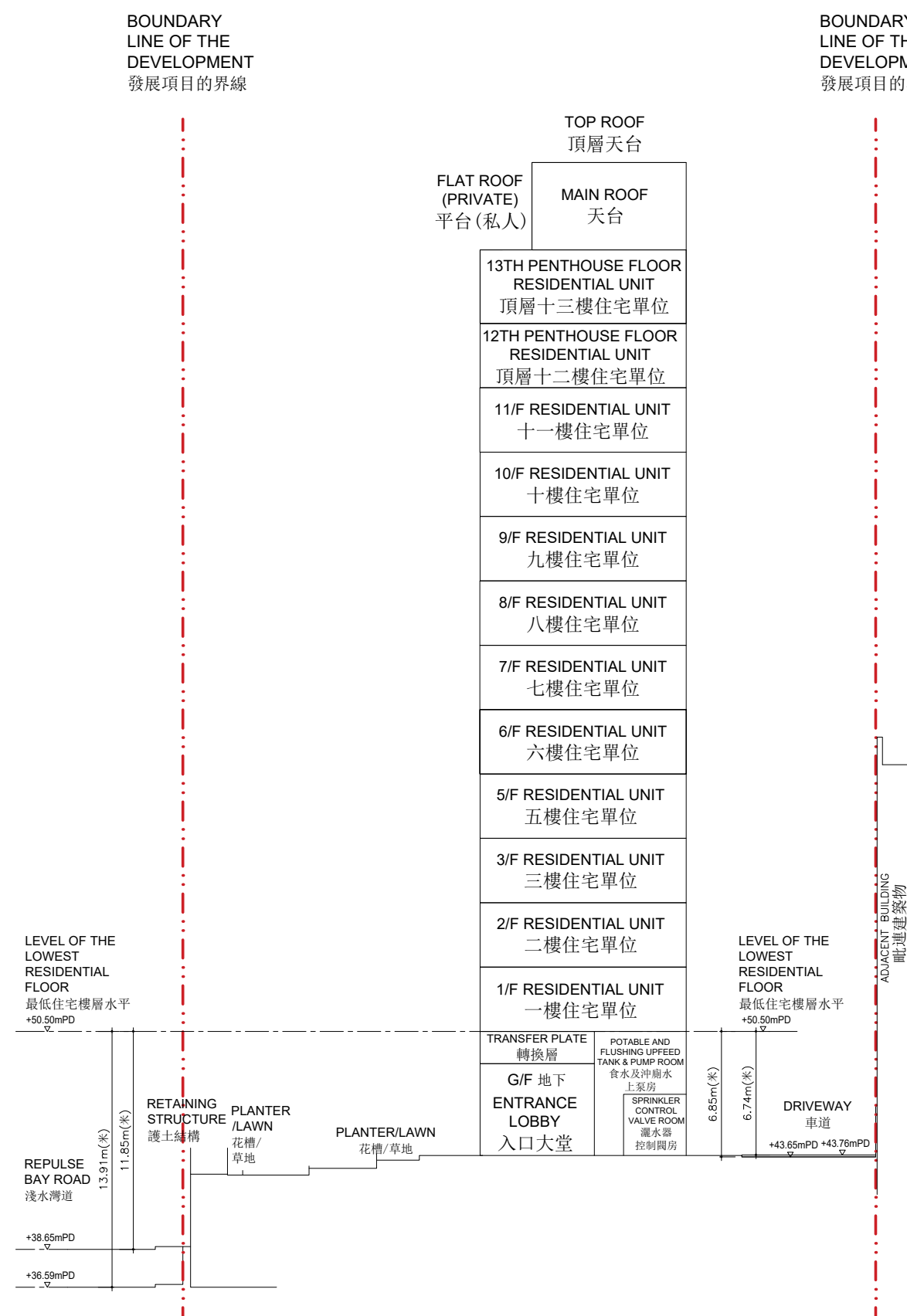

CROSS-SECTION PLAN B-B  
橫截面圖 B-B

BLOCK PLAN  
座向圖

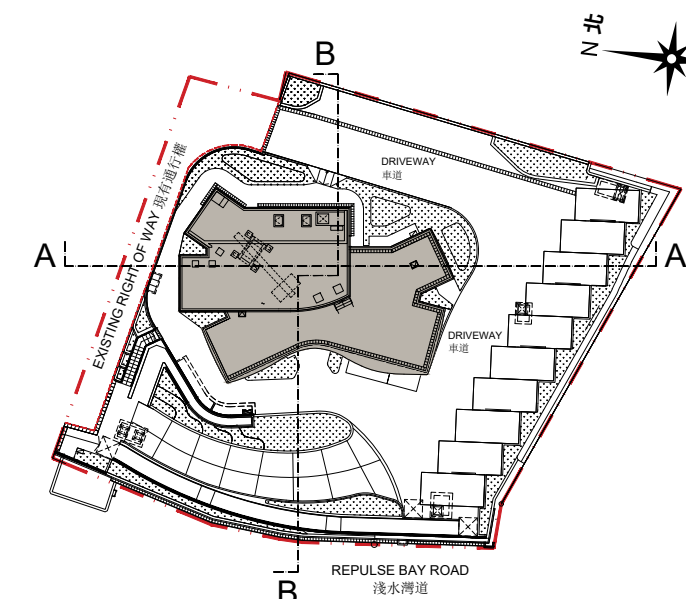

- Boundary of the Development  
發展項目之界線
- Boundary of Existing Right of Way  
現有通行權之界線

CROSS-SECTION PLAN B-B

- ▽ mPD denotes height (in metres) above the Hong Kong Principal Datum (HKPD).
- - - Dotted line denotes the level of the lowest residential floor of the Development.
- The part of Repulse Bay Road adjacent to the building is from 36.59 to 38.65 metres above the Hong Kong Principal Datum (HKPD).
- The part of Driveway adjacent to the building is from 43.65 to 43.76 metres above the Hong Kong Principal Datum (HKPD).

橫截面圖 B-B

- ▽ mPD代表香港主水平基準以上的高度(米)。
- - - 虛線代表發展項目之最低住宅樓層水平。
- 毗連建築物的一段淺水灣道為香港主水平基準以上36.59至38.65米。
- 毗連建築物的一段車道為香港主水平基準以上43.65至43.76米。