

CROSS-SECTION PLAN OF BUILDING IN THE PHASE 期數中的建築物的橫截面圖

CROSS-SECTION PLAN A-A
橫截面圖 A-A

KEY PLAN 指示圖

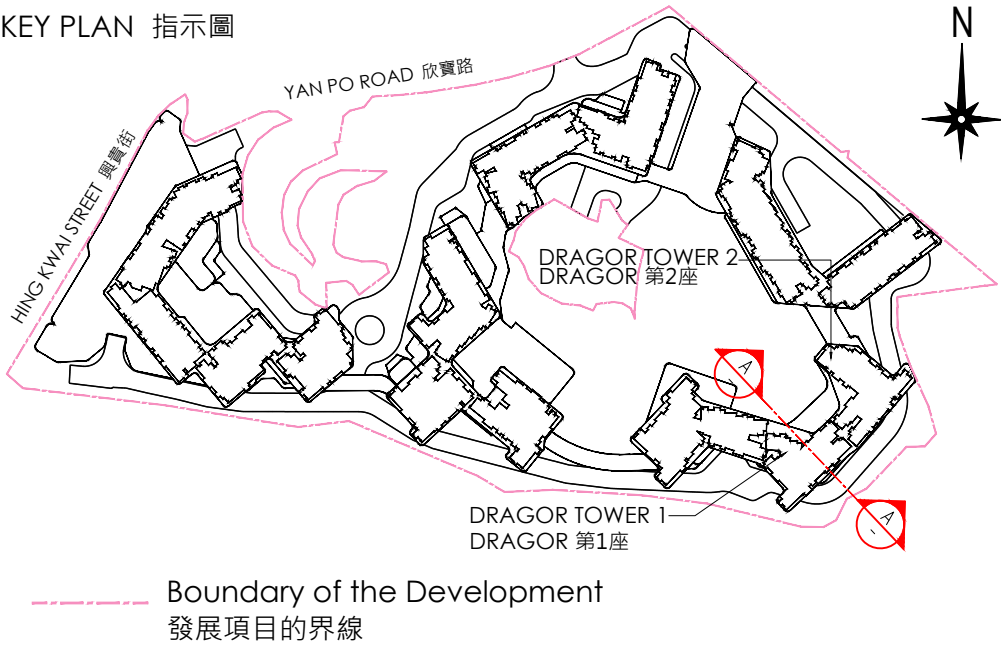

Notes:

1. √— Denotes height(in metres) above the Hong Kong Principal Datum.
2. --- Dotted line denotes the lowest residential floor.
3. The parts of Emergency Vehicular Access Driveway adjacent to the building is 14.525 metres above the Hong Kong Principal Datum.

備註:

1. √— 代表香港主水平基準以上的高度 (米)。
2. --- 虛線為最低住宅樓層水平。
3. 毗鄰建築物的緊急車輛通道為香港主水平基準以上14.525米。

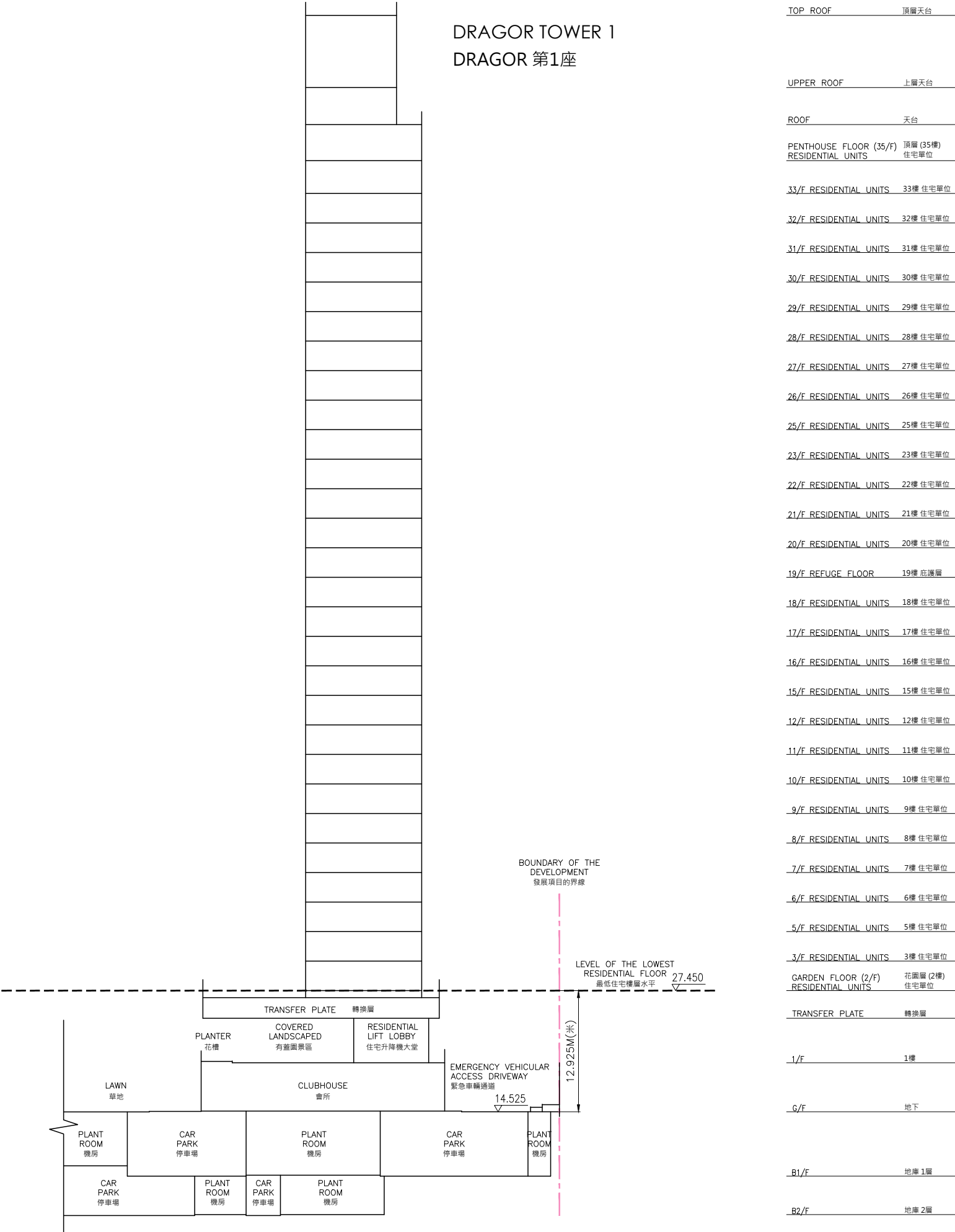

CROSS-SECTION PLAN OF BUILDING IN THE PHASE 期數中的建築物的橫截面圖

CROSS-SECTION PLAN B-B
橫截面圖 B-B

KEY PLAN 指示圖

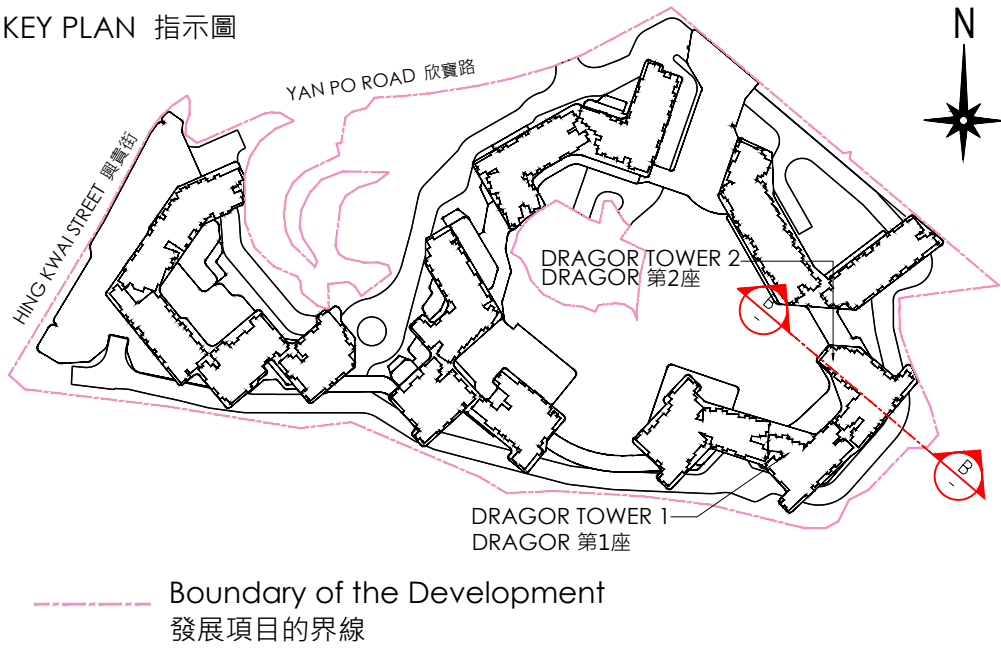

- Notes:
- 1. ∇ — Denotes height(in metres) above the Hong Kong Principal Datum.
 - 2. --- Dotted line denotes the lowest residential floor.
 - 3. The parts of Emergency Vehicular Access Driveway adjacent to the building is 14.490 metres above the Hong Kong Principal Datum.
- 備註:
- 1. ∇ — 代表香港主水平基準以上的高度 (米)。
 - 2. --- 虛線為最低住宅樓層水平。
 - 3. 毗鄰建築物的緊急車輛通道為香港主水平基準以上14.490米。

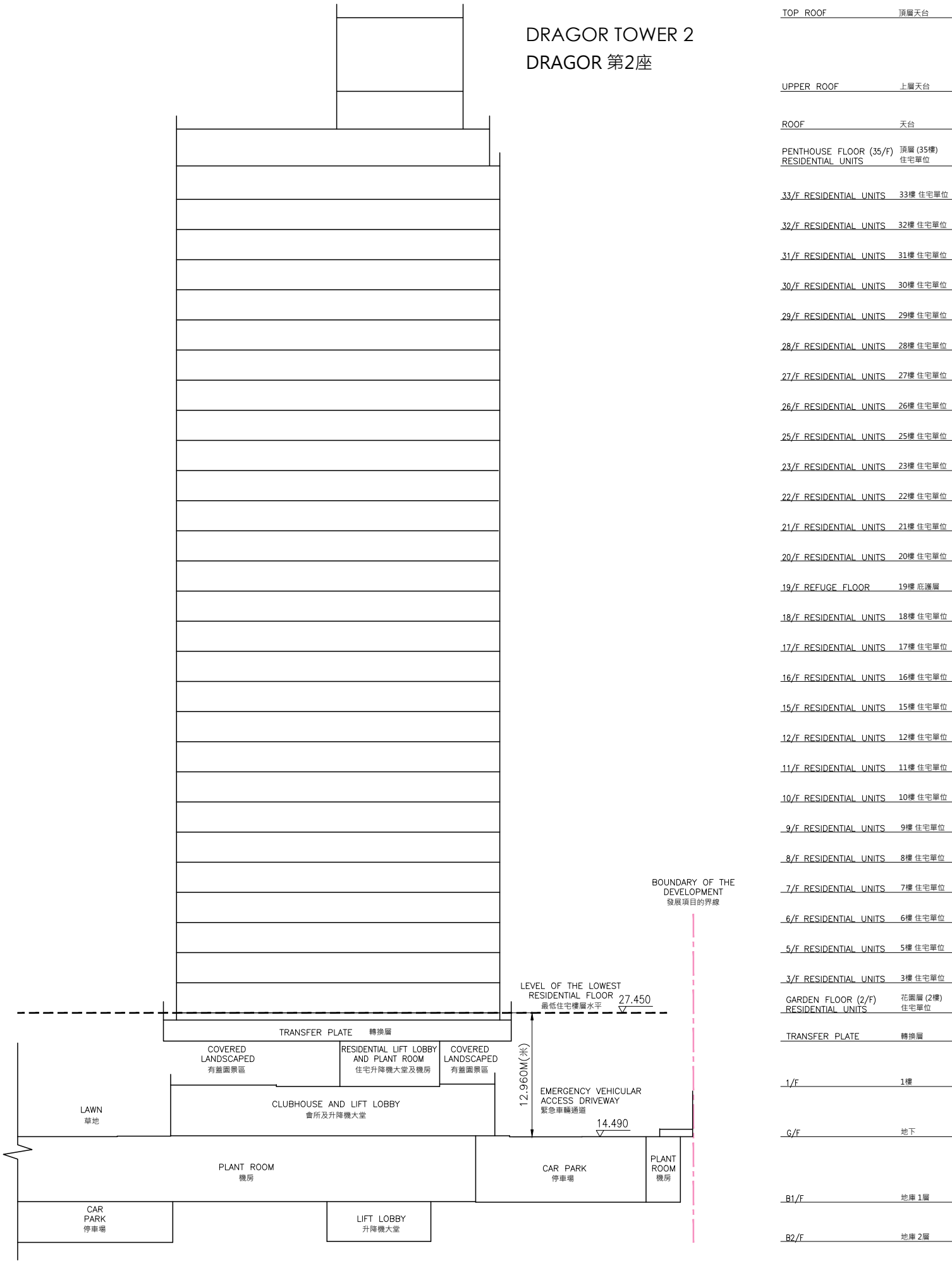

CROSS-SECTION PLAN OF BUILDING IN THE PHASE 期數中的建築物的橫截面圖

CROSS-SECTION PLAN C-C
橫截面圖 C-C

KEY PLAN 指示圖

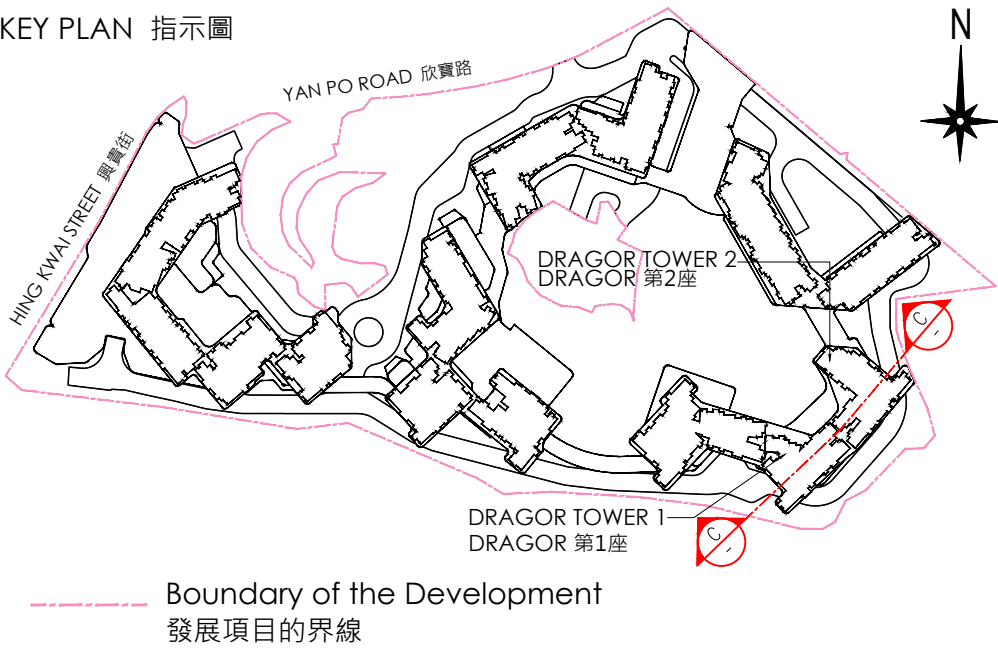

Notes:

- 1. ▽ Denotes height(in metres) above the Hong Kong Principal Datum.
- 2. --- Dotted line denotes the lowest residential floor.
- 3. The parts of Emergency Vehicular Access Driveway adjacent to the building are 14.525 metres and 14.490 metres above the Hong Kong Principal Datum respectively.

備註:

- 1. ▽ 代表香港主水平基準以上的高度 (米)。
- 2. --- 虛線為最低住宅樓層水平。
- 3. 毗鄰建築物的緊急車輛通道分別為香港主水平基準以上14.525米及14.490米。

