

# 18. 發展項目中的建築物的橫截面圖

## CROSS-SECTION PLAN OF BUILDING IN THE DEVELOPMENT

橫截面圖 A-A  
CROSS-SECTION PLAN A-A

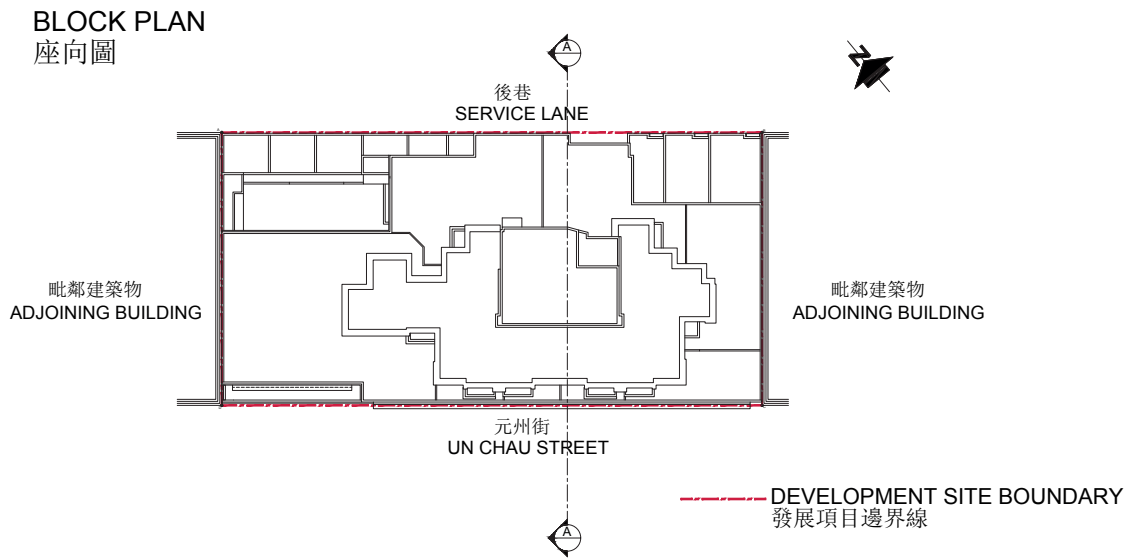

1. 毗鄰建築物的一段後巷為香港主水平基準以上 5.950 米 至 6.010 米。
  2. 毗鄰建築物的一段元州街為香港主水平基準以上 5.745 米 至 5.880 米。
  3. 發展項目之最低住宅層為香港主水平基準以上 21.28 米。
  4. 紅色虛線為最低住宅樓層水平。
1. The part of service lane adjacent to the building is 5.950 to 6.010 metres above the Hong Kong Principal Datum.
  2. The part of Un Chau Street adjacent to the building is 5.745 to 5.880 metres above the Hong Kong Principal Datum.
  3. The level of lowest residential floor of the building is 21.28 metres above the Hong Kong Principal Datum.
  4. Red dotted line denotes the level of the lowest residential floor.

