

Cross-Section Plan of Building in the Development

橫截面圖 A-A Cross-Section Plan A-A

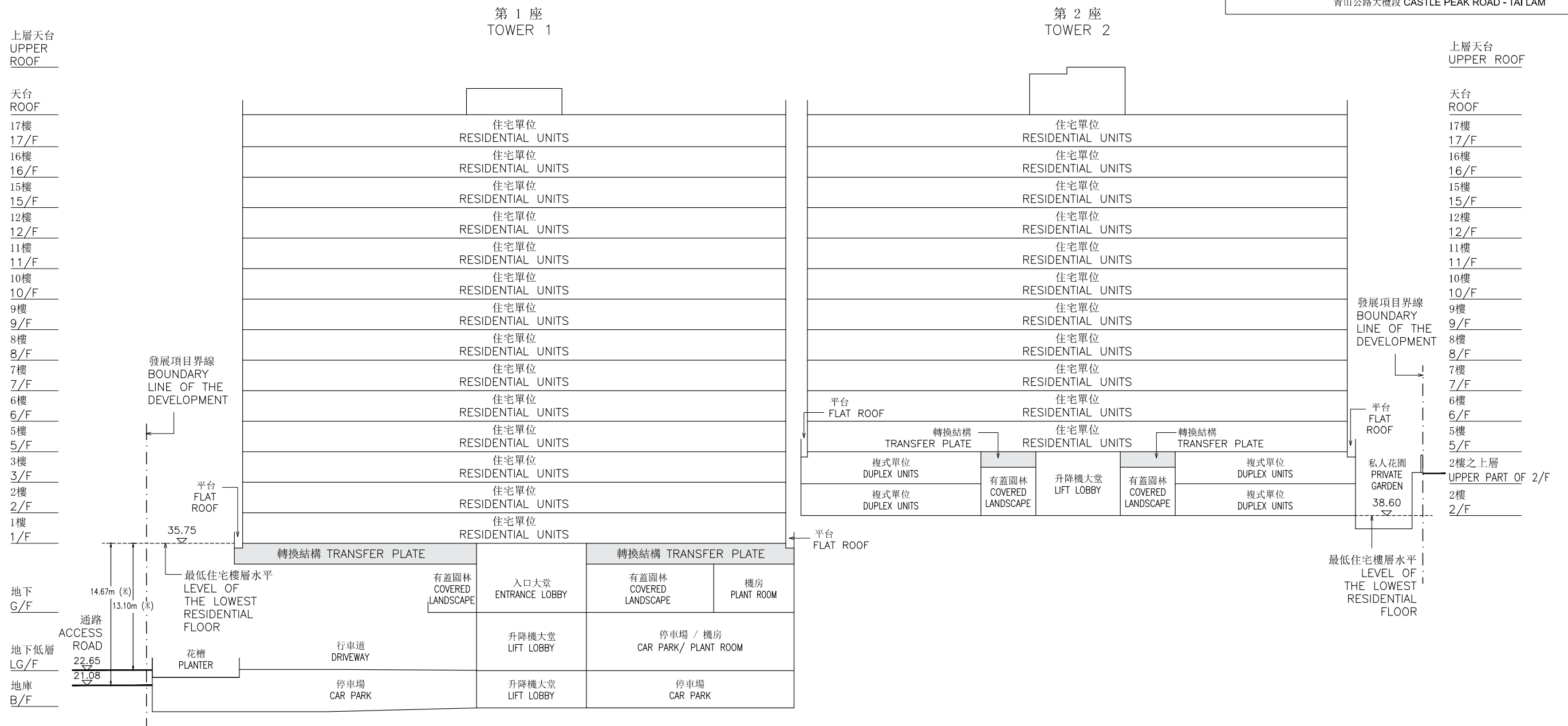

備註：

1. (▽) 表示香港主水平基準以上高度(米)。
2. ----- 虛線為最低住宅樓層水平。
3. 賣方亦建議買方到該發展地盤作實地考察，以獲取對該發展地盤及周圍地區的公共設施及環境較佳的了解。
4. 毗連建築物的一段通路為香港主水平基準以上21.08至22.65米。

Notes:

1. (▽) denotes height (in metre) above Hong Kong Principal Datum.
2. ----- Dotted line denotes the level of the lowest residential floor.
3. The Vendor also advises purchasers to conduct on site visit for a better understanding of the Development site, its surrounding environment and the public facilities nearby.
4. The part of Access Road adjacent to the building is 21.08 to 22.65 metres above Hong Kong Principal Datum (HKPD).

18 發展項目中的建築物的橫截面圖 Cross-Section Plan of Building in the Development

橫截面圖 B-B Cross-Section Plan B-B

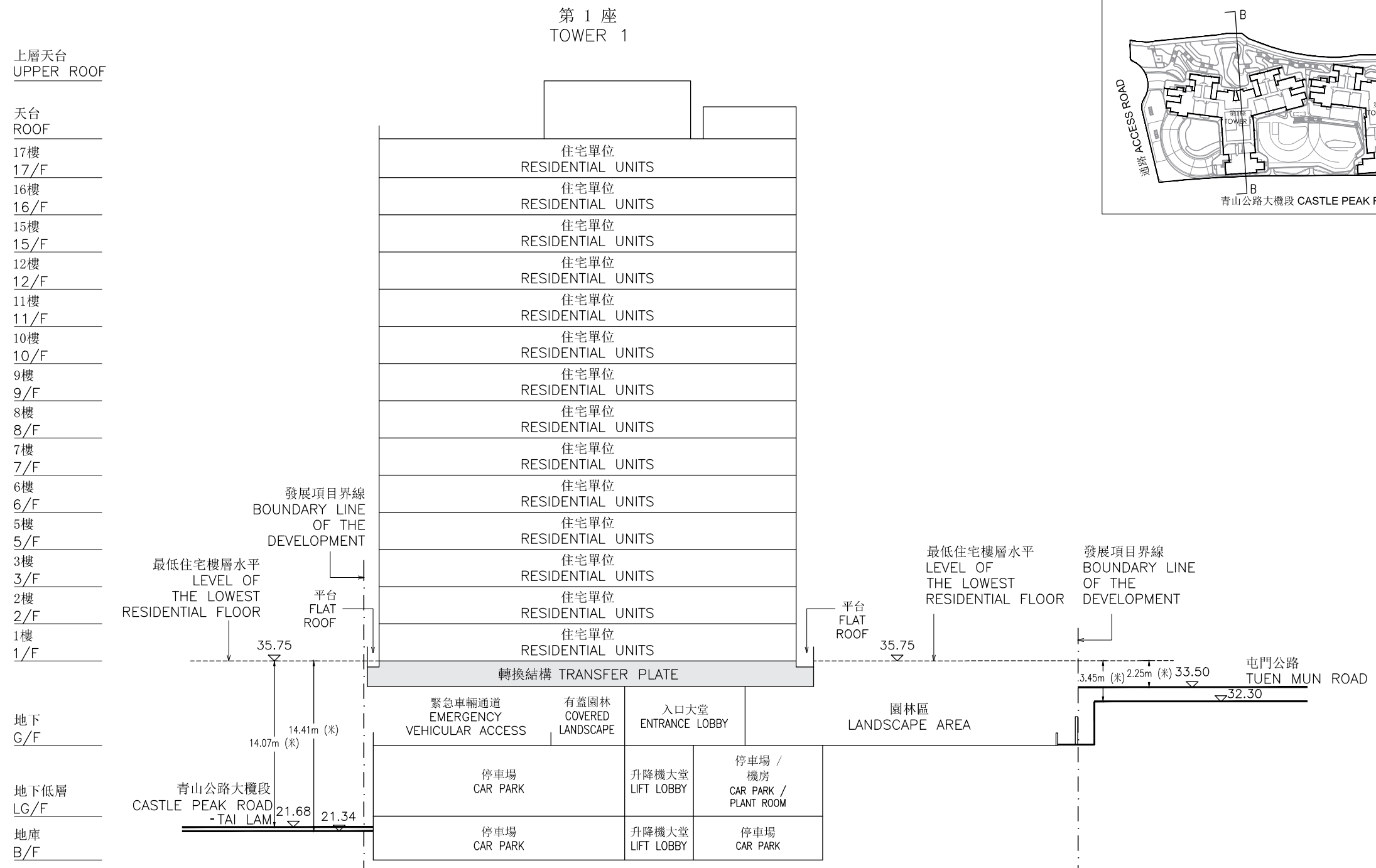

備註：

1. (▽) 表示香港主水平基準以上高度(米)。
2. ----- 虛線為最低住宅樓層水平。
3. 賣方亦建議買方到該發展地盤作實地考察，以獲取對該發展地盤及周圍地區的公共設施及環境較佳的了解。
4. 毗連建築物的一段青山公路大欖段為香港主水平基準以上21.34至21.68米。
5. 毗連建築物的一段屯門公路為香港主水平基準以上32.30至33.50米。

Notes:

1. (▽) denotes height (in metre) above Hong Kong Principal Datum.
2. ----- Dotted line denotes the level of the lowest residential floor.
3. The Vendor also advises purchasers to conduct on site visit for a better understanding of the Development site, its surrounding environment and the public facilities nearby.
4. The part of Castle Peak Road - Tai Lam adjacent to the building is 21.34 to 21.68 metres above Hong Kong Principal Datum (HKPD).
5. The part of Tuen Mun Road adjacent to the building is 32.30 to 33.50 metres above Hong Kong Principal Datum (HKPD).

18 發展項目中的建築物的橫截面圖
Cross-Section Plan of Building in the Development

橫截面圖 C-C Cross-Section Plan C-C

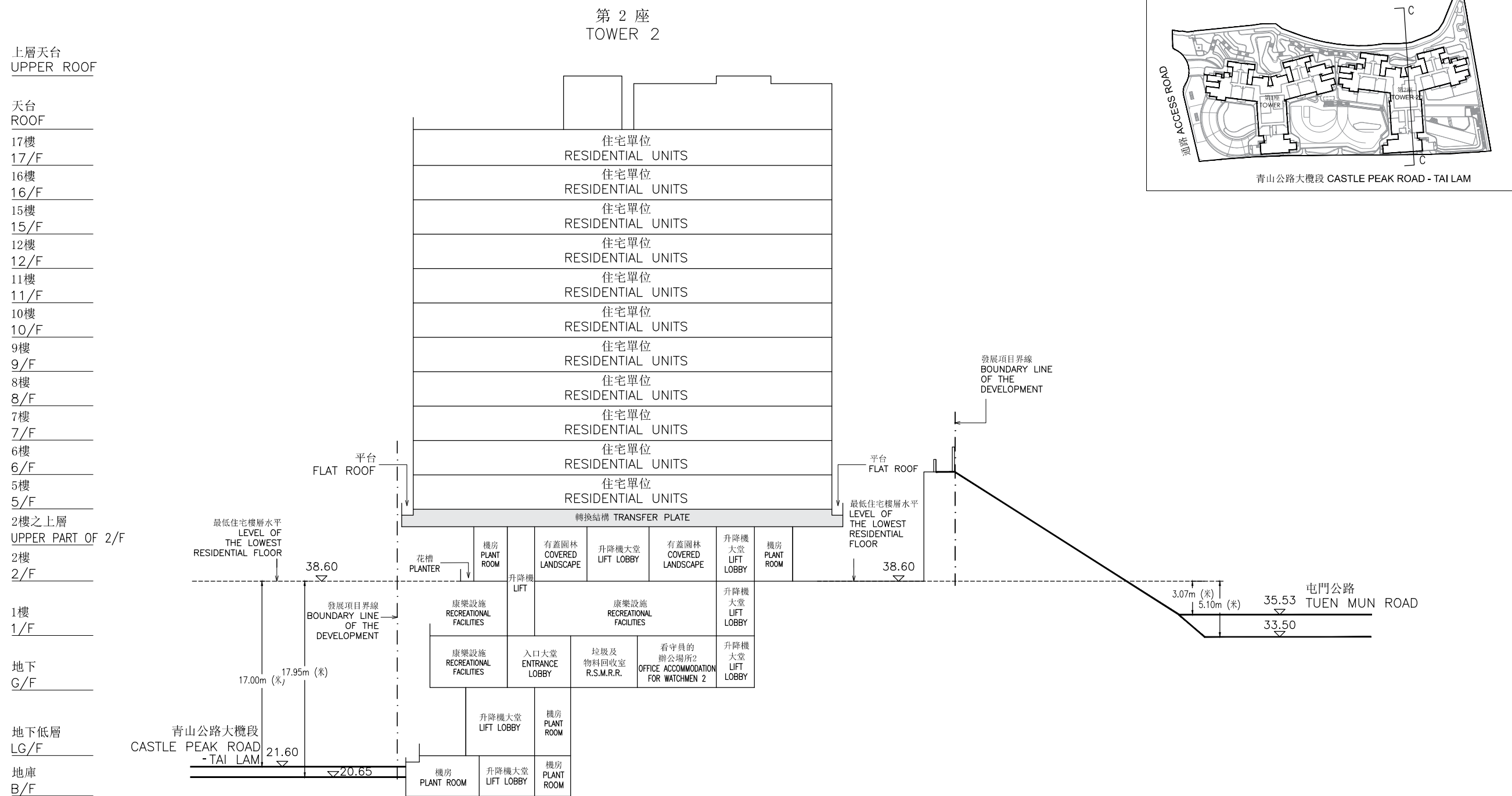

備註：

- 1. (▽) 表示香港主水平基準以上高度(米)。
- 2. ----- 虛線為最低住宅樓層水平。
- 3. 賣方亦建議買方到該發展地盤作實地考察，以獲取對該發展地盤及周圍地區的公共設施及環境較佳的了解。
- 4. 毗連建築物的一段青山公路大欖段為香港主水平基準以上20.65至21.60米。
- 5. 毗連建築物的一段屯門公路為香港主水平基準以上33.50至35.53米。

Notes:

- 1. (▽) denotes height (in metre) above Hong Kong Principal Datum.
- 2. ----- Dotted line denotes the level of the lowest residential floor.
- 3. The Vendor also advises purchasers to conduct on site visit for a better understanding of the Development site, its surrounding environment and the public facilities nearby.
- 4. The part of Castle Peak Road - Tai Lam adjacent to the building is 20.65 to 21.60 metres above Hong Kong Principal Datum (HKPD).
- 5. The part of Tuen Mun Road adjacent to the building is 33.50 to 35.53 metres above Hong Kong Principal Datum (HKPD).