

8 關乎發展項目的分區計劃大綱圖
Outline Zoning Plan Relating to the Development

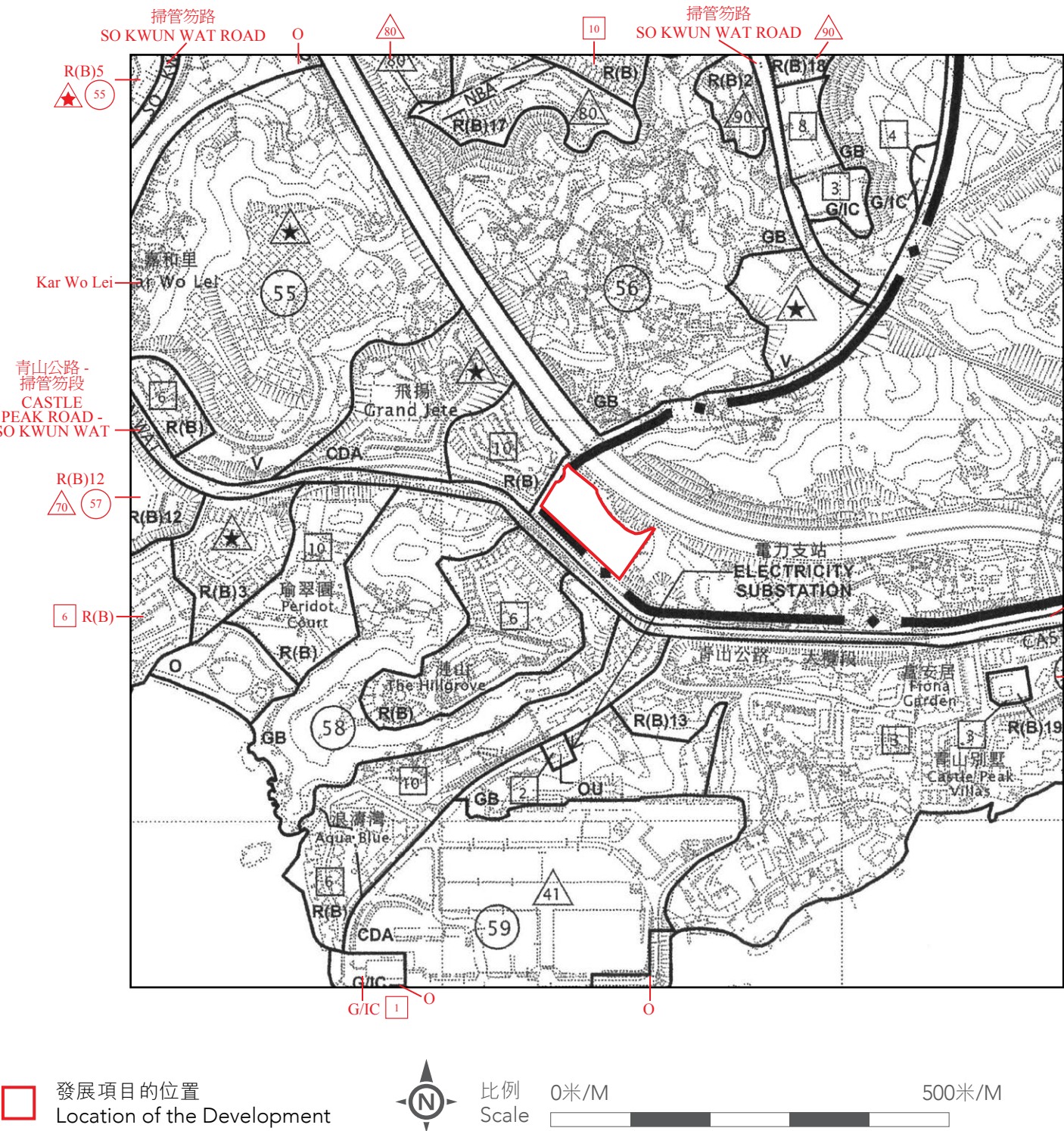

圖例 Notation

地帶 Zones

CDA	綜合發展區 Comprehensive Development Area	O	休憩用地 Open Space
R(B)	住宅(乙類) Residential (Group B)	OU	其他指定用途 Other Specified Uses
V	鄉村式發展 Village Type Development	GB	綠化地帶 Green Belt
G/IC	政府、機構或社區 Government, Institution or Community		

交通 Communications

	主要道路及路口 Major Road and Junction
--	------------------------------------

其他 Miscellaneous

	規劃範圍界線 Boundary of Planning Scheme		《註釋》內訂明最高建築物高度限制 Maximum Building Height restriction as stipulated on the notes
	規劃區編號 Planning Area Number		最高建築物高度(樓層數目) Maximum Building Height (In number of storeys)
	建築物高度管制區界線 Building Height Control Zone Boundary		非建築用地 Non-Building Area
	最高建築物高度 (在主水平基準上若干米) Maximum Building Height (In Metres Above Principal Datum)		

發展項目的位置
Location of the Development



摘錄自2024年11月1日刊憲之屯門分區計劃大綱草圖，圖則編號為S/TM/40，有需要處經修正處理，以紅色表示。

Adopted from part of the draft Tuen Tuen Mun Outline Zoning Plan, Plan No. S/TM/40, gazetted on 1 November 2024, with adjustments where necessary as shown in red.

- 備註：
- 在印刷售樓說明書當日所適用的最近期分區計劃大綱圖及其附表，可於售樓處開放時間內免費查閱。
 - 賣方建議買家到有關發展地盤作實地考察，以對該發展地盤、其周邊地區環境及附近的公共設施有較佳了解。
 - 由於發展項目的邊界不規則的技術原因，此分區計劃大綱圖所顯示的範圍可能超過《一手住宅物業銷售條例》所規定的範圍。
 - 此圖為規劃署遵照城市規劃委員會指示擬備，版權屬香港特別行政區政府，經地政總署准許複印。

- Notes:
- The last updated outline zoning plan and the attached schedule as at the date of printing of the sales brochure is available for free inspection at the sales office during opening hours.
 - The Vendor advises prospective purchasers to conduct an on-site visit for a better understanding of the development site, its surrounding environment and the public facilities nearby.
 - The outline zoning plan may show more than the area required under the Residential Properties (First-hand Sales) Ordinance due to technical reason that the boundary of the Development is irregular.
 - The plan, prepared by the Planning Department under the direction of the Town Planning Board, is reproduced with the permission of the Director of Lands. ©The Government of Hong Kong SAR.

8 關乎發展項目的分區計劃大綱圖
Outline Zoning Plan Relating to the Development

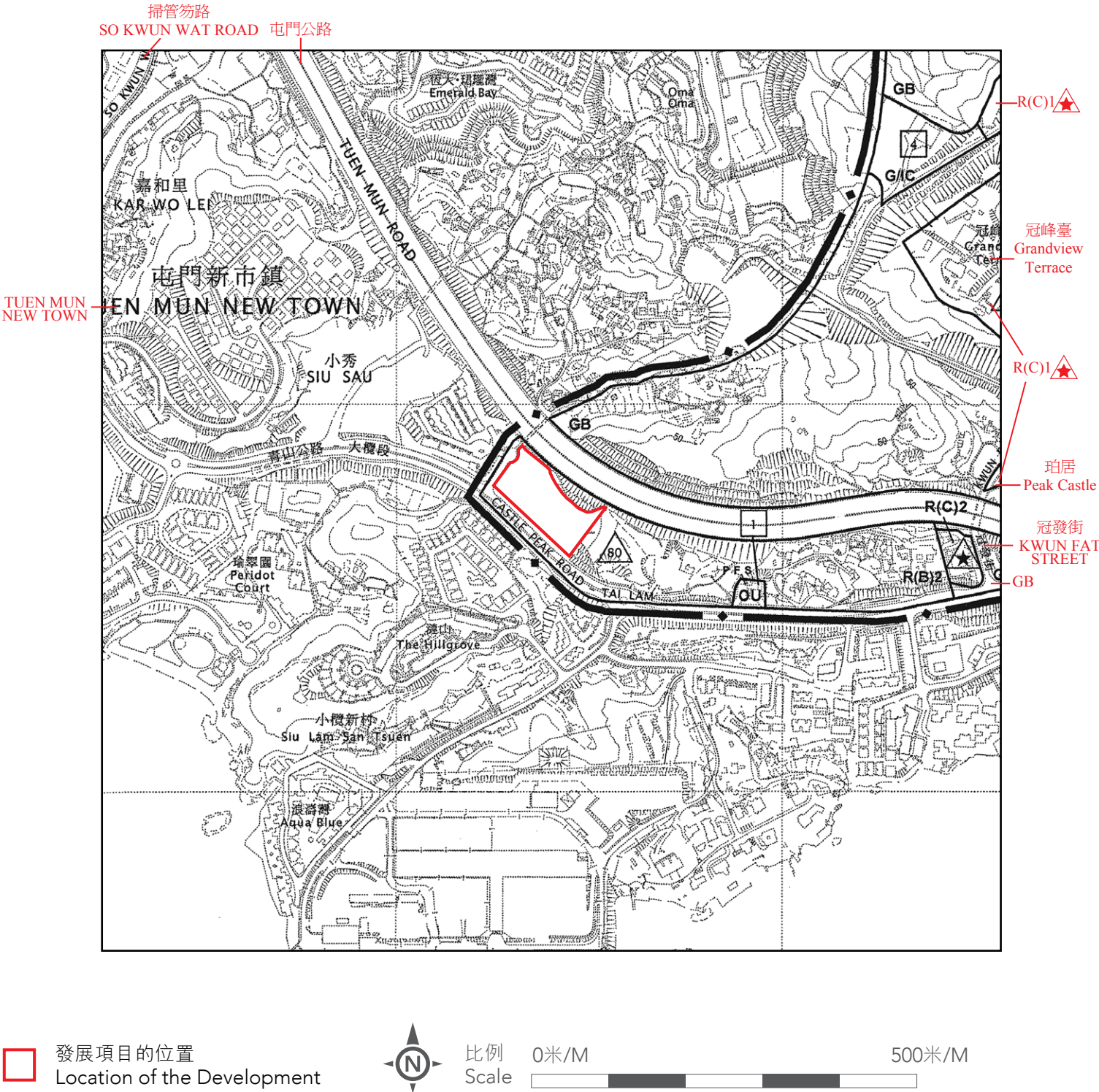

圖例 Notation

地帶 Zones

R(B)	住宅(乙類) Residential (Group B)
R(C)	住宅(丙類) Residential (Group C)
G/I/C	政府、機構或社區 Government, Institution or Community
OU	其他指定用途 Other Specified Uses
GB	綠化地帶 Green Belt

交通 Communications

	主要道路及路口 Major Road and Junction
--	------------------------------------

其他 Miscellaneous

	規劃範圍界線 Boundary of Planning Scheme
	最高建築物高度(在主水平基準上若干米) Maximum Building Height (In Metres Above Principal Datum)
	《註釋》內訂明最高建築物高度限制 Maximum Building Height restriction as stipulated on the notes
	最高建築物高度(樓層數目) Maximum Building Height (In number of storeys)
P F S	加油站 Petrol Filling Station

- 備註：
- 在印刷樓說明書當日所適用的最近期分區計劃大綱圖及其附表，可於售樓處開放時間內免費查閱。
 - 賣方建議準買家到有關發展地盤作實地考察，以對該發展地盤、其周邊地區環境及附近的公共設施有較佳了解。
 - 由於發展項目的邊界不規則的技術原因，此分區計劃大綱圖所顯示的範圍可能超過《一手住宅物業銷售條例》所規定的範圍。
 - 此圖為規劃署遵照城市規劃委員會指示擬備，版權屬香港特別行政區政府，經地政總署准許複印。
- Notes:
- The last updated outline zoning plan and the attached schedule as at the date of printing of the sales brochure is available for free inspection at the sales office during opening hours.
 - The Vendor advises prospective purchasers to conduct an on-site visit for a better understanding of the development site, its surrounding environment and the public facilities nearby.
 - The outline zoning plan may show more than the area required under the Residential Properties (First-hand Sales) Ordinance due to technical reason that the boundary of the Development is irregular.
 - The plan, prepared by the Planning Department under the direction of the Town Planning Board, is reproduced with the permission of the Director of Lands. ©The Government of Hong Kong SAR.

摘錄自2023年10月3日刊憲之掃管笏分區計劃大綱核准圖，圖則編號為S/TM-SKW/15，有需要處經修正處理，以紅色表示。

Adopted from part of the approved So Kwun Wat Outline Zoning Plan, Plan No. S/TM-SKW/15, gazetted on 3 October 2023, with adjustments where necessary as shown in red.