

期數中的建築物的橫截面圖

Cross-section plan of building in the Phase

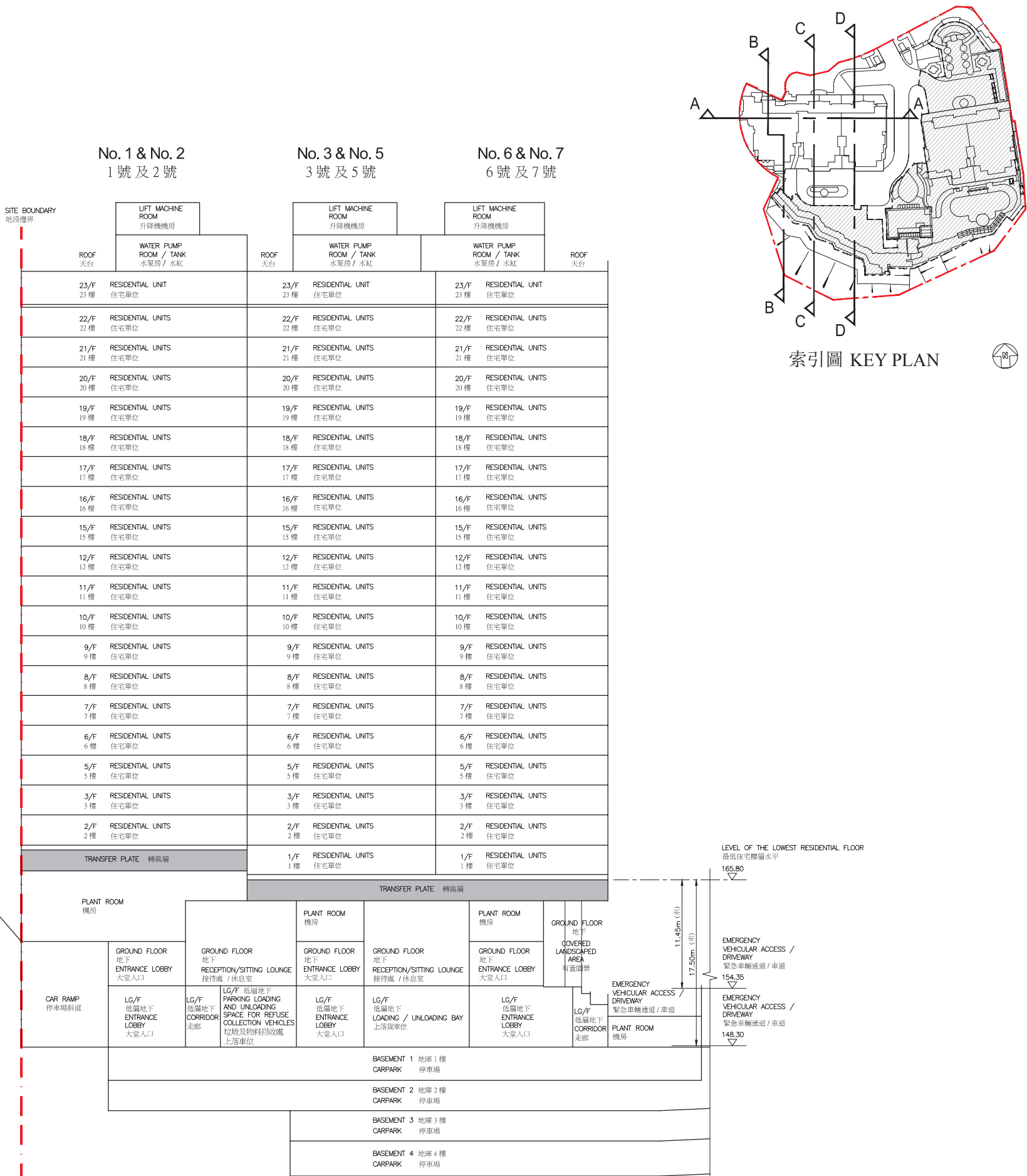

橫截面圖A-A

CROSS SECTION PLAN A-A

- 發展項目第2期
Phase 2 of the Development
- 發展項目的邊界
Boundary of the Development
- 虛線為最低住宅樓層水平
Dotted line denotes the lowest residential floor
- 香港主水平基準以上高度(米)
Height in metres above Hong Kong Principal Datum (HKPD)

毗連建築物的一段緊急車輛通道/車道為香港主水平基準以上148.30至154.35米。
The part of the Emergency Vehicle Access/Driveway adjacent to the building is 148.30 to 154.35 metres above the Hong Kong Principal Datum.

期數中的建築物的橫截面圖

Cross-section plan of building in the Phase

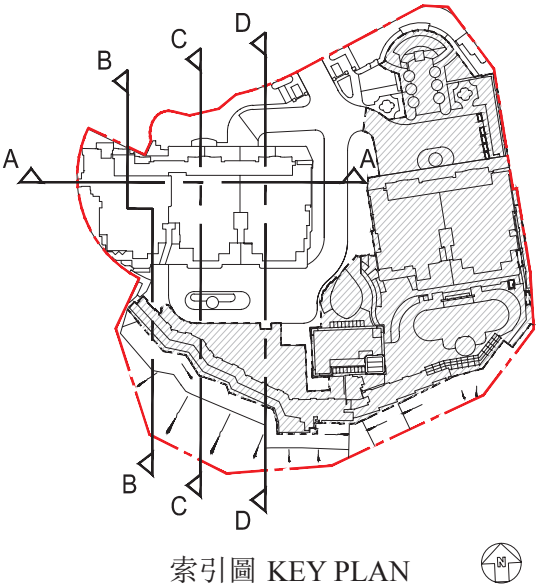

No. 1 & No. 2
1 號及 2 號

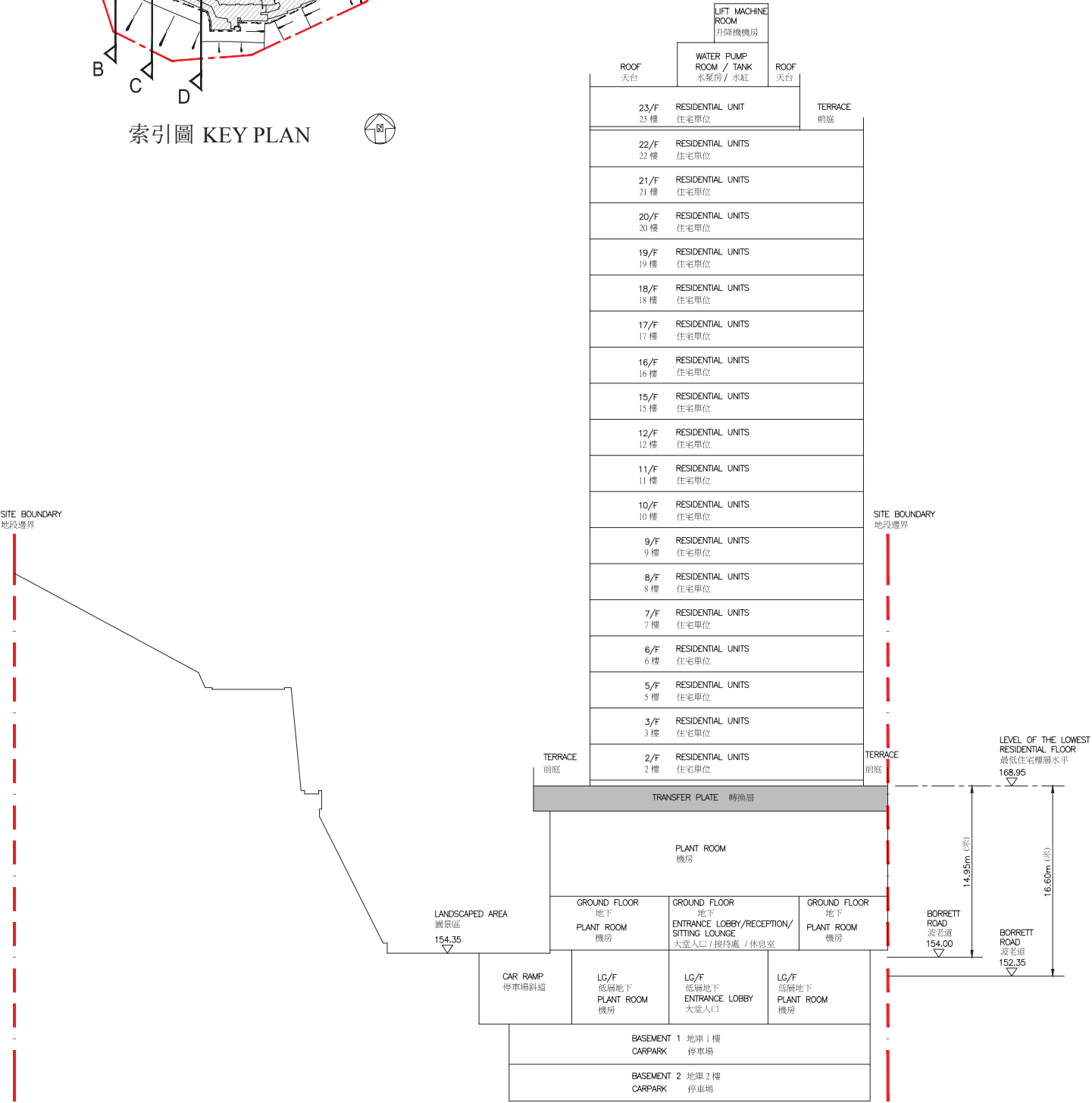

橫截面圖B-B
CROSS SECTION PLAN B-B

毗連建築物的一段波老道為香港主水平基準以上152.35至154.00米。
The part of the Borrett Road adjacent to the building is 152.35 to 154.00 metres above the Hong Kong Principal Datum.

- 發展項目第2期
Phase 2 of the Development
- 發展項目的邊界
Boundary of the Development
- 虛線為最低住宅樓層水平
Dotted line denotes the lowest residential floor
- 香港主水平基準以上高度(米)
Height in metres above Hong Kong Principal Datum (HKPD)

期數中的建築物的橫截面圖

Cross-section plan of building in the Phase

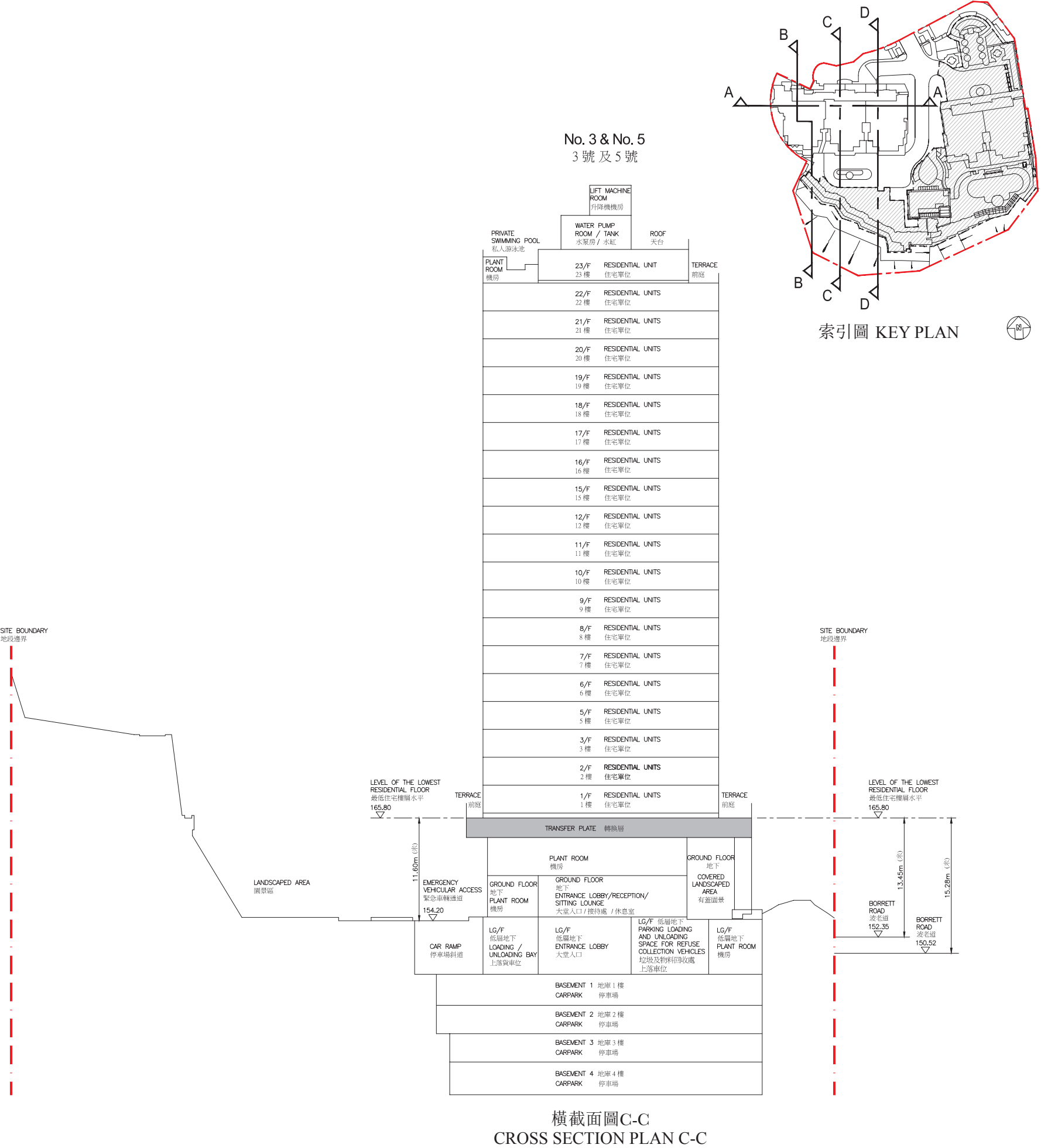

橫截面圖C-C
CROSS SECTION PLAN C-C

毗連建築物的一段波老道為香港主水平基準以上150.52至152.35米。

The part of the Borrett Road adjacent to the building is 150.52 to 152.35 metres above the Hong Kong Principal Datum.

- 發展項目第2期
Phase 2 of the Development
- 發展項目的邊界
Boundary of the Development
- 虛線為最低住宅樓層水平
Dotted line denotes the lowest residential floor
- 香港主水平基準以上高度(米)
Height in metres above Hong Kong Principal Datum (HKPD)

期數中的建築物的橫截面圖

Cross-section plan of building in the Phase

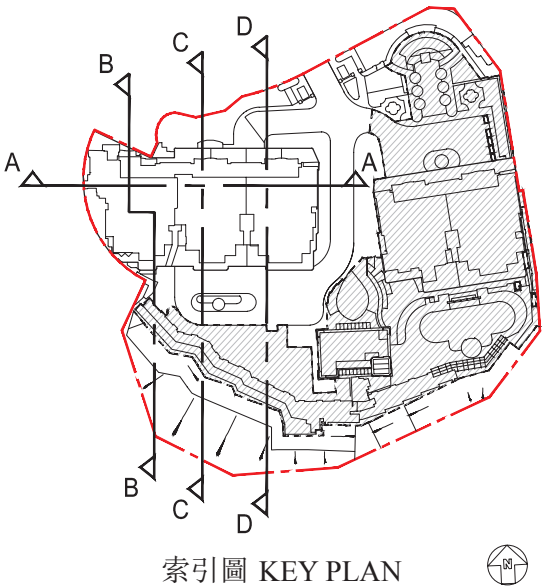

索引圖 KEY PLAN



No. 6 & No. 7
6 號及 7 號

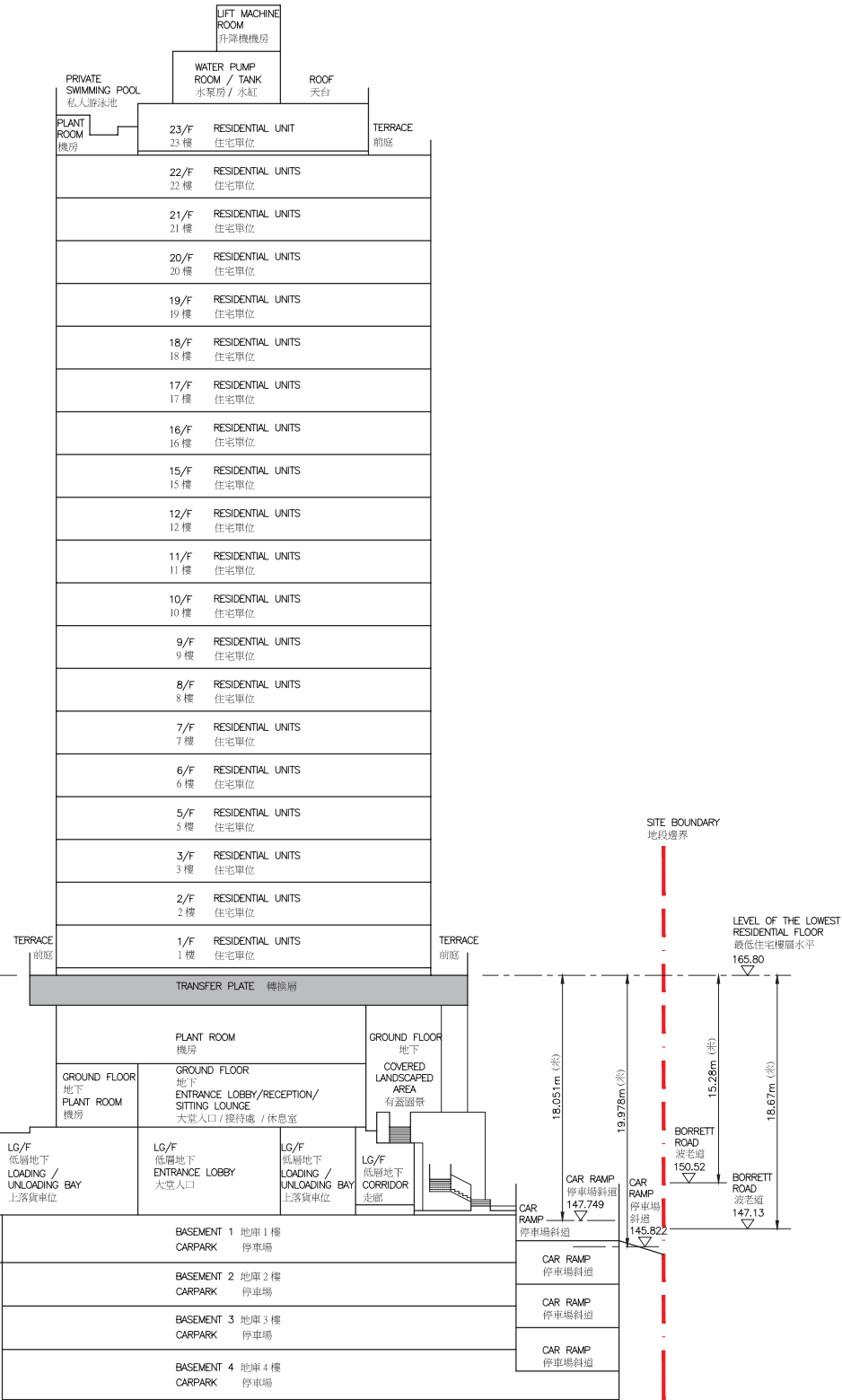

橫截面圖D-D
CROSS SECTION PLAN D-D

毗連建築物的一段波老道為香港主水平基準以上147.13至150.52米。
The part of the Borrett Road adjacent to the building is 147.13 to 150.52 metres above the Hong Kong Principal Datum.

毗連建築物的一段停車場斜道為香港主水平基準以上145.822至147.749米。
The part of the Car Ramp adjacent to the building is 145.822 to 147.749 metres above the Hong Kong Principal Datum.

- 發展項目第2期
Phase 2 of the Development
- 發展項目的邊界
Boundary of the Development
- 虛線為最低住宅樓層水平
Dotted line denotes the lowest residential floor
- 香港主水平基準以上高度(米)
Height in metres above Hong Kong Principal Datum (HKPD)