

摘錄自 2024 年 11 月 8 日刊憲之旺角 (九龍規劃區第 3 區) 分區計劃大綱核准圖，圖則編號為 S/K3/38，經修正處理。

Extracted from the approved Mong Kok (Kowloon Planning Area No. 3) Outline Zoning Plan, Plan No. S/K3/38, gazetted on 8 November 2024, with adjustments where necessary.

圖例 NOTATION

地帶 ZONES

- | | |
|--------------|--|
| C | 商業
Commercial |
| R(A) | 住宅(甲類)
Residential (Group A) |
| R(E) | 住宅(戊類)
Residential (Group E) |
| G/I/C | 政府、機構或社區
Government, Institution or Community |
| O | 休憩用地
Open Space |
| OU | 其他指定用途
Other Specified Uses |

其他 MISCELLANEOUS

- | | |
|------------|--|
| | 規劃範圍界線
Boundary of Planning Scheme |
| | 市區重建局發展計劃圖範圍
Urban Renewal Authority Development Scheme Plan Area |
| | 建築物高度管制區界線
Building Height Control Zone Boundary |
| | 最高建築物高度(在主水平基準上若干米)
Maximum Building Height (In metres above Principal Datum) |
| | 最高建築物高度(樓層數目)
Maximum Building Height (In number of storeys) |
| PFS | 加油站
Petrol Filling Station |
| NBA | 非建築用地
Non-Building Area |

交通 COMMUNICATIONS

- | | |
|--|--|
| | 鐵路及車站 (地下) Railway and Station (Underground) |
| | 主要道路及路口 Major Road and Junction |
| | 高架道路 Elevated Road |

此區的土地用途地帶見市區重建局山東街/地士道街發展計劃圖。
FOR ZONING OF THIS AREA, REFER TO URBAN RENEWAL AUTHORITY SHANTUNG STREET / THISTLE STREET DEVELOPMENT SCHEME PLAN.

備註：因技術性問題，此分區計劃大綱圖所顯示的範圍超過《一手住宅物業銷售條例》的規定。

Note: Due to technical reasons, this outline zoning plan has shown more than the area required under the Residential Properties (First-hand Sales) Ordinance.

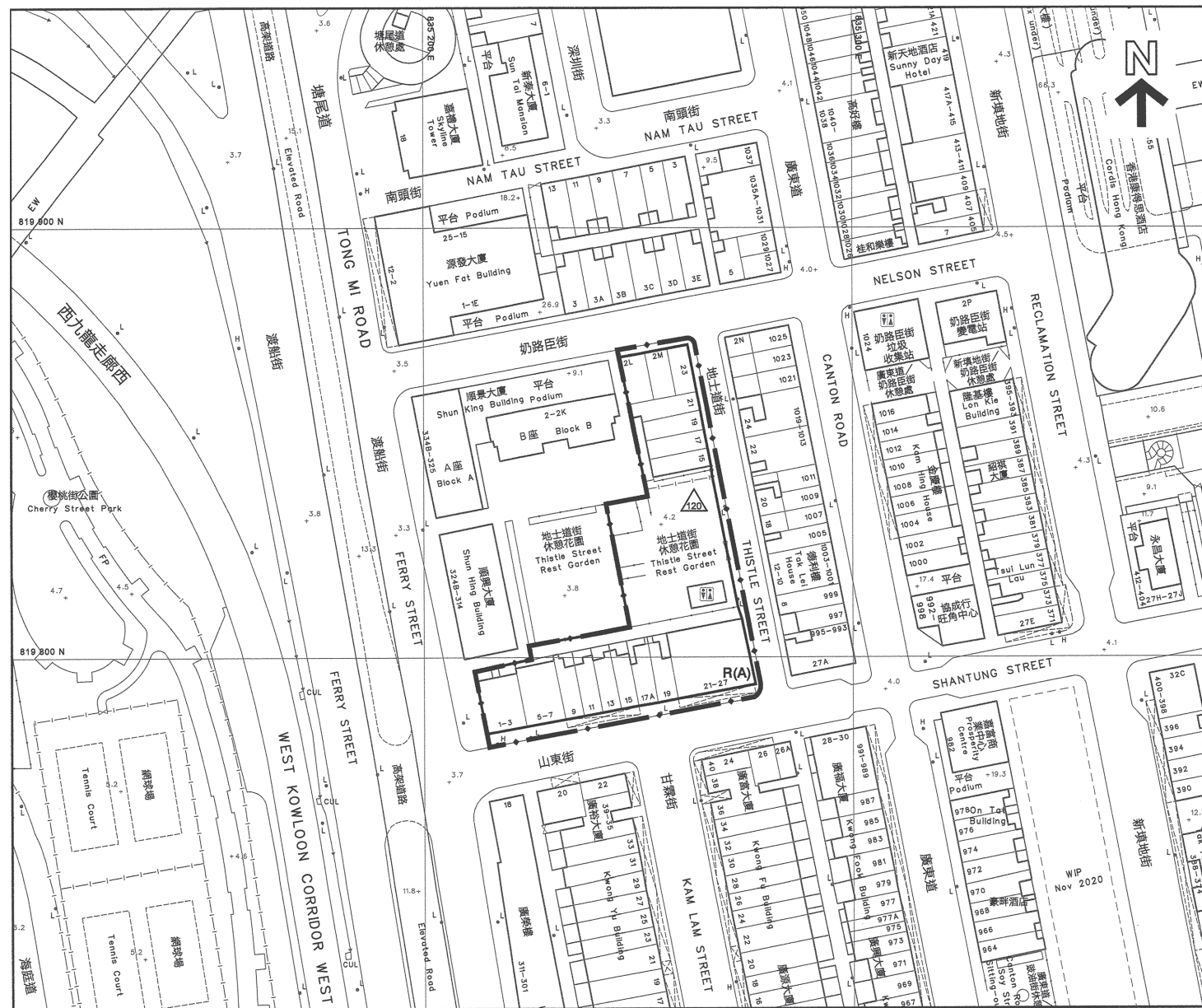

比例：20 0 20 40 60 80
Scale : METRES 米

摘錄自行政長官會同行政會議於 2022 年 2 月 8 日根據城市規劃條例第 9(1)(a) 條核准之香港城市規劃委員會依據城市規劃條例擬備的市區重建局山東街 / 地士道街發展計劃圖，圖則編號為 S/K3/URA4/2。

Adopted from Town Planning Ordinance, Hong Kong Town Planning Board Urban Renewal Authority Shantung Street / Thistle Street Development Scheme Plan with Plan No. S/K3/URA4/2 approved by the Chief Executive in Council under Section 9(1)(a) of the Town Planning Ordinance on 8 February 2022.

圖例 NOTATION

-  發展計劃範圍界線
Boundary of Development Scheme
-  住宅(甲類)
Residential (Group A)
-  主要道路及路口
Major Road and Junction
-  最高建築物高度(在主水平基準上若干米)
Maximum Building Height (In metres above Principal Datum)

備註：因技術性問題，此分區計劃大綱圖所顯示的範圍超過《一手住宅物業銷售條例》的規定。

Note : Due to technical reasons, this outline zoning plan has shown more than the area required under the Residential Properties (First-hand Sales) Ordinance.

關乎發展項目的分區計劃大綱圖等
OUTLINE ZONING PLAN ETC. RELATING TO THE DEVELOPMENT

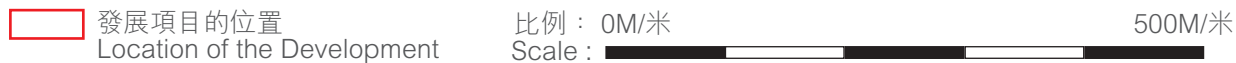

20

Extracted from the approved South West Kowloon (Kowloon Planning Area No. 20) Outline Zoning Plan, Plan No. S/K20/30, gazetted on 3 October 2014, with adjustments where necessary.

地帶 ZONES

OU 其他指定用途
Other Specified Uses

交通 COMMUNICATIONS

 高架道路 Elevated Road

行政長官會同行政會議於2009年10月20日根據鐵路條例(第519章)批准廣深港高速鐵路香港段方案，有關方案的鐵路顯示在這份圖則上，只供參考之用。

THE RAILWAY AS DESCRIBED IN THE RAILWAY SCHEME FOR THE HONG KONG SECTION OF THE GUANGZHOU - SHENZHEN - HONG KONG EXPRESS RAIL LINK AUTHORIZED BY THE CHIEF EXECUTIVE IN COUNCIL UNDER THE RAILWAYS ORDINANCE (CHAPTER 519) ON 20.10.2009 IS SHOWN ON THIS PLAN FOR INFORMATION ONLY.