

18 發展項目中的建築物的橫截面圖  
Cross-Section Plan of Building in the Development

第1座 Tower 1  
橫截面圖 A-A Cross-Section Plan A-A



- 備註：
- （▽）表示香港主水平基準以上高度（米）。
  - 虛線為最低住宅樓層水平。
  - 賣方亦建議買方到該發展地盤作實地考察，以獲取對該發展地盤及周圍地區的公共設施及環境較佳的了解。

- Notes:
- （▽）denotes height (in metre) above Hong Kong Principal Datum.
  - Dotted line denotes the lowest residential floor.
  - The Vendor also advises purchasers to conduct on site visit for a better understanding of the Development site, its surrounding environment and the public facilities nearby.

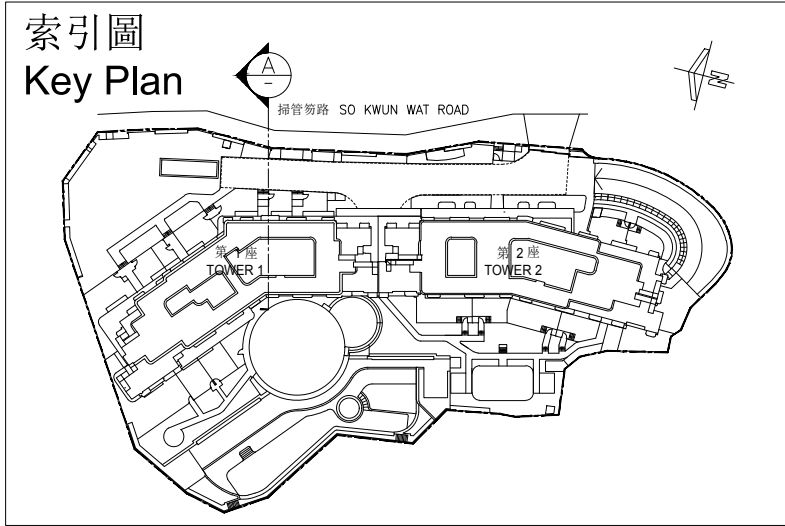

18 發展項目中的建築物的橫截面圖  
Cross-Section Plan of Building in the Development

第2座 Tower 2  
橫截面圖 B-B Cross-Section Plan B-B

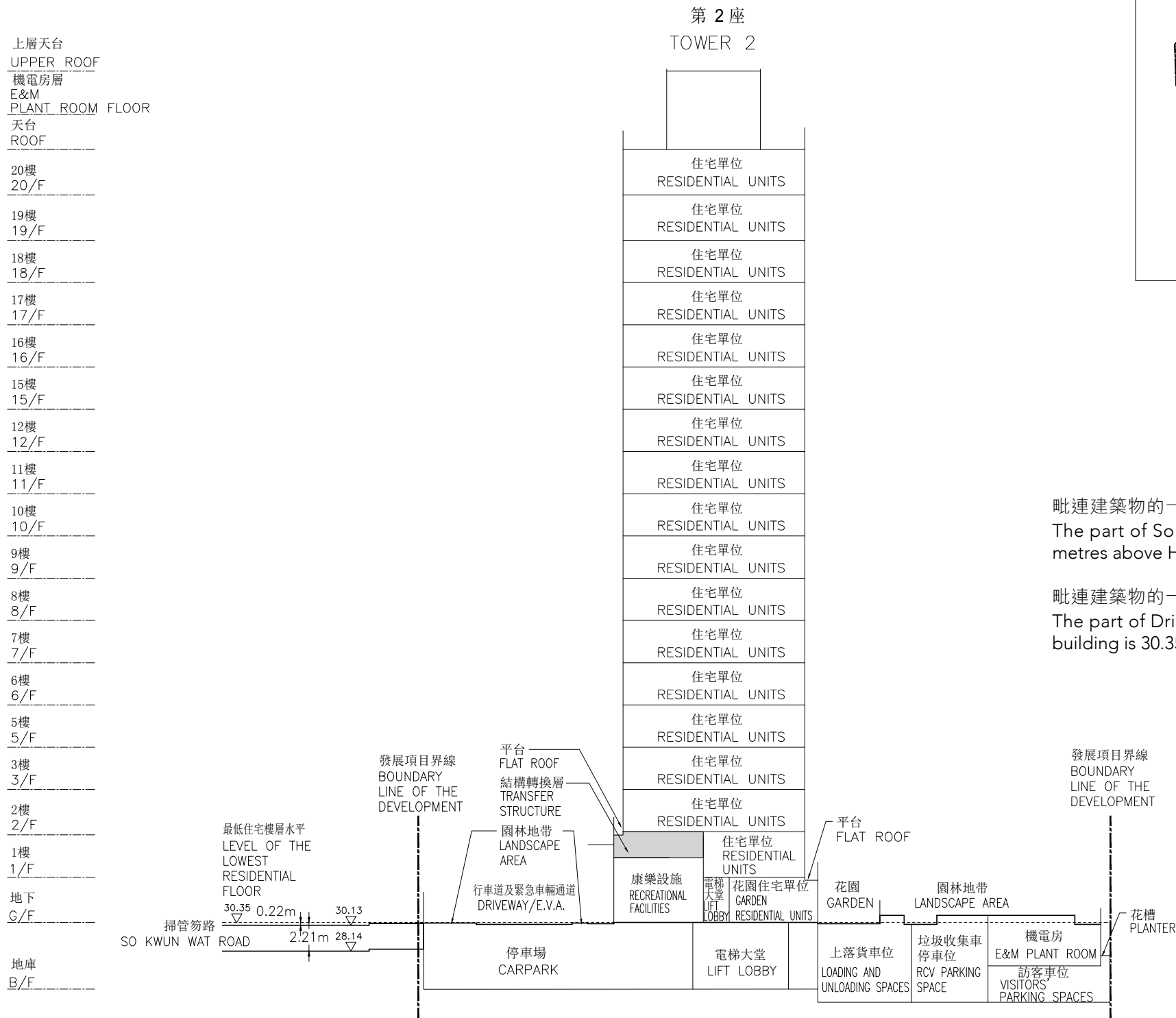

- 備註：
- (▽) 表示香港主水平基準以上高度 (米)。
  - 虛線為最低住宅樓層水平。
  - 賣方亦建議買方到該發展地盤作實地考察，以獲取對該發展地盤及周圍地區的公共設施及環境較佳的了解。

- Notes:
- (▽) denotes height (in metre) above Hong Kong Principal Datum.
  - Dotted line denotes the lowest residential floor.
  - The Vendor also advises purchasers to conduct on site visit for a better understanding of the Development site, its surrounding environment and the public facilities nearby.

