

## 7 LOCATION PLAN OF THE DEVELOPMENT 發展項目的所在位置圖

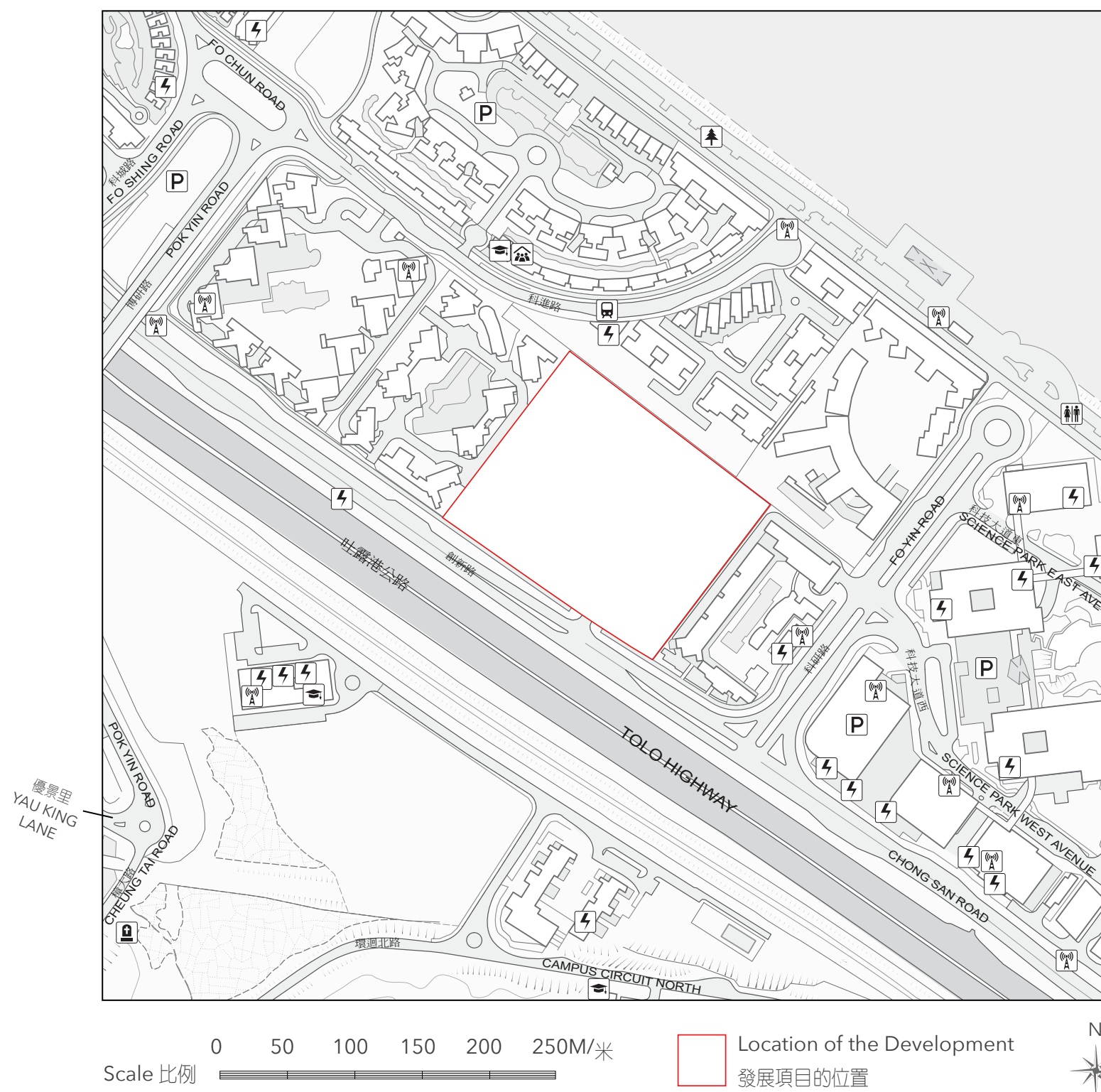

The map is provided by the CSDI Portal and intellectual property rights are owned by the Government of the HKSAR.

地圖由空間數據共享平台提供，香港特別行政區政府為知識產權擁有人。

The Location Plan is prepared by the Vendor with reference to the Digital Topographic Map No.T7-NE-C dated 2<sup>nd</sup> January 2025 from Survey and Mapping Office of the Lands Department, with adjustments where necessary.

此位置圖是由賣方擬備並參考於 2025 年 1 月 2 日出版之地政總署測繪處之數碼地形圖，圖幅編號 T7-NE-C，有需要處經修正處理。

### NOTATION 圖例

-  A Power Plant (including Electricity Sub-stations)  
發電廠 (包括電力分站)
-  A Cemetery  
墳場
-  A Public Carpark (including a Lorry Park)  
公眾停車場 (包括貨車停泊處)
-  A Public Utility Installation  
公用事業設施裝置
-  A School (including a Kindergarten)  
學校 (包括幼稚園)
-  A Public Park  
公園
-  Social Welfare Facilities (including an Elderly Centre and a Home for the Mentally Disabled)  
社會福利設施 (包括老人中心及弱智人士護理院)
-  A Public Transport Terminal (including a Rail Station)  
公共交通總站 (包括鐵路車站)
-  A Public Convenience  
公廁

Notes :

1. The Vendor advises prospective purchasers to conduct an on-site visit for a better understanding of the Development site, its surrounding environment and the public facilities nearby.
2. The Location Plan may show more than the area required under the Residential Properties (First-hand Sales) Ordinance due to technical reason that the boundary of the Development is irregular.

附註：

1. 賣方建議準買家到有關發展地盤作實地考察，以對該發展地盤、其周邊地區環境及附近的公共設施有較佳了解。
2. 由於發展項目的邊界不規則的技術原因，此位置圖所顯示的範圍可能超過《一手住宅物業銷售條例》所規定的範圍。