

發展項目中的建築物的橫截面圖  
CROSS-SECTION PLAN OF BUILDING IN THE DEVELOPMENT

橫截面圖 A-A  
CROSS-SECTION PLAN A-A

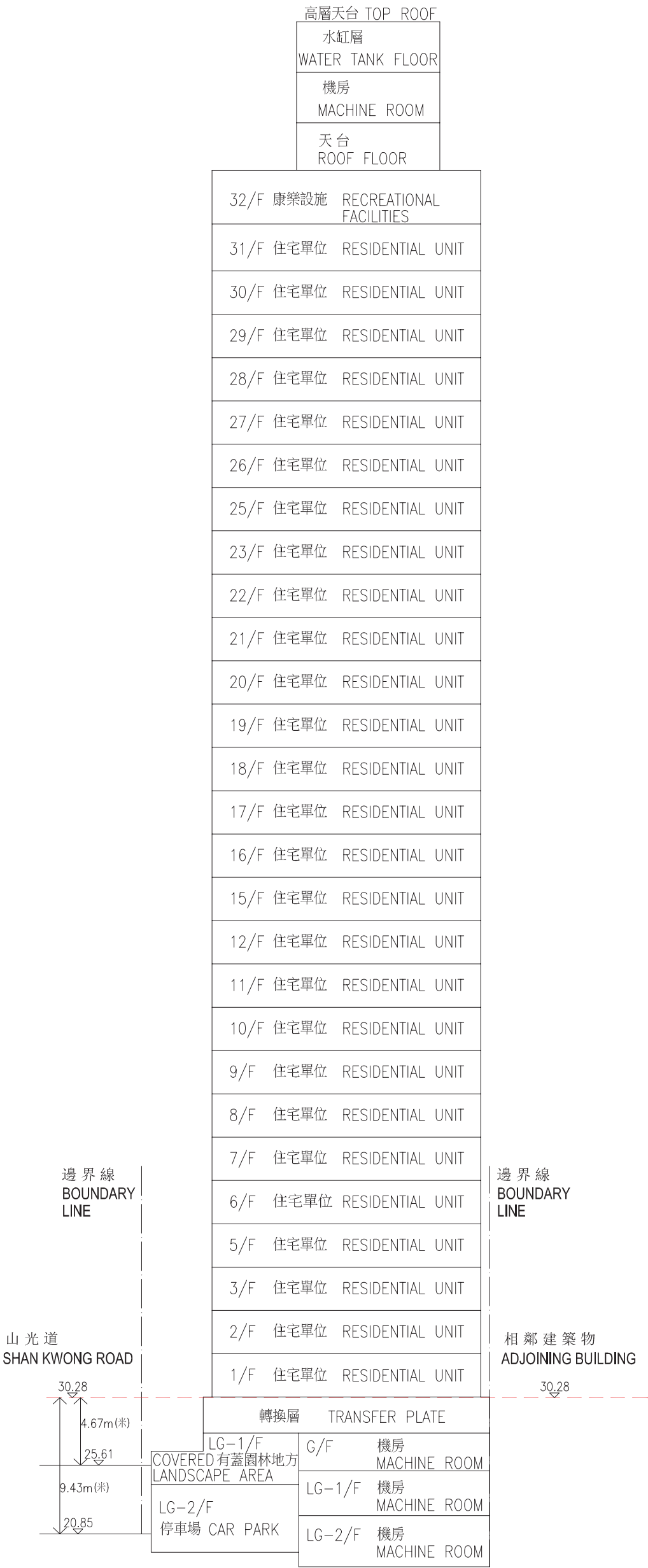

座向圖  
BLOCK PLAN

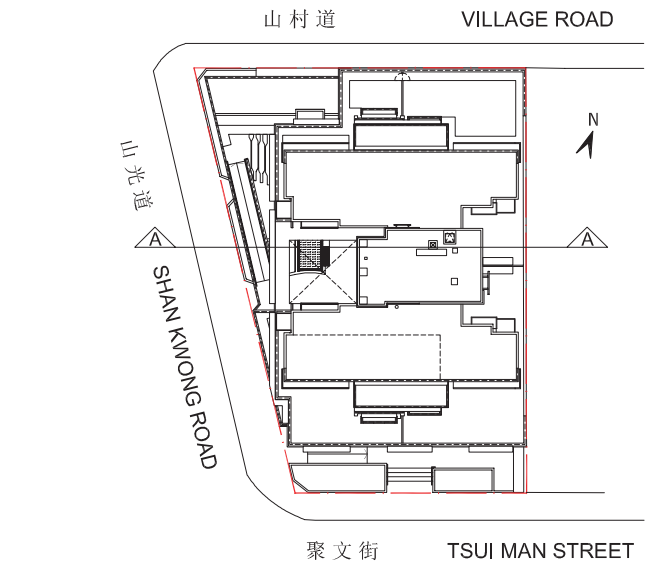

毗連建築物的一段山光道為香港主水平基準以上20.85米至25.61米。  
The part of Shan Kwong Road adjacent to the building is 20.85 metres to 25.61 metres above Hong Kong Principal Datum (HKPD).

為最低住宅樓層水平。  
in the cross section plan denotes the lowest residential floor.

# 發展項目中的建築物的橫截面圖

## CROSS-SECTION PLAN OF BUILDING IN THE DEVELOPMENT

橫截面圖 B-B  
CROSS-SECTION PLAN B-B

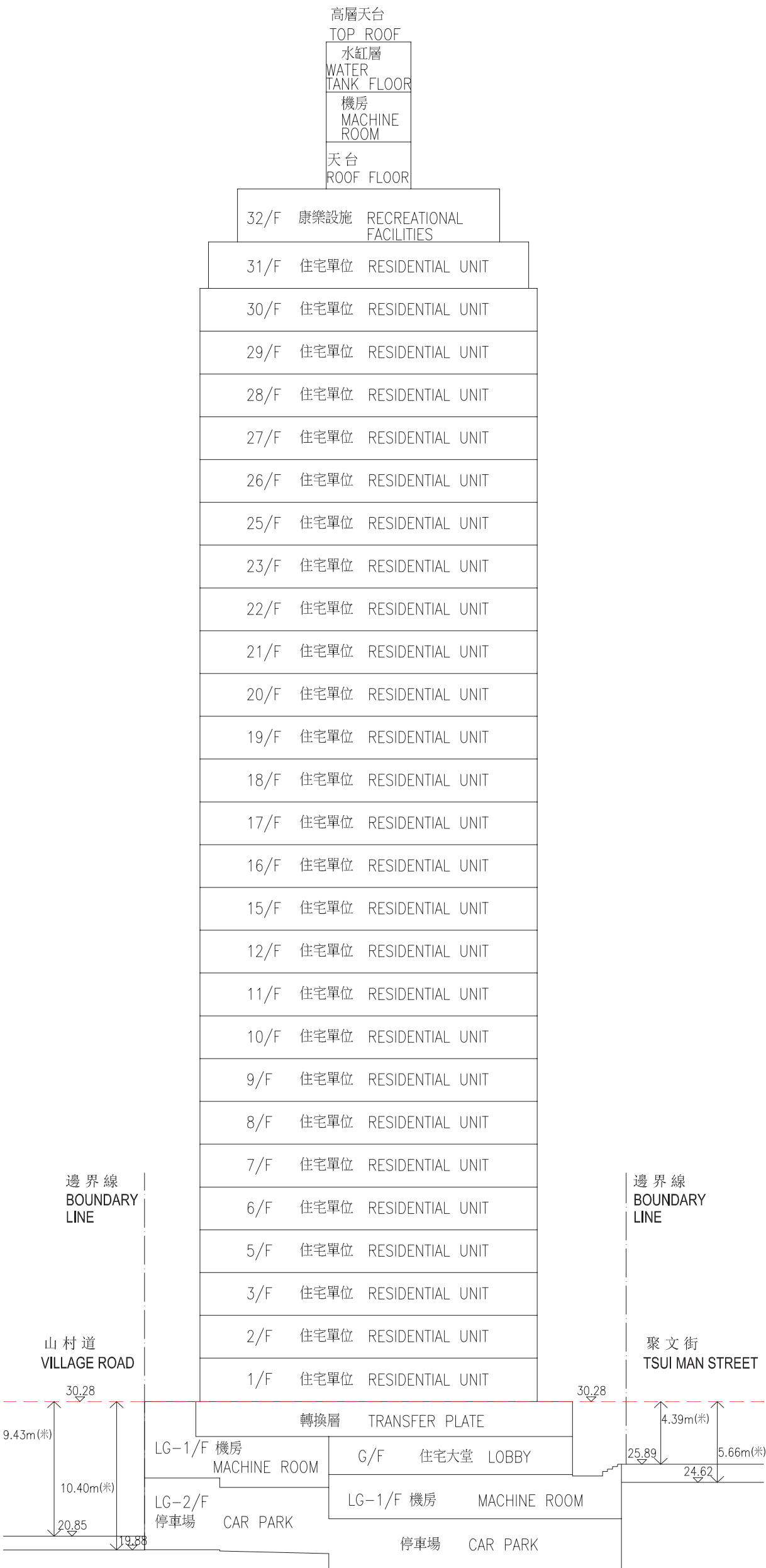

座向圖  
BLOCK PLAN

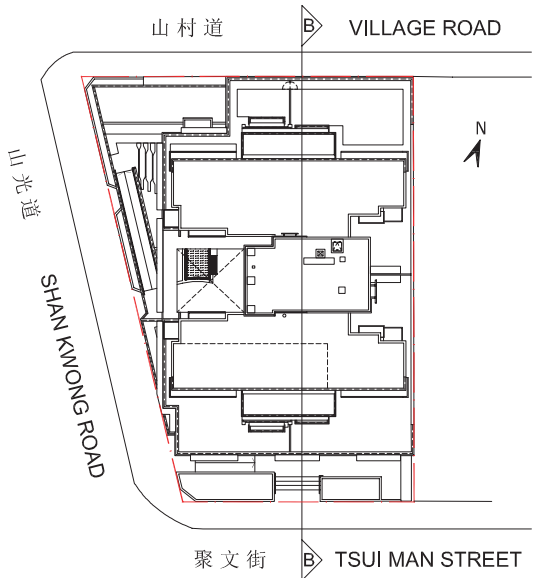

毗連建築物的一段山村道為香港主水平基準以上19.88米至20.85米。

The part of Village Road adjacent to the building is 19.88 metres to 20.85 metres above Hong Kong Principal Datum (HKPD).

毗連建築物的一段聚文街為香港主水平基準以上24.62米至25.89米。

The part of Tsui Man Street adjacent to the building is 24.62 metres to 25.89 metres above Hong Kong Principal Datum (HKPD).

為最低住宅樓層水平。

in the cross section plan denotes the lowest residential floor.