

Layout plan of the development
發展項目的布局圖

The estimated date of completion of the buildings and facilities in the Development, as provided by the Authorized Person for the Development:

由發展項目的認可人士提供的發展項目內的建築物及設施的預計落成日期：

Phase 期數	Buildings and Facilities 建築物及設施	Estimated Date of Completion 預計落成日期
1	Tower 2, Tower 3 and Facilities of Phase 1 第2座、第3座及第1期之設施	30 June 2022 2022年6月30日
2	Tower 5, Tower 6, Tower 7 and Facilities of Phase 2 第5座、第6座、第7座及第2期之設施	31 August 2022 2022年8月31日
3	Tower 1, Tower 8 and Facilities of Phase 3 第1座、第8座及第3期之設施	22 January 2023 2023年1月22日
4	Commercial Development, Bicycle Park, Public Transport Interchange and Facilities of Phase 4 商業發展項目、自行車停車場、公共運輸交匯處及第4期之設施	30 June 2022 2022年6月30日
5	Post Secondary College (Structural Shell and External Façade) and Facilities of Phase 5 專上教育學院(結構外殼及外正面)及第5期之設施	30 June 2022 2022年6月30日

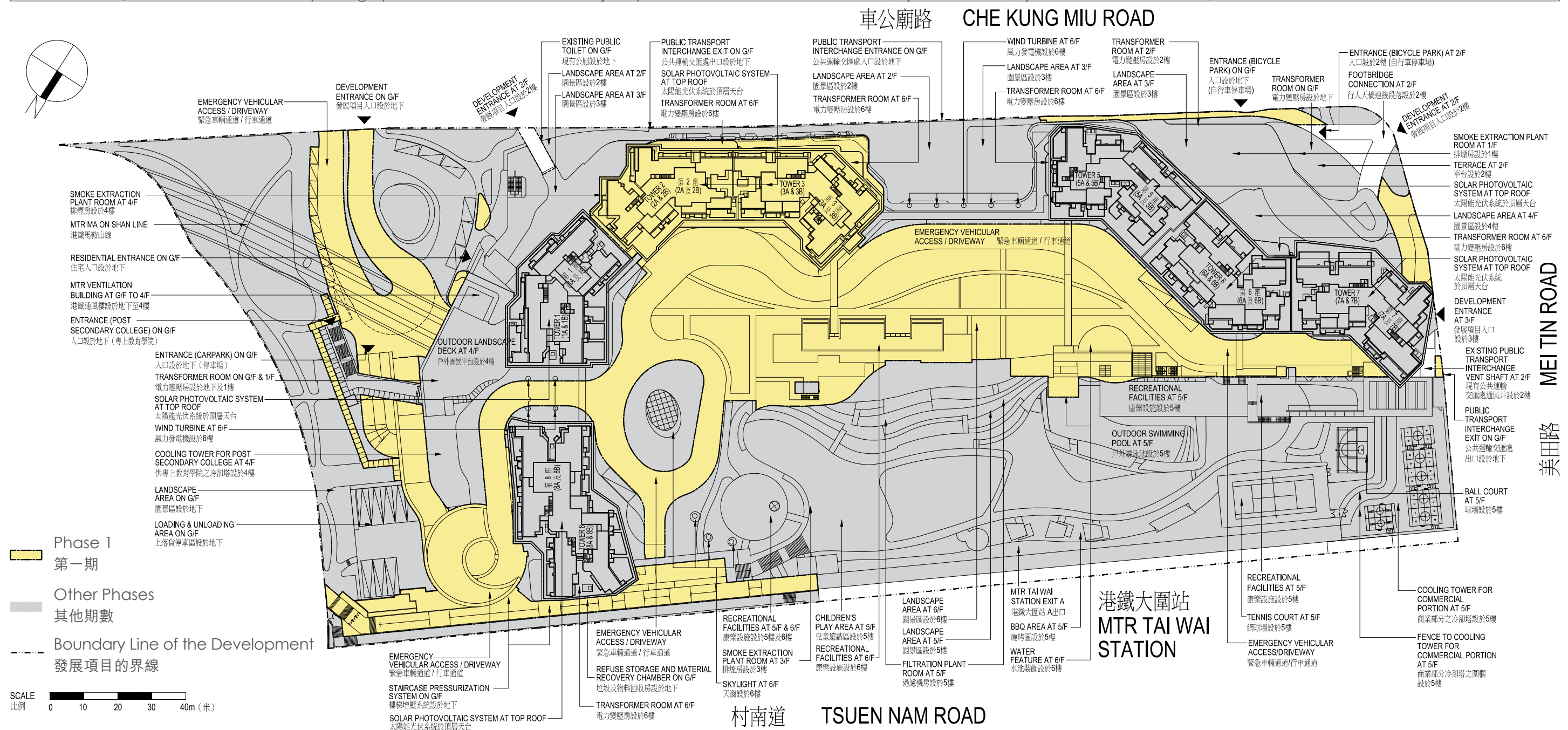

Remarks :

1. Floodlights will be provided for lighting of the outdoor swimming pool of the Development in the evening. Prospective purchasers please note the impact (if any) of the illumination of such lighting system on individual residential unit.
2. Mass Transit Railway ("MTR") ventilation building, cooling tower for Post Secondary College and commercial portion, fence to cooling tower for commercial portion and existing vent shaft for Public Transport Interchange forming parts of the Development may affect the view of the residential properties at lower floors.
3. MTR ventilation building, residents' clubhouse water feature, cooling tower for Post Secondary College and commercial portion, smoke extraction system for commercial portion, staircase pressurization system serving basement and existing vent shaft for Public Transport Interchange forming parts of the Development may emit sounds and affect the enjoyment to the residential properties.

備註：

1. 發展項目之室外泳池會裝設泛光燈以供室外泳池的晚間照明。請準買家注意該等照明系統的照明對個別住宅單位造成的影響 (如有)。
2. 組成發展項目一部分的港鐵通風樓、專上教育學院和商業部分之冷卻塔、商業部分冷卻塔之圍欄及公共運輸交匯處的通風口可能會影響位於低層住宅物業的景觀。
3. 組成發展項目一部分的港鐵通風樓、住客會所的水池裝飾、專上教育學院和商業部分之冷卻塔、商業部分之排煙系統、地庫之樓梯增壓系統及公共運輸交匯處的通風口可能釋放聲音及對享用住宅物業造成影響。