

CROSS-SECTION PLAN OF BUILDING IN THE PHASE 期數中的建築物的橫截面圖

Cross Section A-A
橫截面圖A-A

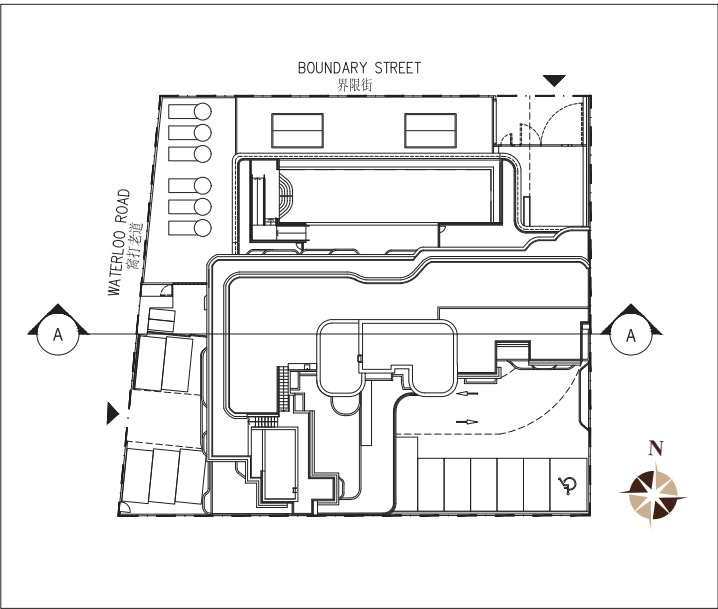
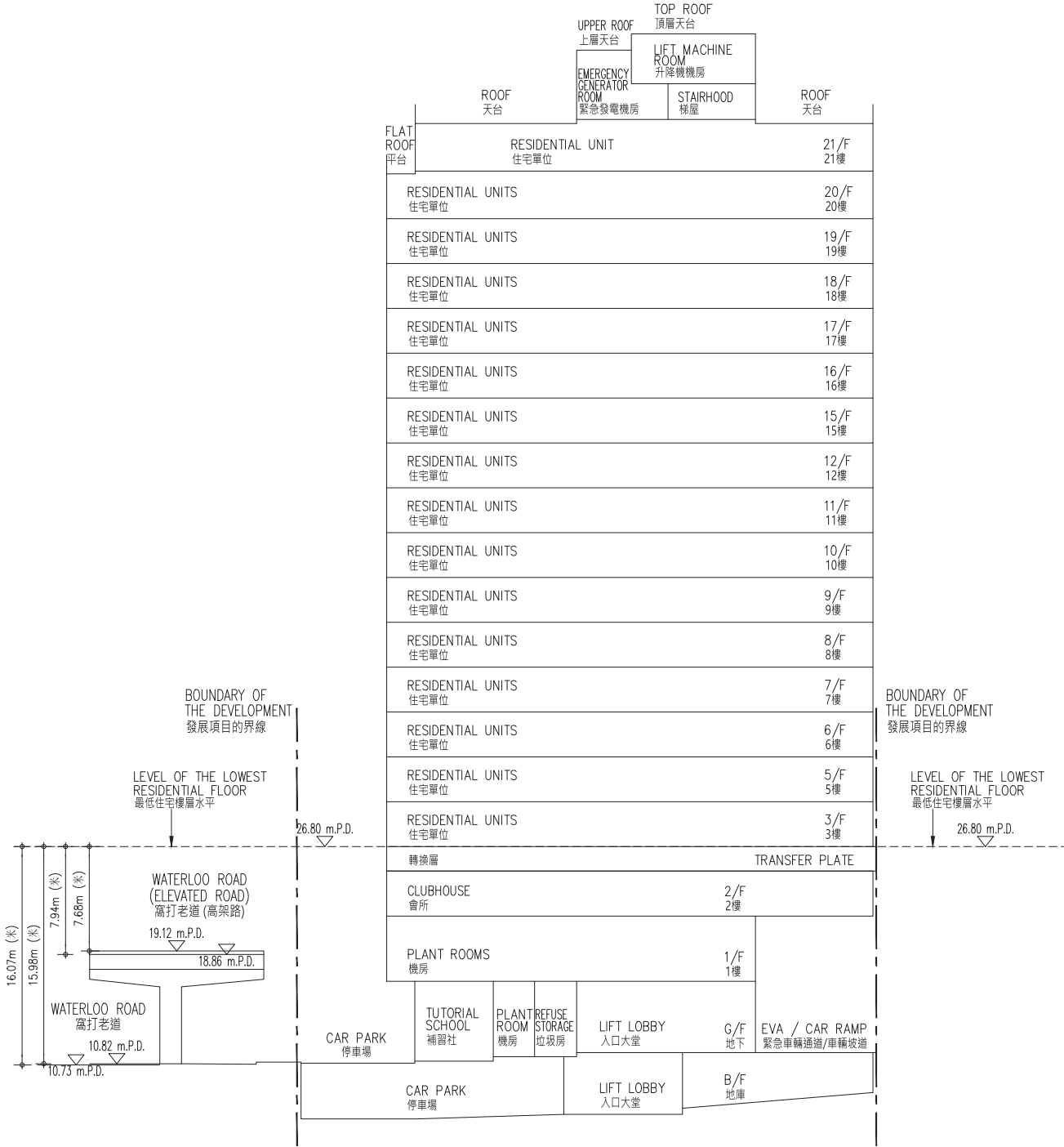

Key Plan
索引圖

- Dotted line denotes the lowest residential floor level of building.
- ▽ denotes height (in metre) above the Hong Kong Principal Datum.
- The part of Waterloo Road adjacent to the building is 10.73 metres to 10.82 metres above the Hong Kong Principal Datum.
- The part of Waterloo Road (elevated road) adjacent to the building is 18.86 metres to 19.12 metres above the Hong Kong Principal Datum.

- 虛線為該建築物最低住宅樓層水平。
- ▽ 代表香港主水平基準以上的高度（米）。
- 毗連建築物的一段窩打老道為香港主水平基準以上10.73米至10.82米。
- 毗連建築物的一段窩打老道（高架路）為香港主水平基準以上18.86米至19.12米。

CROSS-SECTION PLAN OF BUILDING IN THE PHASE
期數中的建築物的橫截面圖

Cross Section B-B
橫截面圖B-B

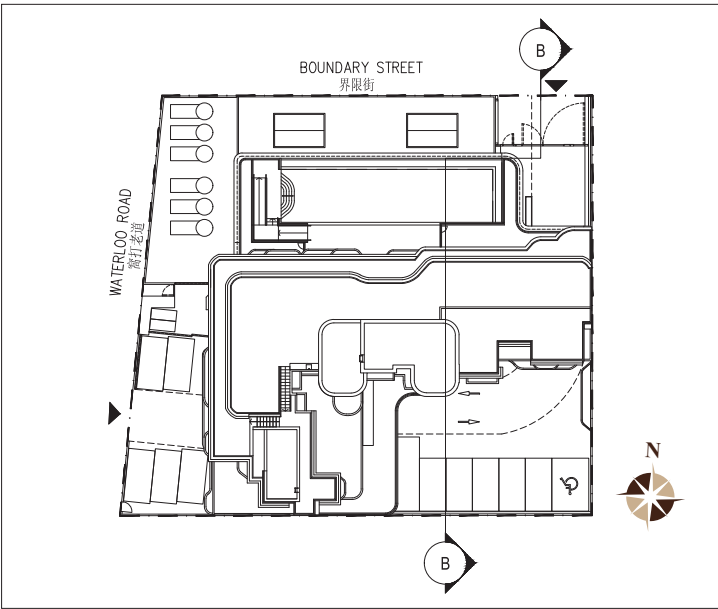
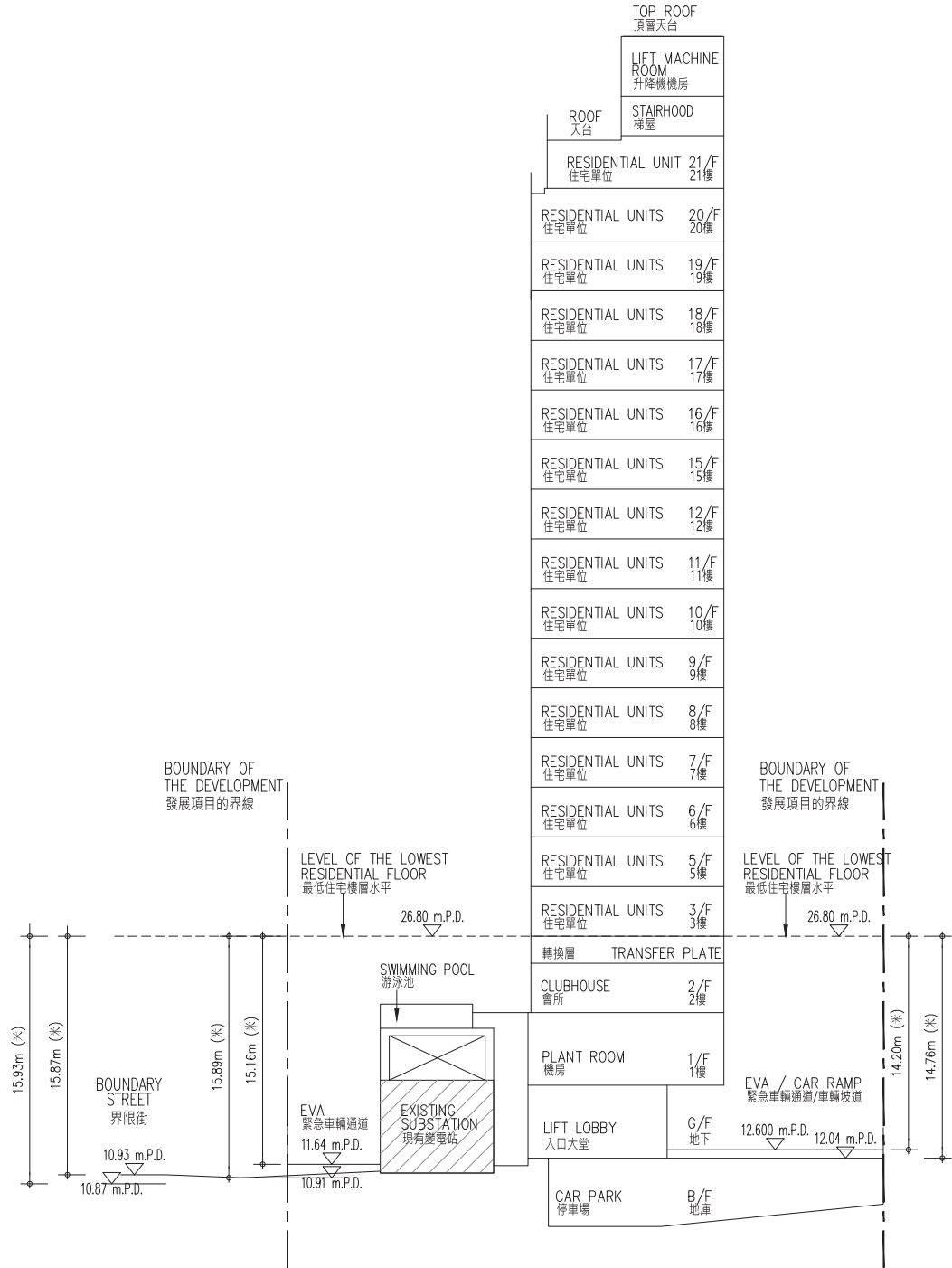

Key Plan
索引圖

1. ----- Dotted line denotes the lowest residential floor level of building.
2. ∇ denotes height (in metre) above the Hong Kong Principal Datum.
3. The part of the Emergency Vehicular Access (EVA) / Car Ramp adjacent to the building is 12.04 metres to 12.600 metres above the Hong Kong Principal Datum.
4. The part of the Emergency Vehicular Access (EVA) adjacent to the building is 10.91 metres to 11.64 metres above the Hong Kong Principal Datum.
5. The part of Boundary Street adjacent to the building is 10.87 metres to 10.93 metres above the Hong Kong Principal Datum.

1. ----- 虛線為該建築物最低住宅樓層水平。
2. ∇ 代表香港主水平基準以上的高度（米）。
3. 毗連建築物的一段緊急車輛通道/車輛坡道為香港主水平基準以上12.04米至12.600米。
4. 毗連建築物的一段緊急車輛通道為香港主水平基準以上10.91米至11.64米。
5. 毗連建築物的一段界限街為香港主水平基準以上10.87米至10.93米。