

7 LOCATION PLAN OF THE DEVELOPMENT 發展項目的所在位置圖

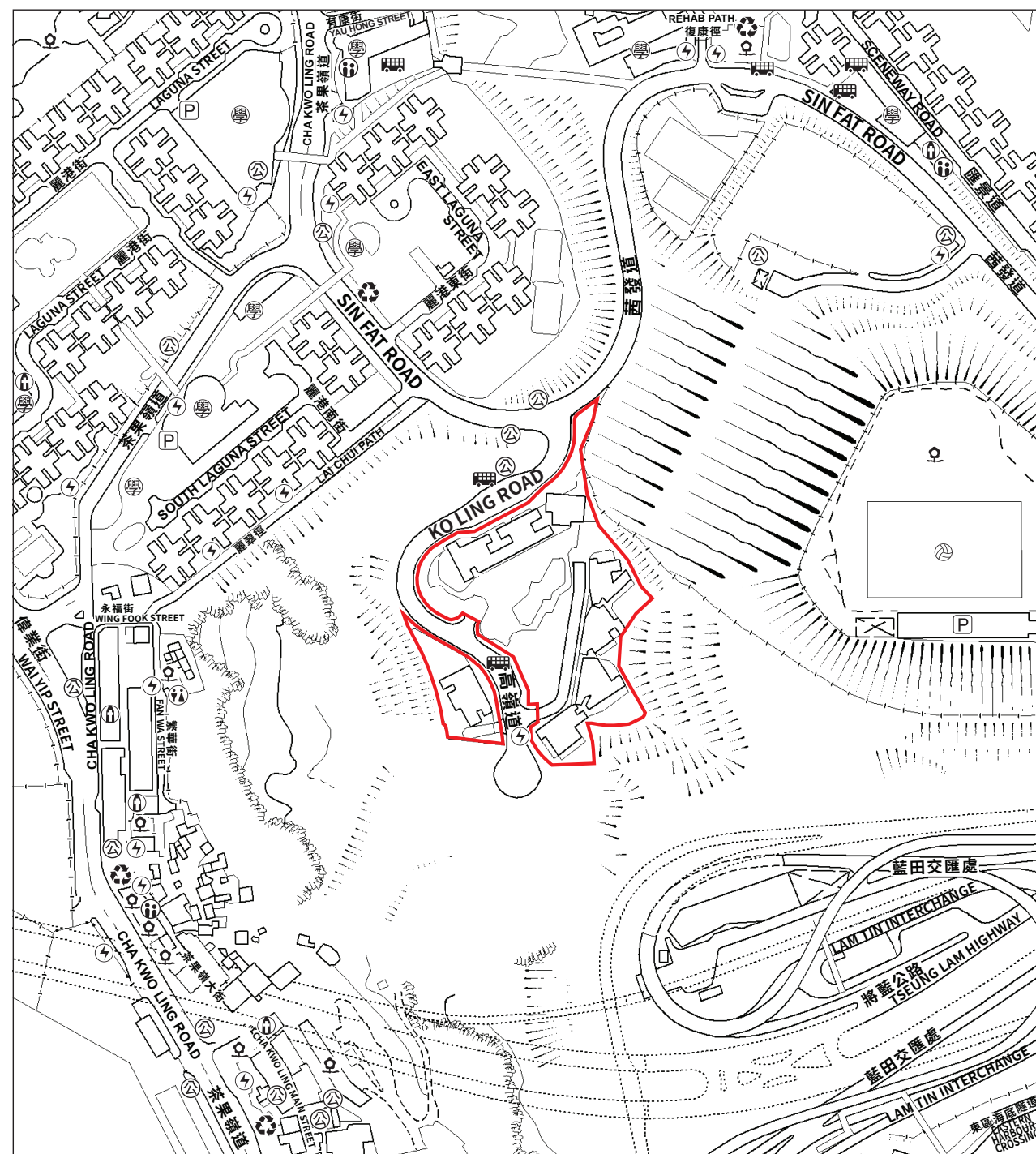

 LOCATION OF THE DEVELOPMENT
發展項目的位置

Scale: 0 50 100 150 200 250 M/米
比例: 0 50 100 150 200 250 M/米

This Location Plan is prepared by the Vendor with reference to the Survey Sheet No. T11-NE-D dated 19th December 2024 and No. T11-SE-B dated 2nd January 2025 from Survey and Mapping Office of the Lands Department.

此位置圖是參考2024年12月19日及2025年1月2日出版之地政總署測繪處之測繪圖，圖幅編號T11-NE-D及T11-SE-B，並由賣方擬備。

NOTATION 圖例

- | | |
|---|---|
| 發電廠 (包括電力分站)
Power plant
(including electricity sub-stations) | 宗教場所 (包括教堂、廟宇及祠堂)
Religious institution (including church,
temple and Tsz Tong) |
| 垃圾收集站 Refuse collection point | 公用事業設施裝置
Public utility installation |
| 公眾停車場 (包括貨車停泊處)
Public carpark (including lorry park) | 學校 (包括幼稚園)
School (including kindergarten) |
| 公廁 Public convenience | 公園 Public park |
| 公共交通總站 (包括鐵路車站)
Public transport terminal
(including rail station) | 體育設施 (包括運動場及游泳池)
Sports facilities (including sports ground
and swimming pool) |
| 社會福利設施
(包括老人中心及弱智人士護理院)
Social welfare facilities (including
elderly centre and home for the
mentally disabled) | |

Notes:

- The vendor advises prospective purchasers to conduct an on-site visit for a better understanding of the development, its surrounding environment and the public facilities nearby.
- The plan may show more than the area required under the Residential Properties (First-hand Sales) Ordinance due to the technical reason that the boundary of the Development is irregular.
- The map reproduced with permission of the Director of Lands. © The Government of Hong Kong SAR Licence No. 47/2020.

附註：

- 賣方建議準買家到該發展項目作實地考察，以對該發展項目、其周邊地區環境及附近的公共設施有較佳了解。
- 由於發展項目的邊界不規則的技術原因，此所在位置圖所顯示之範圍可能多於《一手住宅物業銷售條例》所要求顯示之範圍。
- 地圖版權屬香港特區政府，經地政總署准許複印，版權特許編號47/2020。

The maps are provided by the CSDI Portal and intellectual property rights are owned by the Government of the HKSAR.
地圖由空間數據共享平台提供，香港特別行政區政府為知識產權擁有人。