

7 LOCATION PLAN OF THE DEVELOPMENT

發展項目的所在位置圖

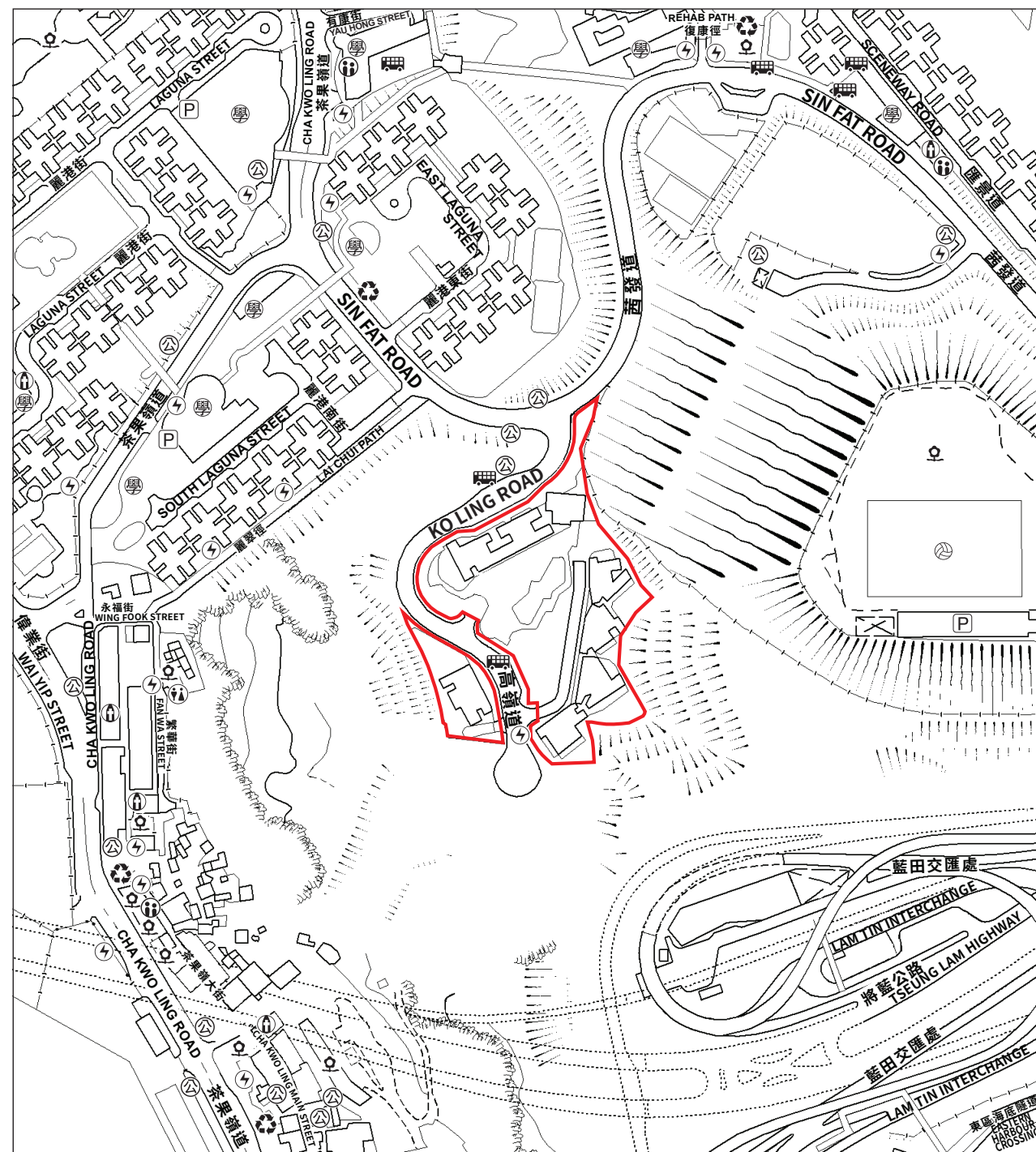

This Location Plan is prepared by the Vendor with reference to the Survey Sheet No. T11-NE-D dated 19th December 2024 and No. T11-SE-B dated 2nd January 2025 from Survey and Mapping Office of the Lands Department.

此位置圖是參考2024年12月19日及2025年1月2日出版之地政總署測繪處之測繪圖，圖幅編號T11-NE-D及T11-SE-B，並由賣方擬備。

NOTATION 圖例

- | | |
|---|--|
|  發電廠 (包括電力分站) Power plant (including electricity sub-stations) |  宗教場所 (包括教堂、廟宇及祠堂) Religious institution (including church, temple and Tsz Tong) |
|  垃圾收集站 Refuse collection point |  公用事業設施裝置 Public utility installation |
|  公眾停車場 (包括貨車停泊處) Public carpark (including lorry park) |  學校 (包括幼稚園) School (including kindergarten) |
|  公廁 Public convenience |  公園 Public park |
|  公共交通總站 (包括鐵路車站) Public transport terminal (including rail station) |  體育設施 (包括運動場及游泳池) Sports facilities (including sports ground and swimming pool) |
|  社會福利設施 (包括老人中心及弱智人士護理院) Social welfare facilities (including elderly centre and home for the mentally disabled) | |

Notes:

- The vendor advises prospective purchasers to conduct an on-site visit for a better understanding of the development, its surrounding environment and the public facilities nearby.
- The plan may show more than the area required under the Residential Properties (First-hand Sales) Ordinance due to the technical reason that the boundary of the Development is irregular.
- The map reproduced with permission of the Director of Lands. © The Government of Hong Kong SAR Licence No. 47/2020.

附註：

- 賣方建議準買家到該發展項目作實地考察，以對該發展項目、其周邊地區環境及附近的公共設施有較佳了解。
- 由於發展項目的邊界不規則的技術原因，此所在位置圖所顯示之範圍可能多於《一手住宅物業銷售條例》所要求顯示之範圍。
- 地圖版權屬香港特區政府，經地政總署准許複印，版權特許編號47/2020。

The maps are provided by the CSDI Portal and intellectual property rights are owned by the Government of the HKSAR. 地圖由空間數據共享平台提供，香港特別行政區政府為知識產權擁有人。