

9 關於發展項目的分區計劃大綱圖等 OUTLINE ZONING PLAN ETC. RELATING TO THE DEVELOPMENT

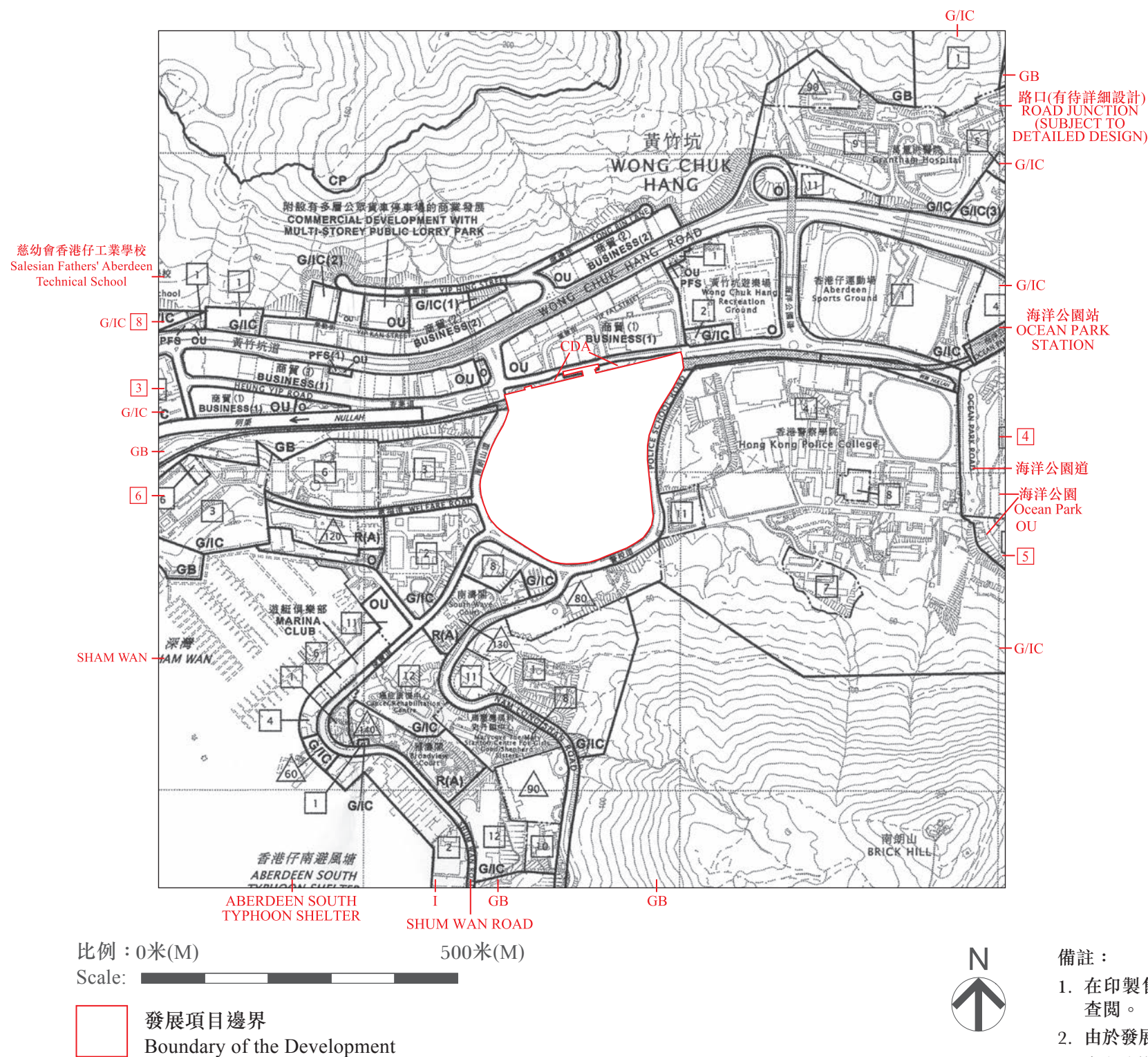

圖例 Notation

地帶 Zones

| | | | |
|------|--|-----|---|
| R(A) | 住宅 (甲類) Residential (Group A) | OU | 其他指定用途 Other specified uses |
| GB | 綠化地帶 Green belt | O | 休憩用地 Open space |
| G/IC | 政府、機構或社區 Government, institution or community | CP | 郊野公園 Country park |
| I | 工業 Industrial | CDA | 綜合發展區 Comprehensive development area |

交通 Communications

| | | | |
|--|------------------------------------|--|--|
| | 主要道路及路口 Major road and junction | | 鐵路及車站 (高架) Railway and station (elevated) |
| | 高架道路 Elevated road | | |

其他 Miscellaneous

| | | | |
|--|---|-------|---|
| | 最高建築物高度 (在主水平基準上若干米) Maximum building height (in metres above principal datum) | P F S | 加油站 Petrol filling station |
| | 最高建築物高度 (樓層數目) Maximum building height (in number of storeys) | | 建築物高度管制區界線 Building height control zone boundary |

備註：

- 在印製售樓說明書當日適用的最近期更新版本分區計劃大綱圖及其附表，可於期數的售樓處開放時間內免費查閱。
- 由於發展項目邊界不規則的技術原因，此圖所顯示之範圍可能多於《一手住宅物業銷售條例》所規定的範圍。
- 賣方建議準買家到有關發展地盤作實地考察，以對該發展地盤、其周邊地區的環境及附近的公共設施有較佳了解。

Notes:

- The last updated version of the Outline Zoning Plan and the attached schedule as at the date of printing of the sales brochure are available for free inspection at the sales office of the Phase during opening hours.
- Due to the technical reason that the boundary of the Development is irregular, the plan may show area more than the area required under the Residential Properties (First-hand Sales) Ordinance.
- The Vendor advises prospective purchasers to conduct an on-site visit for a better understanding of the development site, its surrounding environment and the public facilities nearby.