

# 19 CROSS-SECTION PLAN OF BUILDING IN THE DEVELOPMENT 發展項目中的建築物的橫截面圖

Cross-section A-A  
橫截面圖 A-A

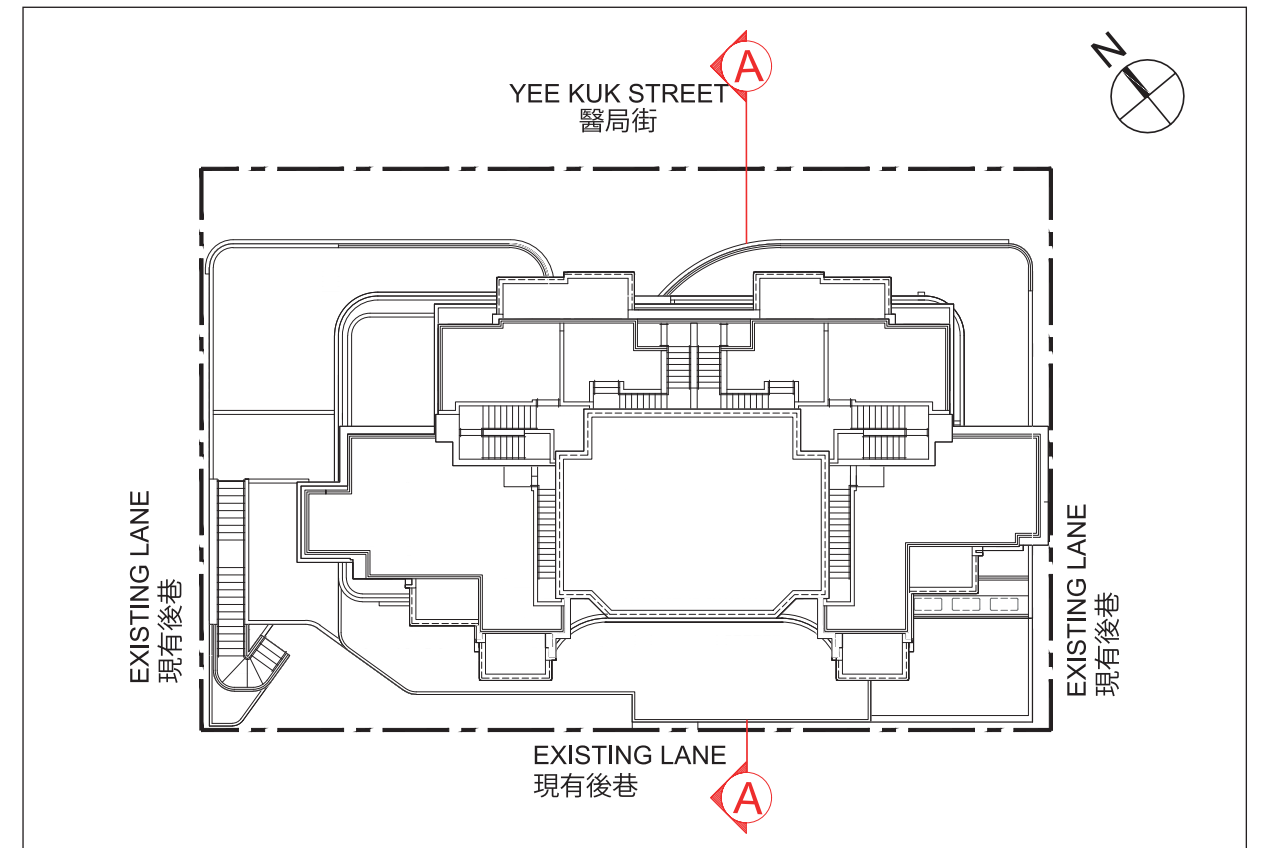
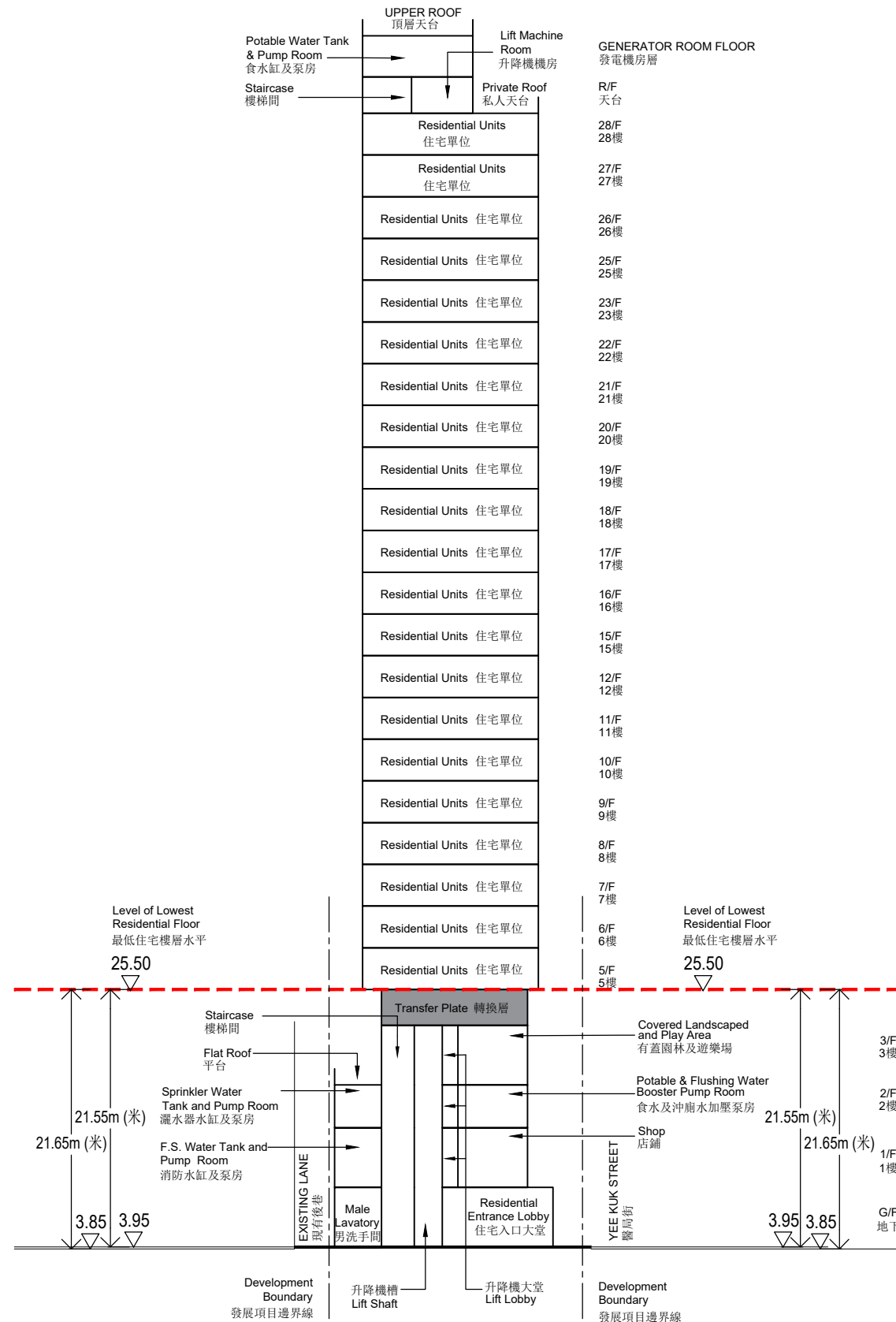

LEGEND 圖例

KEY PLAN 指示圖

--- Development Boundary  
發展項目邊界線

## Notes:

- (▽) denotes height (in metres) above the Hong Kong Principal Datum.
- (-----) Dotted line denotes the level of the lowest residential floor.
- The level of lowest residential floor of the Development is 25.50 metres above Hong Kong Principal Datum (HKPD).
- The part of Yee Kuk Street adjacent to the north-east side of the Development is 3.85 metres to 3.95 metres above Hong Kong Principal Datum (HKPD).
- The part of existing lane adjacent to the south-west side of the Development is 3.85 metres to 3.95 metres above Hong Kong Principal Datum (HKPD).

## 備註：

- (▽)代表香港主水平基準以上的高度(米)。
- (-----)虛線代表最低住宅樓層水平。
- 發展項目之最低層住宅為香港主水平基準以上25.50米。
- 毗鄰建築物東北面的一段醫局街為香港主水平基準以上3.85米至3.95米。
- 毗鄰建築物西南面的一段現有後巷為香港主水平基準以上3.85米至3.95米。

### 發展項目中的建築物的橫截面圖

橫截面圖 B-B

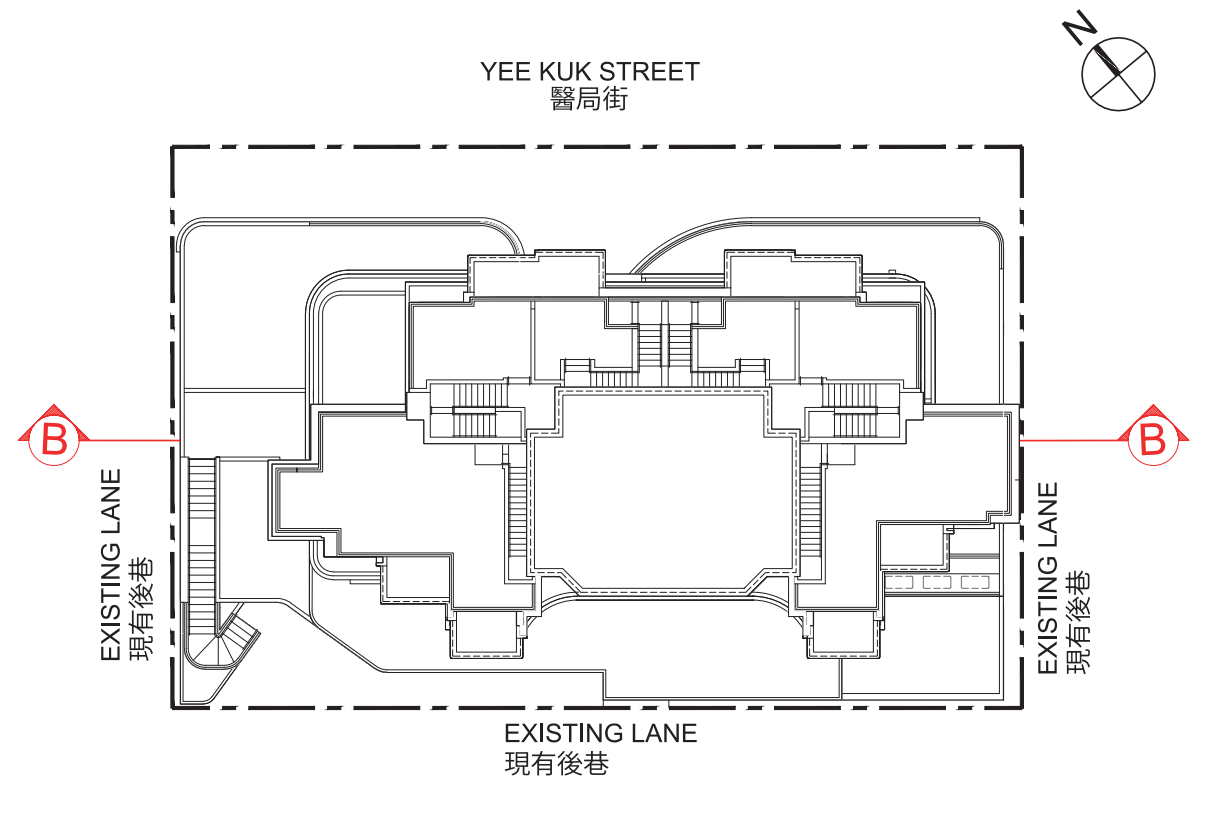
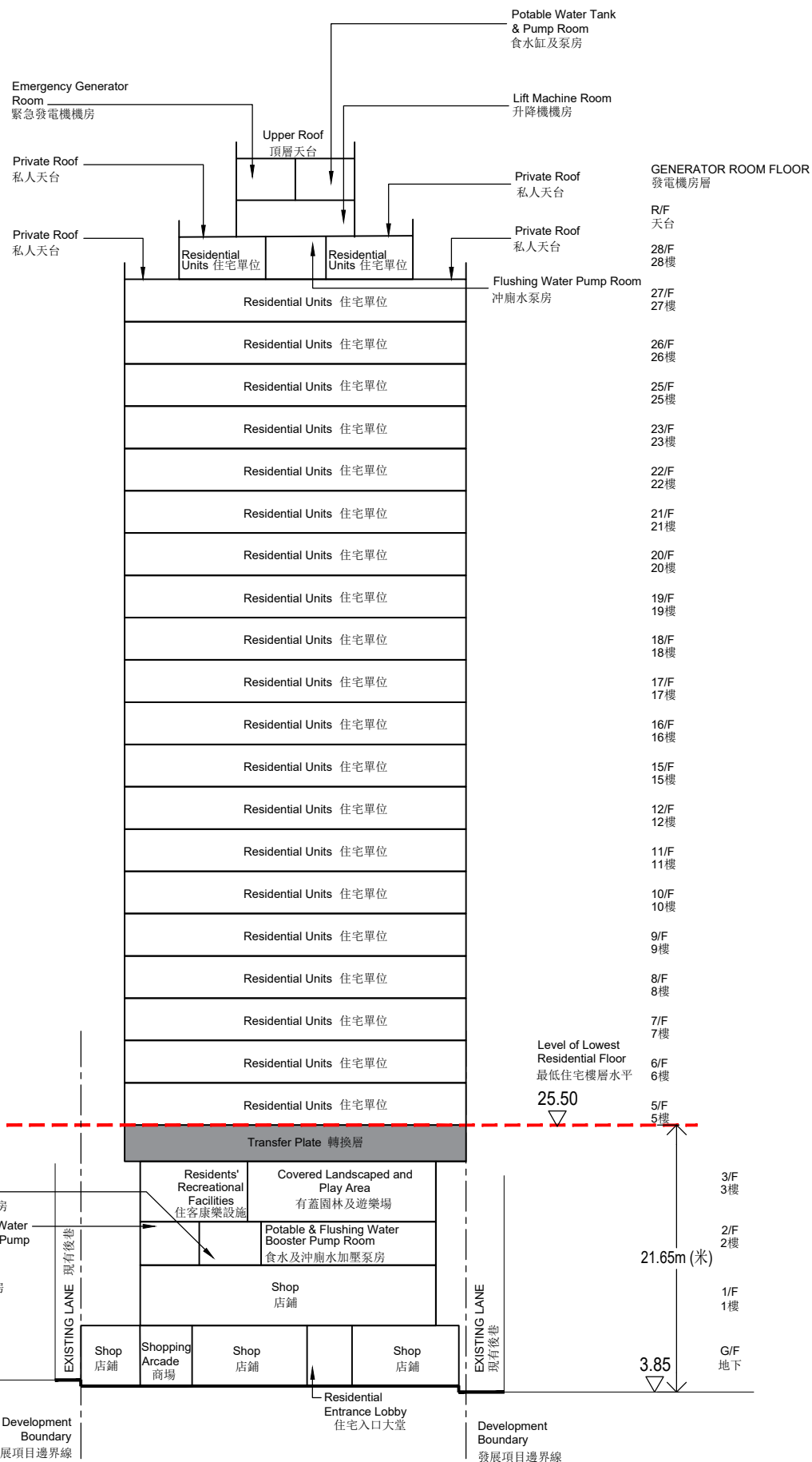

KEY PLAN 指示圖

Development Boundary  
發展項目邊界線

Notes:

1. (▽) denotes height (in metres) above the Hong Kong Principal Datum.
2. (-----) Dotted line denotes the level of the lowest residential floor.
3. The level of lowest residential floor of the Development is 25.50 metres above Hong Kong Principal Datum (HKPD).
4. The part of existing lane adjacent to the north-west side of the Development is 3.95 metres above Hong Kong Principal Datum (HKPD).
5. The part of existing lane adjacent to the south-east side of the Development is 3.85 metres above Hong Kong Principal Datum (HKPD).

備註：

1. (▽)代表香港主水平基準以上的高度(米)。
2. (---)虛線代表最低住宅樓層水平。
3. 發展項目之最低層住宅為香港主水平基準以上25.50米。
4. 毗鄰建築物西北面的一段現有後巷為香港主水平基準以上3.95米。
5. 毗鄰建築物東南面的一段現有後巷為香港主水平基準以上3.85米。