

# CROSS-SECTION PLAN OF BUILDING IN THE DEVELOPMENT

## 發展項目中的建築物的橫截面圖

### CROSS-SECTION PLAN A-A

#### 橫截面圖 A-A

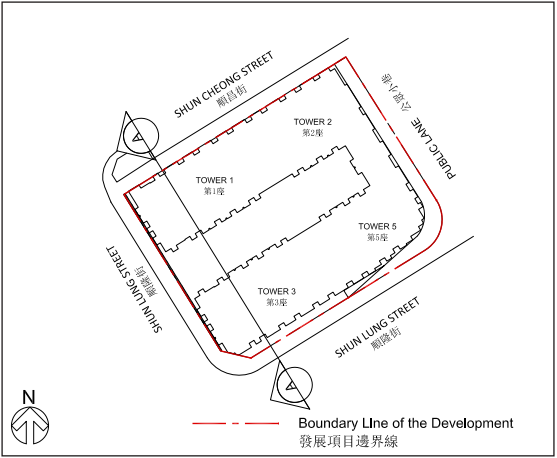

KEY PLAN  
指示圖

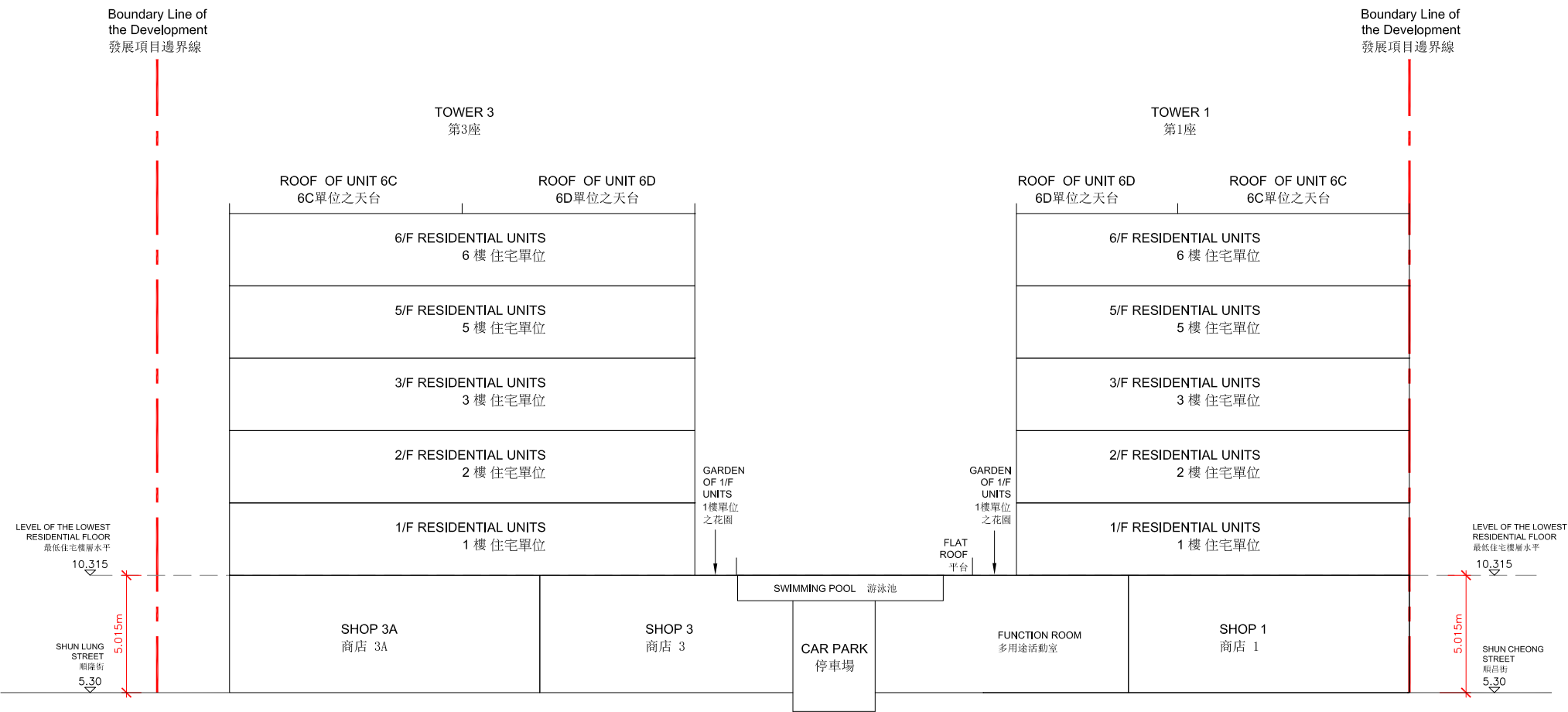

1. The part of Shun Cheong Street adjacent to the building is 5.3 metres above Hong Kong Principal Datum.
2. The part of Shun Lung Street adjacent to the building is 5.3 metres above Hong Kong Principal Datum.
3. Dotted line — — — denotes the level of the lowest residential floor of the building.
4. (▽) or (△) denotes height (in metres) above the Hong Kong Principal Datum.

1. 毗鄰建築物的一段順昌街為香港主水平基準以上5.3米。
2. 毗鄰建築物的一段順隆街為香港主水平基準以上5.3米。
3. 虛線 — — — 代表建築物之最低住宅樓層水平。
4. (▽)或(△)代表香港主水平基準以上的高度(米)。

# CROSS-SECTION PLAN OF BUILDING IN THE DEVELOPMENT

## 發展項目中的建築物的橫截面圖

### CROSS-SECTION PLAN B-B

#### 橫截面圖 B-B

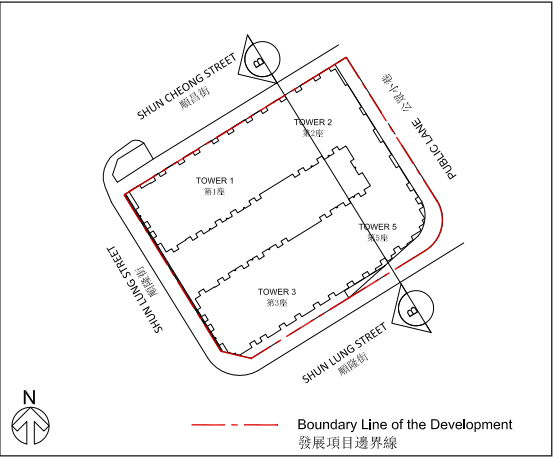
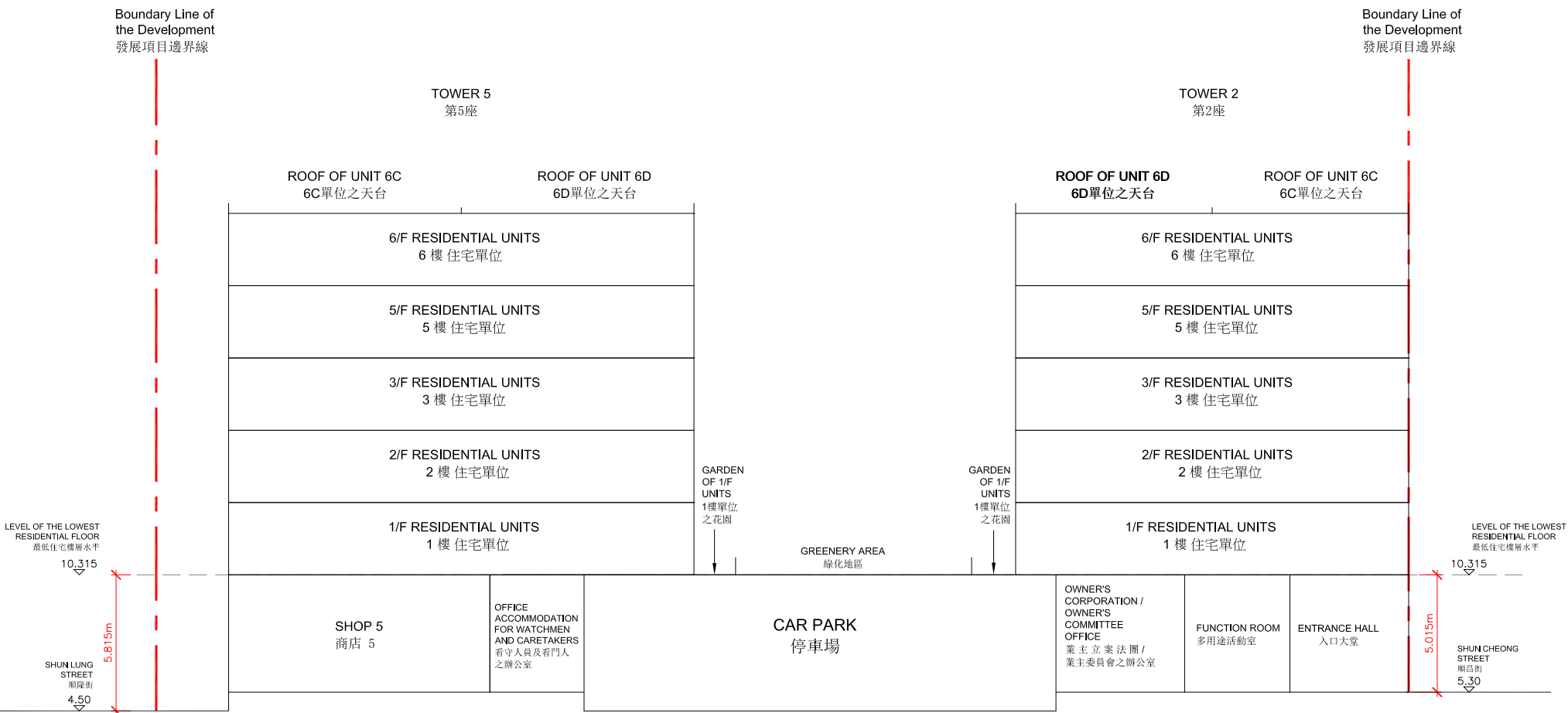

KEY PLAN  
指示圖

1. The part of Shun Cheong Street adjacent to the building is 5.3 metres above Hong Kong Principal Datum.
2. The part of Shun Lung Street adjacent to the building is 4.5 metres above Hong Kong Principal Datum.
3. Dotted line — — — denotes the level of the lowest residential floor of the building.
4. (▽) or (△) denotes height (in metres) above the Hong Kong Principal Datum.

1. 毗鄰建築物的一段順昌街為香港主水平基準以上5.3米。
2. 毗鄰建築物的一段順隆街為香港主水平基準以上4.5米。
3. 虛線 — — — 代表建築物之最低住宅樓層水平。
4. (▽)或(△)代表香港主水平基準以上的高度(米)。

# CROSS-SECTION PLAN OF BUILDING IN THE DEVELOPMENT

## 發展項目中的建築物的橫截面圖

CROSS-SECTION PLAN C-C  
橫截面圖 C-C

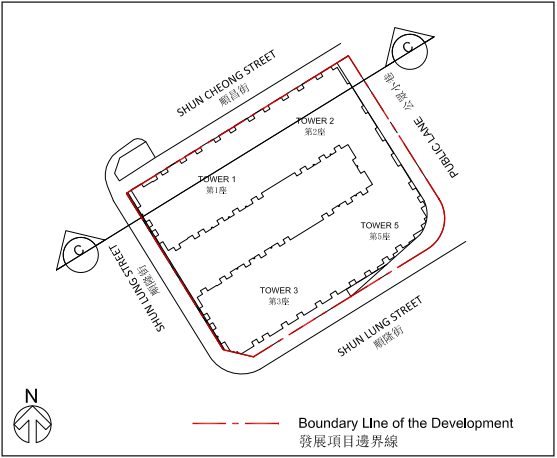

KEY PLAN  
指示圖

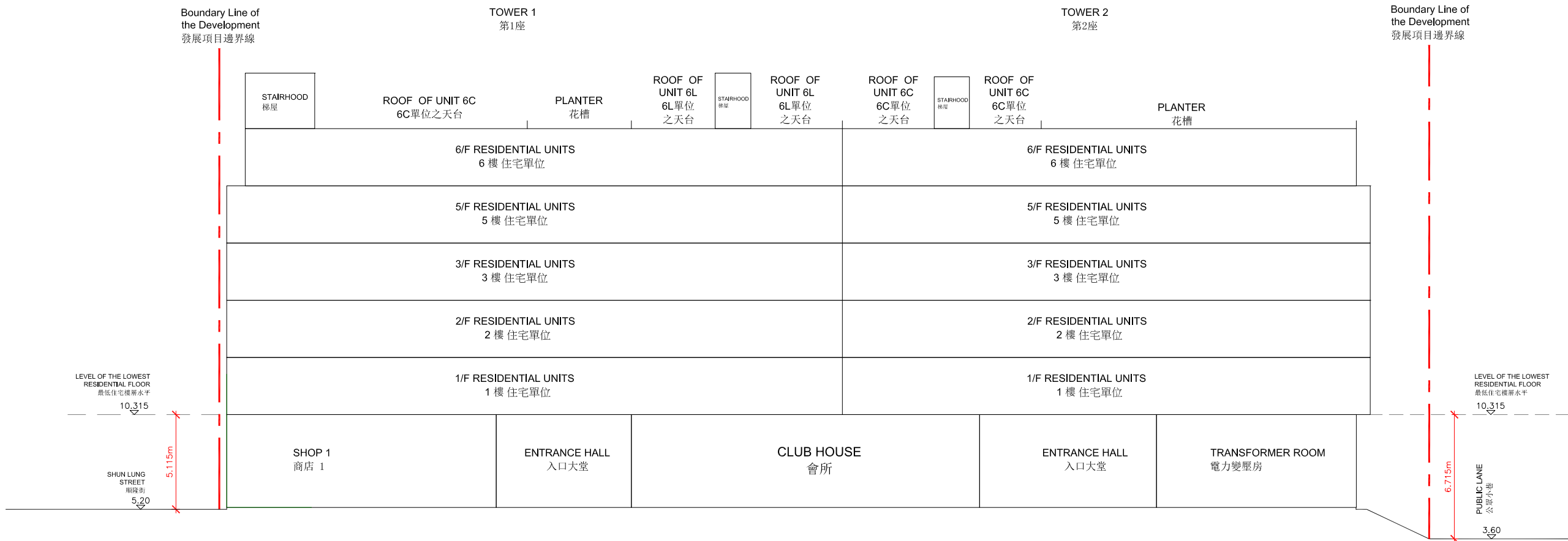

1. The part of the existing public lane adjacent to the building is 3.6 metres above Hong Kong Principal Datum.
2. The part of Shun Lung Street adjacent to the building is 5.2 metres above Hong Kong Principal Datum.
3. Dotted line — — — denotes the level of the lowest residential floor of the building.
4. (▽) or (△) denotes height (in metres) above the Hong Kong Principal Datum.

1. 毗鄰建築物的現有公眾小巷為香港主水平基準以上3.6米。
2. 毗鄰建築物的一段順隆街為香港主水平基準以上5.2米。
3. 虛線 — — — 代表建築物之最低住宅樓層水平。
4. (▽)或(△)代表香港主水平基準以上的高度(米)。

# CROSS-SECTION PLAN OF BUILDING IN THE DEVELOPMENT

## 發展項目中的建築物的橫截面圖

### CROSS-SECTION PLAN D-D

#### 橫截面圖 D-D

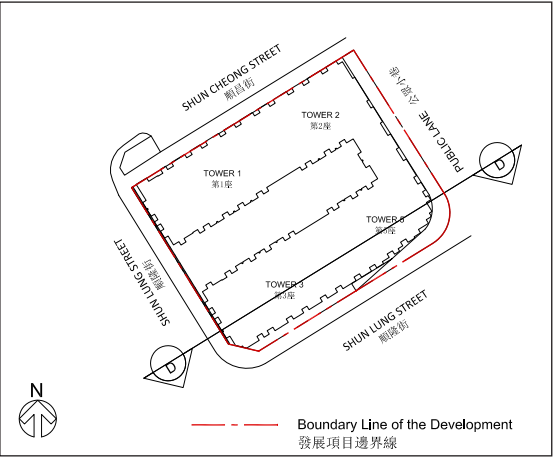
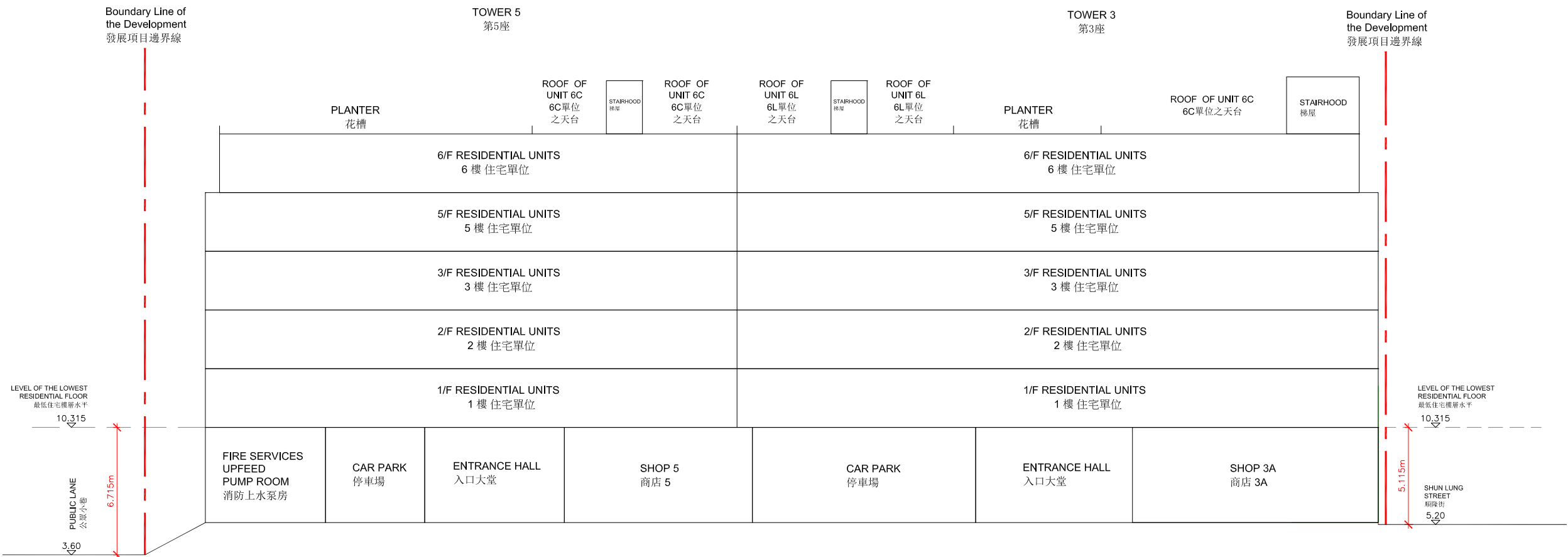

KEY PLAN  
指示圖

1. The part of the existing public lane adjacent to the building is 3.6 metres above Hong Kong Principal Datum.
2. The part of Shun Lung Street adjacent to the building is 5.2 metres above Hong Kong Principal Datum.
3. Dotted line — — — denotes the level of the lowest residential floor of the building.
4. (▽) or (△) denotes height (in metres) above the Hong Kong Principal Datum.

1. 毗鄰建築物的現有公眾小巷為香港主水平基準以上3.6米。
2. 毗鄰建築物的一段順隆街為香港主水平基準以上5.2米。
3. 虛線 — — — 代表建築物之最低住宅樓層水平。
4. (▽)或(△)代表香港主水平基準以上的高度(米)。