

19 CROSS-SECTION PLAN OF BUILDING IN THE DEVELOPMENT

發展項目中的建築物的橫截面圖

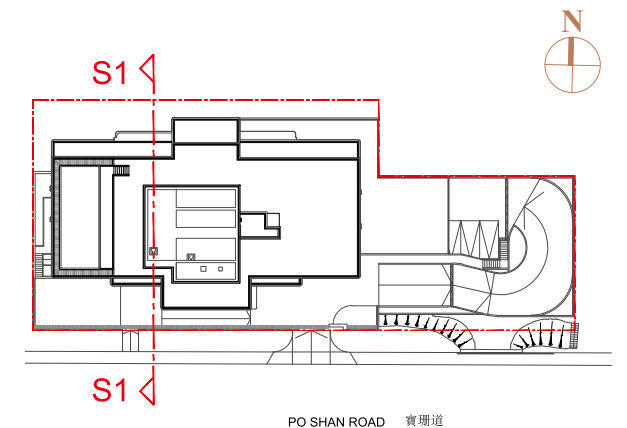

Cross Section S1
橫截面圖 S1

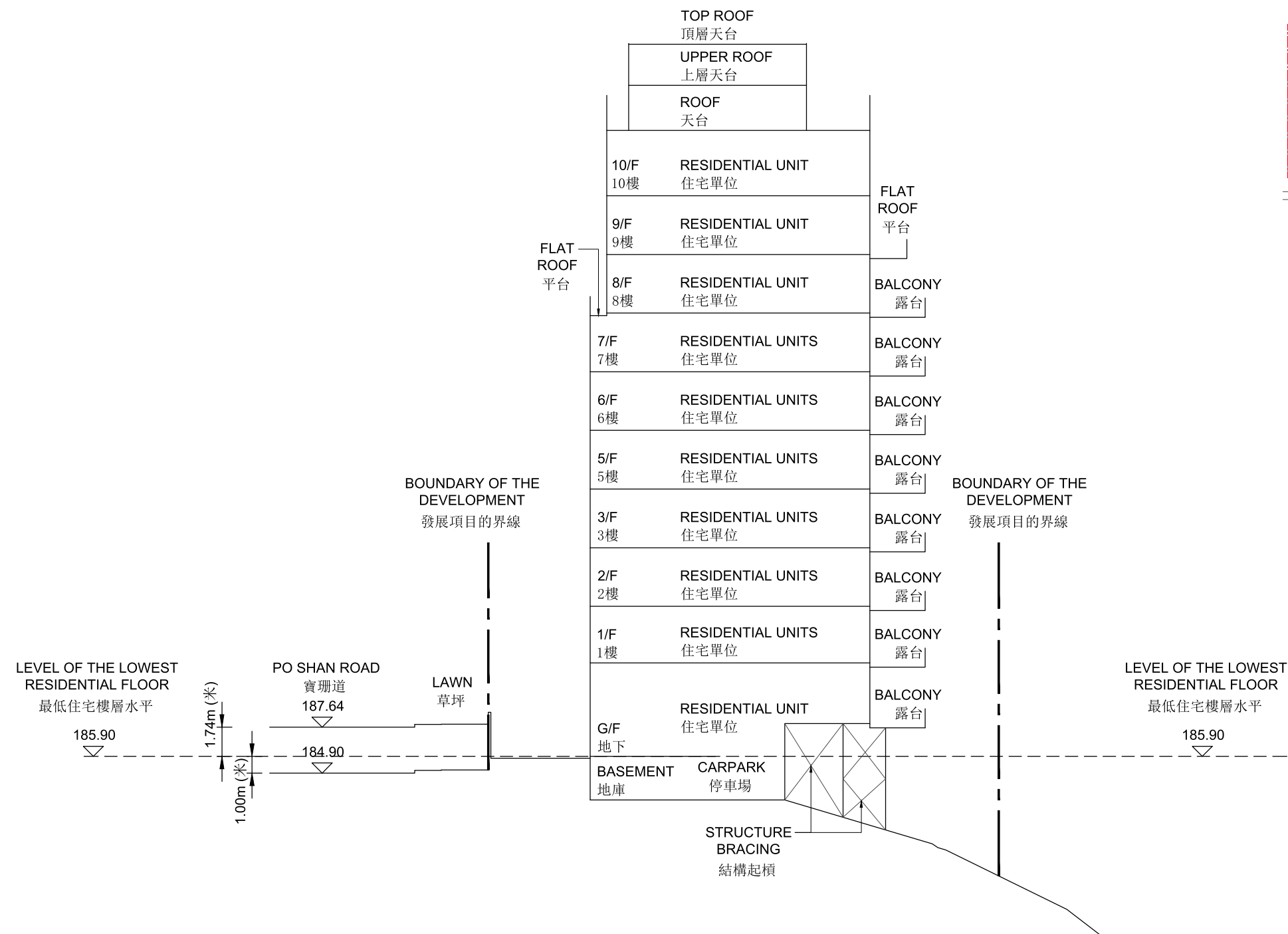

Key Plan
索引圖

1. The part of Po Shan Road adjacent to the building is from 184.90 metres to 187.64 metres above the Hong Kong Principal Datum.
2. — — — Dotted line denotes the lowest residential floor of the building.
3. ▽ denotes height (in metre) above the Hong Kong Principal Datum (HKPD).

1. 毗連建築物的一段寶珊道為香港主水平基準以上184.90米至187.64米。
2. — — — 虛線為該建築物最低住宅樓層水平。
3. ▽ 為香港主水平基準以上高度（米）。

19 CROSS-SECTION PLAN OF BUILDING IN THE DEVELOPMENT

發展項目中的建築物的橫截面圖

Cross Section S2
橫截面圖 S2

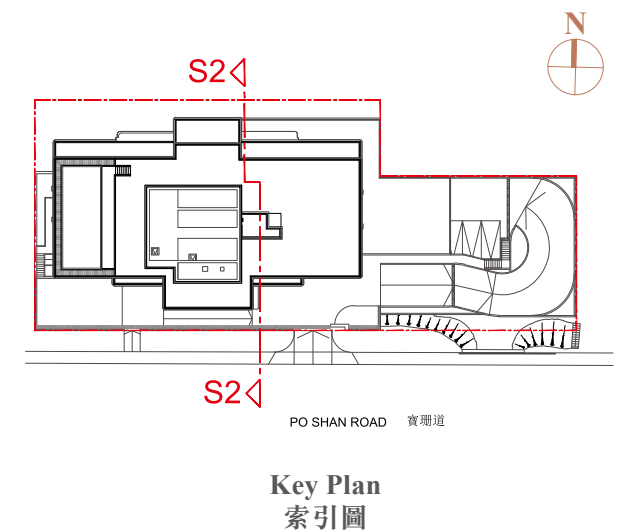
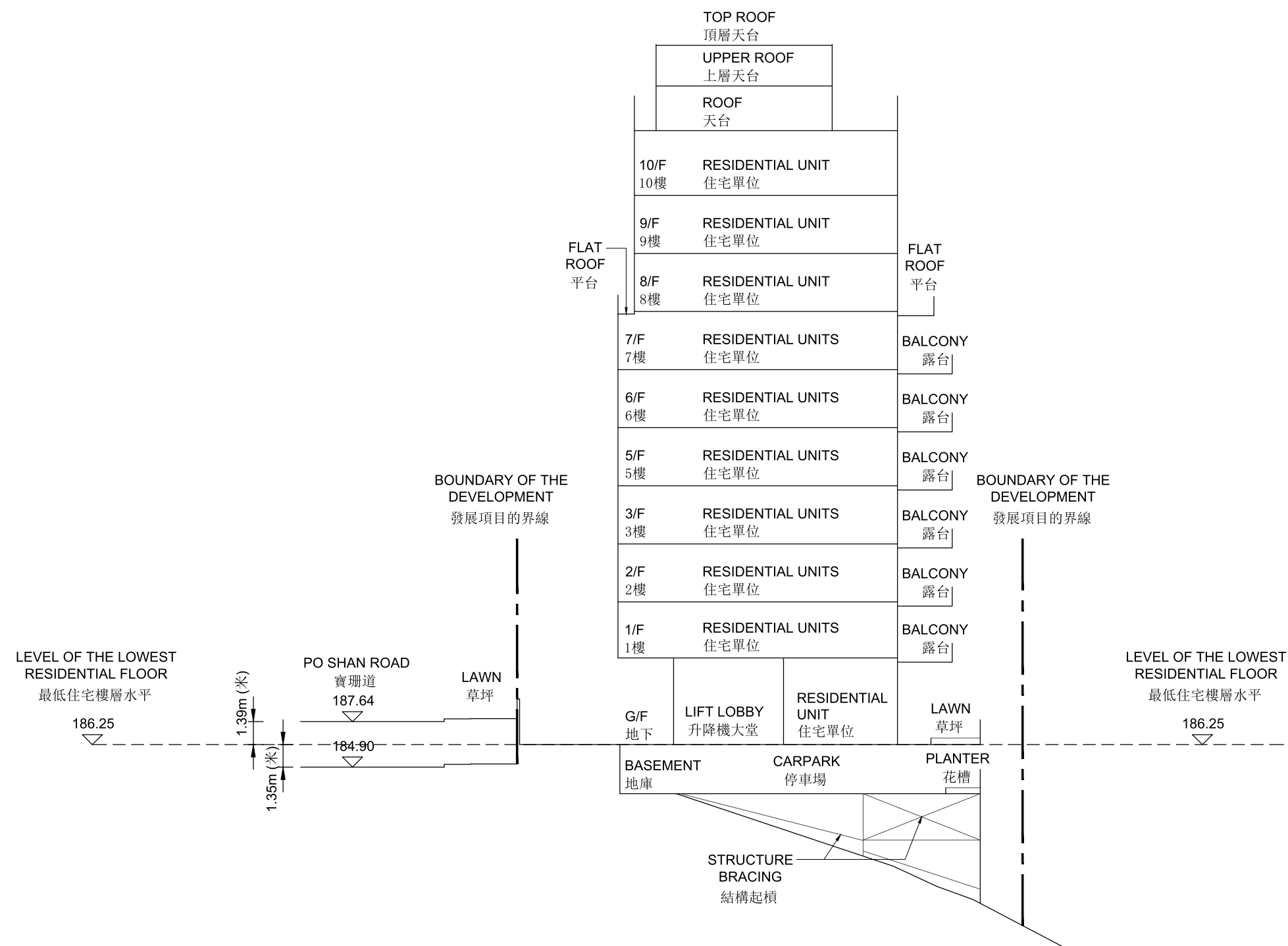

1. The part of Po Shan Road adjacent to the building is from 184.90 metres to 187.64 metres above the Hong Kong Principal Datum.
2. --- Dotted line denotes the lowest residential floor of the building.
3. ▽ denotes height (in metre) above the Hong Kong Principal Datum (HKPD).

1. 毗連建築物的一段寶珊道為香港主水平基準以上184.90米至187.64米。
2. --- 虛線為該建築物最低住宅樓層水平。
3. ▽ 為香港主水平基準以上高度（米）。