

Cross-section plan of residential properties in the development

發展項目住宅物業的橫截面圖

Cross-Section Plan B-B 橫截面圖B-B

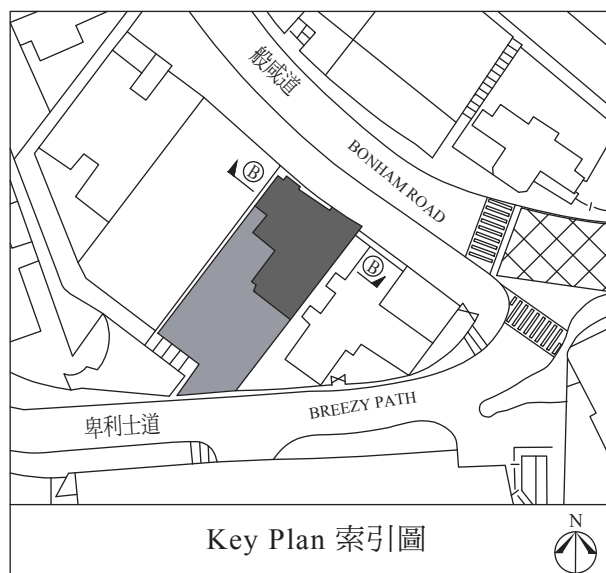
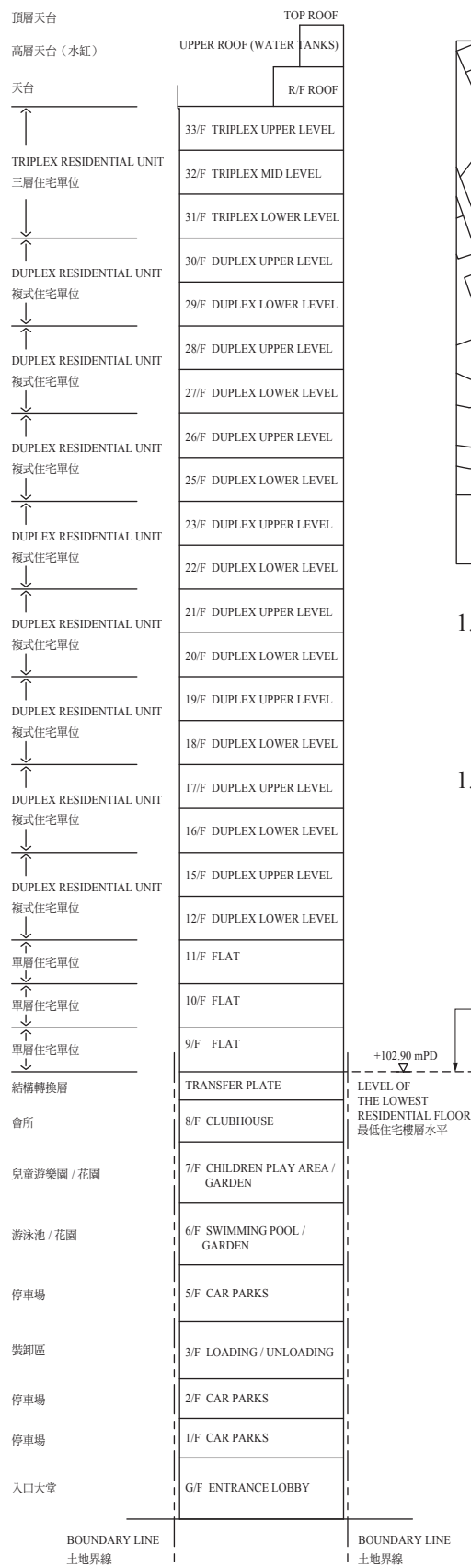

- The level of the lowest residential floor of the Development is 102.90 metres above Hong Kong Principal Datum (HKPD or PD).
- 發展項目之最低住宅層為香港主水平基準以上 102.90 米。

Dotted line denotes the lowest residential floor
虛線為最低住宅樓層水平

Scale 比例尺 0 25m