

發展項目的所在位置圖

LOCATION PLAN OF THE DEVELOPMENT

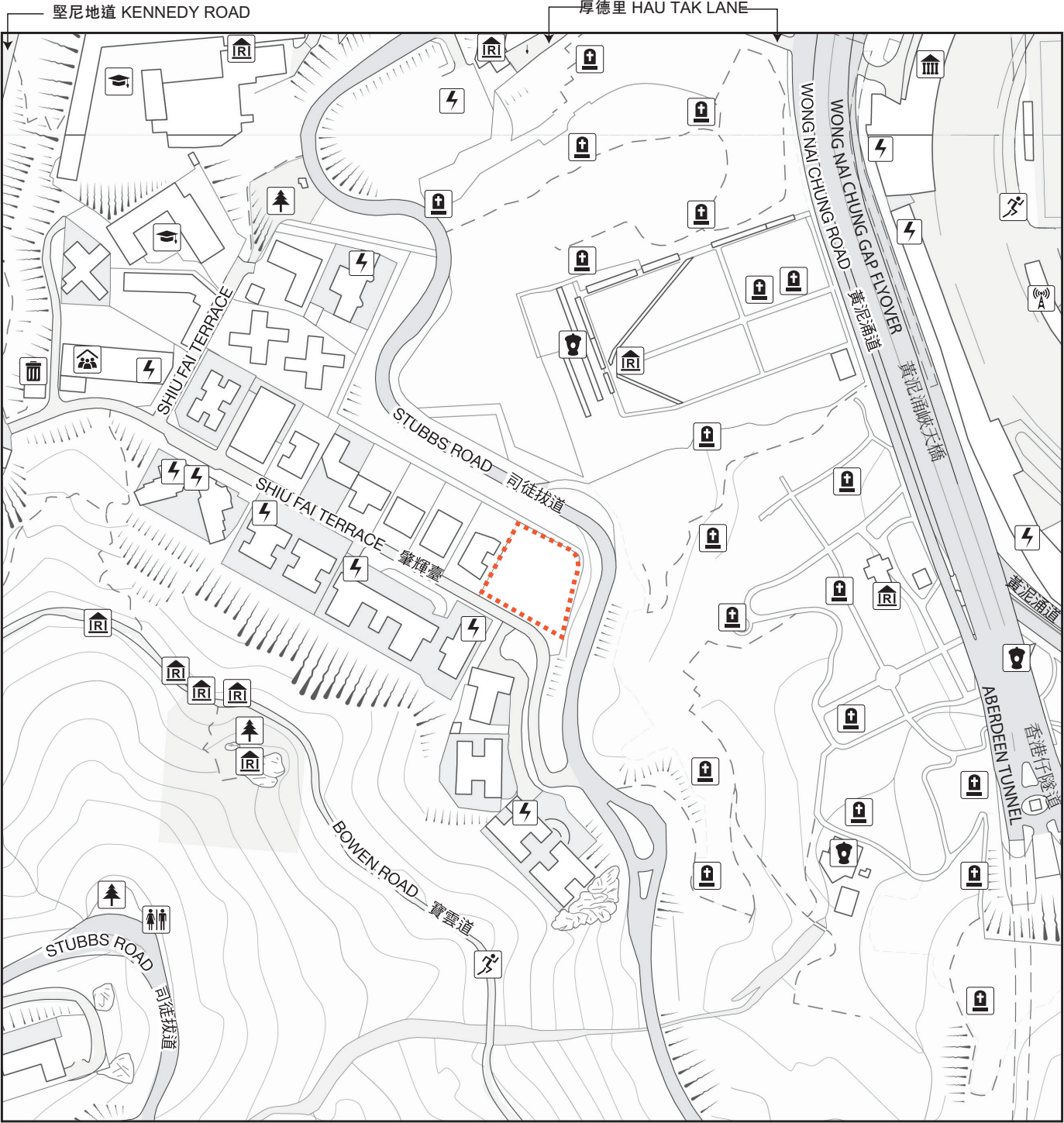

NOTATION 圖例

- 宗教場所 (包括教堂、廟宇及祠堂) A Religious Institution (including a church, a temple and a Tsz Tong)
- 公園 A Public Park
- 公廁 A Public Convenience
- 體育設施 (包括運動場及游泳池) Sports Facilities (including a sports ground and a swimming pool)
- 學校 (包括幼稚園) A School (including a kindergarten)
- 垃圾收集站 A Refuse Collection Point
- 骨灰龕 A Columbarium
- 社會福利設施 (包括老人中心及弱智人士護理院) Social Welfare Facilities (including an elderly centre and a home for the mentally disabled)
- 墳場 A Cemetery
- 博物館 A Museum
- 發電廠(包括電力分站) A Power Plant (including electricity sub-stations)
- 公用事業設施裝置 A Public Utility Installation

--- 發展項目範圍的地界線 Boundary Line of the Development

SCALE 比例尺：0 50 100 150 200 250(m)(米)

Explanatory remark:

- The Location Plan is prepared with reference to the Digital Topographic Map No.T11-SW-B dated 13/2/2025 and Digital Topographic Map No.T11-SW-D dated 13/2/2025.
- The map is provided by the CSDI Portal and intellectual property rights are owned by the Government of the HKSAR.
- The Location Plan may show more than the area required under the Residential Properties (First-hand Sales) Ordinance (Cap.621) due to technical reason that the boundary of the Development is irregular.

備註:

- 所在位置圖是參考日期為2025年2月13日之數碼地形圖(編號為T11-SW-B)及日期為2025年2月13日之數碼地形圖(編號為T11-SW-D) 擬備。
- 地圖由空間數據共享平台提供，香港特別行政區政府為知識產權擁有人。
- 由於發展項目的邊界不規則的技術原因，所在位置圖可能顯示多於《一手住宅物業銷售條例》(第621章) 所要求顯示的範圍。