

CROSS-SECTION PLAN OF BUILDING IN THE DEVELOPMENT

發展項目中的建築物的橫截面圖

Cross Section Key Plan
橫截面示意圖



CROSS-SECTION PLAN OF BUILDING IN THE DEVELOPMENT

發展項目中的建築物的橫截面圖

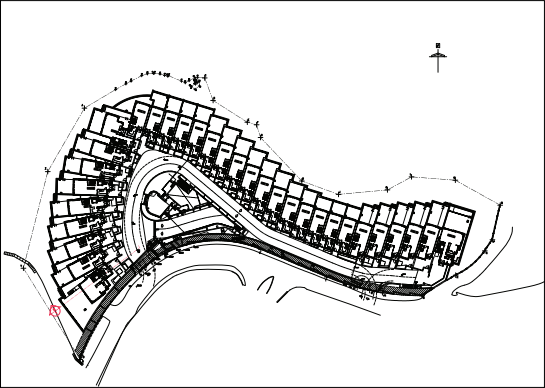

Section 1
橫截面圖 1

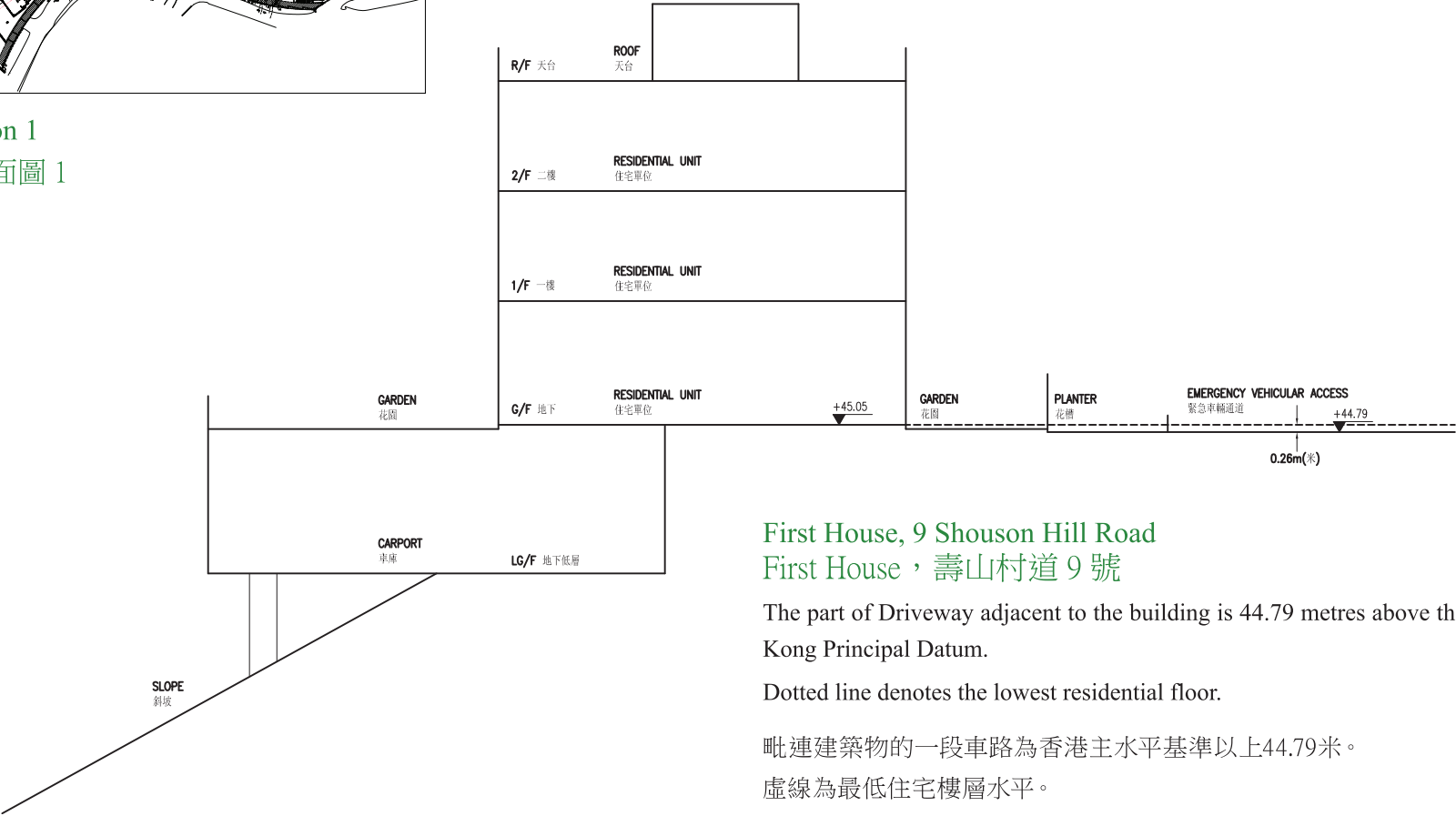

First House, 9 Shouson Hill Road First House，壽山村道 9 號

The part of Driveway adjacent to the building is 44.79 metres above the Hong Kong Principal Datum.

Dotted line denotes the lowest residential floor.

毗連建築物的一段車路為香港主水平基準以上44.79米。
虛線為最低住宅樓層水平。

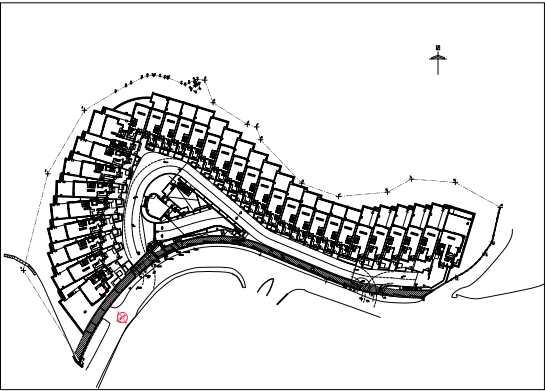

Section 2
橫截面圖 2

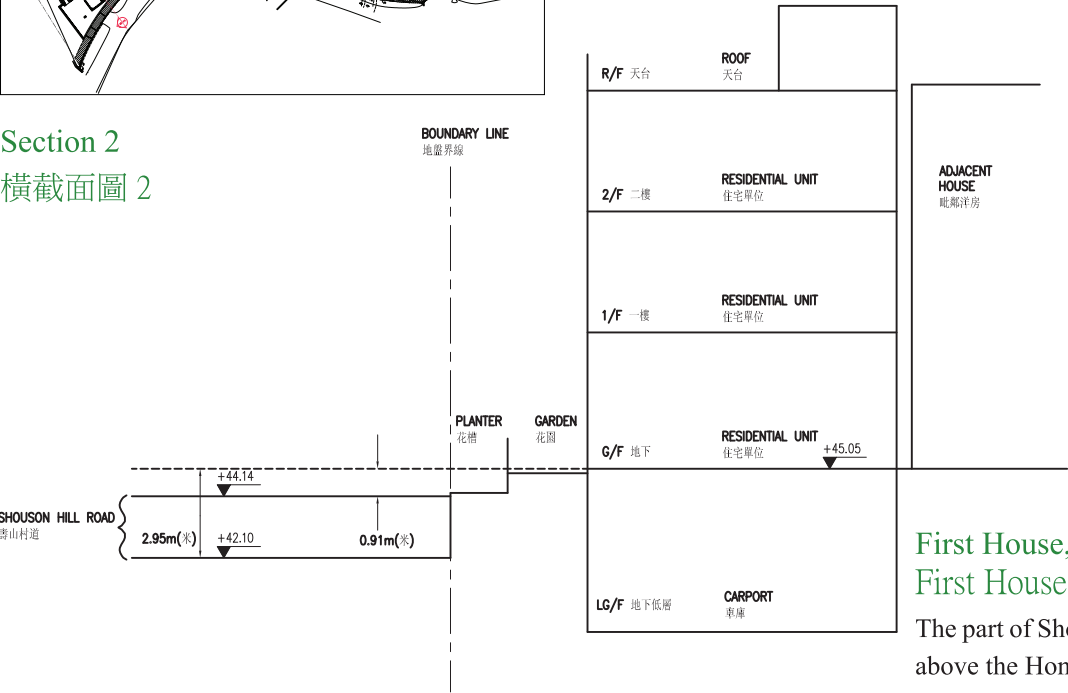

First House, 9 Shouson Hill Road First House，壽山村道 9 號

The part of Shouson Hill Road adjacent to the building is 42.10 to 44.14 metres above the Hong Kong Principal Datum.

Dotted line denotes the lowest residential floor.

毗連建築物的一段壽山村道為香港主水平基準以上42.10至44.14米。
虛線為最低住宅樓層水平。

CROSS-SECTION PLAN OF BUILDING IN THE DEVELOPMENT

發展項目中的建築物的橫截面圖

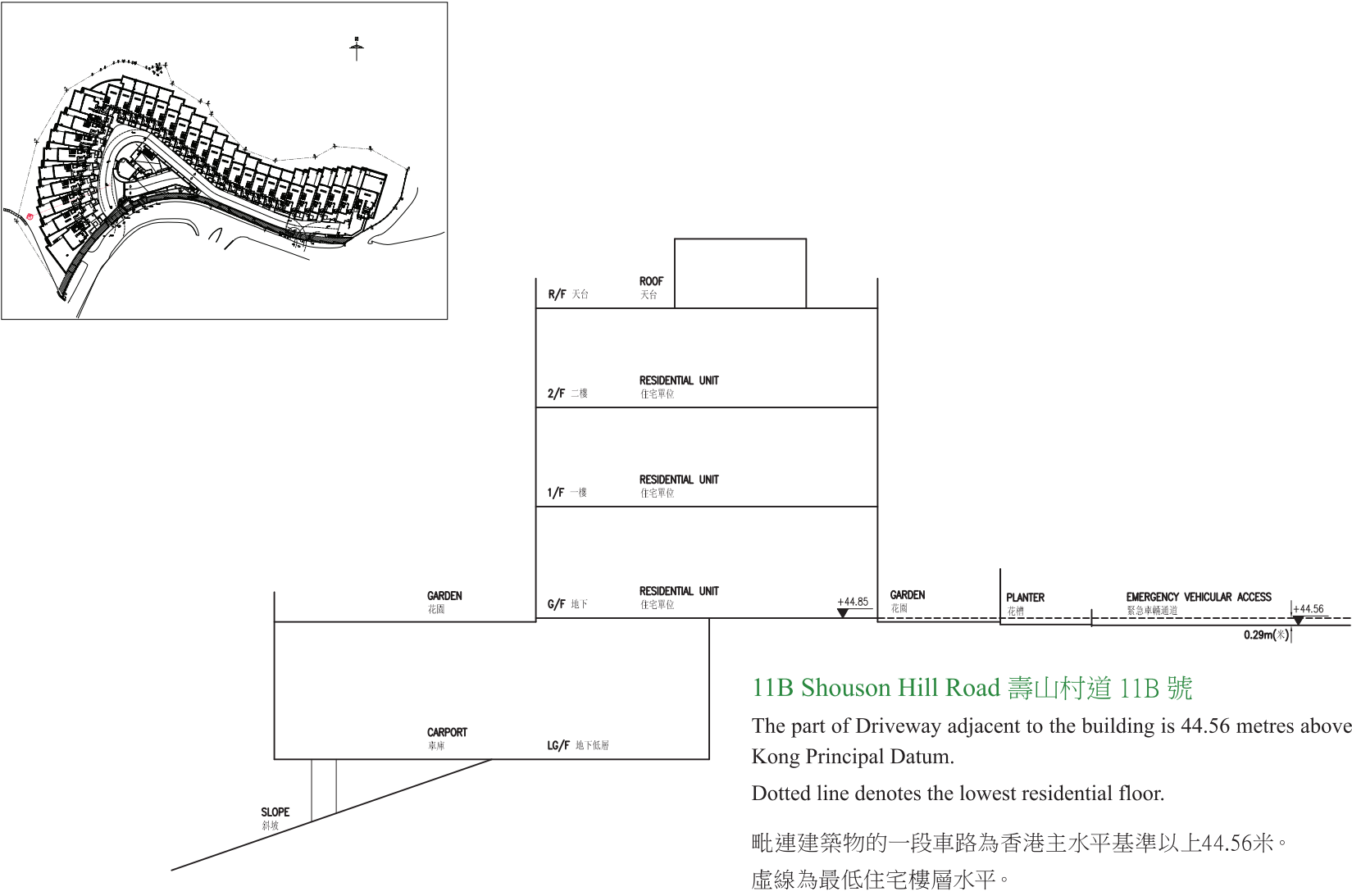
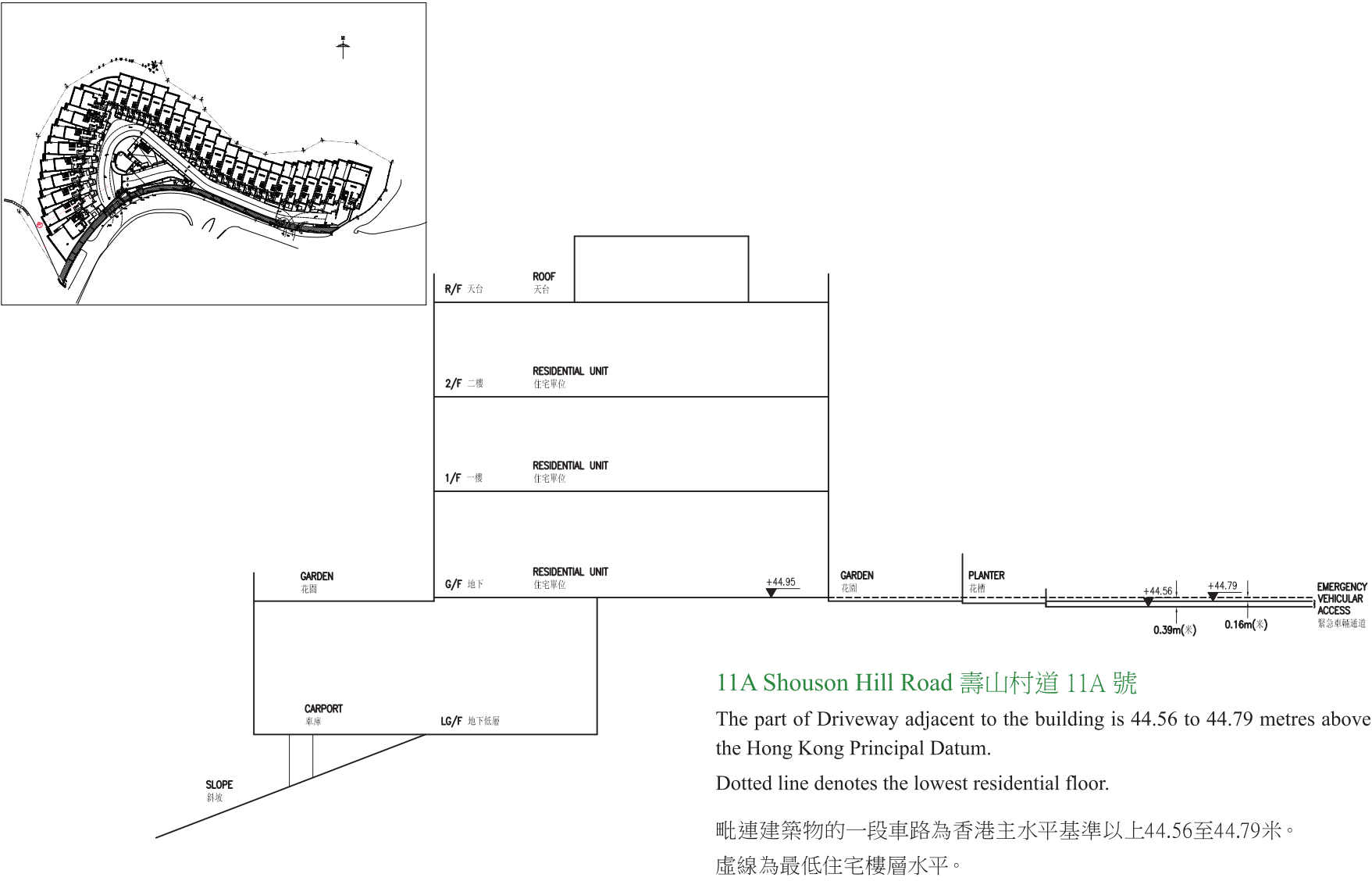

CROSS-SECTION PLAN OF BUILDING IN THE DEVELOPMENT

發展項目中的建築物的橫截面圖

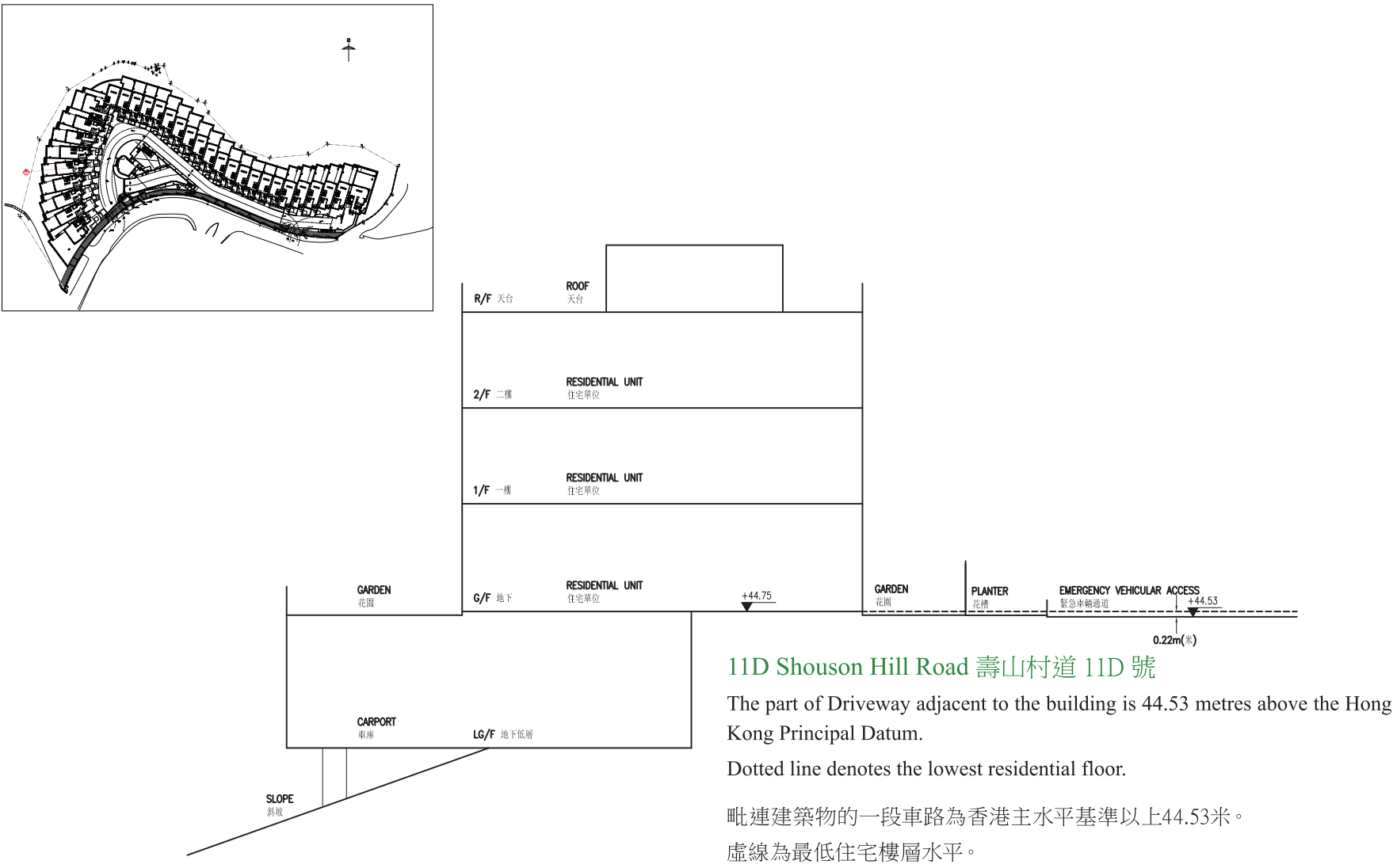
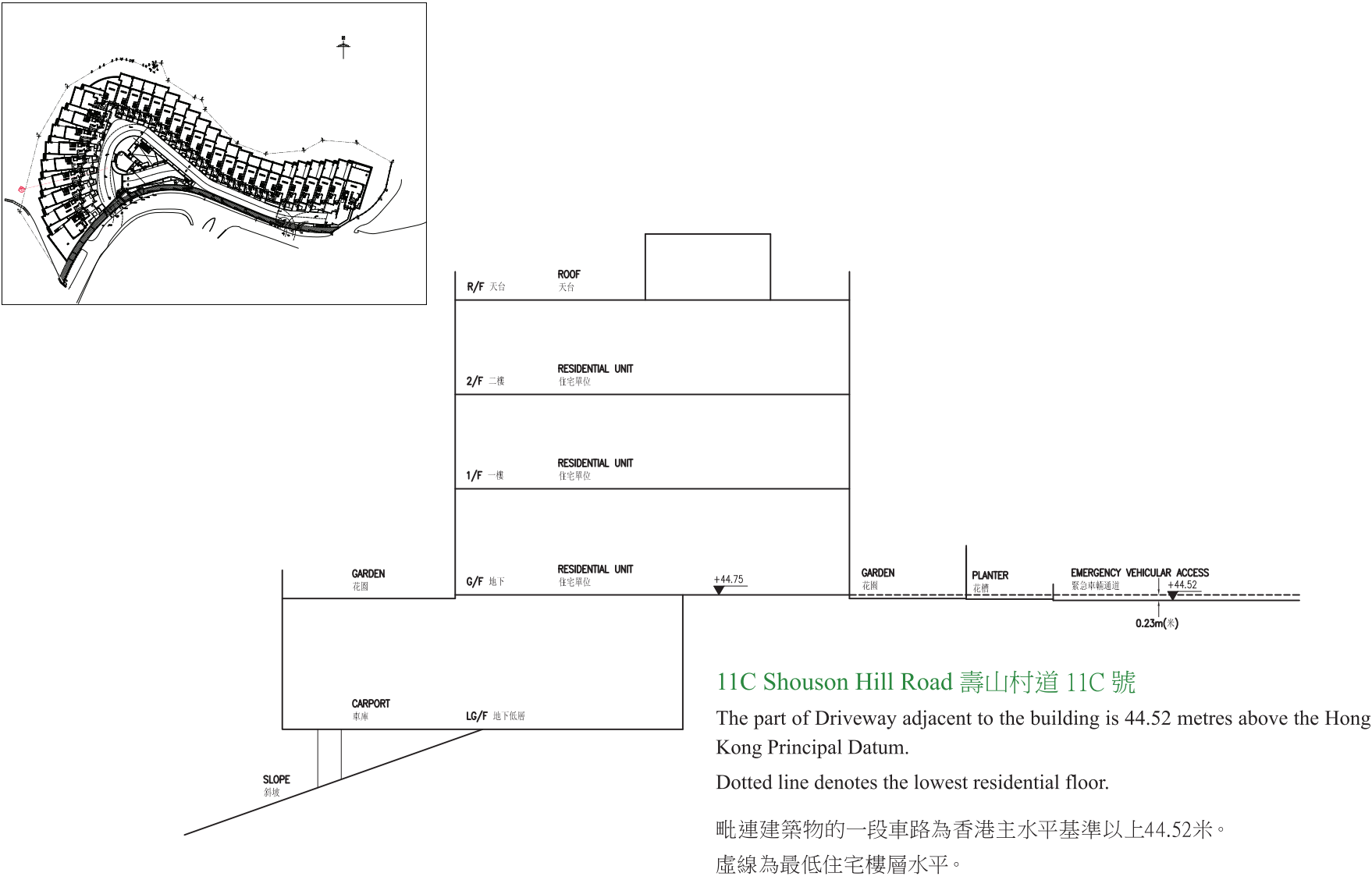

CROSS-SECTION PLAN OF BUILDING IN THE DEVELOPMENT

發展項目中的建築物的橫截面圖

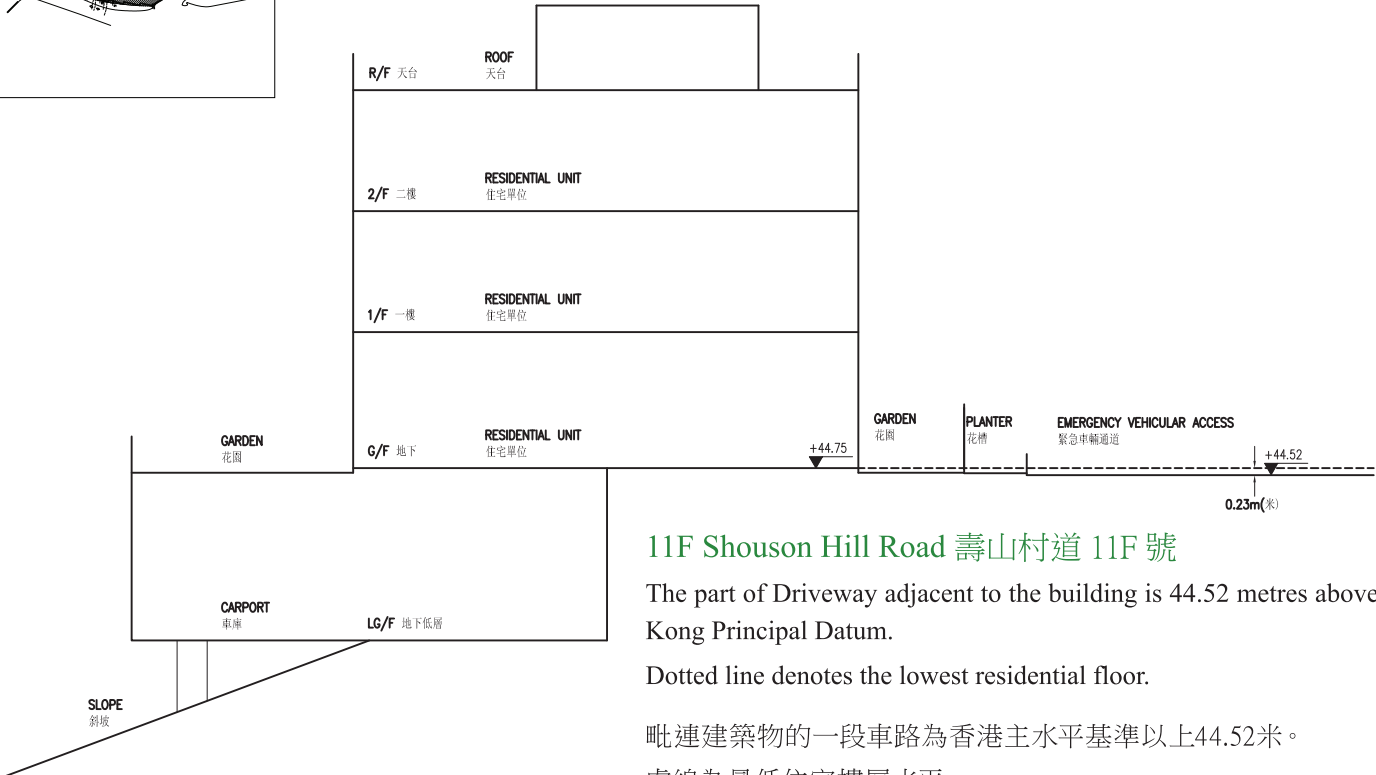
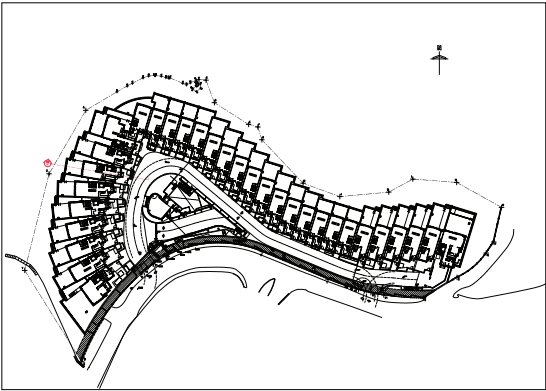
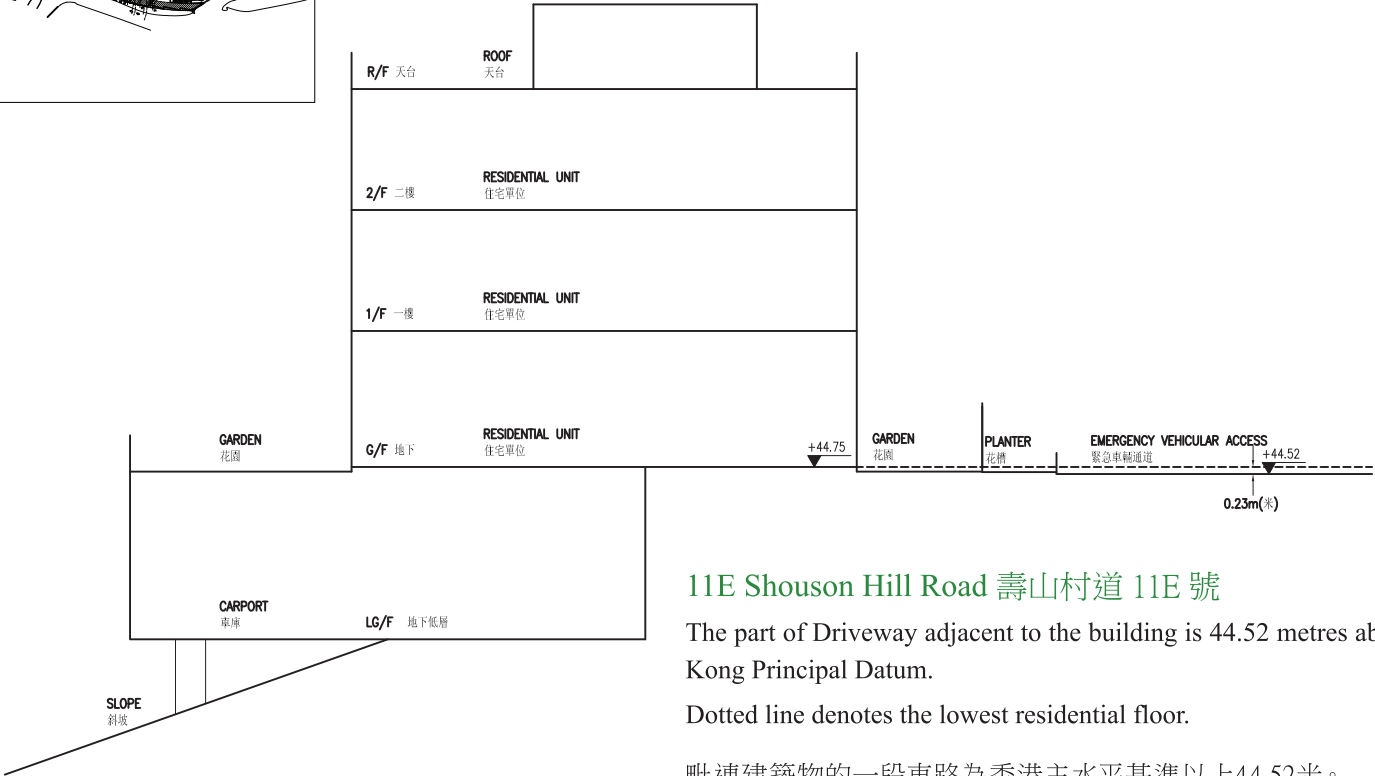
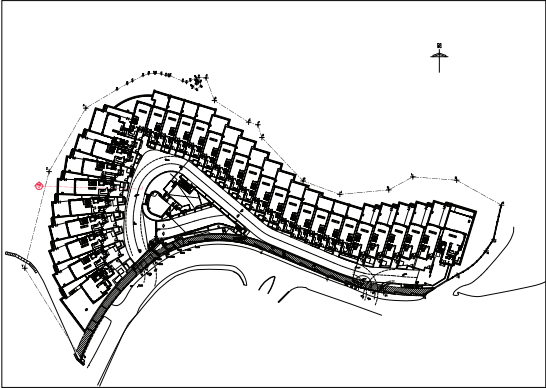

CROSS-SECTION PLAN OF BUILDING IN THE DEVELOPMENT

發展項目中的建築物的橫截面圖

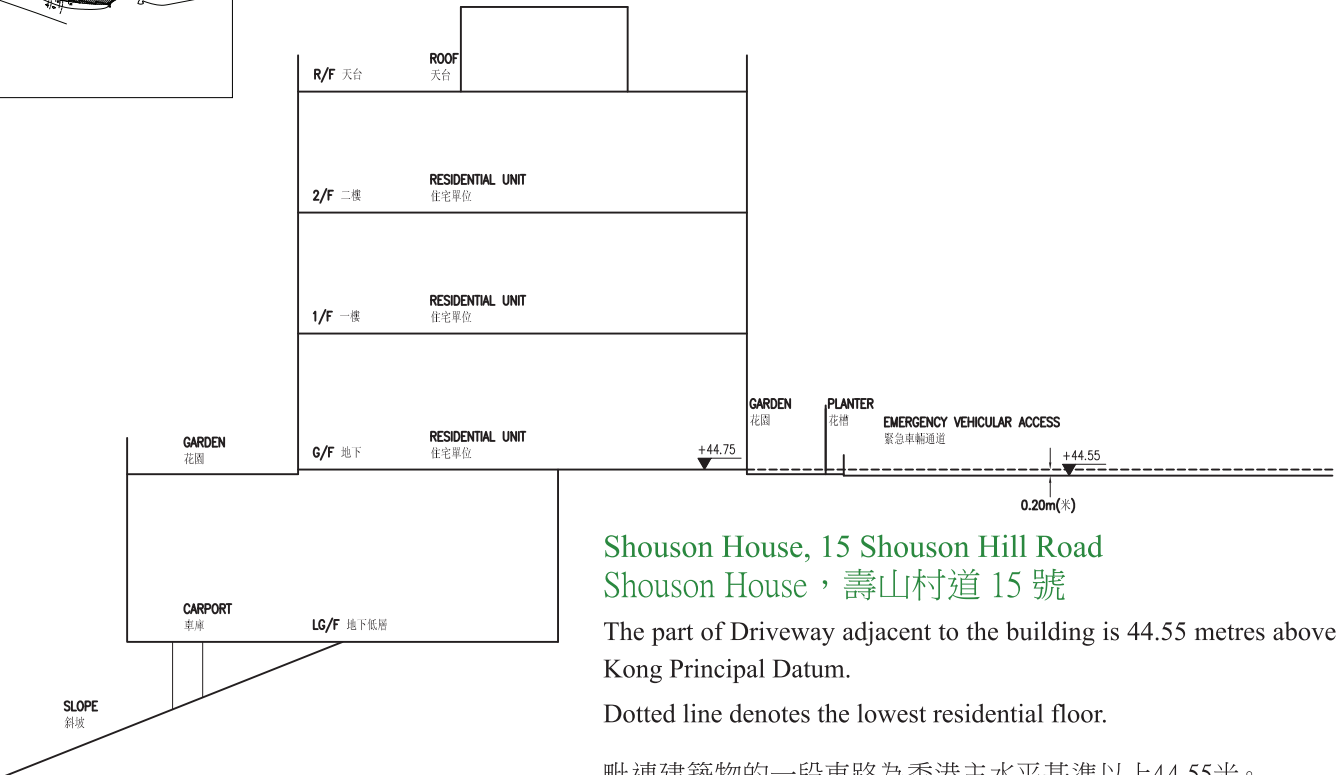
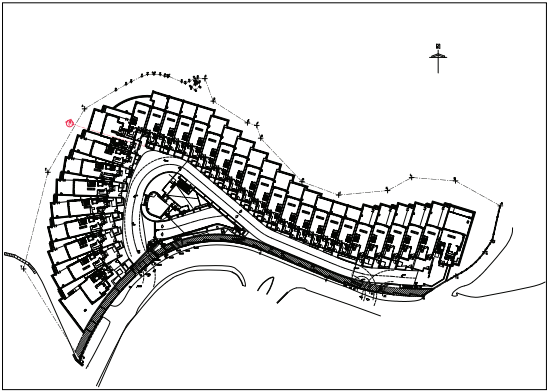
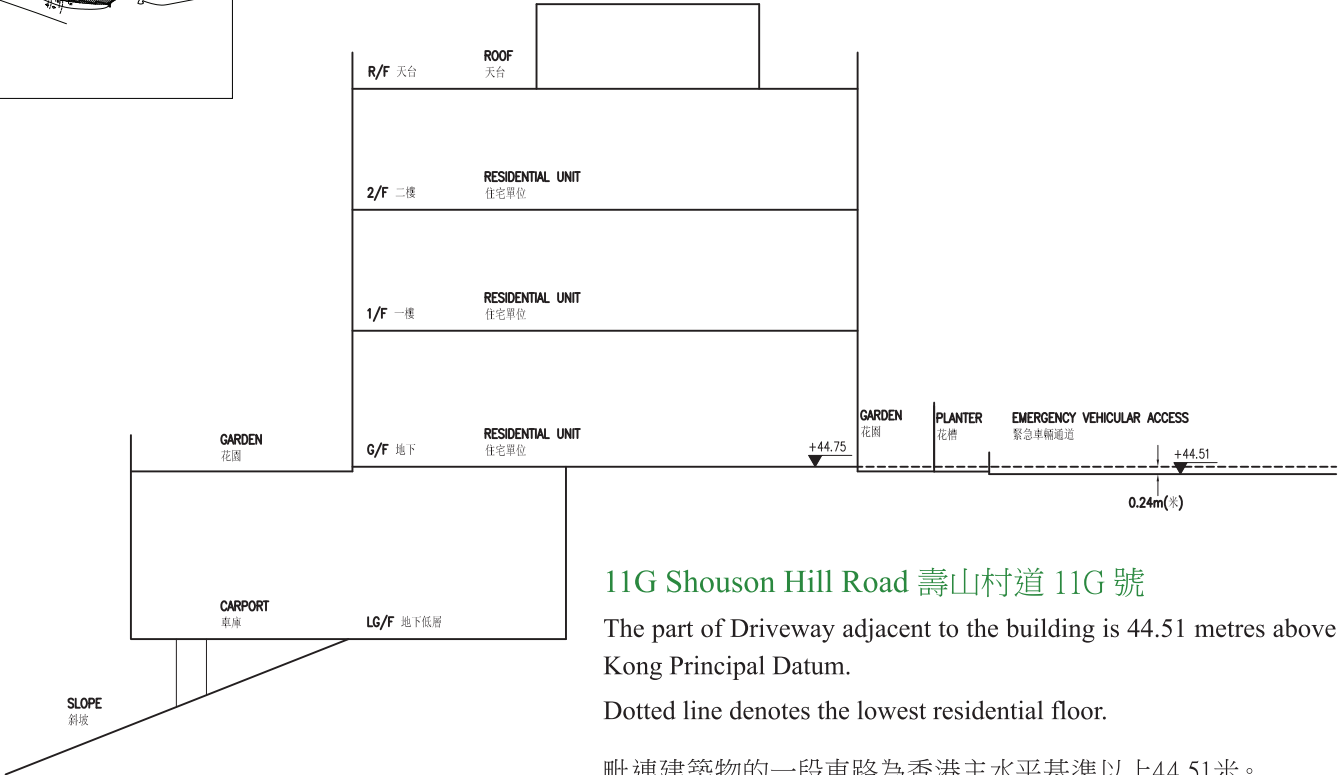
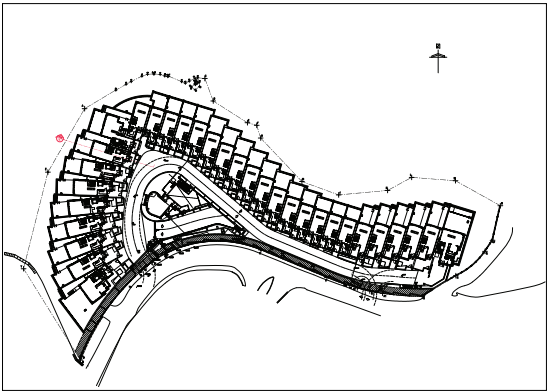

CROSS-SECTION PLAN OF BUILDING IN THE DEVELOPMENT

發展項目中的建築物的橫截面圖

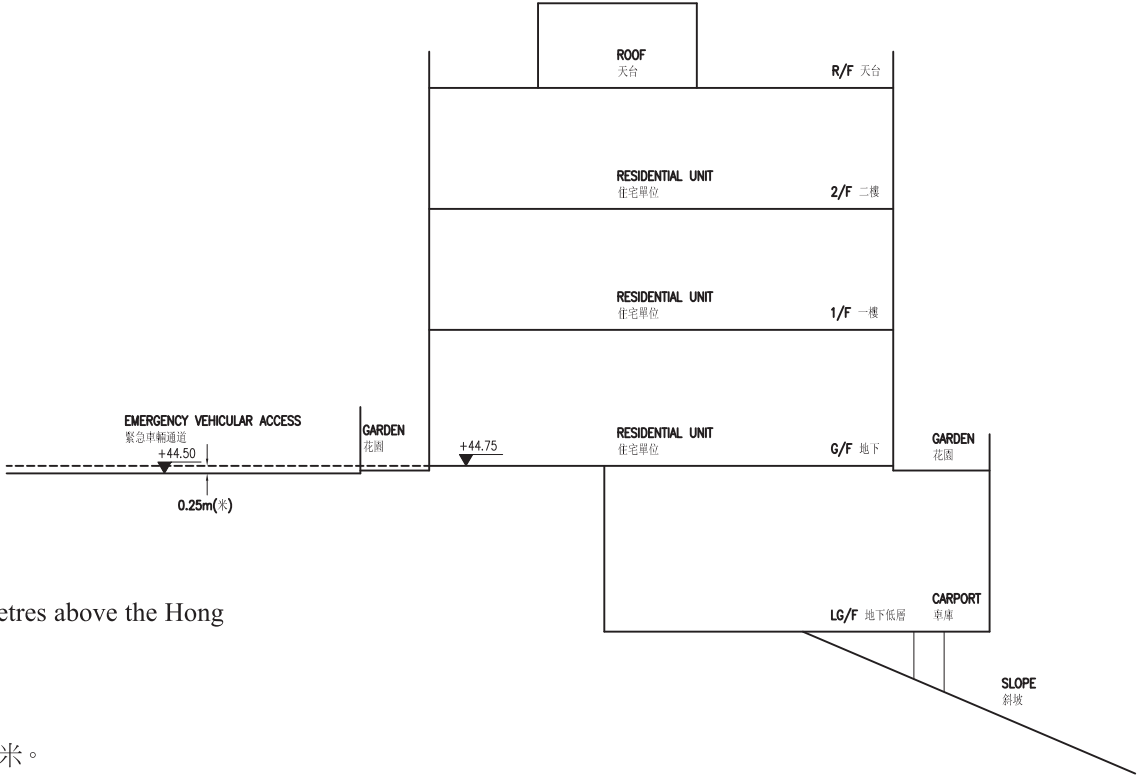
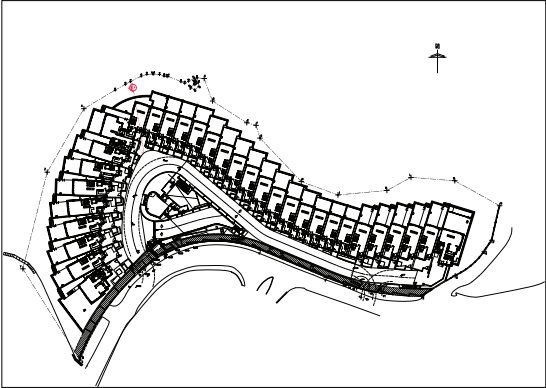

17A Shouson Hill Road 壽山村道 17A 號

The part of Driveway adjacent to the building is 44.50 metres above the Hong Kong Principal Datum.

Dotted line denotes the lowest residential floor.

毗連建築物的一段車路為香港主水平基準以上44.50米。
虛線為最低住宅樓層水平。

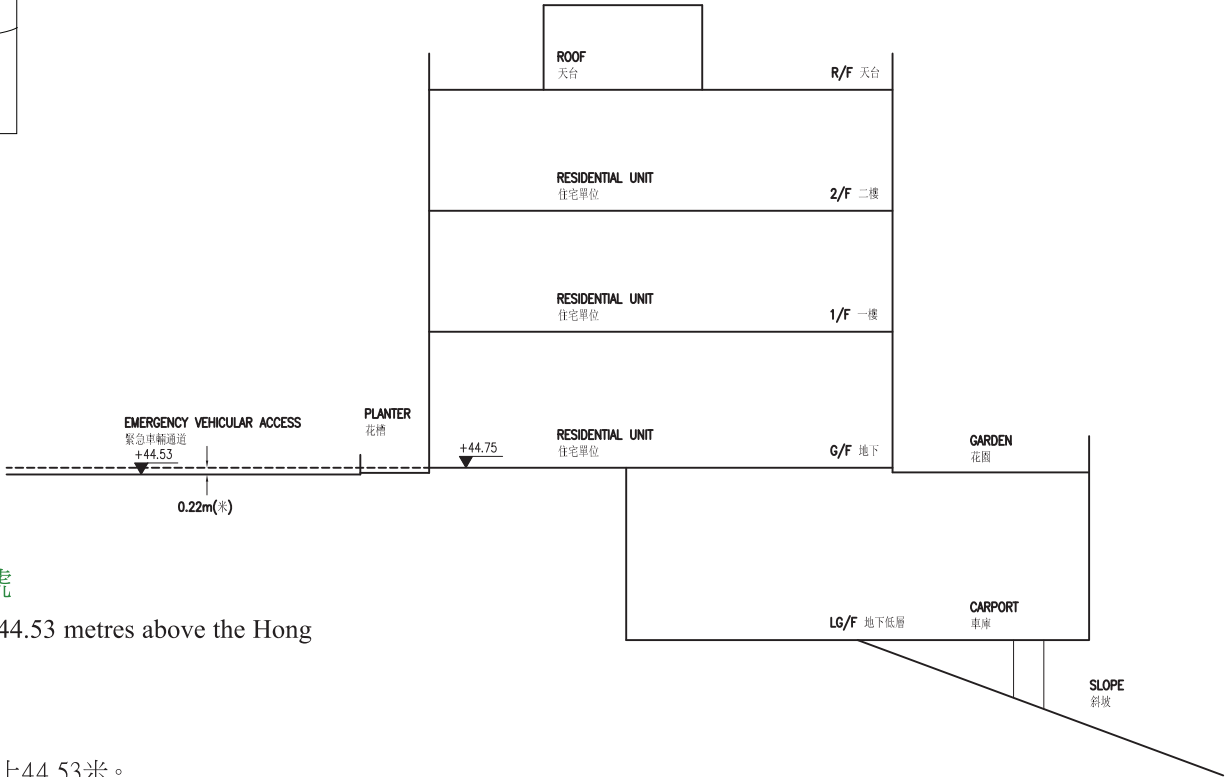
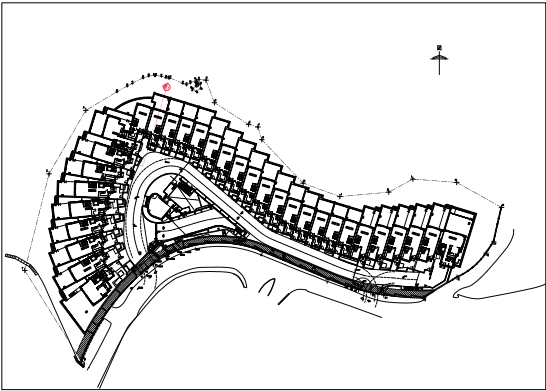

17B Shouson Hill Road 壽山村道 17B 號

The part of Driveway adjacent to the building is 44.53 metres above the Hong Kong Principal Datum.

Dotted line denotes the lowest residential floor.

毗連建築物的一段車路為香港主水平基準以上44.53米。
虛線為最低住宅樓層水平。

CROSS-SECTION PLAN OF BUILDING IN THE DEVELOPMENT

發展項目中的建築物的橫截面圖

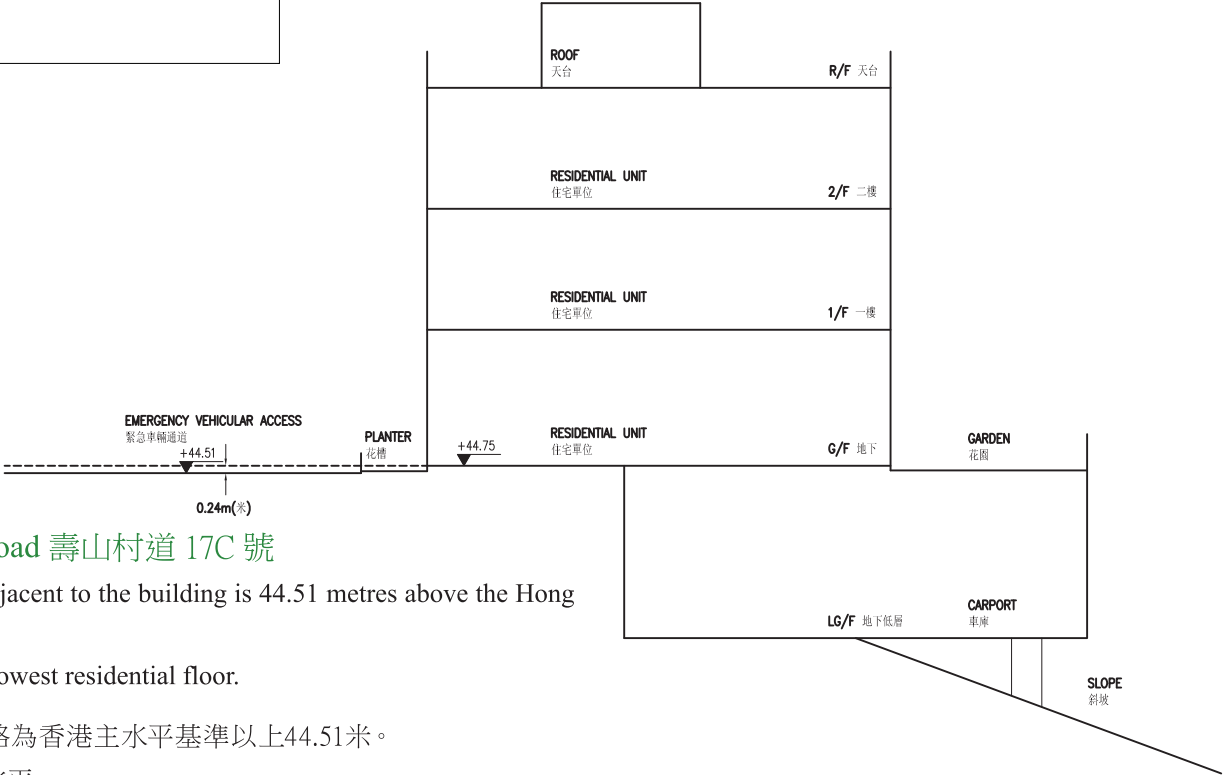
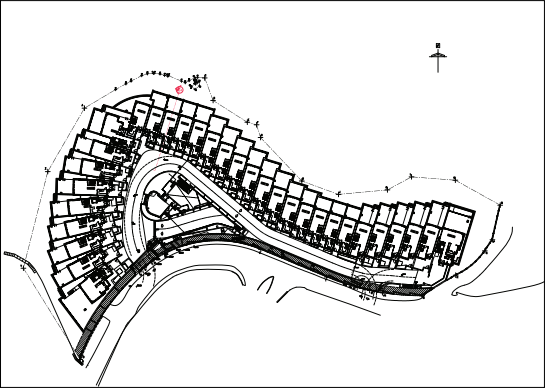

17C Shouson Hill Road 壽山村道 17C 號

The part of Driveway adjacent to the building is 44.51 metres above the Hong Kong Principal Datum.

Dotted line denotes the lowest residential floor.

毗連建築物的一段車路為香港主水平基準以上44.51米。
虛線為最低住宅樓層水平。

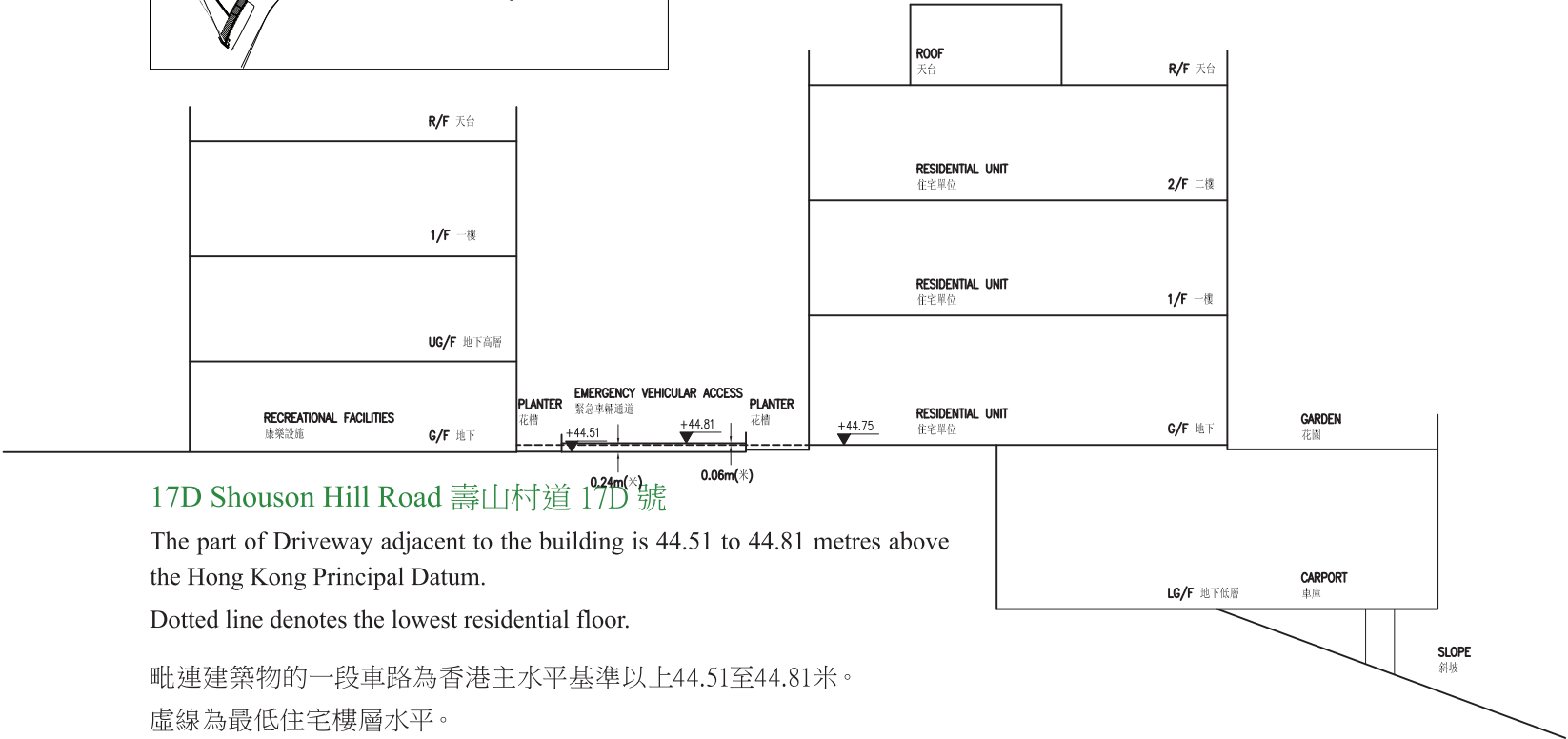
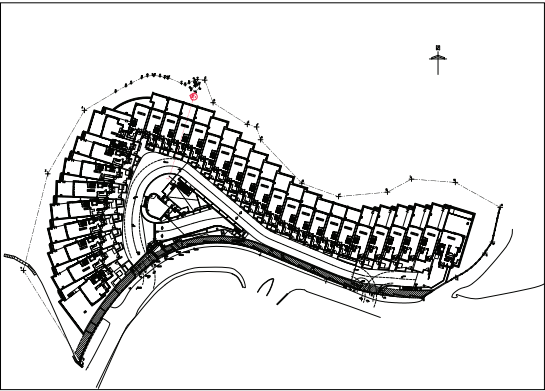

17D Shouson Hill Road 壽山村道 17D 號

The part of Driveway adjacent to the building is 44.51 to 44.81 metres above the Hong Kong Principal Datum.

Dotted line denotes the lowest residential floor.

毗連建築物的一段車路為香港主水平基準以上44.51至44.81米。
虛線為最低住宅樓層水平。

CROSS-SECTION PLAN OF BUILDING IN THE DEVELOPMENT

發展項目中的建築物的橫截面圖

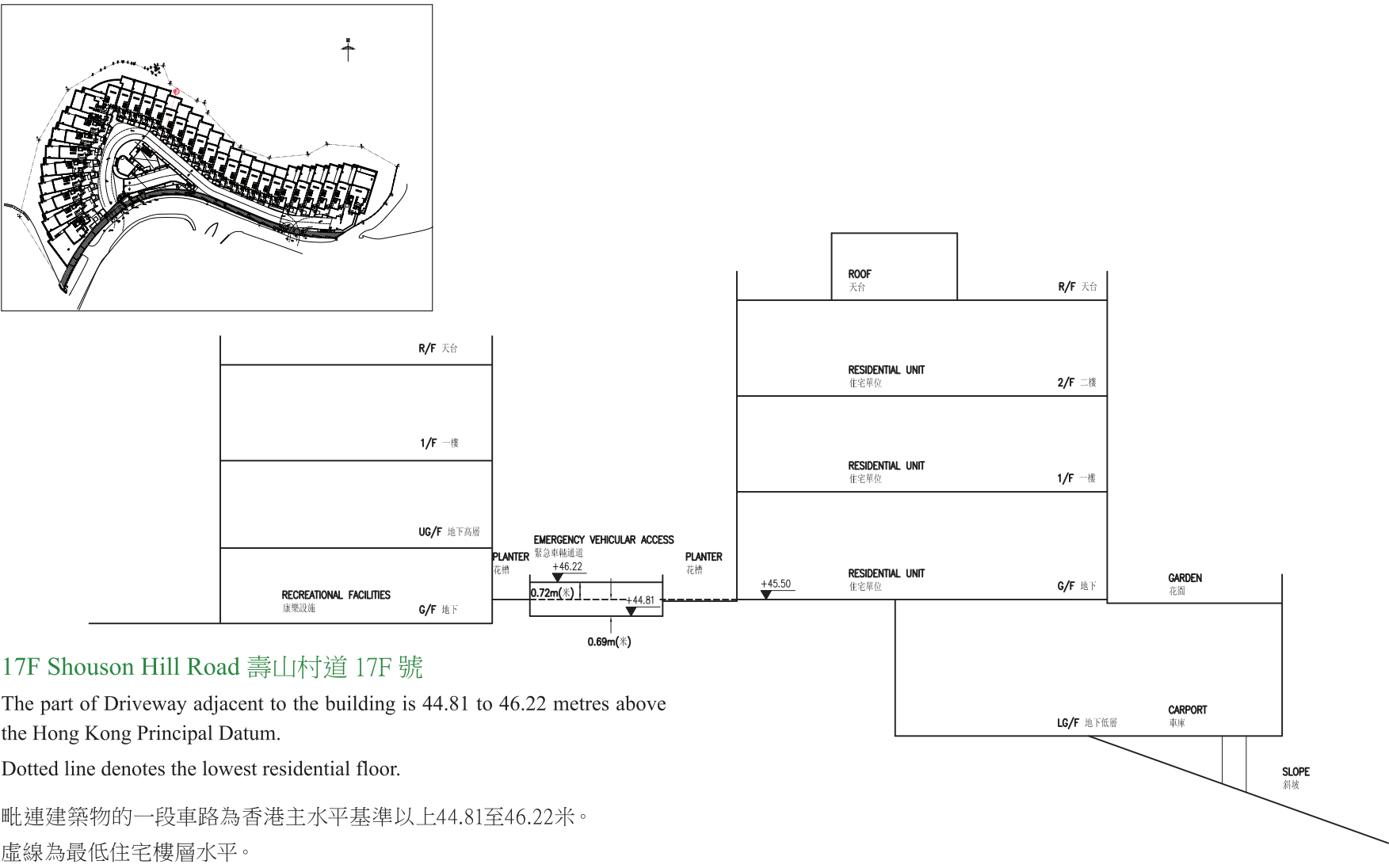
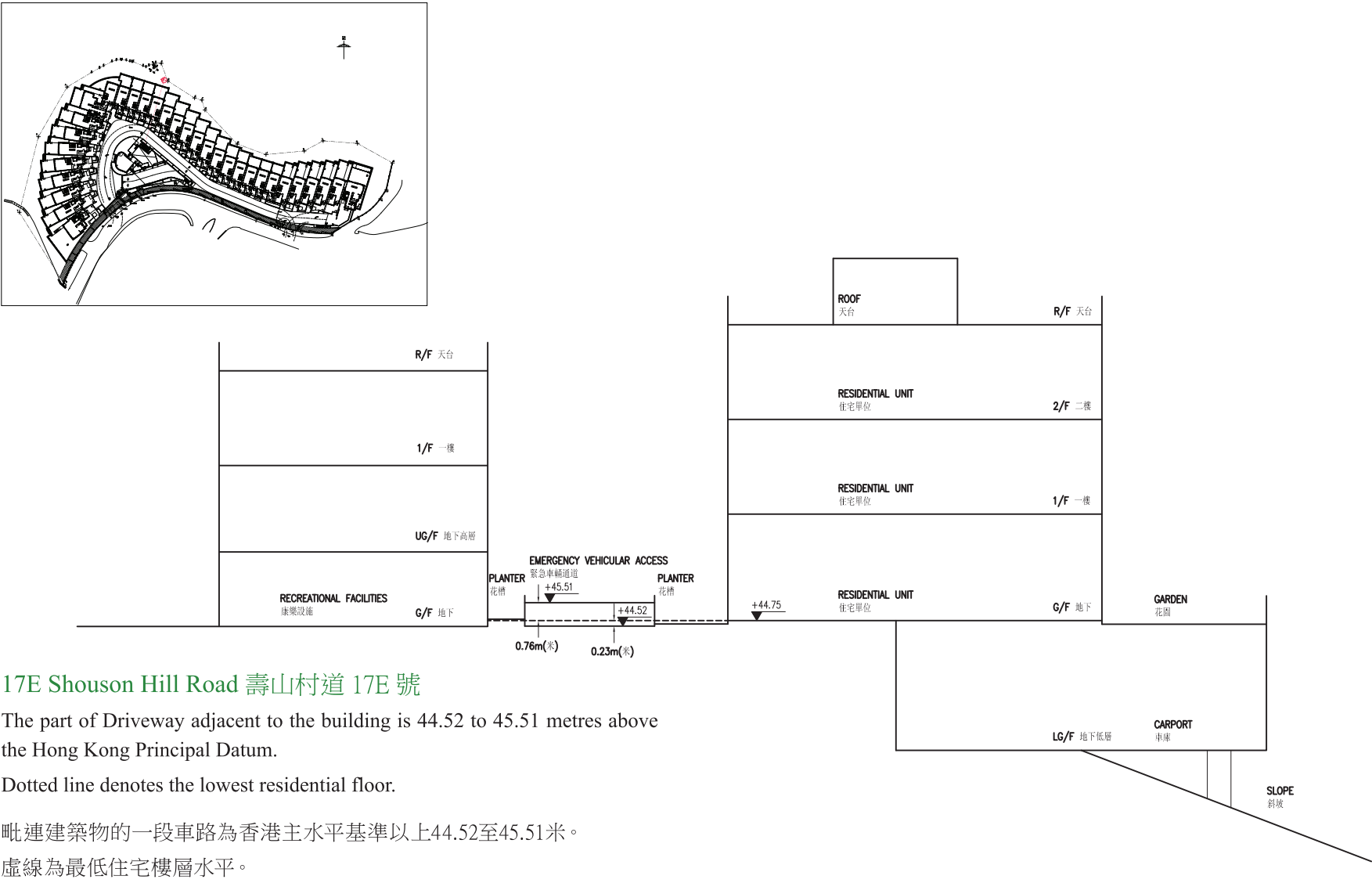

CROSS-SECTION PLAN OF BUILDING IN THE DEVELOPMENT

發展項目中的建築物的橫截面圖

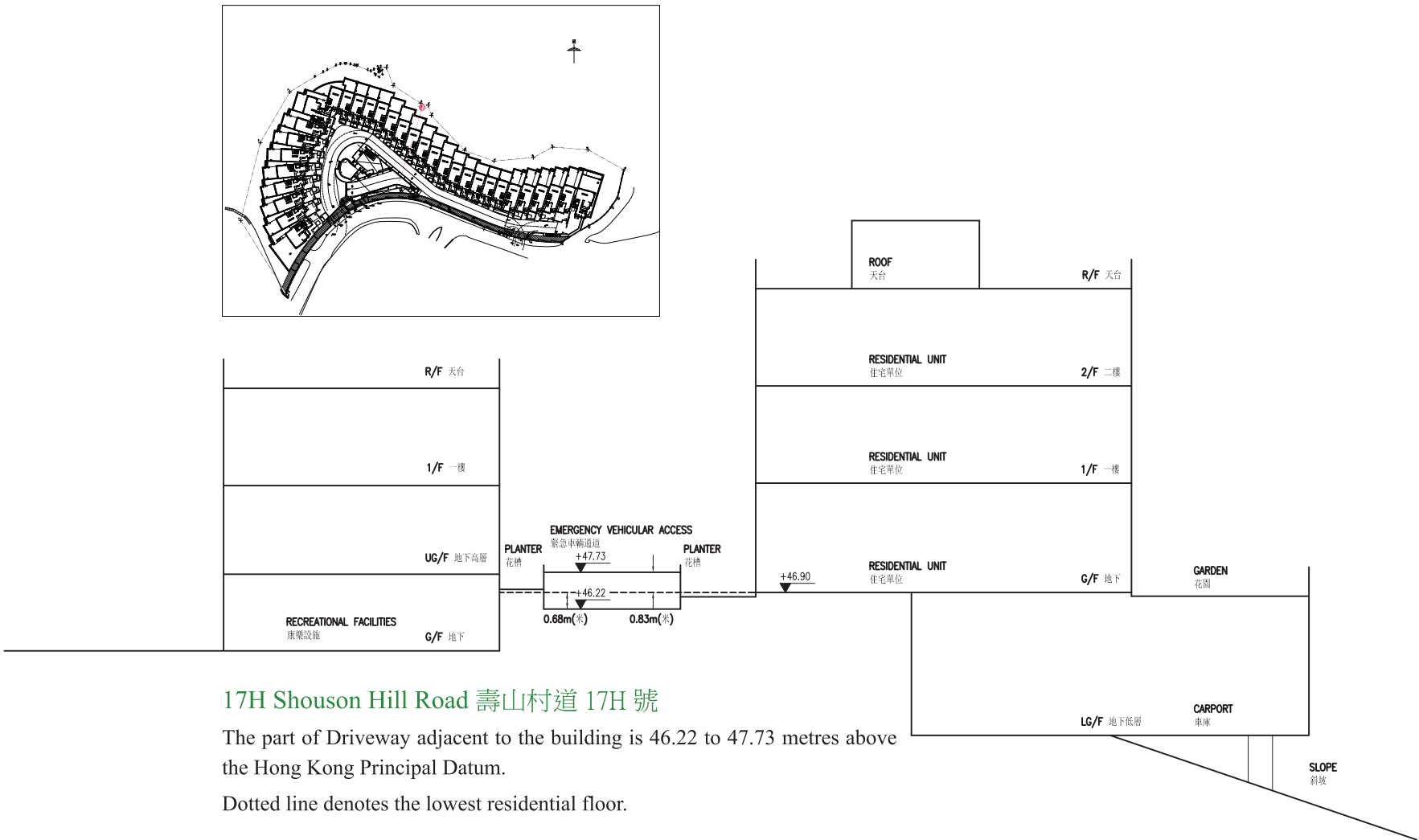
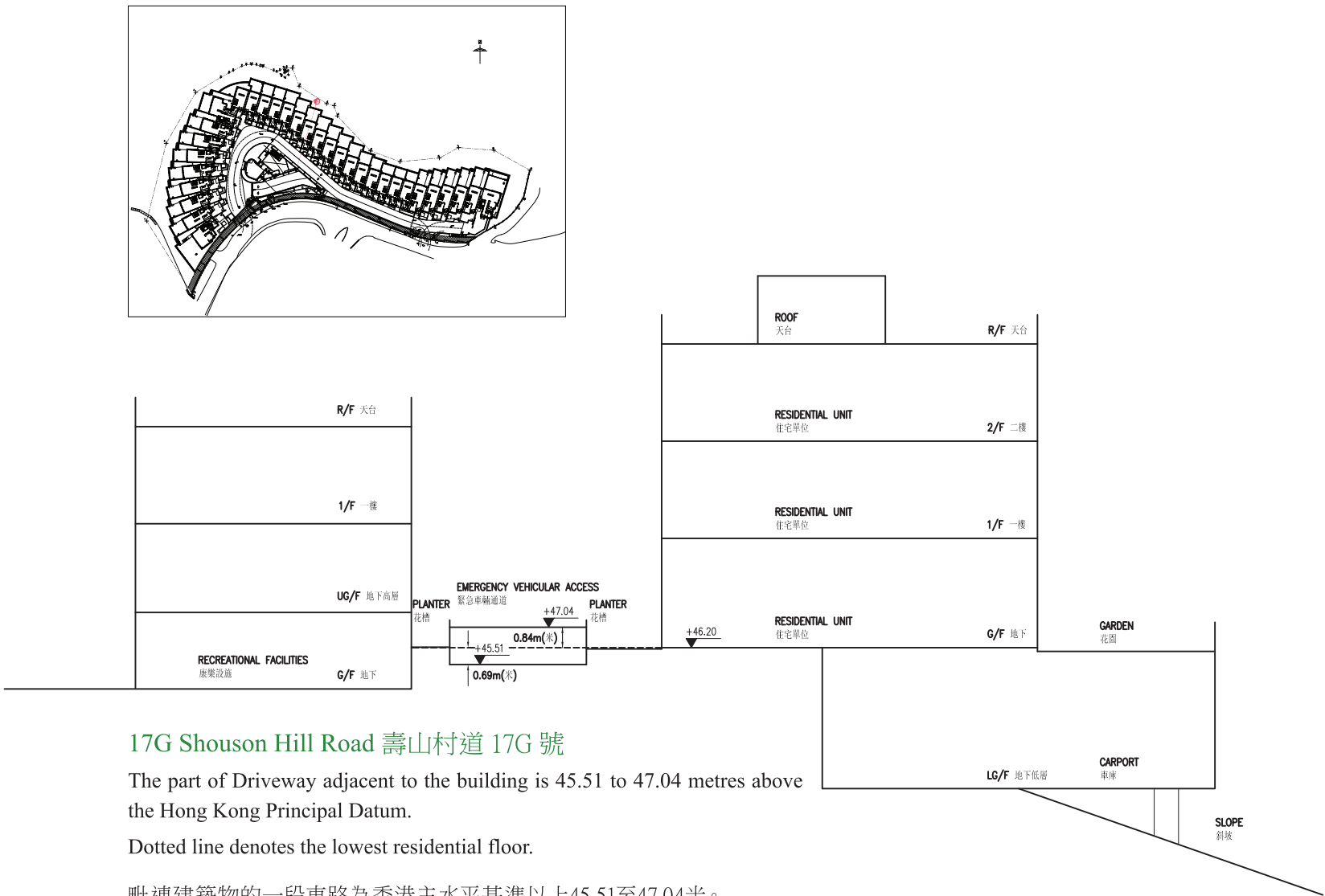

CROSS-SECTION PLAN OF BUILDING IN THE DEVELOPMENT

發展項目中的建築物的橫截面圖

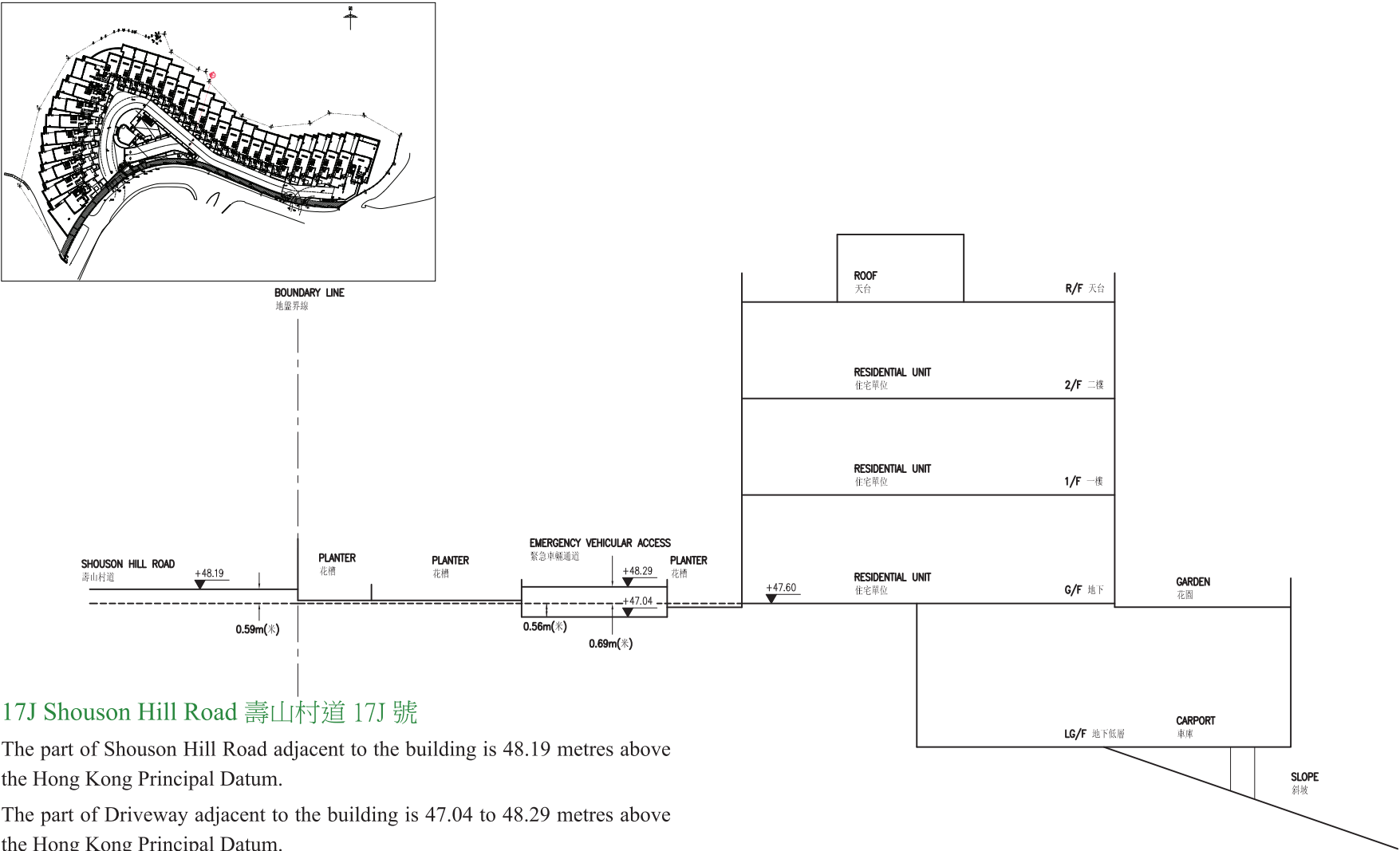

17J Shouson Hill Road 壽山村道 17J 號

The part of Shouson Hill Road adjacent to the building is 48.19 metres above the Hong Kong Principal Datum.

The part of Driveway adjacent to the building is 47.04 to 48.29 metres above the Hong Kong Principal Datum.

Dotted line denotes the lowest residential floor.

毗連建築物的一段壽山村道為香港主水平基準以上48.19米。

毗連建築物的一段車路為香港主水平基準以上47.04至48.29米。

虛線為最低住宅樓層水平。

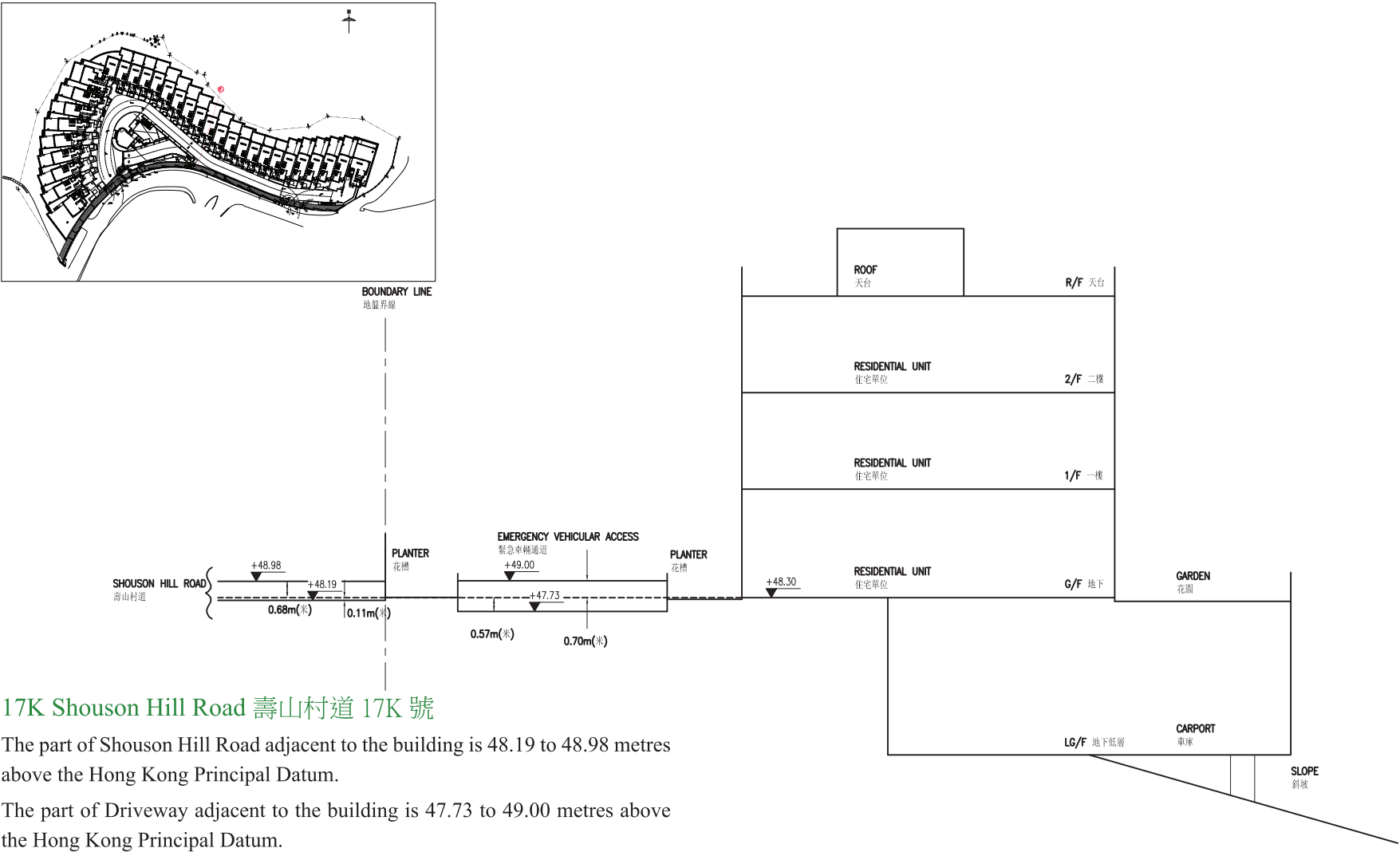

17K Shouson Hill Road 壽山村道 17K 號

The part of Shouson Hill Road adjacent to the building is 48.19 to 48.98 metres above the Hong Kong Principal Datum.

The part of Driveway adjacent to the building is 47.73 to 49.00 metres above the Hong Kong Principal Datum.

Dotted line denotes the lowest residential floor.

毗連建築物的一段壽山村道為香港主水平基準以上48.19至48.98米。

毗連建築物的一段車路為香港主水平基準以上47.73至49.00米。

虛線為最低住宅樓層水平。

CROSS-SECTION PLAN OF BUILDING IN THE DEVELOPMENT

發展項目中的建築物的橫截面圖

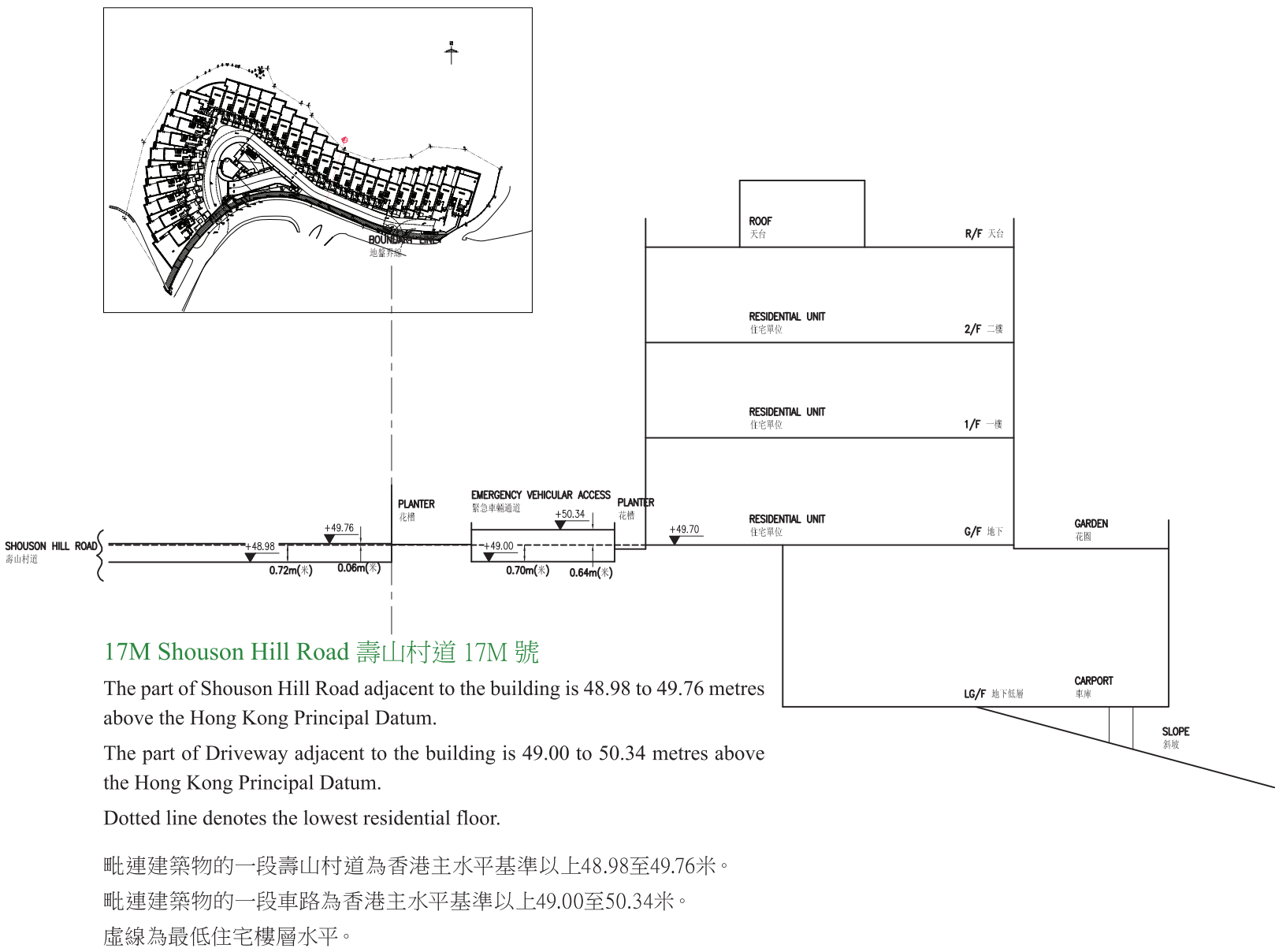
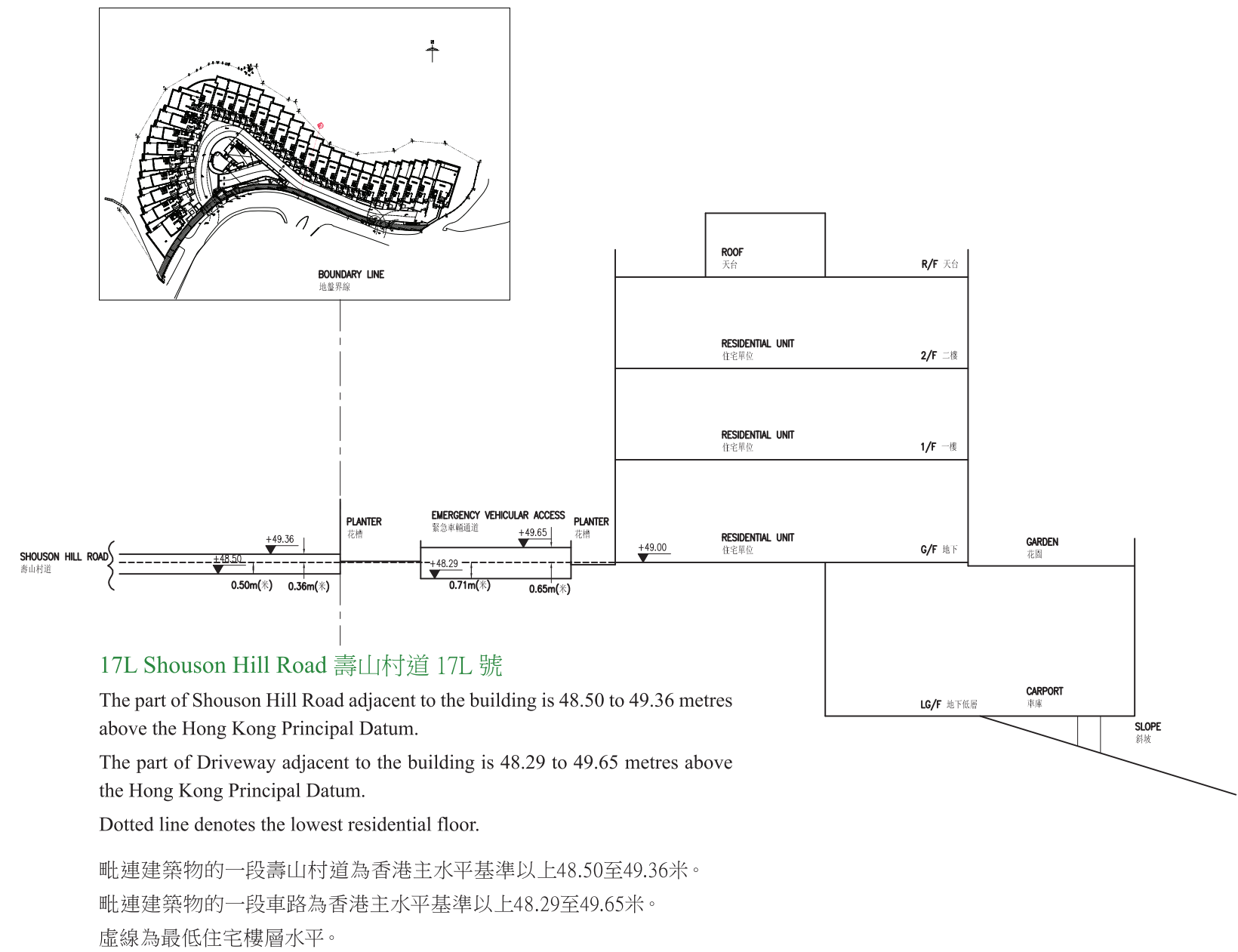

CROSS-SECTION PLAN OF BUILDING IN THE DEVELOPMENT

發展項目中的建築物的橫截面圖

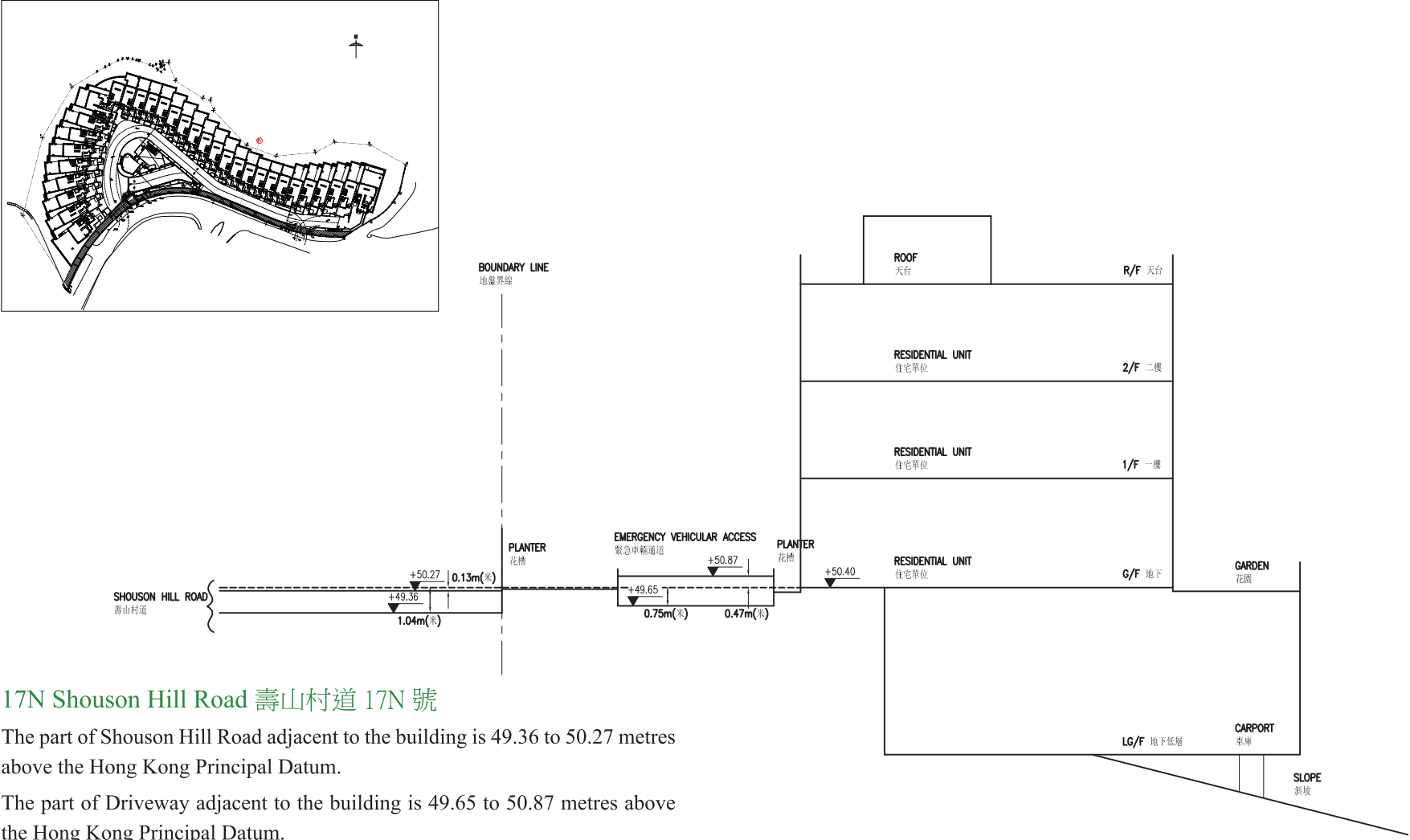

毗連建築物的一段壽山村道為香港主水平基準以上49.36至50.27米。

毗連建築物的一段車路為香港主水平基準以上49.65至50.87米。

虛線為最低住宅樓層水平。

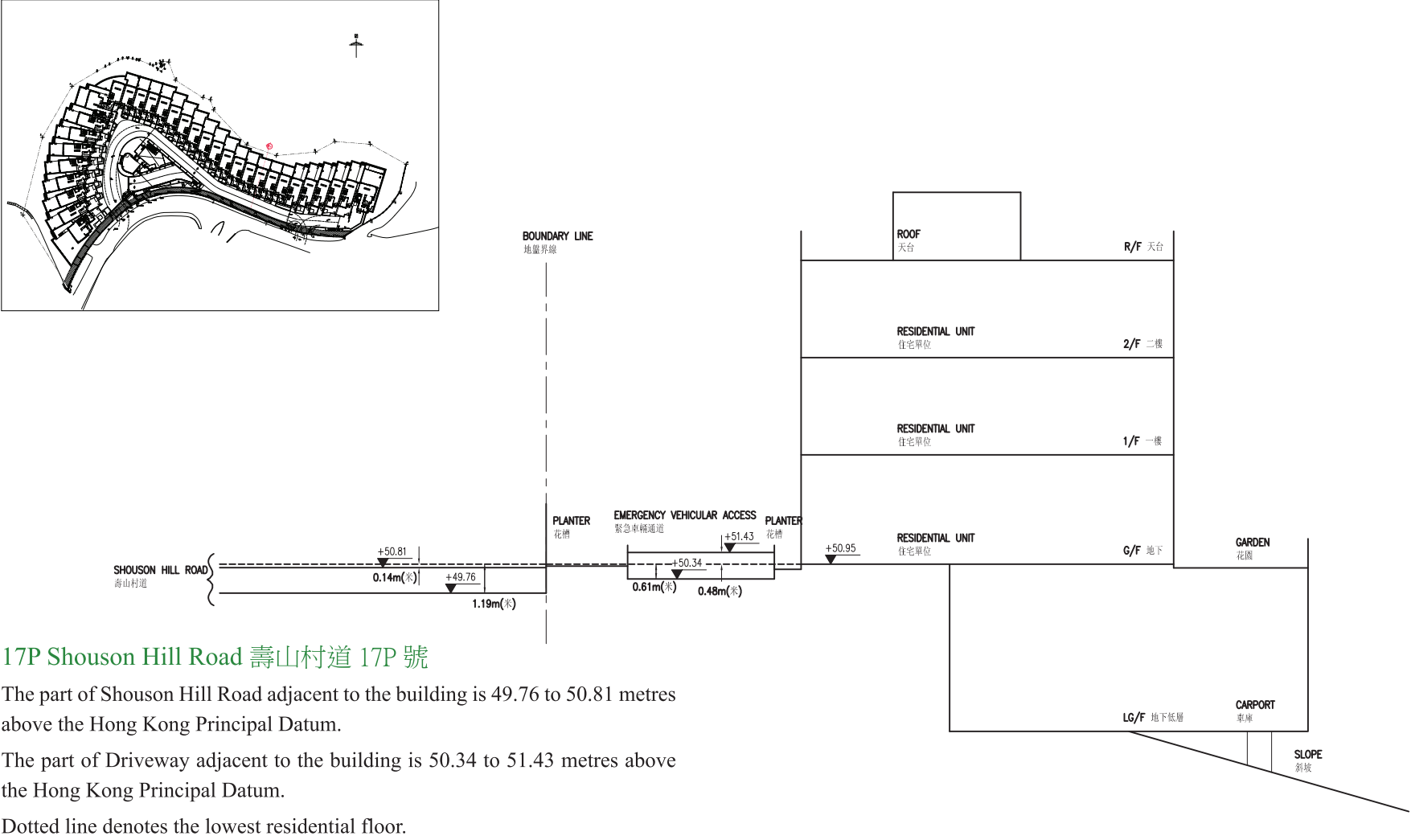

毗連建築物的一段壽山村道為香港主水平基準以上49.76至50.81米。

毗連建築物的一段車路為香港主水平基準以上50.34至51.43米。

虛線為最低住宅樓層水平。

CROSS-SECTION PLAN OF BUILDING IN THE DEVELOPMENT

發展項目中的建築物的橫截面圖

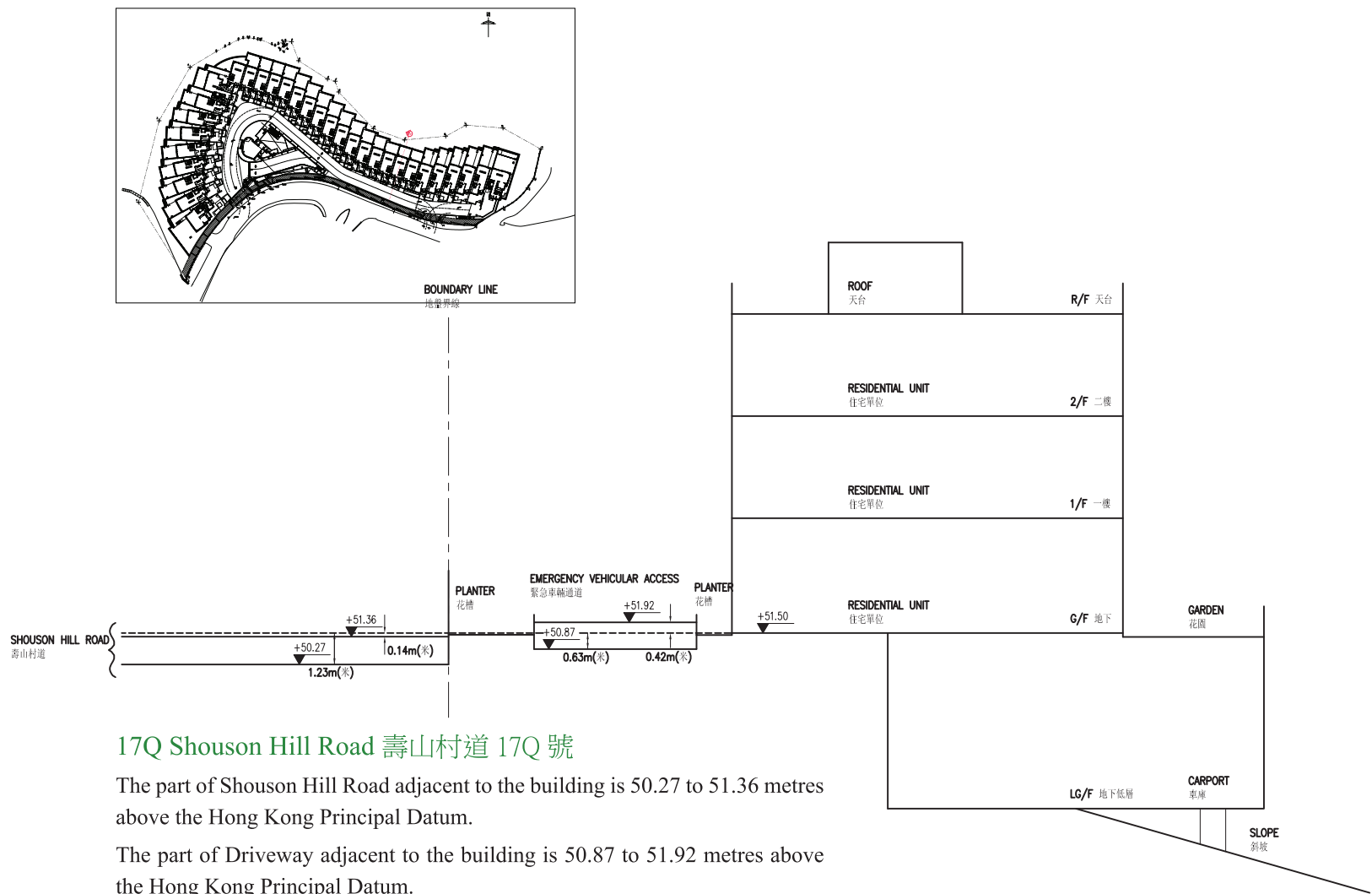

17Q Shouson Hill Road 壽山村道 17Q 號

The part of Shouson Hill Road adjacent to the building is 50.27 to 51.36 metres above the Hong Kong Principal Datum.

The part of Driveway adjacent to the building is 50.87 to 51.92 metres above the Hong Kong Principal Datum.

Dotted line denotes the lowest residential floor.

毗連建築物的一段壽山村道為香港主水平基準以上50.27至51.36米。

毗連建築物的一段車路為香港主水平基準以上50.87至51.92米。

虛線為最低住宅樓層水平。

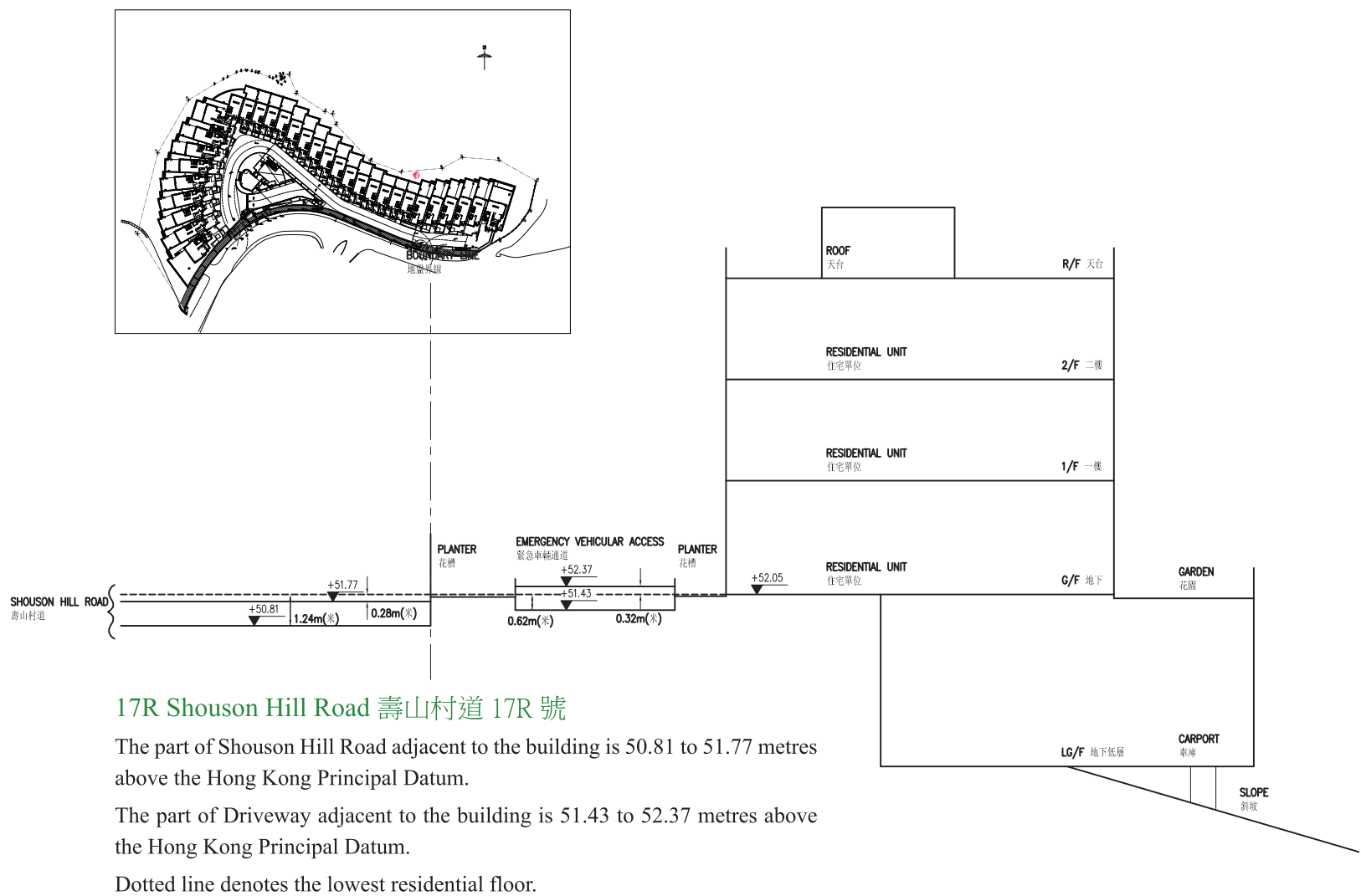

17R Shouson Hill Road 壽山村道 17R 號

The part of Shouson Hill Road adjacent to the building is 50.81 to 51.77 metres above the Hong Kong Principal Datum.

The part of Driveway adjacent to the building is 51.43 to 52.37 metres above the Hong Kong Principal Datum.

Dotted line denotes the lowest residential floor.

毗連建築物的一段壽山村道為香港主水平基準以上50.81至51.77米。

毗連建築物的一段車路為香港主水平基準以上51.43至52.37米。

虛線為最低住宅樓層水平。

CROSS-SECTION PLAN OF BUILDING IN THE DEVELOPMENT

發展項目中的建築物的橫截面圖

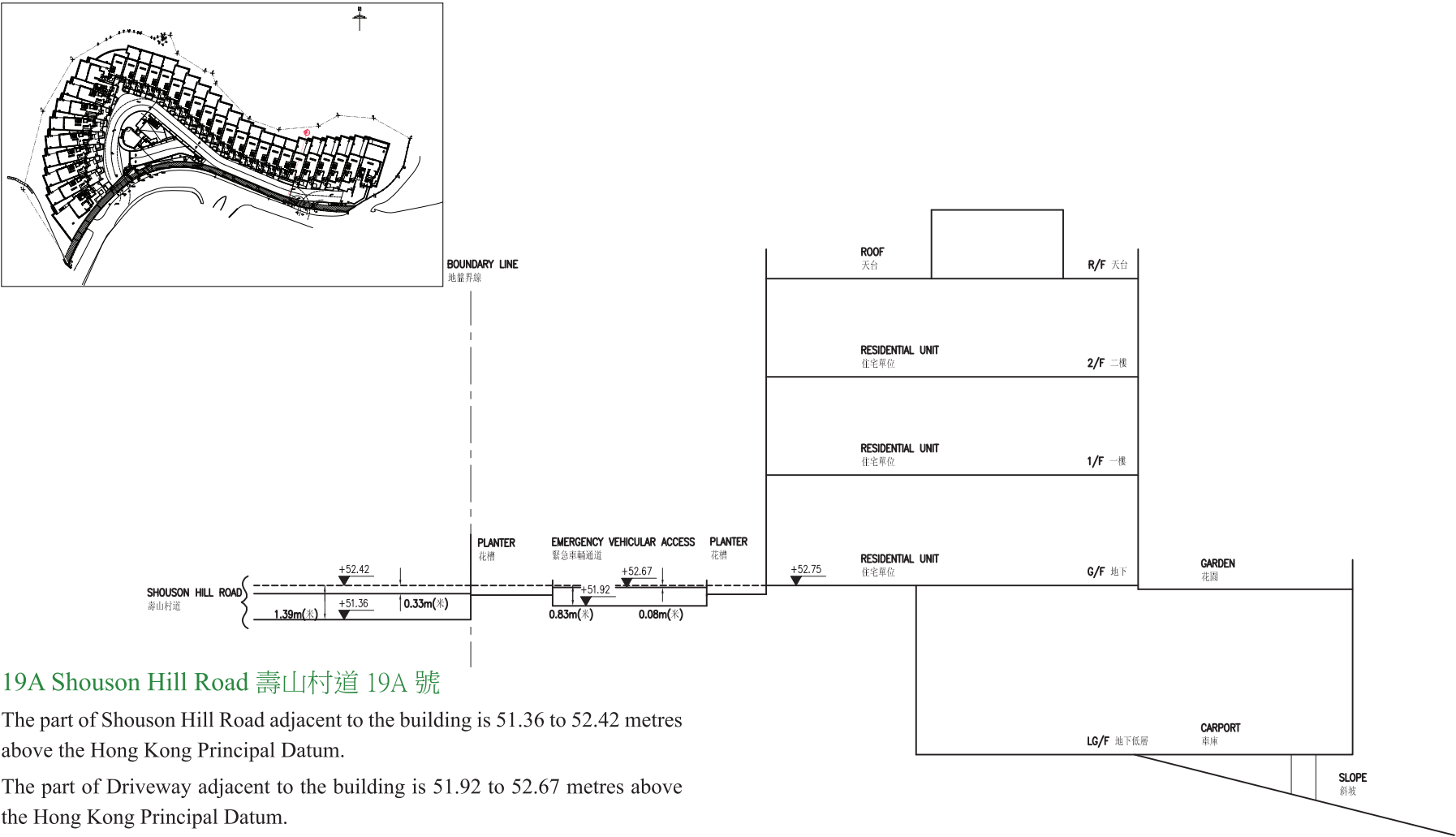

19A Shouson Hill Road 壽山村道 19A 號

The part of Shouson Hill Road adjacent to the building is 51.36 to 52.42 metres above the Hong Kong Principal Datum.

The part of Driveway adjacent to the building is 51.92 to 52.67 metres above the Hong Kong Principal Datum.

Dotted line denotes the lowest residential floor.

毗連建築物的一段壽山村道為香港主水平基準以上51.36至52.42米。

毗連建築物的一段車路為香港主水平基準以上51.92至52.67米。

虛線為最低住宅樓層水平。

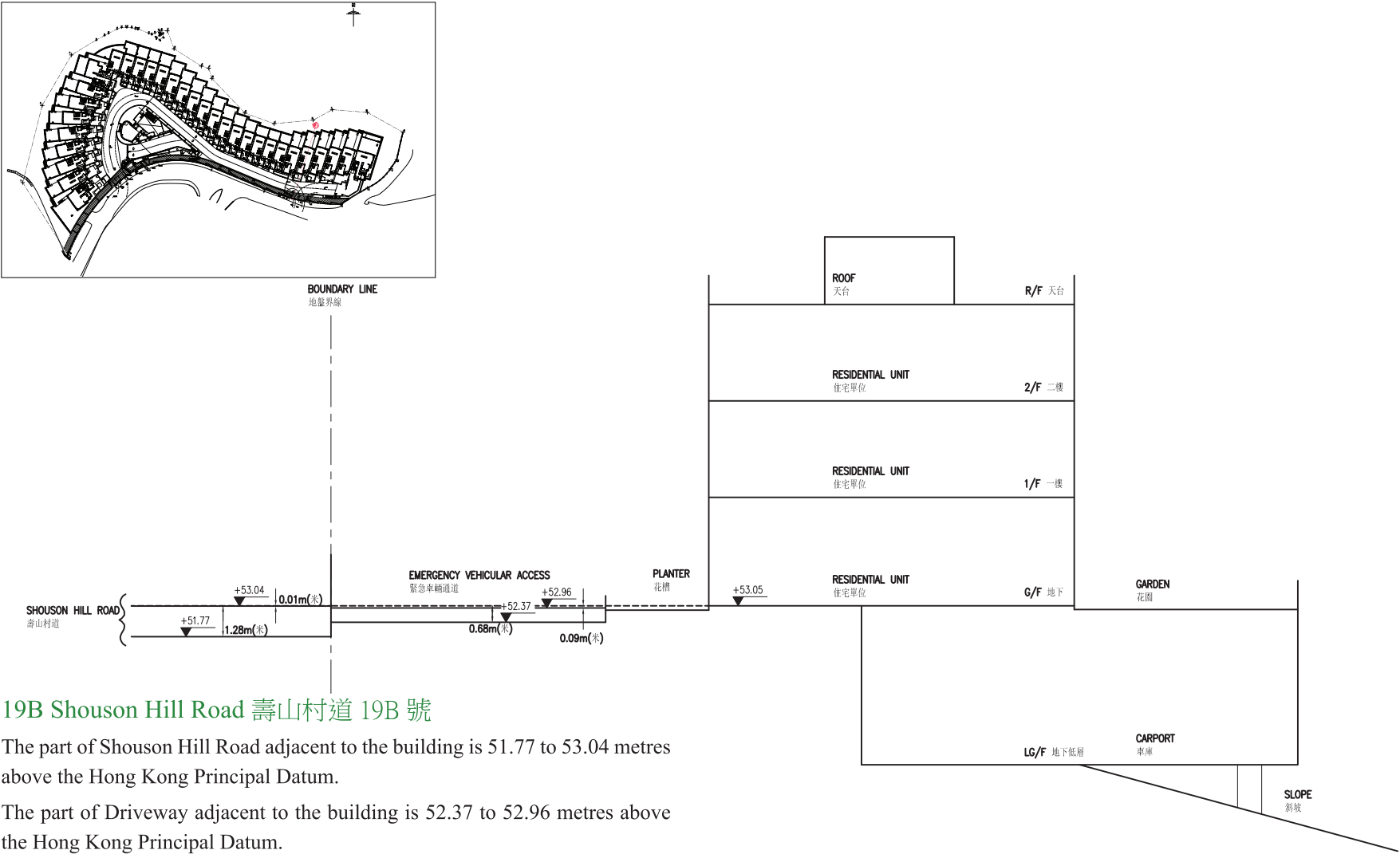

19B Shouson Hill Road 壽山村道 19B 號

The part of Shouson Hill Road adjacent to the building is 51.77 to 53.04 metres above the Hong Kong Principal Datum.

The part of Driveway adjacent to the building is 52.37 to 52.96 metres above the Hong Kong Principal Datum.

Dotted line denotes the lowest residential floor.

毗連建築物的一段壽山村道為香港主水平基準以上51.77至53.04米。

毗連建築物的一段車路為香港主水平基準以上52.37至52.96米。

虛線為最低住宅樓層水平。

CROSS-SECTION PLAN OF BUILDING IN THE DEVELOPMENT

發展項目中的建築物的橫截面圖

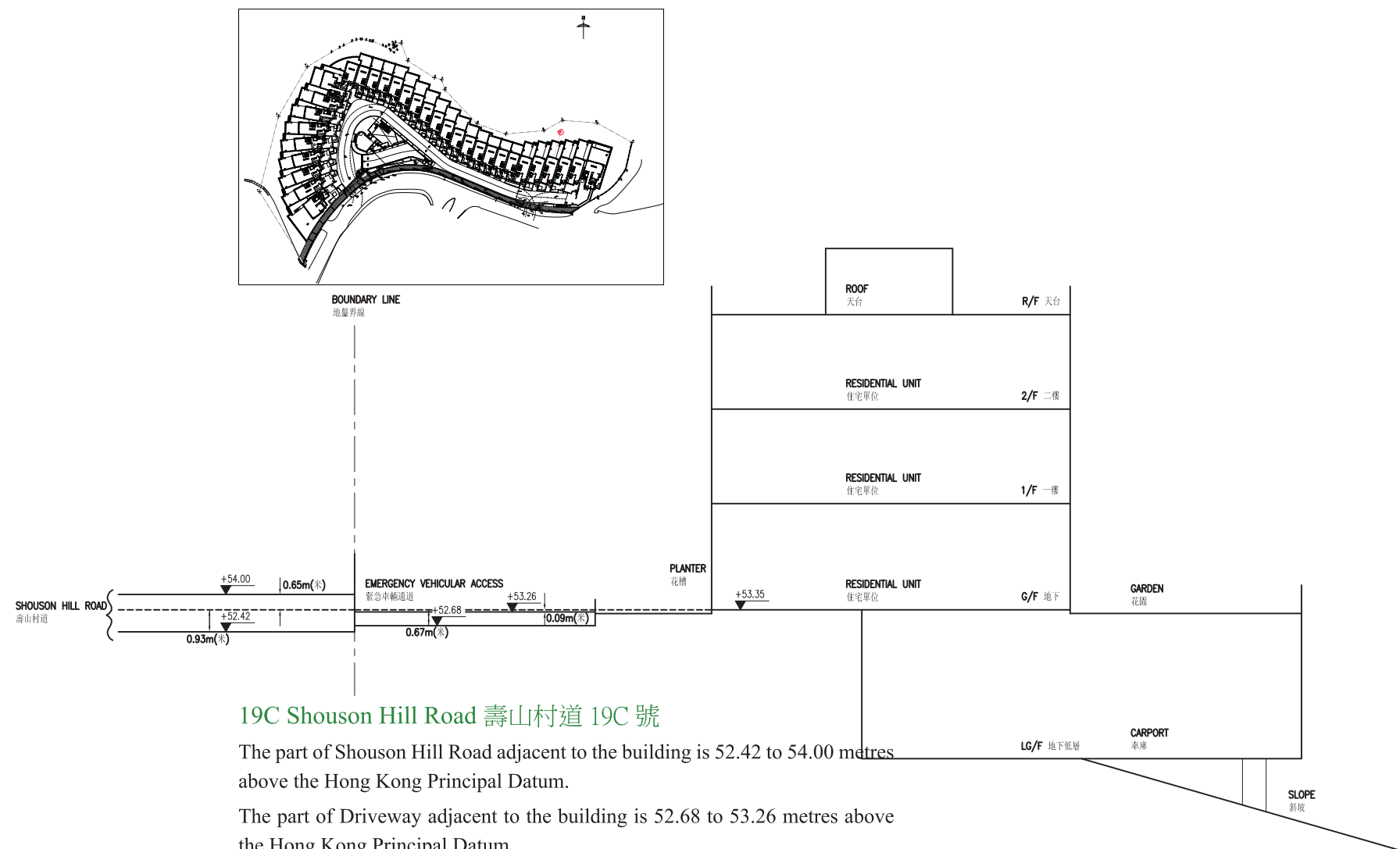

19C Shouson Hill Road 壽山村道 19C 號

The part of Shouson Hill Road adjacent to the building is 52.42 to 54.00 metres above the Hong Kong Principal Datum.

The part of Driveway adjacent to the building is 52.68 to 53.26 metres above the Hong Kong Principal Datum.

Dotted line denotes the lowest residential floor.

毗連建築物的一段壽山村道為香港主水平基準以上52.42至54.00米。

毗連建築物的一段車路為香港主水平基準以上52.68至53.26米。

虛線為最低住宅樓層水平。

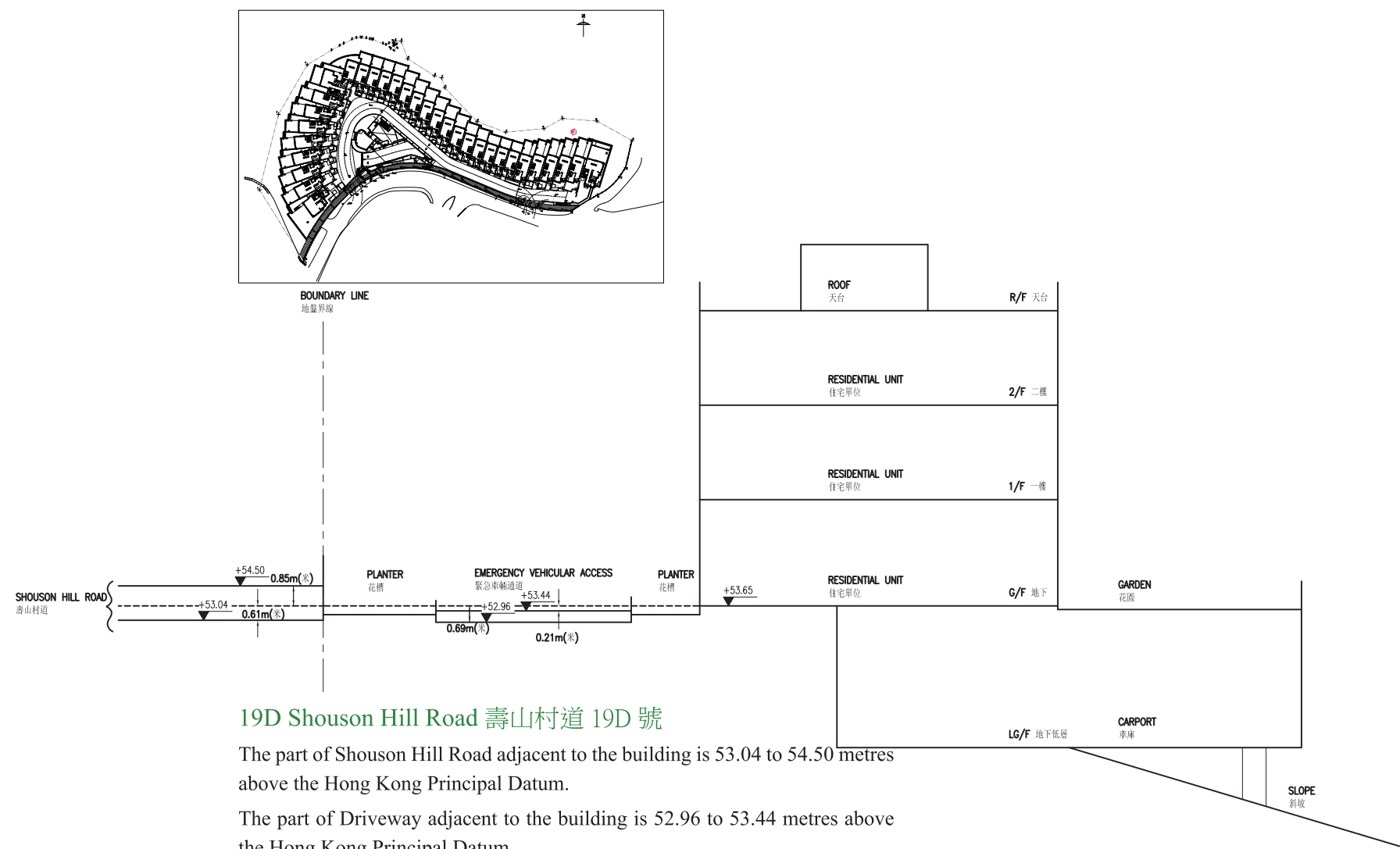

19D Shouson Hill Road 壽山村道 19D 號

The part of Shouson Hill Road adjacent to the building is 53.04 to 54.50 metres above the Hong Kong Principal Datum.

The part of Driveway adjacent to the building is 52.96 to 53.44 metres above the Hong Kong Principal Datum.

Dotted line denotes the lowest residential floor.

毗連建築物的一段壽山村道為香港主水平基準以上53.04至54.50米。

毗連建築物的一段車路為香港主水平基準以上52.96至53.44米。

虛線為最低住宅樓層水平。

CROSS-SECTION PLAN OF BUILDING IN THE DEVELOPMENT

發展項目中的建築物的橫截面圖

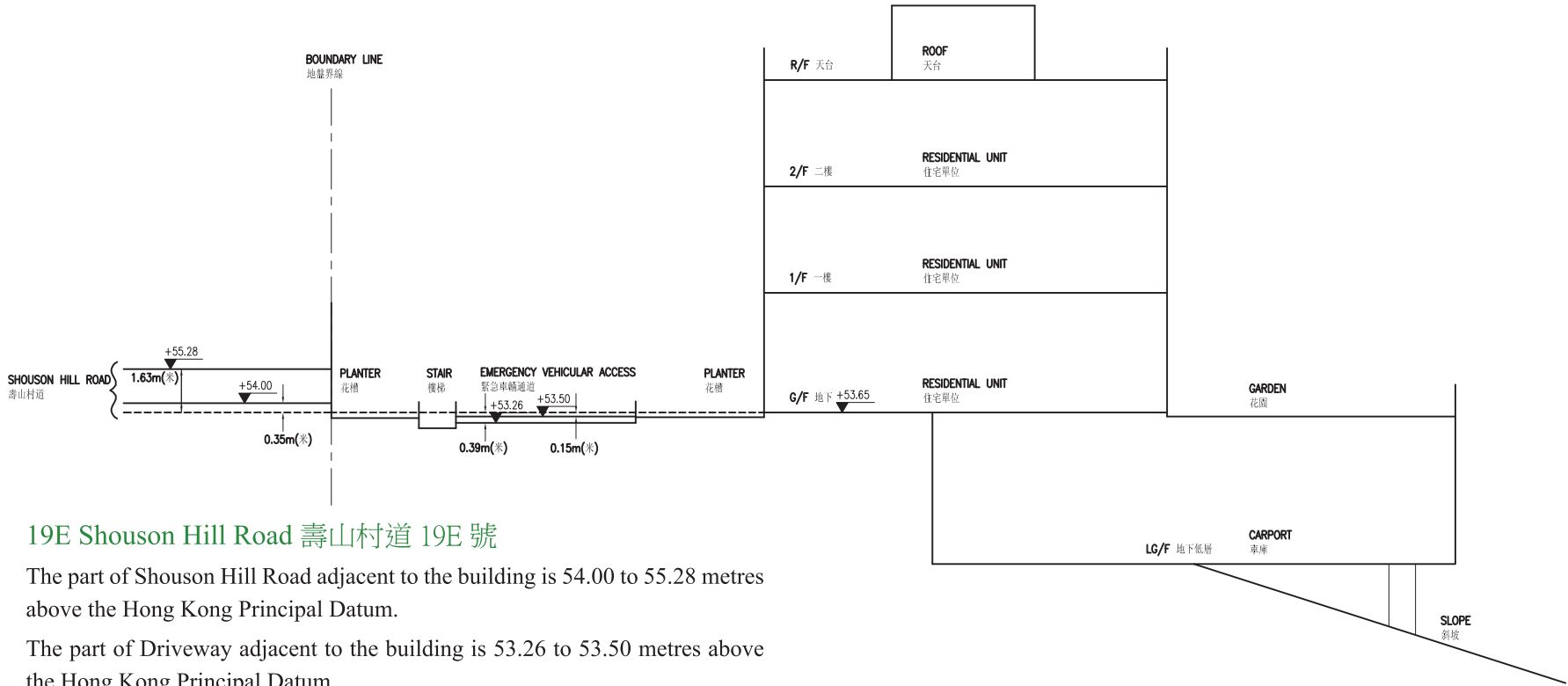
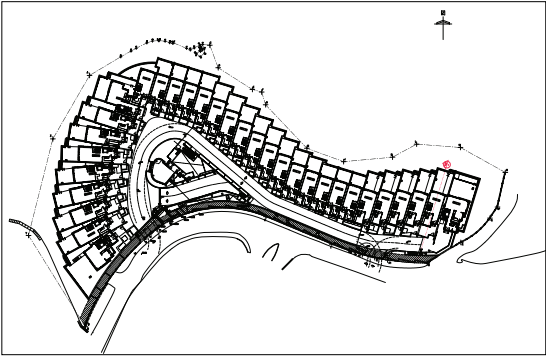

19E Shouson Hill Road 壽山村道 19E 號

The part of Shouson Hill Road adjacent to the building is 54.00 to 55.28 metres above the Hong Kong Principal Datum.

The part of Driveway adjacent to the building is 53.26 to 53.50 metres above the Hong Kong Principal Datum.

Dotted line denotes the lowest residential floor.

毗連建築物的一段壽山村道為香港主水平基準以上54.00至55.28米。

毗連建築物的一段車路為香港主水平基準以上53.26至53.50米。

虛線為最低住宅樓層水平。

發展項目中的建築物的橫截面圖



The part of Shouson Hill Road adjacent to the building is 54.50 to 55.34 metres above the Hong Kong Principal Datum.

Dotted line denotes the lowest residential floor.

毗連建築物的一段壽山村道為香港主水平基準以上54.50至55.34米。
虛線為最低住宅樓層水平。



The part of Shouson Hill Road West adjacent to the building is 51.87 to 55.34 metres above the Hong Kong Principal Datum.

Dotted line denotes the lowest residential floor.

毗連建築物的一段壽臣山道西為香港主水平基準以上51.87至55.34米。
虛線為最低住宅樓層水平。