

1. --- red dotted line denotes the lowest residential floor.
2. ▽ denotes height in metres above Hong Kong Principal Datum (mPD).

The part of Pok Fu Lam Road adjacent to building is 141.00 to 141.25 metres above the Hong Kong Principal Datum.

The part of Footpath adjacent to building is 151.64 to 151.76 metres above the Hong Kong Principal Datum.

1. --- 紅色虛線為最低住宅樓層水平。
2. ▽ 代表香港主水平基準以上高度(米)。

毗連建築物的一段薄扶林道為香港主水平基準以上141.00至141.25米。
毗連建築物的一段行人徑為香港主水平基準以上151.64至151.76米。

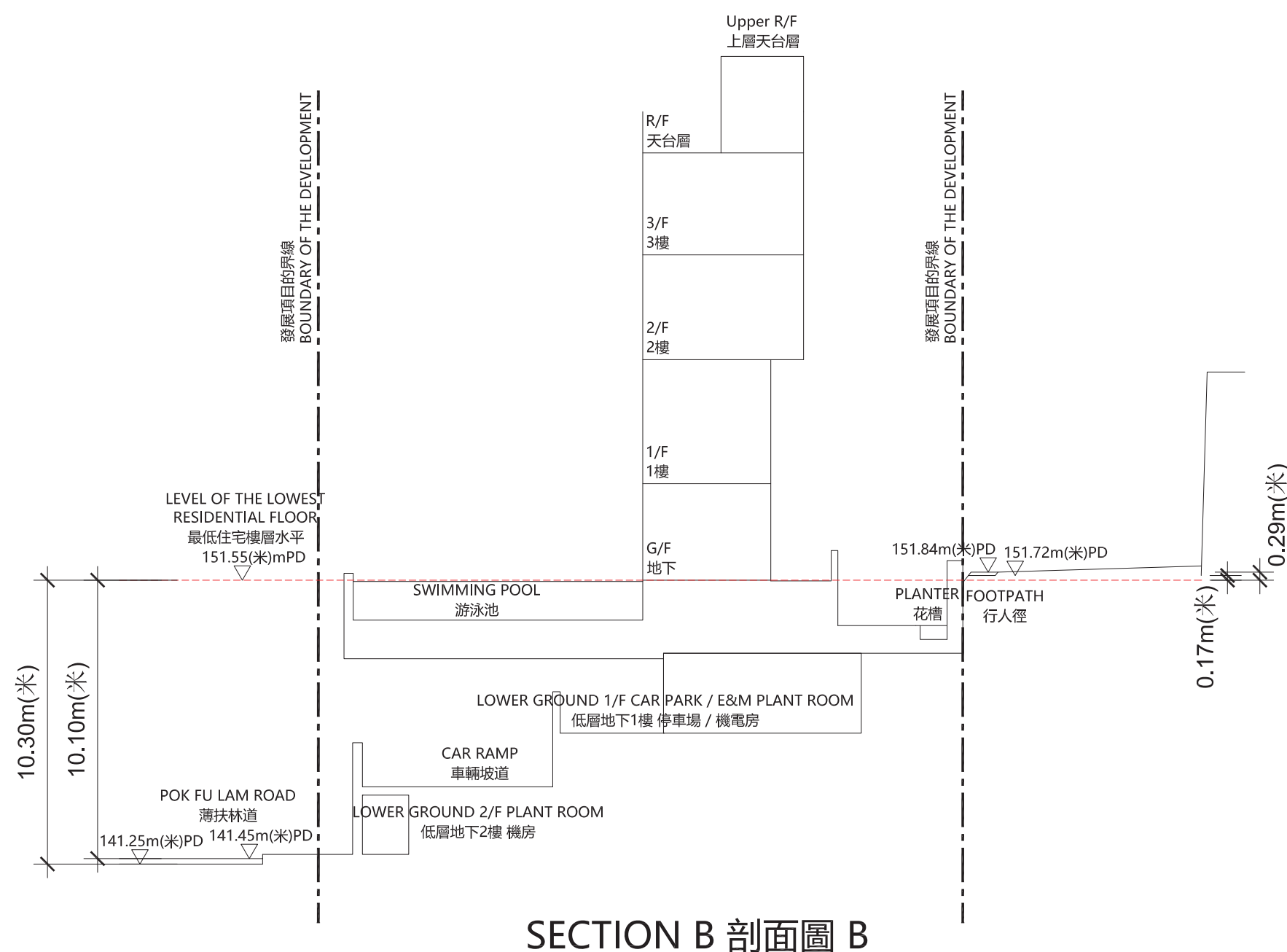
HOUSE 2
洋房2

SECTION B 剖面圖 B

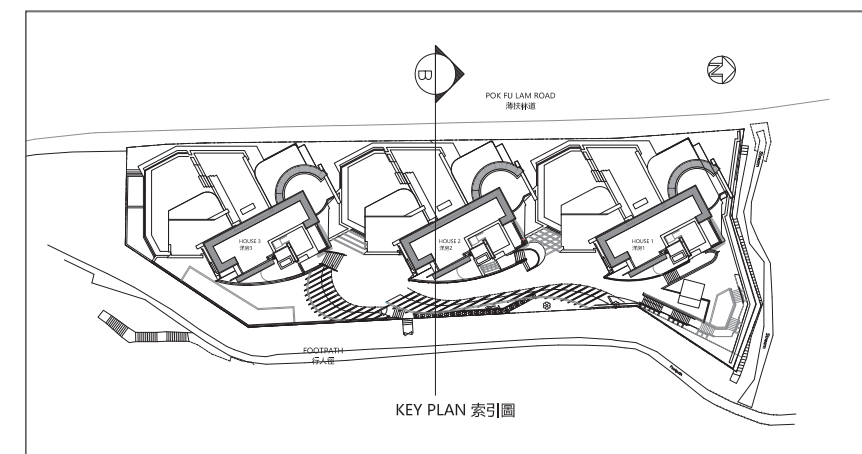

1. --- red dotted line denotes the lowest residential floor.
2. ▽ denotes height in metres above Hong Kong Principal Datum (mPD).

The part of Pok Fu Lam Road adjacent to building is 141.25 to 141.45 metres above the Hong Kong Principal Datum.

The part of Footpath adjacent to building is 151.72 to 151.84 metres above the Hong Kong Principal Datum.

1. --- 紅色虛線為最低住宅樓層水平。
2. ▽ 代表香港主水平基準以上高度(米)。

毗連建築物的一段薄扶林道為香港主水平基準以上141.25至141.45米。
毗連建築物的一段行人徑為香港主水平基準以上151.72至151.84米。

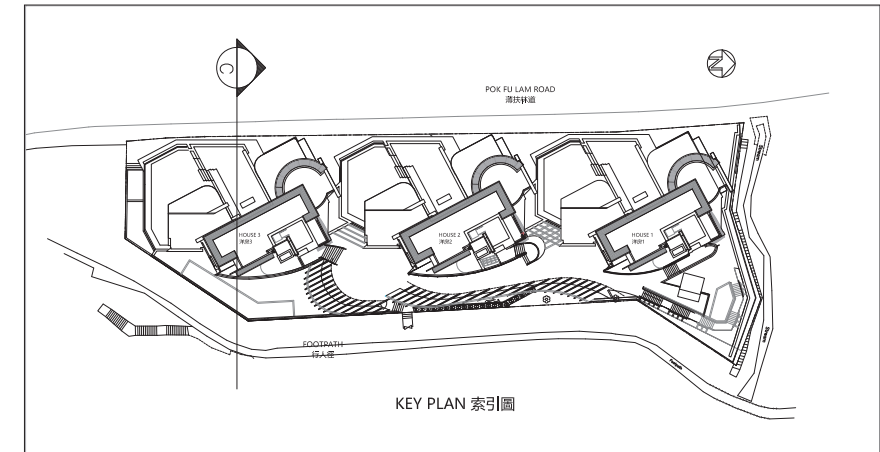
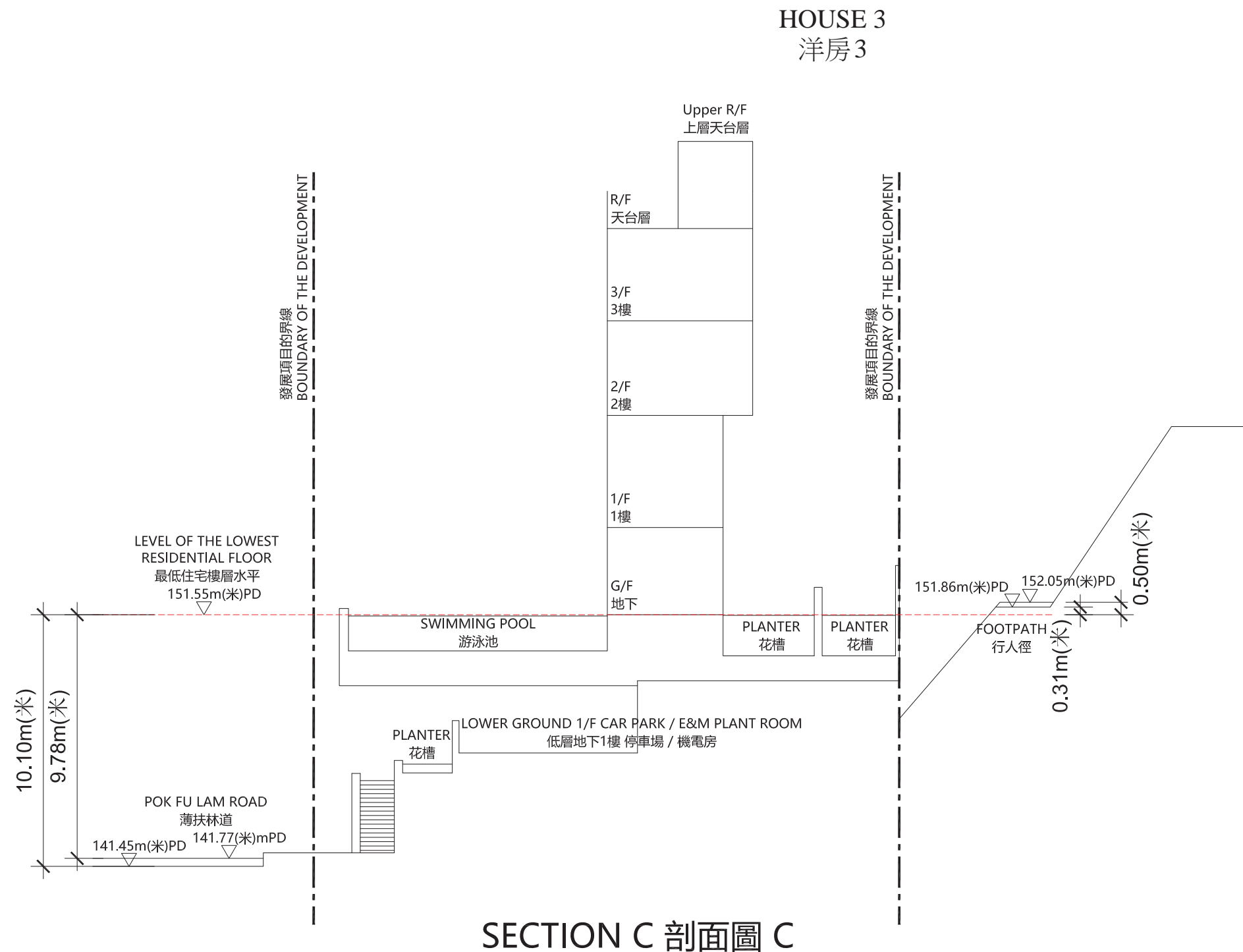

1. --- red dotted line denotes the lowest residential floor.
2. ▽ denotes height in metres above Hong Kong Principal Datum (mPD).

The part of Pok Fu Lam Road adjacent to building is 141.45 to 141.77 metres above the Hong Kong Principal Datum.

The part of Footpath adjacent to building is 151.86 to 152.05 metres above the Hong Kong Principal Datum.

1. --- 紅色虛線為最低住宅樓層水平。
2. ▽ 代表香港主水平基準以上高度(米)。

毗連建築物的一段薄扶林道為香港主水平基準以上141.45至141.77米。
毗連建築物的一段行人徑為香港主水平基準以上151.86至152.05米。

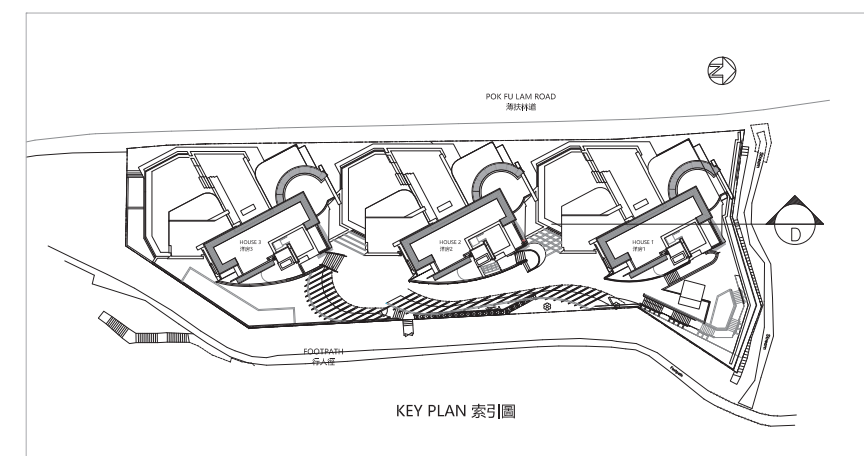
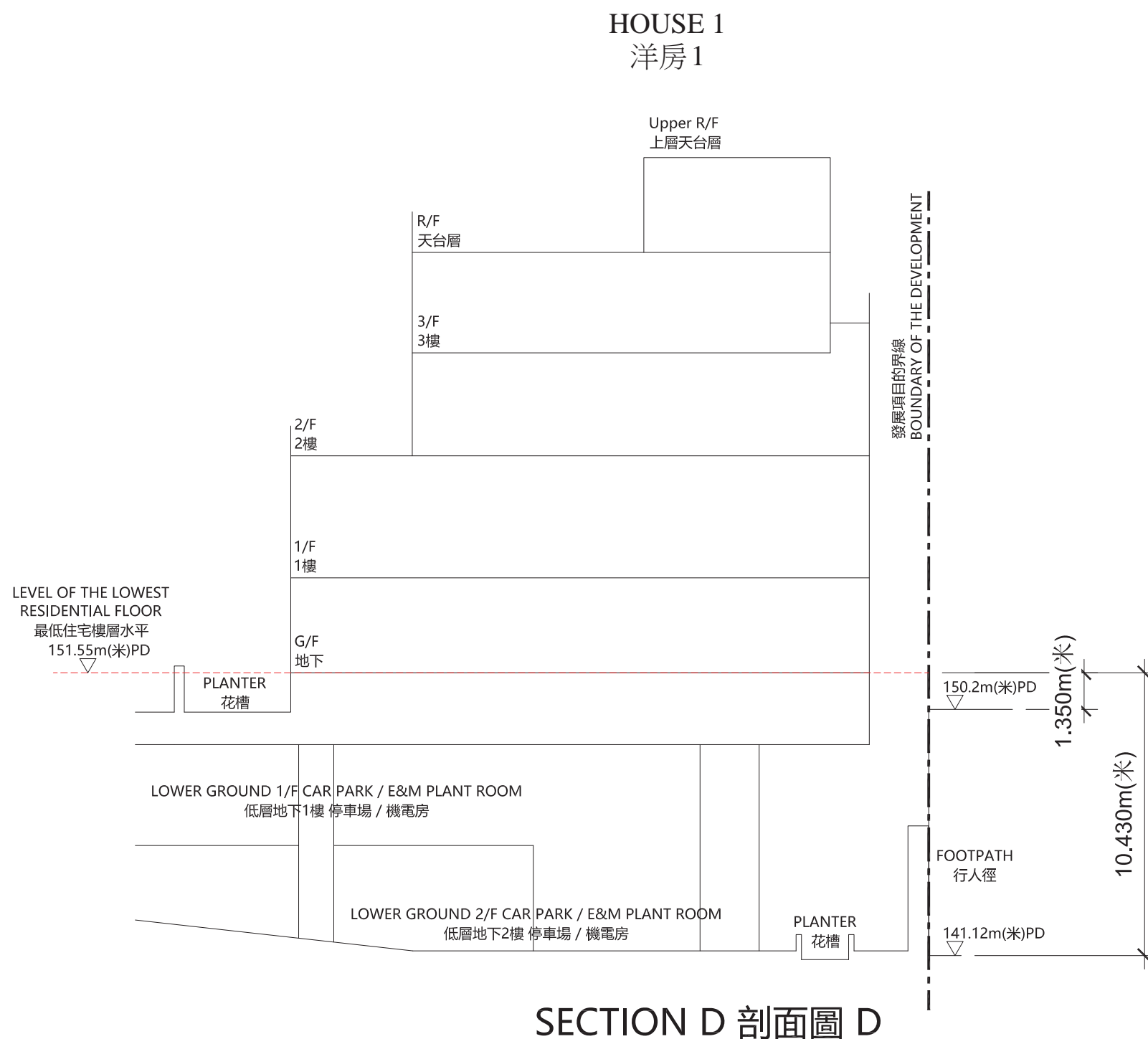

1. --- red dotted line denotes the lowest residential floor.
2. ▽ denotes height in metres above Hong Kong Principal Datum (mPD).

The part of Footpath adjacent to building is 141.12 to 150.20 metres above the Hong Kong Principal Datum.

1. --- 紅色虛線為最低住宅樓層水平。
 2. ▽ 代表香港主水平基準以上高度(米)。
- 毗連建築物的一段行人徑為香港主水平基準以上141.12至150.20米。