

Notes:

1. The last updated Outline Zoning Plan and the attached schedule as at the date of printing of the sales brochure are available for free inspection at the sales office during opening hours.
2. The Vendor advises prospective purchasers to conduct an on-site visit for a better understanding of the Development site, its surrounding environment and the public facilities nearby.
3. This Outline Zoning Plan may show more than the area required under the Residential Properties (First-hand Sales) Ordinance due to technical reason that the boundary of the Development is irregular.
4. This Outline Zoning Plan, prepared by the Planning Department under the direction of the Town Planning Board, is reproduced with the permission of the Director of Lands. ©The Government of Hong Kong SAR.

備註：

1. 在印刷售樓說明書當日所適用的最近期分區計劃大綱圖及其附表，可於售樓處開放時間內免費查閱。
2. 賣方建議準買家到有關發展地盤作實地考察，以對該發展地盤、其周邊地區環境及附近的公共設施有較佳了解。
3. 由於發展項目的邊界不規則的技術原因，此分區計劃大綱圖所顯示的範圍可能超過《一手住宅物業銷售條例》所規定的範圍。
4. 此分區計劃大綱圖為規劃署遵照城市規劃委員會指示擬備，版權屬香港特別行政區政府，經地政總署准許複印。

Adopted from part of the Draft Ho Chung Outline Zoning Plan No. S/SK-HC/12, gazetted on 22nd November 2024, with adjustments where necessary as shown in red.

摘錄自2024年11月22日刊憲之蠔涌分區計劃大綱草圖編號S/SK-HC/12，有需要處經修正處理，並以紅色顯示。

Notation 圖例

Zones

Comprehensive Development Area
 Residential (Group C)
 Residential (Group D)
 Residential (Group E)
 Village Type Development
 Government, Institution or Community
 Agriculture
 Green Belt
 Conservation Area
 Coastal Protection Area

Communications

Major Road and Junction

Miscellaneous

Boundary of Planning Scheme
 Non-Building Area

地帶

綜合發展區
 住宅（丙類）
 住宅（丁類）
 住宅（戊類）
 鄉村式發展
 政府、機構或社區
 農業
 綠化地帶
 自然保育區
 海岸保護區

交通

主要道路及路口

其他

規劃範圍界線
 非建築用地

AMENDMENTS TO APPROVED PLAN No. S/SK-HC/11

核准圖編號S/SK-HC/11的修訂

AMENDMENTS EXHIBITED UNDER SECTION 5 OF THE TOWN PLANNING ORDINANCE

按照城市規劃條例第5條展示的修訂

Amendment Item B
 修訂項目B項

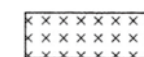

Amendment Item C
 修訂項目C項

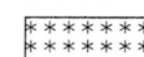

Amendment Item D
 修訂項目D項



Amendment Item E
 修訂項目E項



Amendment Item F
 修訂項目F項



Amendment Item G1
 修訂項目G1項



Amendment Item G2
 修訂項目G2項

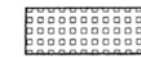

Amendment Item G3
 修訂項目G3項

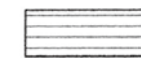

Amendment Item G4
 修訂項目G4項



Amendment Item G5
 修訂項目G5項



Amendment Item H
 修訂項目H項



行政長官會同行政會議2011年10月4日根據道路（工程、使用及補償）條例（第370章）批准的清水灣道與匡湖居之間的一段西貢公路分隔車道工程及綠洲區內道路改善工程。
THE ROAD AS DESCRIBED IN THE ROAD SCHEME FOR DUALLING OF HIRAM'S HIGHWAY BETWEEN CLEAR WATER BAY ROAD AND MARINA COVE AND IMPROVEMENT TO LOCAL ACCESS TO HO CHUNG AUTHORIZED BY THE CHIEF EXECUTIVE IN COUNCIL UNDER THE ROADS (WORKS, USE AND COMPENSATION) ORDINANCE (CHAPTER 370) ON 4.10.2011 IS SHOWN ON THIS PLAN FOR INFORMATION ONLY

這是1990年10月12日在憲報公布的白沙灣中期發展審批地區圖編號IDPA/SK-HH/1沒有涵蓋的範圍，但已包括在2004年6月25日在憲報公布的白沙灣分區計劃大綱草圖編號S/SK-HH/4的規劃區內。
AREA NOT FALLING WITHIN THE BOUNDARIES OF THE HEBE HAVEN INTERIM DEVELOPMENT PERMISSION AREA PLAN No. IDPA/SK-HH/1 PUBLISHED IN THE GAZETTE ON 12.10.1990 BUT INCLUDED IN THE PLANNING SCHEME AREA ON THE DRAFT HEBE HAVEN OUTLINE ZONING PLAN No. S/SK-HH/4 PUBLISHED IN THE GAZETTE ON 25.6.2004.

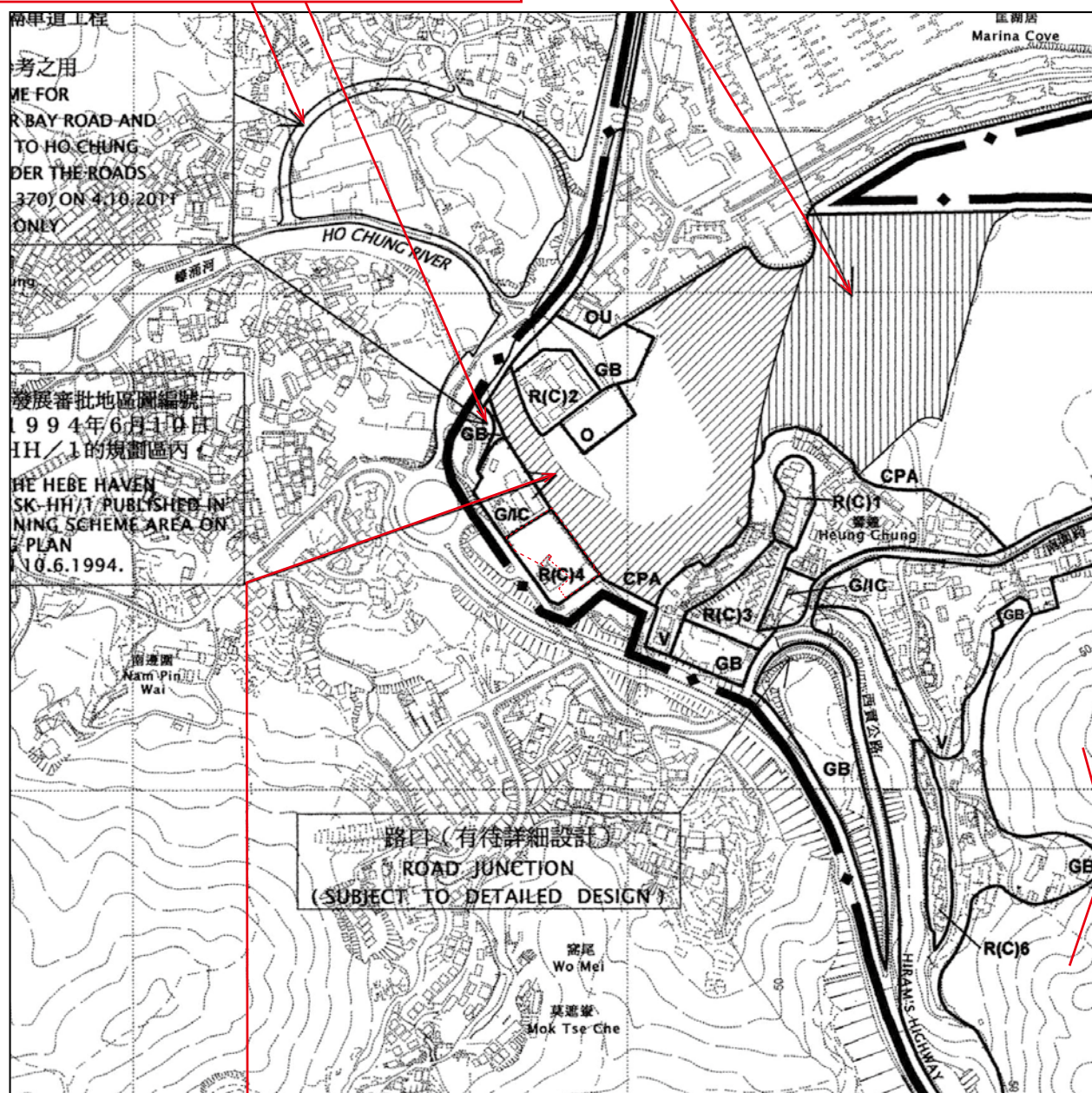

這是1990年10月12日在憲報公布的白沙灣中期發展審批地區圖編號IDPA/SK-HH/1沒有涵蓋的範圍，但已包括1994年6月10日在憲報公布的白沙灣分區計劃大綱草圖編號S/SK-HH/1的規劃區內。
AREA NOT FALLING WITHIN THE BOUNDARIES OF THE HEBE HAVEN INTERIM DEVELOPMENT PERMISSION AREA PLAN No. IDPA/SK-HH/1 PUBLISHED IN THE GAZETTE ON 12.10.1990 BUT INCLUDED IN THE PLANNING SCHEME AREA ON THE DRAFT HEBE HAVEN OUTLINE ZONING PLAN No. S/SK-HH/1 PUBLISHED IN THE GAZETTE ON 10.6.1994.

 Location of the Development
發展項目的位置

Scale: 0M/米
比例: 

Notes:

- The last updated Outline Zoning Plan and the attached schedule as at the date of printing of the sales brochure are available for free inspection at the sales office during opening hours.
- The Vendor advises prospective purchasers to conduct an on-site visit for a better understanding of the Development site, its surrounding environment and the public facilities nearby.
- This Outline Zoning Plan may show more than the area required under the Residential Properties (First-hand Sales) Ordinance due to technical reason that the boundary of the Development is irregular.
- This Outline Zoning Plan, prepared by the Planning Department under the direction of the Town Planning Board, is reproduced with the permission of the Director of Lands. ©The Government of Hong Kong SAR.

Adopted from part of the Approved Hebe Haven Outline Zoning Plan No. S/SK-HH/8, gazetted on 12th June 2020, with adjustments where necessary as shown in red.

摘錄自2020年6月12日刊憲之白沙灣分區計劃大綱核准圖編號S/SK-HH/8，有需要處經修正處理，並以紅色顯示。

Notation 圖例

Zones

Residential (Group C)

R(C)

地帶
住宅（丙類）

Village Type Development

V

鄉村式發展

Government, Institution or Community

G/IC

政府、機構或社區

Open Space

O

休憩用地

Other Specified Uses

OU

其他指定用途

Green Belt

GB

綠化地帶

Conservation Area

CA

自然保育區

Coastal Protection Area

CPA

海岸保護區

Communications

Major Road and Junction

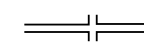

交通
主要道路及路口

Miscellaneous

Boundary of Planning Scheme



其他
規劃範圍界線

備註：

- 在印刷售樓說明書當日所適用的最近期分區計劃大綱圖及其附表，可於售樓處開放時間內免費查閱。
- 賣方建議準買家到有關發展地盤作實地考察，以對該發展地盤、其周邊地區環境及附近的公共設施有較佳了解。
- 由於發展項目的邊界不規則的技術原因，此分區計劃大綱圖所顯示的範圍可能超過《一手住宅物業銷售條例》所規定的範圍。
- 此分區計劃大綱圖為規劃署遵照城市規劃委員會指示擬備，版權屬香港特別行政區政府，經地政總署准許複印。