

CROSS-SECTION PLAN OF BUILDING IN THE DEVELOPMENT

發展項目中的建築物的橫截面圖

Cross-section Plan A-A 橫截面圖 A-A

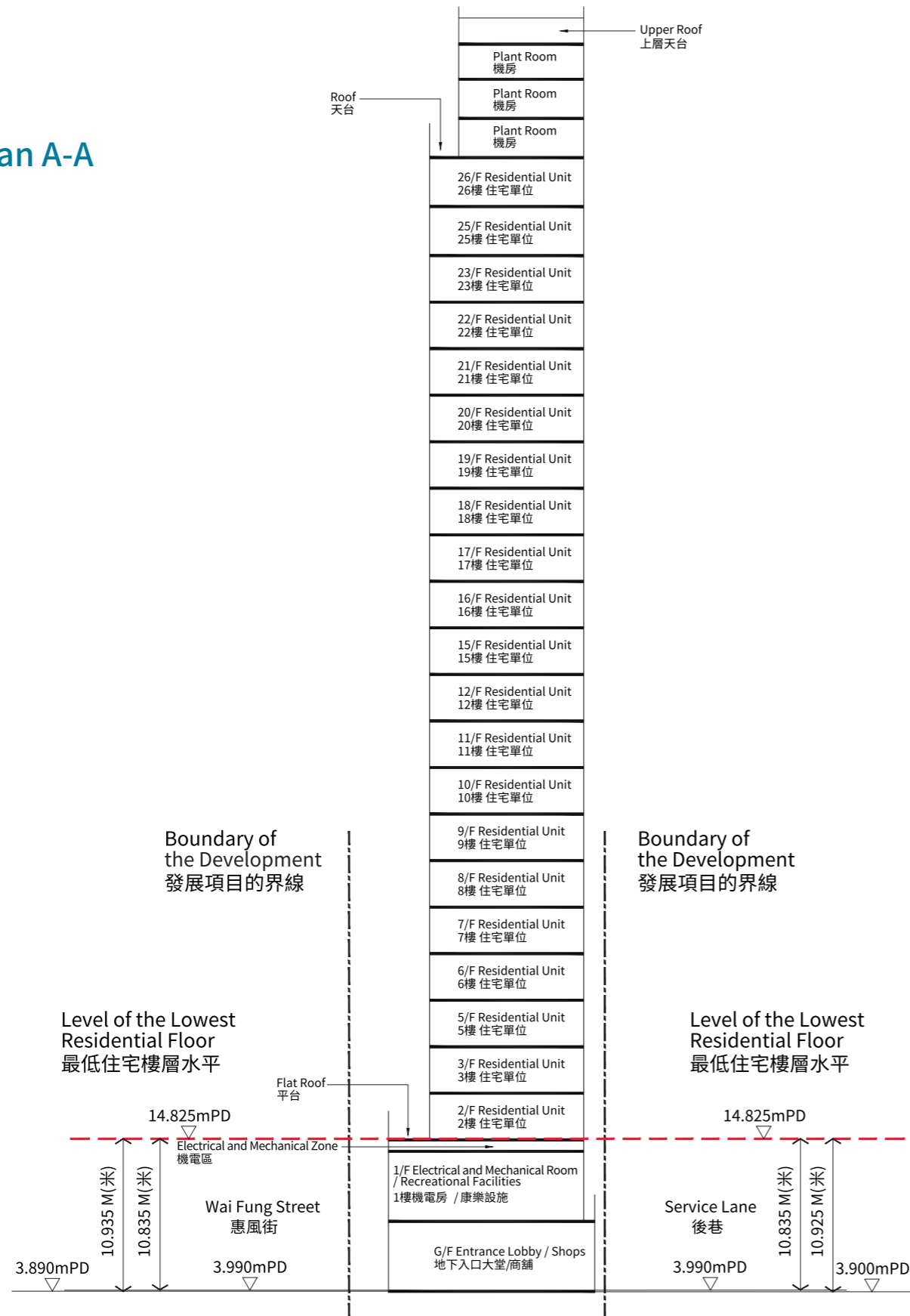

Dotted line denotes the level of the lowest residential floor.
虛線為最低住宅樓層水平。

1. The part of Wai Fung Street adjacent to the building is 3.890 metres to 3.990 metres above the Hong Kong Principal Datum.
2. The part of Service Lane adjacent to the building is 3.900 metres to 3.990 metres above the Hong Kong Principal Datum.
3. ▽ Denotes height (in metres) above the Hong Kong Principal Datum (mPD).

Key Plan 指示圖

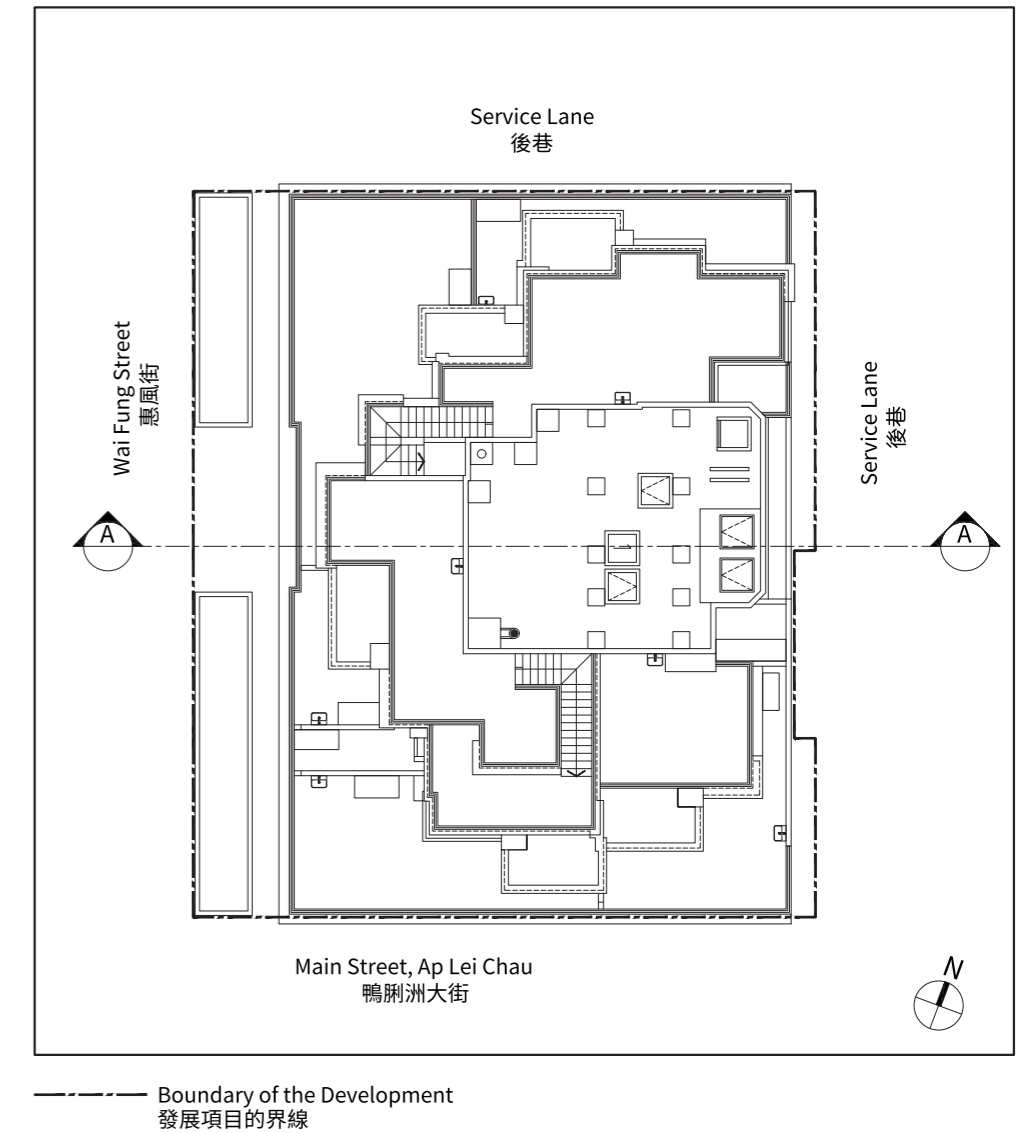

1. 毗鄰建築物的一段惠風街為香港主水平基準以上3.890米至3.990米。
2. 毗鄰建築物的一段後巷為香港主水平基準以上3.900米至3.990米。
3. ▽ 為香港主水平基準以上高度(米)。

CROSS-SECTION PLAN OF BUILDING IN THE DEVELOPMENT

發展項目中的建築物的橫截面圖

Cross-section Plan B-B 橫截面圖 B-B

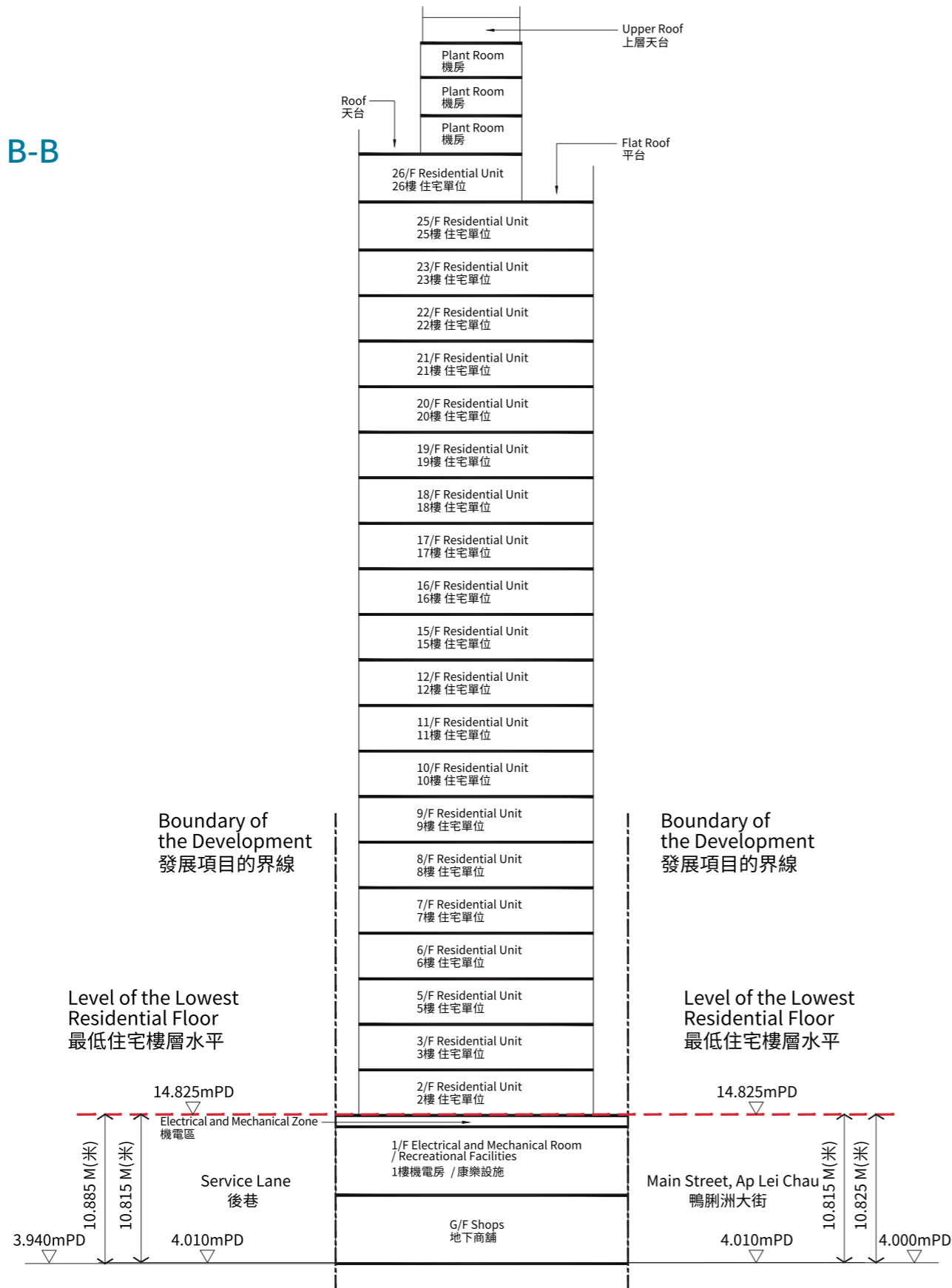

Key Plan 指示圖

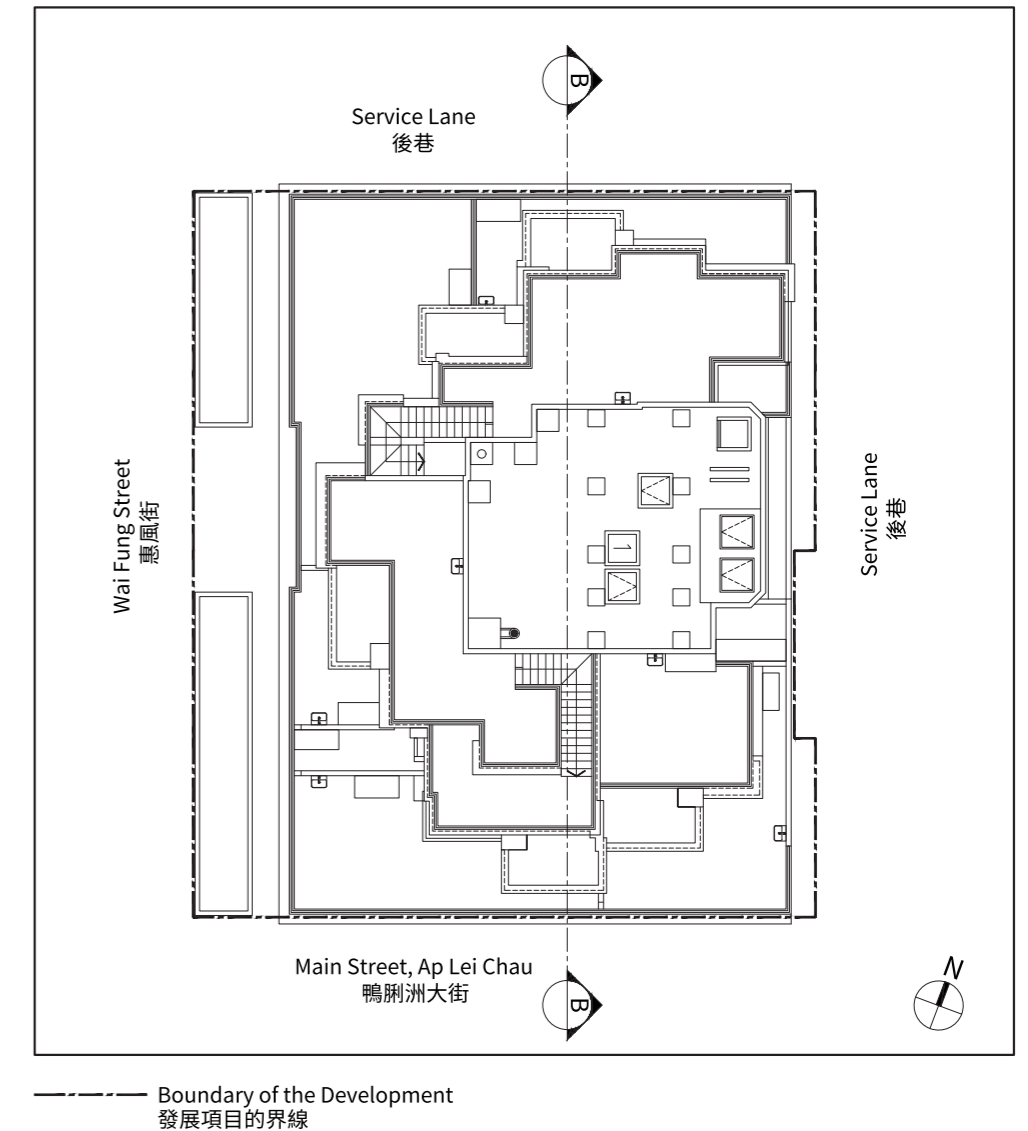

Dotted line denotes the level of the lowest residential floor.

虛線為最低住宅樓層水平。

1. The part of Main Street, Ap Lei Chau adjacent to the building is 4.000 metres to 4.010 metres above the Hong Kong Principal Datum.
2. The part of Service Lane adjacent to the building is 3.940 metres to 4.010 metres above the Hong Kong Principal Datum.
3. ▽ Denotes height (in metres) above the Hong Kong Principal Datum (mPD).

1. 毗鄰建築物的一段鴨洲大街為香港主水平基準以上4.000米至4.010米。
2. 毗鄰建築物的一段後巷為香港主水平基準以上3.940米至4.010米。
3. ▽ 為香港主水平基準以上高度(米)。